



Chipsmall Limited consists of a professional team with an average of over 10 year of expertise in the distribution of electronic components. Based in Hongkong, we have already established firm and mutual-benefit business relationships with customers from,Europe,America and south Asia,supplying obsolete and hard-to-find components to meet their specific needs.

With the principle of “Quality Parts,Customers Priority,Honest Operation,and Considerate Service”,our business mainly focus on the distribution of electronic components. Line cards we deal with include Microchip,ALPS,ROHM,Xilinx,Pulse,ON,Everlight and Freescale. Main products comprise IC,Modules,Potentiometer,IC Socket,Relay,Connector.Our parts cover such applications as commercial,industrial, and automotives areas.

We are looking forward to setting up business relationship with you and hope to provide you with the best service and solution. Let us make a better world for our industry!



## Contact us

Tel: +86-755-8981 8866 Fax: +86-755-8427 6832

Email & Skype: info@chipsmall.com Web: www.chipsmall.com

Address: A1208, Overseas Decoration Building, #122 Zhenhua RD., Futian, Shenzhen, China



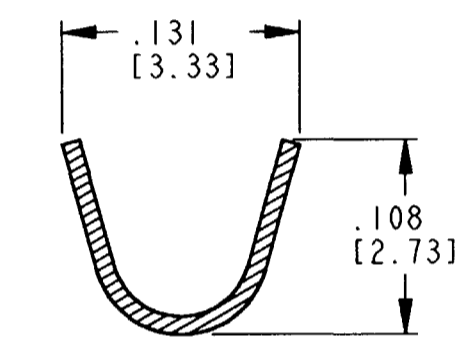
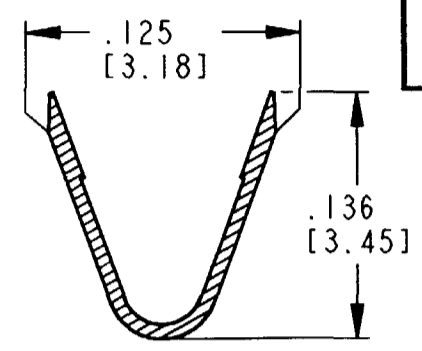
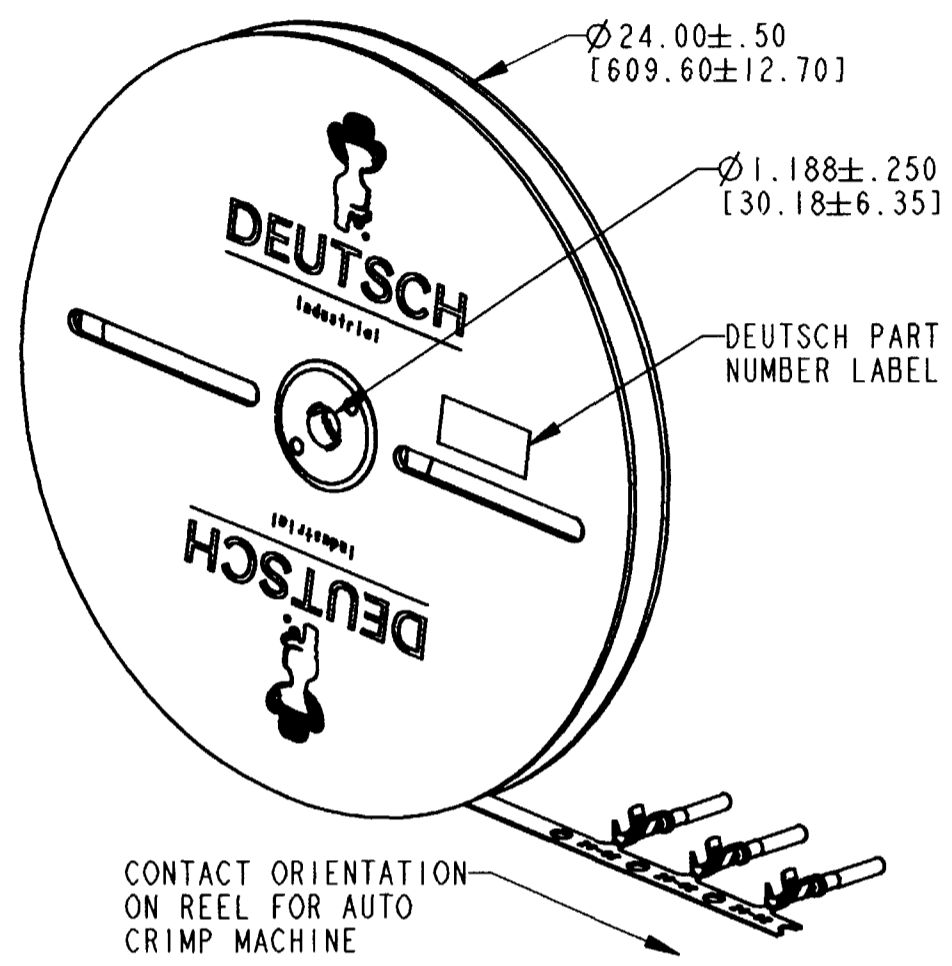

REV	DESCRIPTION	DATE	APPROVED
E	1062-20-02**		
B	REVISED PER E.O. P17938	11-1-02	R.D.R.
C	REVISED PER E.O. P19261	6-13-06	R.D.R.
D	REVISED PER E.O. P19555	7-11-07	R.D.R.
E	REVISED PER E.O. P20392	12-3-09	RDR

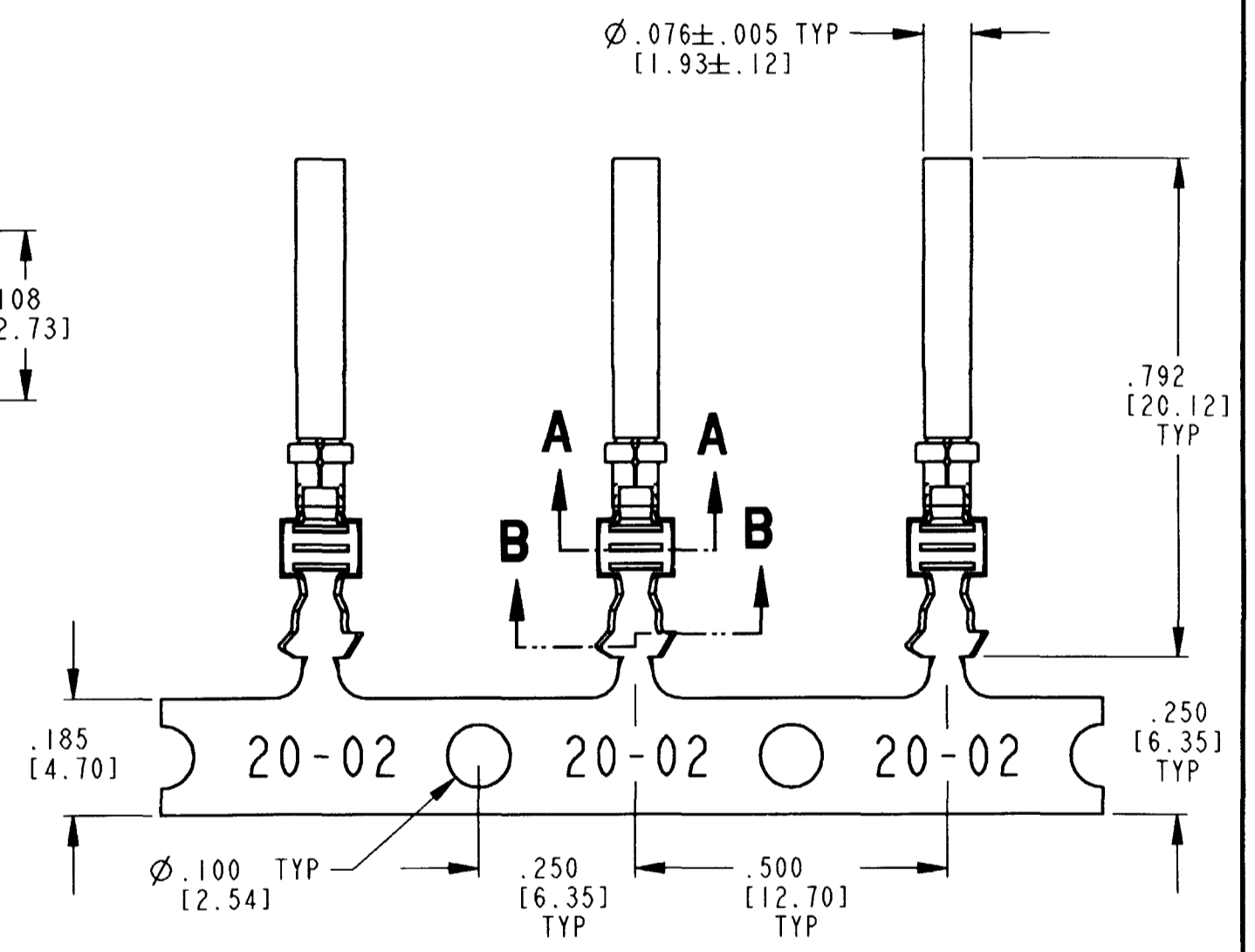

7. CONTACT BODY MATERIAL: COPPER ALLOY;  
CONTACT SLEEVE MATERIAL: STAINLESS STEEL.
  6. WHEN \*\* = 22 PLATING IS NICKEL.  
      \*\* = 44 PLATING IS GOLD.  
      \*\* = 77 PLATING IS TIN.
  5. SEE 0425-015-0000 FOR CONTACT PERFORMANCE AND WIRE APPLICATION CHARACTERISTICS.
  4. THIS CONTACT MAY BE CRIMPED WITH DCT20-02-00 AUTOMATIC DIE OR DTT-20-02 HAND TOOL. SEE DRAWING 0425-207-0000 FOR APPLICABLE WIRE SIZE, INSULATION DIAMETER RANGE, AND CRIMPING INFORMATION.
  3. ONE REEL CONTAINS APPROXIMATELY 4000 CONTACTS.
  2. DIMENSIONAL TOLERANCE: ±.025 [0.63].
  1. DIMENSIONS ARE IN INCHES [mm].
- NOTES: UNLESS OTHERWISE SPECIFIED

SIGNATURE & DATE		<b>STAMPED CONTACT SOCKET SIZE 20</b>	EP	MATL. CODE
DR	J. APOSTOL 02DEC2009		3850 INDUSTRIAL AVE. HEMET, CA 92545	
CHK	D. Meyer 12/2/09		<b>DEUTSCH INDUSTRIAL</b>	
PE	D. Meyer 12/2/09		<b>B 1062-20-02**</b>	
APPD	R. Reed 12-3-09	ENVELOPE	DWG SIZE	CODE 11139 SHEET   OF
SCALE NONE	WT			