



Chipsmall Limited consists of a professional team with an average of over 10 year of expertise in the distribution of electronic components. Based in Hongkong, we have already established firm and mutual-benefit business relationships with customers from,Europe,America and south Asia,supplying obsolete and hard-to-find components to meet their specific needs.

With the principle of “Quality Parts,Customers Priority,Honest Operation,and Considerate Service”,our business mainly focus on the distribution of electronic components. Line cards we deal with include Microchip,ALPS,ROHM,Xilinx,Pulse,ON,Everlight and Freescale. Main products comprise IC,Modules,Potentiometer,IC Socket,Relay,Connector.Our parts cover such applications as commercial,industrial, and automotives areas.

We are looking forward to setting up business relationship with you and hope to provide you with the best service and solution. Let us make a better world for our industry!



Contact us

Tel: +86-755-8981 8866 Fax: +86-755-8427 6832

Email & Skype: info@chipsmall.com Web: www.chipsmall.com

Address: A1208, Overseas Decoration Building, #122 Zhenhua RD., Futian, Shenzhen, China



4

3

2

THIS DRAWING IS UNPUBLISHED. RELEASED FOR PUBLICATION 2000
 © COPYRIGHT 2000 BY TYCO ELECTRONICS CORPORATION. ALL RIGHTS RESERVED.

LOC	DIST	REVISIONS				
P	LTR	DESCRIPTION	DATE	DWN	APVD	
	0	EH00-0248-93	11 OCT 93	RH	WB	
	01	SR10-0065-01	20 FEB 01	KV	KV	

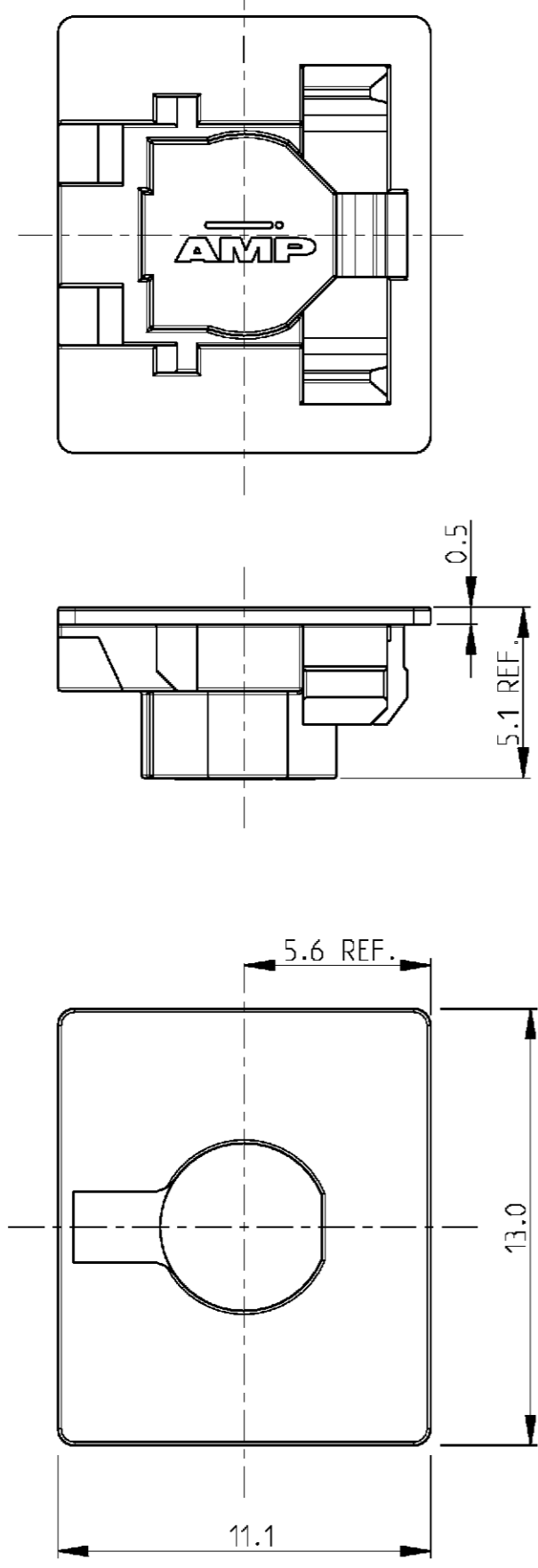

⚠ CAN BE USED WITH 6 POS. MODULAR JACK
 IN CERTAIN CASES IT FITS IN 8 POS. MODULAR JACK.
 CONTACT AMP FOR MORE DETAILS
 PACKAGING: 50.000 pcs IN A BOX

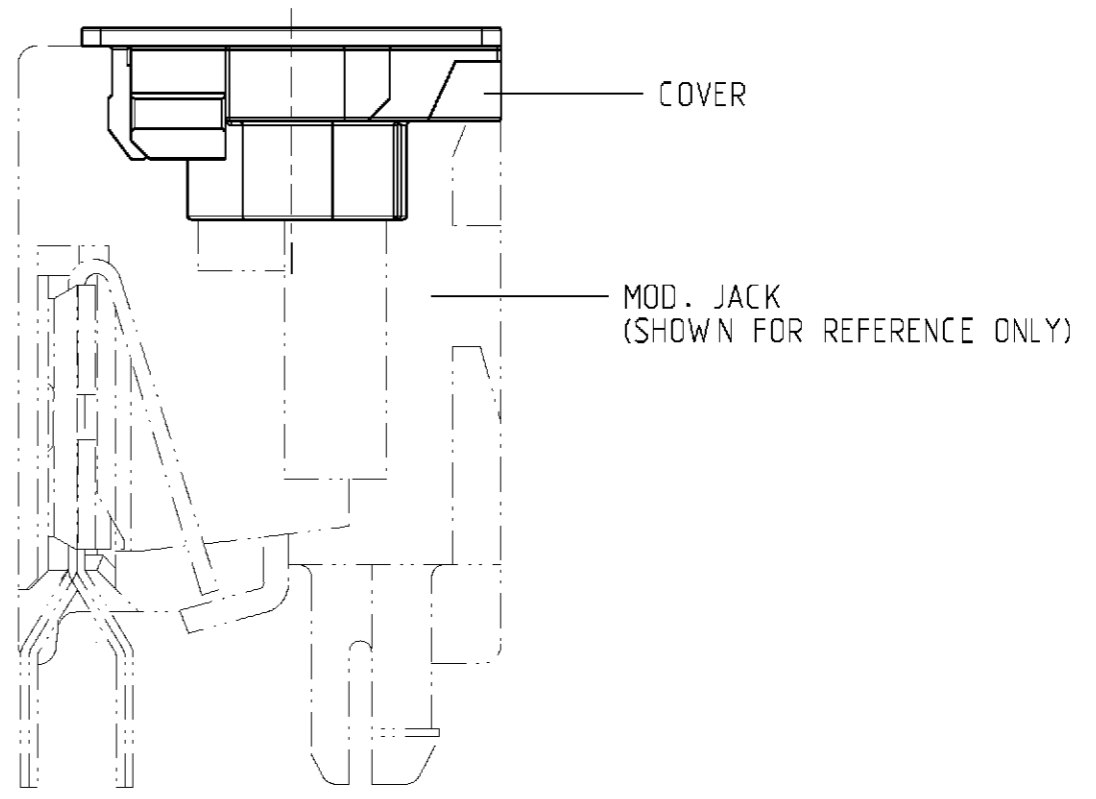

BLACK	G. F. NYLON	106307-1
COLOR	MATERIAL	PARTNUMBER

THIS DRAWING IS A CONTROLLED DOCUMENT FOR TYCO ELECTRONICS CORPORATION IT IS SUBJECT TO CHANGE AND THE CONTROLLING ENGINEERING ORGANIZATION SHOULD BE CONTACTED FOR THE LATEST REVISION.		DWN	11 OCT 93	Tyco Electronics Oostkamp - Belgium	
DIMENSIONS: mm		CHK	-	NAME	
TOLERANCES UNLESS OTHERWISE SPECIFIED:		APVD	-	COVER 6 POS.	
0 PLC	±0.5	PRODUCT SPEC	-	SIZE	CAGE CODE
1 PLC	±0.13	APPLICATION SPEC	-	A3	00779
2 PLC	±0.013	WEIGHT	-	DRAWING NO	106307
3 PLC	±0.0001	CUSTOMER DRAWING	-	SCALE	5:1
4 PLC	±	RESTRICTED TO	-	SHEET	1 OF 1
ANGLES	±	REV	01	OF	1
MATERIAL	-				
FINISH	-				