



Chipsmall Limited consists of a professional team with an average of over 10 year of expertise in the distribution of electronic components. Based in Hongkong, we have already established firm and mutual-benefit business relationships with customers from,Europe,America and south Asia,supplying obsolete and hard-to-find components to meet their specific needs.

With the principle of “Quality Parts,Customers Priority,Honest Operation,and Considerate Service”,our business mainly focus on the distribution of electronic components. Line cards we deal with include Microchip,ALPS,ROHM,Xilinx,Pulse,ON,Everlight and Freescale. Main products comprise IC,Modules,Potentiometer,IC Socket,Relay,Connector.Our parts cover such applications as commercial,industrial, and automotives areas.

We are looking forward to setting up business relationship with you and hope to provide you with the best service and solution. Let us make a better world for our industry!



## Contact us

Tel: +86-755-8981 8866 Fax: +86-755-8427 6832

Email & Skype: info@chipsmall.com Web: www.chipsmall.com

Address: A1208, Overseas Decoration Building, #122 Zhenhua RD., Futian, Shenzhen, China



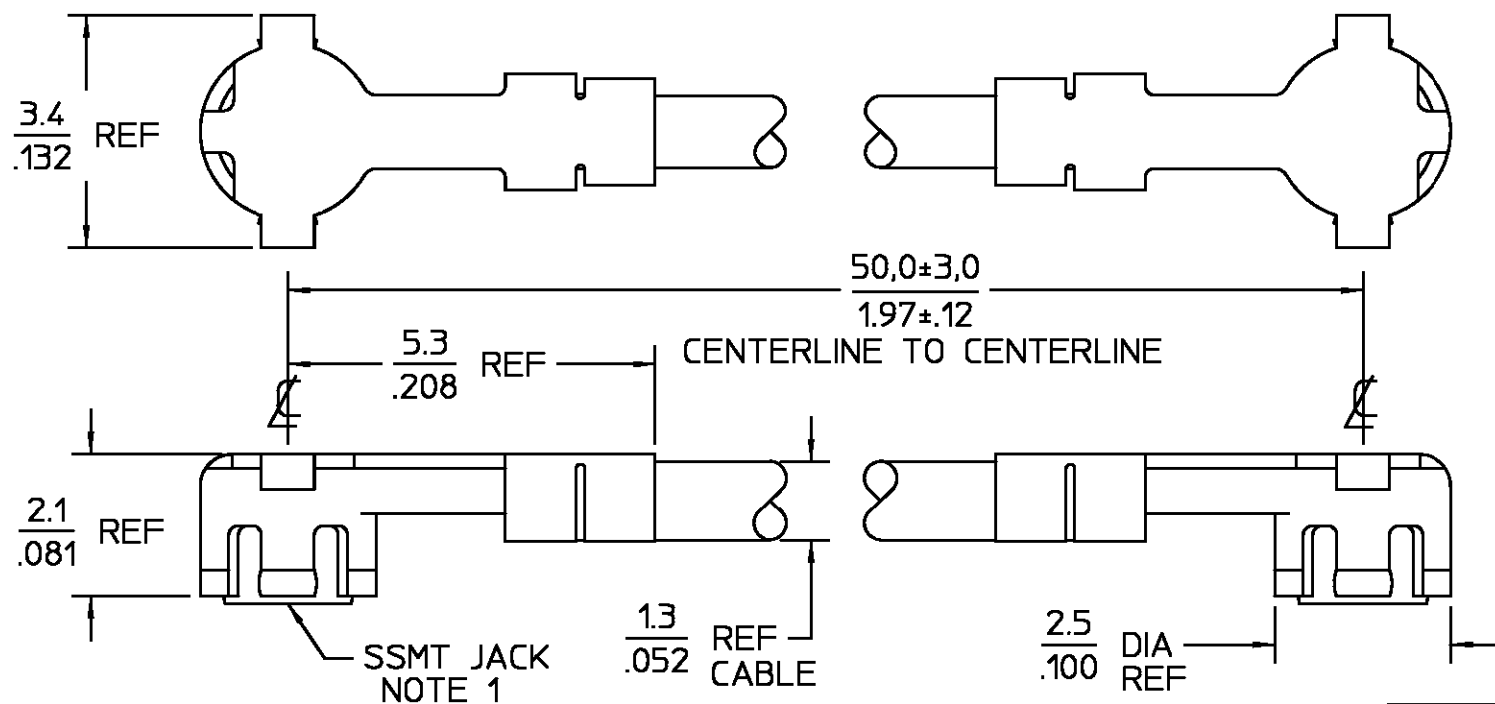

REVISIONS			
REV	DESCRIPTION	DATE	APPROVED
010	RELEASED	7/21/95	S. Morley
011	REVISED PER ECN 95-0547	12/7/95	S. Morley
012	REVISED PER ECN 99-0001	DM 5/20/99	S. Morley
013	REVISED PER ECN 99-0001	DM 6/25/99	PCW 6/25/99

**NOTES:**

1. CONNECTOR CENTERLINES SHALL BE ALIGNED AS SHOWN WITHIN ±30° FOR LENGTHS 165 MILLIMETERS OR LESS. LENGTHS ABOVE 165 MILLIMETERS SHALL HAVE CONNECTOR CENTERLINES ALIGNED AT RANDOM.

XX.X = mm  
.XXX = in

ELECTRICAL

Frequency	DC - 6 GHz
Nominal Impedance	50 ohms
Voltage Rating	250 Volts (VRMS Max.) @ Sea Level
VSWR	1.20:1 Max. @ 2GHz 1.40:1 Max. @ 6GHz
Insulation Resistance	1,000 Megohms Minimum @ 250VDC
Dielectric Withstanding Voltage	500 Volts (VRMS Minimum) @ Sea Level

MECHANICAL

Connector Durability 100 mating cycles

ENVIRONMENTAL

Temperature Rating -40°C (-40°F) To +125°C (257°F)

CONNECTOR:	MATERIAL	FINISH
INNER & OUTER CONTACTS	BERYLLIUM COPPER ALLOY CDA172	GOLD PLATE OVER NICKEL PLATE
DIELECTRIC	POLYPROPYLENE, GF	N/A
CABLE:		
JACKET	FEP FLUOROCARBON PER ASTM-D2116	N/A
SHIELD	COPPER WIRE, 44AWG	SILVER PLATED
DIELECTRIC	PTFE FLUOROCARBON PER ASTM-D1457	N/A
CENTER CONDUCTOR	COPPER CLAD STEEL, 30AWG	SILVER PLATED
COMPONENT	MATERIAL	FINISH

UNLESS OTHERWISE SPECIFIED DIMENSIONS ARE IN MILLIMETERS TOLERANCE ON FRAC DEC ANGLES - - -	DRAWN BY P. RESNICK	DATE 3 JUNE 94	AMP Incorporated 140 Fourth Avenue Waltham, MA 02451-7599
	CHECKED BY	APPD BY	

These drawings and specifications are the property of AMP Incorporated and shall not be reproduced or copied or used in whole or in part as the basis for the manufacture or sale of item(s) without written permission.	USE ASSY PROCEDURE			TITLE SSMT RIGHT ANGLE JACK TO JACK CABLE ASSEMBLY		
	NO. A.P. N/A	SIZE B	CODE IDENT NO. 26805	9960-1050-24	REV 013	
		SCALE 10:1	CABLE TYPE SSMT-FLEX	SHEET 1 OF 1		

CUSTOMER DRAWING

AMP PART # 1064522-1  
SHEET 1 OF 1 REV A

OUTLINE, -50 AND B/M MUST CARRY THE SAME MAJOR REVISION LEVEL