



Chipsmall Limited consists of a professional team with an average of over 10 year of expertise in the distribution of electronic components. Based in Hongkong, we have already established firm and mutual-benefit business relationships with customers from,Europe,America and south Asia,supplying obsolete and hard-to-find components to meet their specific needs.

With the principle of “Quality Parts,Customers Priority,Honest Operation,and Considerate Service”,our business mainly focus on the distribution of electronic components. Line cards we deal with include Microchip,ALPS,ROHM,Xilinx,Pulse,ON,Everlight and Freescale. Main products comprise IC,Modules,Potentiometer,IC Socket,Relay,Connector.Our parts cover such applications as commercial,industrial, and automotives areas.

We are looking forward to setting up business relationship with you and hope to provide you with the best service and solution. Let us make a better world for our industry!



Contact us

Tel: +86-755-8981 8866 Fax: +86-755-8427 6832

Email & Skype: info@chipsmall.com Web: www.chipsmall.com

Address: A1208, Overseas Decoration Building, #122 Zhenhua RD., Futian, Shenzhen, China



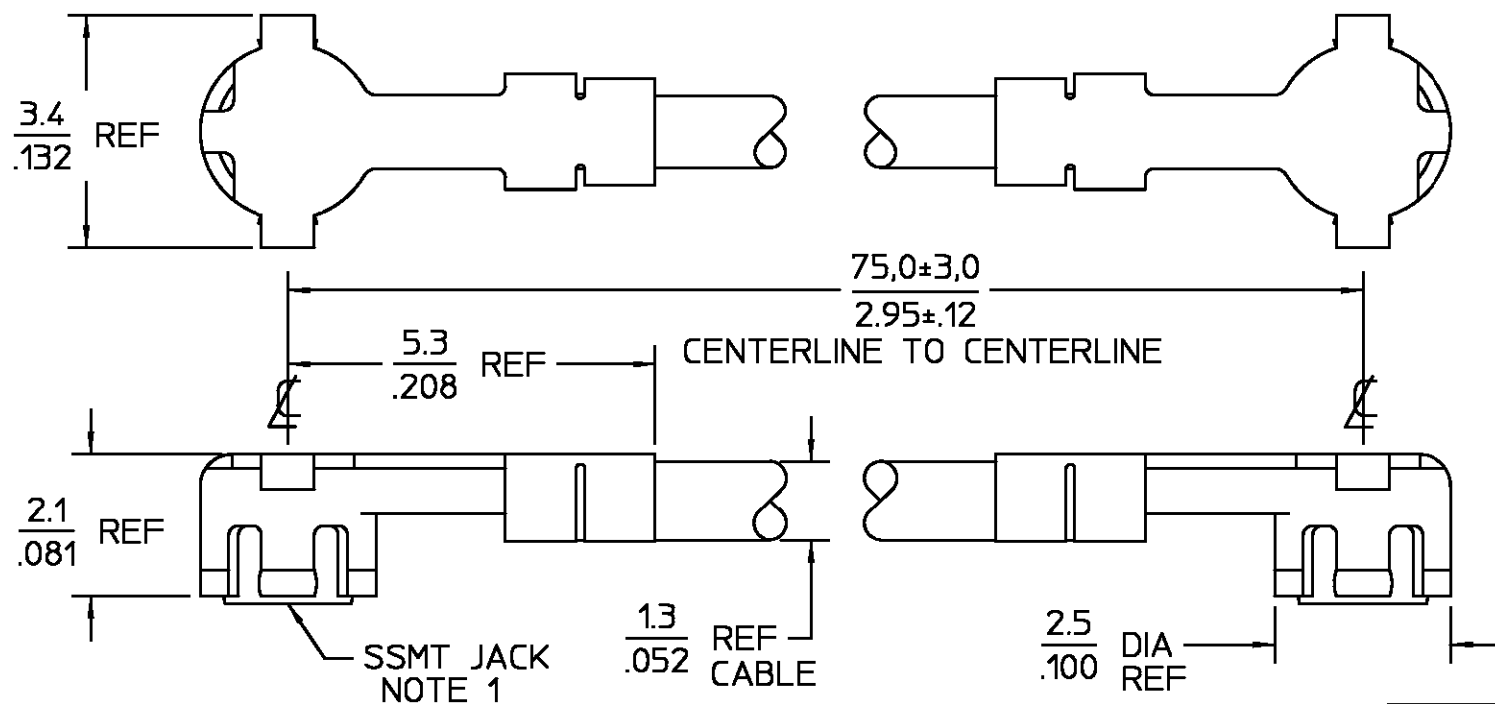

| REVISIONS | | | |
|-----------|-------------------------|---------------|----------------|
| REV | DESCRIPTION | DATE | APPROVED |
| 010 | RELEASED | 7/21/95 | S. Morley |
| 011 | REVISED PER ECN 95-0547 | 12/7/95 | S. Morley |
| 012 | REVISED PER ECN 99-0001 | DM 5/20/99 | S. Morley |
| 013 | REVISED PER ECN 99-0001 | DM 6/25/99 | PCW 6/25/99 |

NOTES:

1. CONNECTOR CENTERLINES SHALL BE ALIGNED AS SHOWN WITHIN ±30° FOR LENGTHS 165 MILLIMETERS OR LESS. LENGTHS ABOVE 165 MILLIMETERS SHALL HAVE CONNECTOR CENTERLINES ALIGNED AT RANDOM.

XX.X = mm
.XXX = in

| CONNECTOR: | MATERIAL | FINISH |
|------------------------|----------------------------------|------------------------------|
| INNER & OUTER CONTACTS | BERYLLIUM COPPER ALLOY CDA172 | GOLD PLATE OVER NICKEL PLATE |
| DIELECTRIC | POLYPROPYLENE, GF | N/A |
| CABLE: | | |
| JACKET | FEP FLUOROCARBON PER ASTM-D2116 | N/A |
| SHIELD | COPPER WIRE, 44AWG | SILVER PLATED |
| DIELECTRIC | PTFE FLUOROCARBON PER ASTM-D1457 | N/A |
| CENTER CONDUCTOR | COPPER CLAD STEEL, 30AWG | SILVER PLATED |

| COMPONENT | MATERIAL | FINISH |
|-----------|----------|--------|
| | | |

| | | | |
|---|------------------------|-------------------|---|
| UNLESS OTHERWISE SPECIFIED DIMENSIONS ARE IN MILLIMETERS TOLERANCE ON FRAC DEC ANGLES - - - | DRAWN BY P. RESNICK | DATE 3 JUNE 94 | AMP Incorporated 140 Fourth Avenue Waltham, MA 02451-7599 |
| | CHECKED BY | APPD BY | |

| | | | | | | | |
|--|--------------------|--|-------------------------|---|-------------------------|--------------|------------|
| These drawings and specifications are the property of AMP Incorporated and shall not be reproduced or copied or used in whole or in part as the basis for the manufacture or sale of item(s) without written permission. | USE ASSY PROCEDURE | | | TITLE SSMT RIGHT ANGLE JACK TO JACK CABLE ASSEMBLY | | | |
| | NO. A.P. N/A | | | SIZE B | CODE IDENT NO. 26805 | 9960-1075-24 | REV 013 |
| | SCALE 10:1 | | CABLE TYPE SSMT-FLEX | SHEET 1 OF 2 | | | |

ELECTRICAL

Frequency DC - 6 GHz
 Nominal Impedance 50 ohms
 Voltage Rating 250 Volts (VRMS Max.) @ Sea Level
 VSWR 1.20:1 Max. @ 2GHz
 1.40:1 Max. @ 6GHz
 Insulation Resistance 1,000 Megohms Minimum @ 250VDC
 Dielectric Withstanding Voltage 500 Volts (VRMS Minimum) @ Sea Level

MECHANICAL

Connector Durability 100 mating cycles

ENVIRONMENTAL

Temperature Rating -40°C (-40°F) To +125°C (257°F)

CUSTOMER DRAWING

AMP PART # 1064523-1
SHEET 1 OF 1 REV A

OUTLINE, -50 AND B/M MUST CARRY THE SAME MAJOR REVISION LEVEL