



Chipsmall Limited consists of a professional team with an average of over 10 year of expertise in the distribution of electronic components. Based in Hongkong, we have already established firm and mutual-benefit business relationships with customers from,Europe,America and south Asia,supplying obsolete and hard-to-find components to meet their specific needs.

With the principle of "Quality Parts,Customers Priority,Honest Operation,and Considerate Service",our business mainly focus on the distribution of electronic components. Line cards we deal with include Microchip,ALPS,ROHM,Xilinx,Pulse,ON,Everlight and Freescale. Main products comprise IC,Modules,Potentiometer,IC Socket,Relay,Connector.Our parts cover such applications as commercial,industrial, and automotives areas.

We are looking forward to setting up business relationship with you and hope to provide you with the best service and solution. Let us make a better world for our industry!



## Contact us

Tel: +86-755-8981 8866 Fax: +86-755-8427 6832

Email & Skype: info@chipsmall.com Web: www.chipsmall.com

Address: A1208, Overseas Decoration Building, #122 Zhenhua RD., Futian, Shenzhen, China



**SERIES**

**105R & 108R**  
**105 & 108**



**Micro i® Chip Inductors**

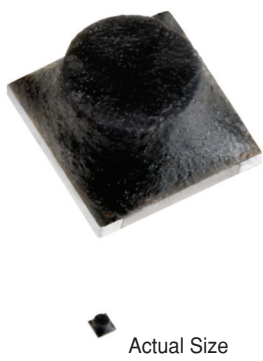
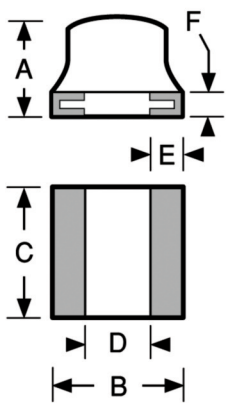

**Military Specifications**

Series 105 MIL-PRF-83446 (Reference)  
Series 108 MIL-PRF-83446/8 (Reference)

**Physical Parameters for Series 105**

	Inches	Millimeters
A	0.075 Max.	1.91 Max.
B	0.100 ± 0.010	2.54 ± 0.25
C	0.100 ± 0.010	2.54 ± 0.25
D	0.050 Min.	1.27 Min.
E	0.015 Min. (Typ.)	0.38 Min. (Typ.)
F	0.020 Max. (Typ.)	0.51 Max. (Typ.)

**Physical Parameters for Series 108**

	Inches	Millimeters
A	0.070 Max.	1.78 Max.
B	0.100 ± 0.010	2.54 ± 0.254
C	0.100 ± 0.010	2.54 ± 0.254
D	0.050 Min.	1.27 Min.
E	0.025 ± 0.005 (Typ.)	0.635 ± 0.13 (Typ.)
F	0.020 Max. (Typ.)	0.51 Max. (Typ.)

**Weight Max.** (Grams) 0.05

**Current Rating at 90°C Ambient** 35°C Rise

**Operating Temperature Range** -55°C to +125°C

**Maximum Power Dissipation at 90°C** 0.135 W

**Mechanical Configuration** Units are epoxy encapsulated. Contact areas for reflow soldering are gold plated per MIL-G-45204 Type 1-Grade A. Internal connections are thermal compression bonded.

**Packaging** Tape & reel (8mm): 7" reel, 2000 pieces max.; 13" reel, 8000 pieces max.

**Made in the U.S.A.**

MIL DASH # (Reference)  
INDUCTANCE (µH)  
TOLERANCE  
Q MINIMUM  
TEST FREQUENCY (MHz)  
SRF MINIMUM (MHz)  
DC RESISTANCE MAXIMUM (OHMS)  
CURRENT RATING MAXIMUM (mA)

SERIES 105 IRON CORE								
-121M		0.12	± 20%	40	25.0	500	0.14	830
-151M		0.15	± 20%	40	25.0	440	0.16	775
-181M		0.18	± 20%	40	25.0	405	0.19	710
-221K		0.22	± 10%	40	25.0	360	0.21	675
-271K		0.27	± 10%	40	25.0	330	0.23	650
-331K		0.33	± 10%	35	25.0	280	0.25	620
-391K		0.39	± 10%	35	25.0	185	0.28	585
-471K		0.47	± 10%	35	25.0	178	0.31	555
-561K		0.56	± 10%	35	25.0	163	0.45	460
-681K		0.68	± 10%	35	25.0	160	0.62	395
-821K		0.82	± 10%	30	25.0	155	0.65	385
-102K		1.0	± 10%	30	25.0	130	0.73	360
-122K		1.2	± 10%	25	7.9	115	1.0	310
-152K		1.5	± 10%	25	7.9	100	1.2	280
-182K		1.8	± 10%	25	7.9	90	1.5	250
-222K		2.2	± 10%	25	7.9	75	1.7	235
-272K		2.7	± 10%	25	7.9	68	2.0	220
-332K		3.3	± 10%	25	7.9	62	2.2	210
-392K		3.9	± 10%	25	7.9	57	2.8	185
-472K		4.7	± 10%	30	7.9	52	3.1	175
-562K		5.6	± 10%	30	7.9	47	3.3	170
-682K		6.8	± 10%	30	7.9	42	3.8	160
-822K		8.2	± 10%	30	7.9	40	5.0	135
-103K		10.0	± 10%	30	7.9	38	5.6	130
M83446/08- (Reference) SERIES 108 IRON CORE								
-123K	87	12.0	± 10%	36	2.5	26.0	4.0	79
-153K	88	15.0	± 10%	32	2.5	24.0	4.2	79
-183K	89	18.0	± 10%	32	2.5	21.0	4.4	75
-223K	90	22.0	± 10%	32	2.5	19.0	7.5	57
-273K	91	27.0	± 10%	32	2.5	14.0	8.0	55
-333K	92	33.0	± 10%	30	2.5	12.0	13.0	45
-393K	93	39.0	± 10%	30	2.5	10.0	17.0	38
-473K	94	47.0	± 10%	30	2.5	9.0	19.0	36
-563K	95	56.0	± 10%	30	2.5	8.5	23.0	33
-683K	96	68.0	± 10%	30	2.5	8.2	25.0	32
-823K	97	82.0	± 10%	30	2.5	8.0	28.0	30
-104K	98	100.0	± 10%	30	2.5	7.0	31.0	28

Optional Tolerances: J = 5% H = 3% G = 2% F = 1%  
\*Complete part # must include series # PLUS the dash #  
For surface finish information, refer to [www.delevan.com](http://www.delevan.com)