



Chipsmall Limited consists of a professional team with an average of over 10 year of expertise in the distribution of electronic components. Based in Hongkong, we have already established firm and mutual-benefit business relationships with customers from,Europe,America and south Asia,supplying obsolete and hard-to-find components to meet their specific needs.

With the principle of “Quality Parts,Customers Priority,Honest Operation,and Considerate Service”,our business mainly focus on the distribution of electronic components. Line cards we deal with include Microchip,ALPS,ROHM,Xilinx,Pulse,ON,Everlight and Freescale. Main products comprise IC,Modules,Potentiometer,IC Socket,Relay,Connector.Our parts cover such applications as commercial,industrial, and automotives areas.

We are looking forward to setting up business relationship with you and hope to provide you with the best service and solution. Let us make a better world for our industry!



Contact us

Tel: +86-755-8981 8866 Fax: +86-755-8427 6832

Email & Skype: info@chipsmall.com Web: www.chipsmall.com

Address: A1208, Overseas Decoration Building, #122 Zhenhua RD., Futian, Shenzhen, China



cannon

DL Series ZIF connectors



ITT

ENGINEERED FOR LIFE

A Historical Achievement of Technology Leadership

Defining and Championing Innovation

Showcasing a portfolio of creativity, ITT's "Engineered For Life" execution embraces products which have become ubiquitous in a broad collection of markets including: Military/Aerospace, Civil Aircraft, Industrial Instrumentation, Medical, Oil & Gas, Energy, Transportation, Telecom/Handset, Computer, Consumer, and Automotive.

ITT's rich interconnect history embraces contributions to both technological breakthroughs and social movements. With one of the industry's broadest product offerings, ITT's interconnect products have supported:

- Every Free World space mission, bringing the universe to our doorstep.
- Motion picture, radio, and television equipment, serving laughter and entertainment to millions.
- Commercial and military communications systems, linking the voices of the world.
- Computerized tools, reshaping the information highway.
- Aircraft, rapid transit, and automobiles, mobilizing our expanding society.
- Oil and natural gas production, powering the world's economies.
- Agricultural equipment, attacking the roots of world hunger.



ITT Cannon

ITT Cannon is a brand of the multi-national ITT Corporation. Our connector portfolio remains the most extensive in the industry offering the most reliable and cost effective range of interconnect solutions. These innovations have enabled ITT to provide products and technologies to such markets as:

- Automotive
- Computer/Consumer
- Industrial/Instrumentation
- Military/Aerospace
- Oil Fields
- Telecom/Handset
- Transportation

When you specify a Cannon, VEAM or BIW connector, you can rely on a product designed, developed, and manufactured to the highest quality and reliability standards. This tradition of excellence is based on ITT's corporate culture of operating its businesses under the principles of Six Sigma. At ITT, Six Sigma is not just a quality philosophy but a complete corporate culture that drives the entire business. Our Value Based Management and Value Based Product Development systems are two cornerstones that allow for the development of both leadership and product engineering principles, ensuring the correct industry leading products are developed to the accepted market driven lead times. These principles have allowed ITT to become the market leader in all of our business portfolios.

Six Sigma Manufacturing

ITT operates manufacturing facilities in the United States, Germany, Italy, Mexico, China, Japan and the UK, all of which have particular product area strengths allowing ITT to offer a truly global footprint to our customers. Our facilities are world class and accommodate full vertical integration utilizing the latest manufacturing technologies including: automated and robotic machining centers, Super Market manufacturing cells, Kanban pull systems, and automated electrical, mechanical, and optical test and inspection equipment. The combination of our manufacturing strength and our advanced manufacturing facilities allows ITT to offer products at market driven prices. Our capabilities, especially in robotics, computerized precision tooling, Kaizen Project Management, Six Sigma tools, and testing,

give ITT the most optimized global manufacturing footprint in the interconnect industry.

The Custom Difference

As the industry leader in harsh environment interconnect applications, ITT's world class engineering teams will work directly with our customers to design and develop cost effective solutions for their applications. In many cases we may modify one of our standard designs to ensure a highly reliable solution where timing is critical. Yet, in those cases where a complete custom interconnect solution is required, ITT will work with our customer's Engineers to design an interconnect solution which will be cost effective yet highly reliable. As professional consultants, our Engineering teams will provide a thorough systems and mechanical analysis of any proposed solution. These analyses provide our customers with sophisticated electrical signal and mechanical characterizations to determine the best solution for their application.

RoHS Compliance Information

ITT has implemented a strict parts control plan for all ITT electronics plants worldwide that allows the Cannon, VEAM, and BIW connector product portfolios to meet the requirements of European Union Directive 2002/95/EC better known as the Reduction of Hazardous Substances initiative. As appropriate, specific Cannon, VEAM, and BIW products may be ordered with an R prefix number which insures our customers will receive RoHS compliant parts for their commercial electronics applications and equipment. Since most RoHS hazardous substances center around specific metal plating and lead solder coatings, ITT's products for RoHS compliance are available in the following plating finishes: black zinc electroless nickel, stainless steel, Anodize over aluminum and Gold plating. It should be noted that gold plating would be recommended as the replacement for tin-lead solder when ordering board mount connectors.



DL



- Plastic Body
- 60, 96, 156, or 260 Contact Cavities
- Single Hand Actuation
- Crimp or Square Post Contacts

Introduction 10
 Product Specifications 11
 How to Order 12
 Layout Information 13-16

DLM



- Metal Body
- EMI/RFI Shielding
- 60, 96, 156, 260 or 360 Contact Cavities
- Single Hand Actuation
- Crimp, Square Post or PC/RC Contacts

Introduction 21
 Product Specifications 22
 How to Order 23
 Layout Information 24-28

DLP



- Metal Body
- EMI/RFI Shielding
- Modular Landed Contact System
 (DLP-272 - 34 Contacts/Module
 DLP-408 - 68 Contacts/Module)
- Single Hand Actuation

Introduction 29
 Product Specifications 29
 How to Order 30
 Layout Information 31-32

QLC



- Metal Body
- EMI / RFI Shielding
- 260 Contacts
- Small form factor. For portable equipment

Introduction 33
 Product Specifications 33
 Layout Information 34

Accessories



- Cannon offers a large selection of accessories to meet a variety of application requirements
- Allows customization using standard components

Introduction 35
 Selection Guide 35
 Junction Shells, Plastic 36
 Backshells, Metal 38
 Actuating Handles 39
 Protective Covering 40
 Polarizing Posts 41
 Shells (EMI/RFI) 42

Contacts



- Crimp and Buss contacts are available loose or reeled
- Accommodates wire sizes #42-#18AWG
- Customer installed. Field installable/removable

Introduction 43
 Buss Contacts 44
 Crimp Contacts-Loose / Reeled 45

Tools and Assembly



- Cannon offers hand crimp tooling for low volume applications
- Contact extraction tools
- Automatic tooling can be leased for large volume applications

Introduction 46
 Hand Crimp Tools 46
 Extraction Tools 47
 Assembly Instructions 48-50
 Lease Automatic Tooling 51-52

PCB Hole Pattern and Pad Layout 53-60
 Panel Cutouts 61-67
 Contact Cavity Arrangements 64-66



| | DL | DLM | DLP 136 - 272 | DLP 408 | QLC |
|---|---|---|--|---|---|
| |  |  |  |  |  |
| Type | Plug & Receptacle | Plug & Receptacle | Plug & Receptacle | Plug & Receptacle | Plug & Receptacle |
| Body | Plastic | Metal | Metal | Metal | Metal |
| Body Material | Thermoplastic | Aluminum | Aluminum | Zinc Alloy | Zinc |
| Available Layouts | 60; 96; 156; and 260 signal | 60; 96; 156 260 and 360 signal | 136, 204 and 272 signal | 408 signal | 260 signal |
| Crimp Contacts | yes | yes | - | - | - |
| Square Post Contacts | yes | yes | - | - | - |
| PC/RC Contacts | - | yes | - | - | - |
| Pressfit Contacts | yes (1) | yes (2) | no | yes | no |
| Current Rating | 5 A max. (3) | 5 A max. (3) / 4 A max. (4) | 0,5 A max. | 0,3 A max | 0,5A max |
| Contact Resistance | 15 milliohms max. | 15 milliohms max. | 30 milliohms max. (Initial) | 30 milliohms max. (Initial) | 100 milliohms max (includes bulk resistance) |
| | 20 milliohms max. (5) | 20 milliohms max. (5) | | | |
| | | 30 milliohms max. (4) | | | |
| Contact Material | 20 or 50 μ inches gold plated copper alloy | 20 or 50 μ inches gold plated copper alloy | Gold plated copper Alloy | Gold plated copper Alloy | 40 μ inch gold plated copper alloy |
| Operating temperature | -55°C to 105°C | -55°C to 105°C | -55°C to 85°C | -55°C to 85°C | -55°C to 85°C |
| RoHS compliant | yes | yes | yes | yes | yes |
| Factory terminated | Solder to PCB Through Hole | Solder to PCB Through Hole | Solder to PCB Through Hole | Press-fit | Solder to PCB through hole |
| Mating cycles | 10.000 min. | 10.000 min. | 10,000 max | 10,000 max | 20,000 max |
| EMI/RFI shielding | - | yes | yes | yes | yes |
| Accessories See Pages 40-47 | | | | | |
| Actuating handles | yes | yes | yes | yes | yes |
| Protective Cover (Rubber) (6) | yes | yes | - | - | - |
| Protective Cover (Plastic) (7) | yes | yes | yes | - | - |
| Metals Shell for EMI/RFI shielding | yes (5) | - | - | - | - |
| Plastic Junction Shell | yes | yes | - | - | - |
| Cable Clamps | yes | yes | - | - | - |
| Metals Backshell | yes | yes | - | - | - |
| Polarizing Posts | yes | yes | - | - | - |
| Page number | 10-16 | 21-28 | 34-36 | 37 | 38-39 |

Notes:

- (1) DL5 only
- (2) DLM5 only
- (3) Crimp or Square Post Contacts
- (4) PC/RC contact
- (5) Specification for Crimp Contacts smaller than 28 AWG

The mechanical function of the new DLP ZIF connector

A quarter turn of knob (shaft) mates all the contact at once by the function of cam and bearing.

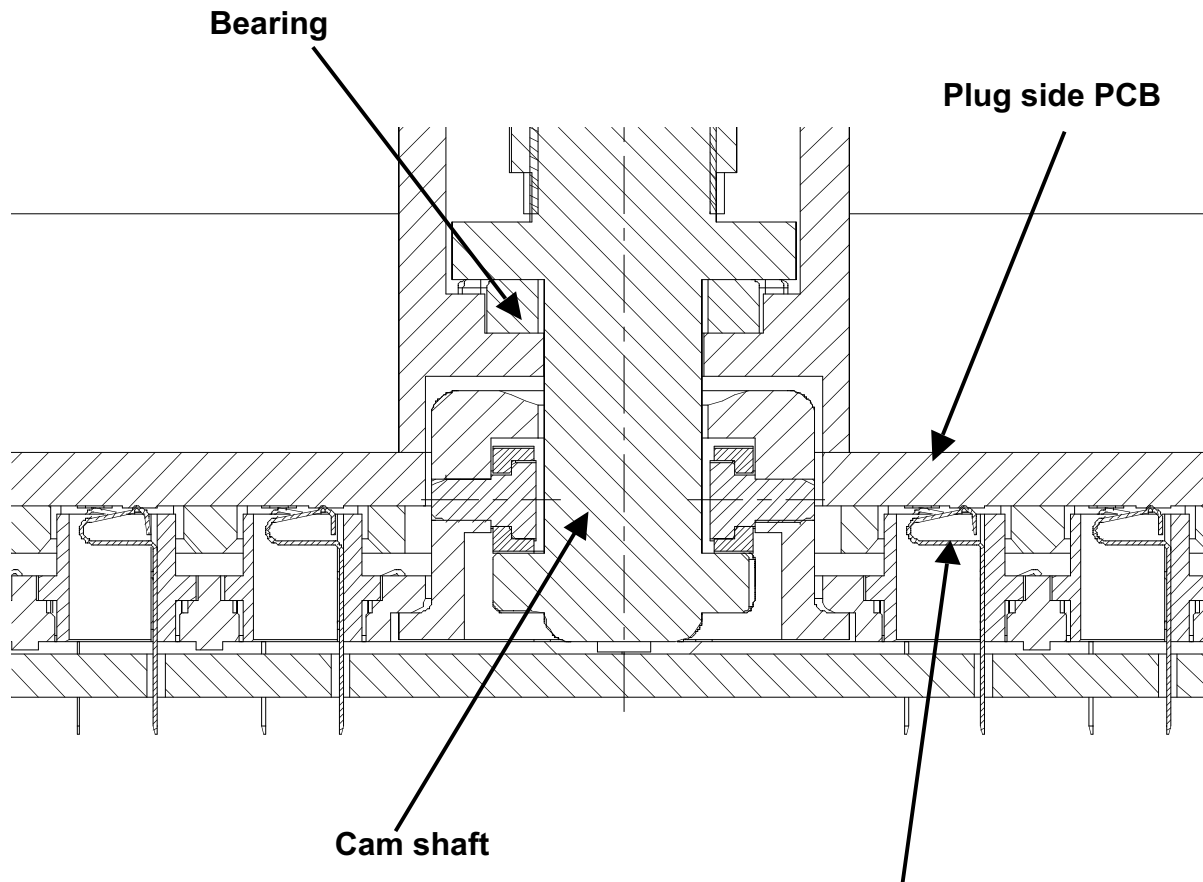

Our DLP connector uses our landed contact system. Modules of 34 or 68 contacts each are populated in to the receptacle to the customer's requirements. These contacts are positioned to land on pads that are designed into the customer supplied PCB and mounted to the plug connector housing. When mated, the contacts do not touch the pads on the plug PCB. Once the handle is rotated and locked, the shape of the receptacle contact generates a slight wipe on the plug PCB pads.

The long life and rapid mating are achieved through the use of our Zero Insertion Force design. Contact in the plug and receptacle do not touch each other while the connector halves are being engaged.

Step 1:

The plug is placed over the receptacle.

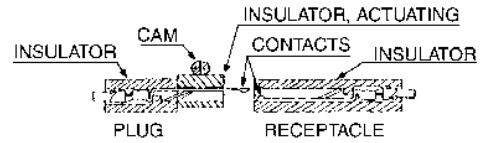
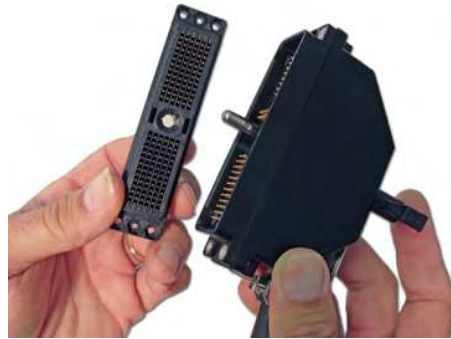

Step 2:

A "quarter turn" of an actuating shaft mates all contacts at once.

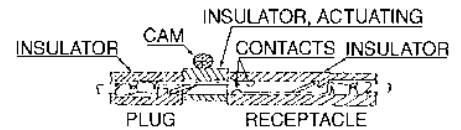
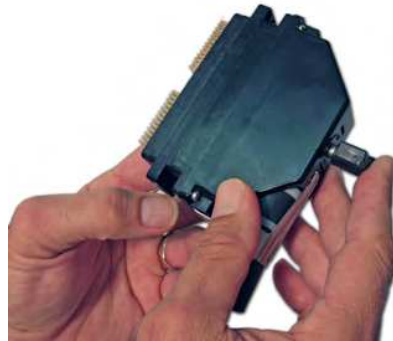

Step 3:

The same "quarter turn" also physically locks the connector halves together.

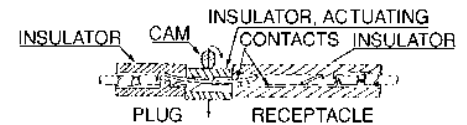

Connector engagement force is zero, and the only wear on the contacts occurs as they are pressed together and lightly wiped past each other during the camming and locking operation.



Medical

- Ultrasound Diagnostic
- Patient Monitoring
- Hospital Equipment
- MRI (Non-Magnetic)
- Portable Equipment (Imaging)

Commercial / Industrial Manufacturing

- Automation
- Robotics
- Electrical Controls

Telecommunications

- Systems Interconnect
- Manufacturing Test Equipment
- Switching Systems

Test & Instrument

- Avionics
- Automated Test Equipment
- Computer and Peripheral Equipment
- Semiconductor

Entertainment

- Recording Studio Equipment
- Stage Lighting and Sound
- Broadcasting Equipment

Transportation

- Locomotive Systems
- Automotive Electronics
- Aircraft Simulators

The Cannon DL Series of Zero Insertion Force (ZIF) connectors fill the need in the medical, commercial / industrial, computer, and peripheral equipment market places for low-cost, high performance, multiple-wire power and signal connectors.

DL connectors feature: a minimum rated life of 10,000 complete mating and unmating cycles with no performance loss; can be mated and unmated in less than two seconds even with as many as 624 contacts; and they cost less (often as much as 25% less) per mated line than singular high-density rack-and-panel connectors.

Simple. Effective. Reliable. Durable

Combining their special design with commercial-grade materials and low cost crimp, PCB, and wrappable hermaphroditic contacts, that may be hand or machine terminated, makes the DL Series of ZIF connectors the finest low-cost-per-mated-line I/O connectors available today.



Derating Curves

DL1

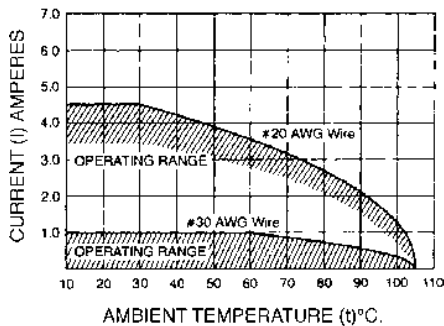

DL2

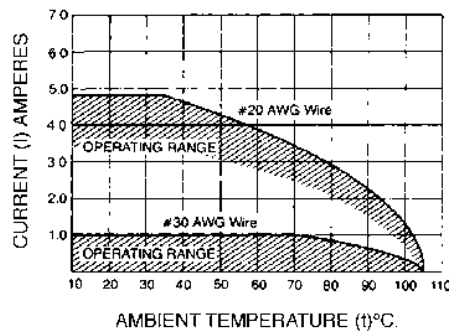

DL3

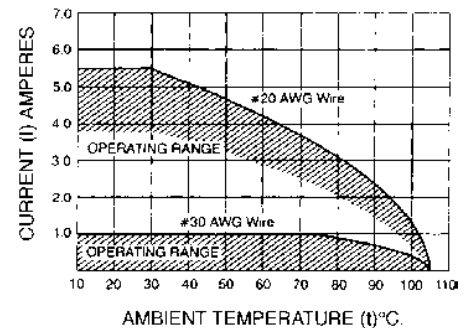

The ambient temperature curves shown represent the rated current carrying capacity of the Cannon DL1/2/3/4, electrical connectors, derated to 80% of the values recorded during the methods specified by International Electro-Technical Commission Document 48 (1975).

Current was applied to the total connector (all contacts) in one-half ampere increments and maintained at each current level until thermal stability was achieved. A thermocouple inserted into the "hottest area" of each connector then measured the connector temperature at the same time that an ambient temperature reading was taken. The difference between the two measured values is the heat rise or self-heating created solely by the current flow, and this temperature rise for the current level was deducted from the insulator material rated temperature. These values were then derated to 80% to obtain the curves shown.

Standard Materials and Finishes

| | |
|---|---|
| DL Housing: | Glass Filled Thermoplastic, UL 94V-1 rated, Color: Black |
| Crimp Contacts and Square Post Contacts: | - Copper alloy, 20 or 50 microinches gold over 50 microinches nickel in mated area, gold flash on balance |
| Actuating Camshaft: | Stainless steel, Passivated |
| Insulator Retainer (Plug Only) | Stainless steel, Passivated |

Electrical Data

| | |
|-----------------------------|---|
| No. of Contacts: | 60, 96, 156, and 260 signal |
| Wire Size: | #18 AWG through #42 AWG |
| Contact Termination: | - Crimp - Square Post - Wrap Post - Buss - Pressfit |

Mechanical Data

| | |
|-------------------------|--------------------------|
| Actuation: | Single Hand |
| Coupling: | Rotating latch |
| Polarization: | Polarizing Posts |
| Contact Spacing: | 2,54 (0.100) Square Grid |
| Shell Styles: | Plug and Receptacle |

Performance Data

| | |
|---|--|
| Current Rating: | 5 A max - Crimp/Square Post/PCB contact 10 A, 20 A, 30 A, 40 A, 50 A, 60 A max - Buss contact |
| Dielectric Withstanding Voltage: | 1200 VAC RMS - Crimp/Square Post Contact |
| Operating Temperature: | -55°C to 105°C (DL/DLM/DLD) |
| Insulation Resistance: | 5000 Megaohms minimum |
| Durability: | 10,000 Cycles minimum |
| Contact Resistance: | 15 mΩ max. - Crimp/Square Post Contact 20 mΩ max. - Crimp #32 AWG - #30 AWG Contact |
| Insulation Resistance: | 5000 MΩ min. |
| Wire Accommodation: | #42 AWG - #18 AWG |
| Contact Retention: | 8 lb (35.585 N) minimum |

How to Order

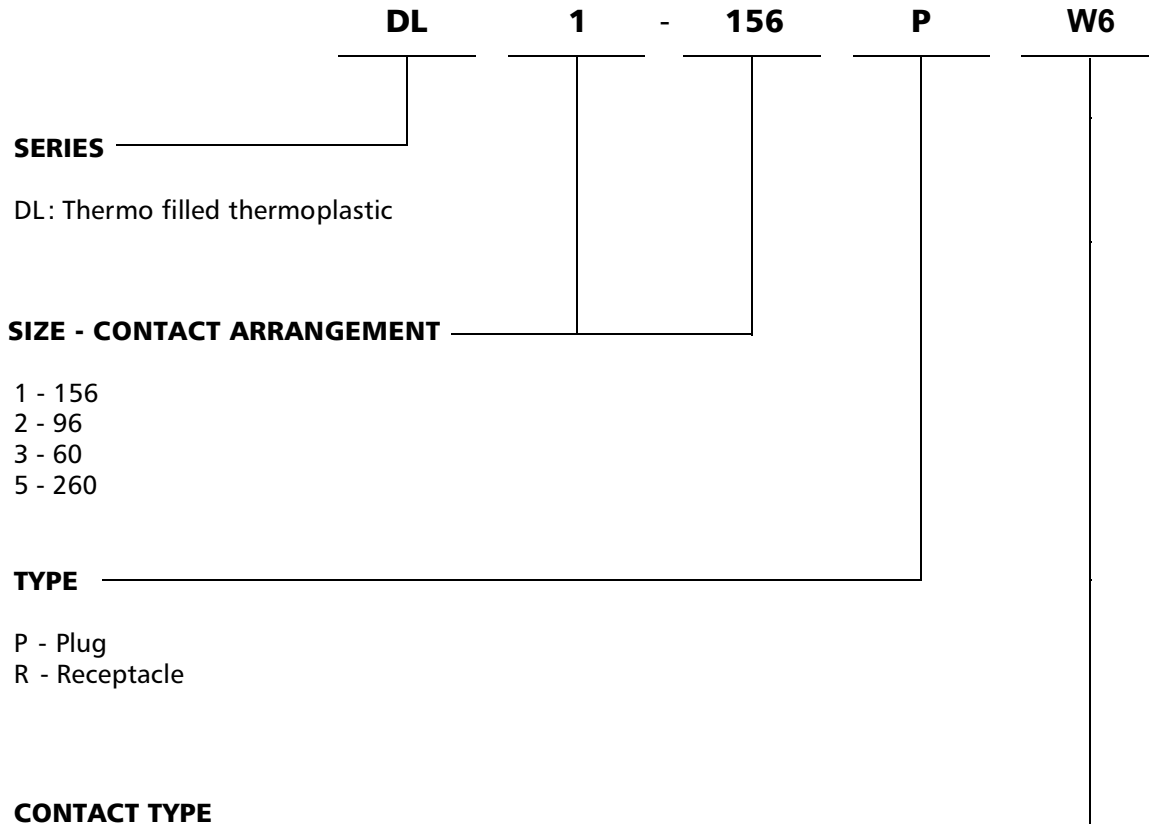

- W4 - Wrap Post 15,37 (0.605), 20 μ inches Gold
- W4A - Wrap Post 15,37 (0.605), 50 μ inches Gold, Plug only
- W4B - Wrap Post 15,37 (0.605), 50 μ inches Gold, Receptacle only
- W6 - Square Post 7,11 (0.280), 20 μ inches Gold
- W6A - Square Post 7,11 (0.280), 50 μ inches Gold, Plug only
- W6B - Square Post 7,11 (0.280), 50 μ inches Gold, Receptacle only
- W9A - Square Post 3,18 (0.125), 50 μ inches Gold, Plug only
- W9B - Square Post 3,18 (0.125), 50 μ inches Gold, Receptacle only
- F - Pressfit, 20 μ inches Gold, DL5 Receptacle only



Plug



- Order Actuating Handle Kit sold separately, see page 44.
- Crimp Contacts are to be ordered separately and to be installed by customer, see pages 48-50.
- For contact cavity arrangements see pages 69-70.
- For panel cutout and mounting hole pattern, see page 66.
- For PC hole pattern, see pages 59-61.

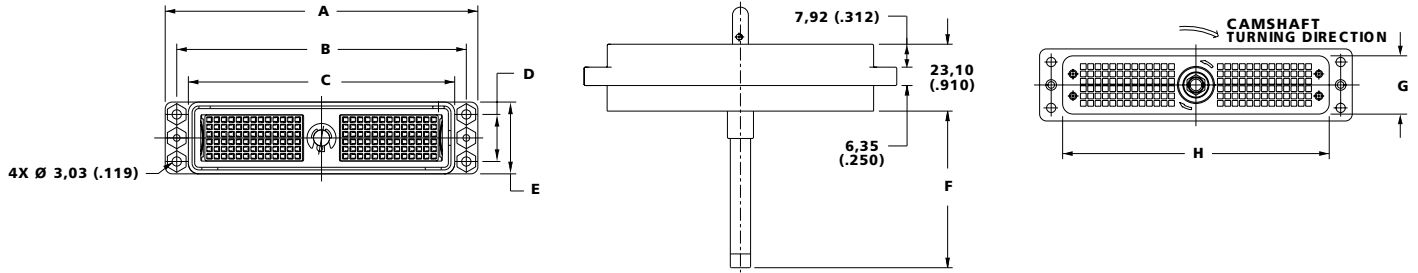

| Description | A | B | C | D | E | F | G | H |
|-----------------|-------------------|-------------------|------------------|------------------|------------------|------------------|------------------|------------------|
| DL3-60P | 65,80 (2.592) | 57,91 (2.280) | 50,55 (1.992) | 11,89 (0.466) | 24,90 (0.981) | 39,19 (1.543) | 24,90 (0.981) | 49,02 (1.931) |
| DL2-96P | 65,80 (2.592) | 57,91 (2.280) | 50,60 (1.994) | 19,38 (.763) | 28,12 (1.108) | 39,19 (1.543) | 24,05 (0.947) | 50,60 (1.994) |
| DL1-156P | 108,00 (4.255) | 100,03 (3.938) | 92,26 (3.631) | 16,26 (0.640) | 24,90 (0.980) | 54,81 (2.158) | 20,10 (0.792) | 92,10 (3.626) |
| DL5-260P | 108,00 (4.255) | 100,03 (3.938) | 92,26 (3.631) | 26,00 (1.024) | 35,00 (1.378) | 54,26 (2.136) | 30,30 (1.193) | 92,10 (3.626) |

Receptacle



- Crimp Contacts are to be ordered separately and to be installed by customer, see pages 48-50.
- For contact cavity arrangements see pages 69-70.
- For panel cutout and mounting hole pattern, see page 66.
- For PC hole pattern, see pages 59-61.

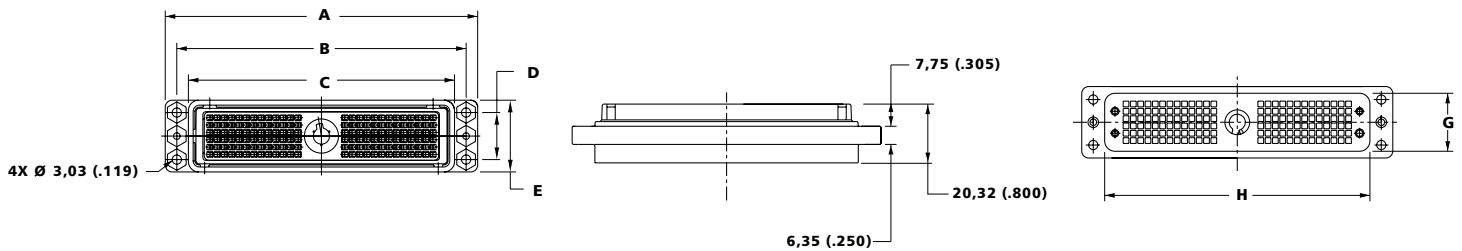

| Description | A | B | C | D | E | G | H |
|-----------------|-------------------|-------------------|------------------|------------------|------------------|------------------|------------------|
| DL3-60R | 65,80 (2.592) | 57,91 (2.280) | 50,50 (1.988) | 11,89 (0.468) | 24,90 (0.981) | 19,18 (0.755) | 49,02 (1.931) |
| DL2-96R | 65,80 (2.592) | 57,91 (2.280) | 50,60 (1.994) | 19,38 (.763) | 28,12 (1.108) | 24,05 (0.947) | 50,60 (1.994) |
| DL1-156R | 108,00 (4.255) | 100,03 (3.938) | 92,10 (3.622) | 16,26 (0.640) | 24,90 (0.980) | 20,10 (0.792) | 92,10 (3.626) |
| DL5-260R | 108,00 (4.255) | 100,03 (3.938) | 92,10 (3.622) | 26,00 (1.024) | 35,00 (1.378) | 30,30 (1.193) | 92,10 (3.626) |

Notes:
Crimp contacts are to be ordered separately and to be installed by customer, see pages 49-50.

Dimensions shown in mm (inch)
Specifications and dimensions subject to change

Cannon ZIF Connectors

DL - Plastic Body - Square / Wrap Post Contacts

Plug



- Order Actuating Handle Kit sold separately, see page 44.
- For contact cavity arrangements see pages 69-70.
- For panel cutout and mounting hole pattern, see page 66.
- For PC hole pattern, see pages 59-61.

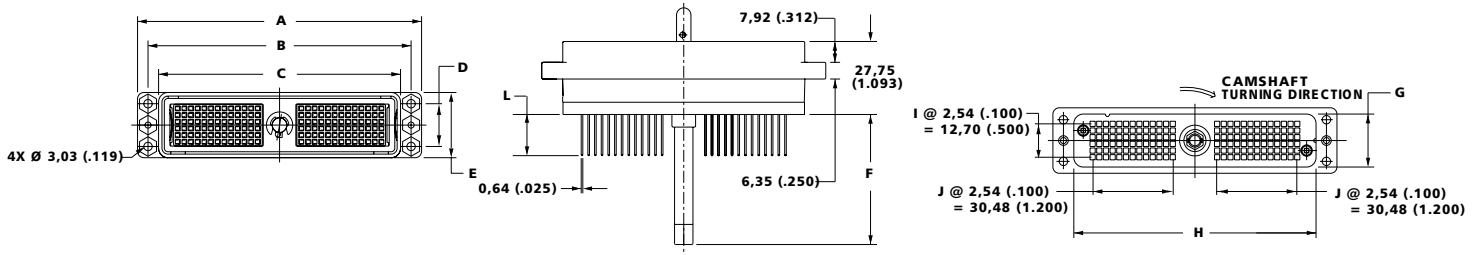

| Description | A | B | C | D | E | F | G | H | I | J | L |
|---|-------------------|-------------------|------------------|------------------|------------------|------------------|------------------|------------------|-------------|--------------|-----------------|
| DL3-60PW4 DL3-60PW4A | 65,80 (2.592) | 57,91 (2.280) | 50,55 (1.992) | 11,89 (.468) | 24,90 (.981) | 34,54 (1.360) | 19,94 (.785) | 49,02 (1.931) | 5 spaces | 4 spaces | 15,37 (.605) |
| DL3-60PW6 DL3-60PW6A | 65,80 (2.592) | 57,91 (2.280) | 50,55 (1.992) | 11,89 (.468) | 24,90 (.981) | 34,54 (1.360) | 19,94 (.785) | 49,02 (1.931) | 5 spaces | 4 spaces | 7,11 (.280) |
| DL3-60PW9A | 65,80 (2.592) | 57,91 (2.280) | 50,55 (1.992) | 11,89 (.468) | 24,90 (.981) | 34,54 (1.360) | 19,94 (.785) | 49,02 (1.931) | 5 spaces | 4 spaces | 3,18 (.125) |
| DL2-96PW4 DL2-96PW4A | 65,80 (2.592) | 57,91 (2.280) | 50,60 (1.994) | 19,38 (.763) | 28,12 (1.108) | 34,54 (1.360) | 24,05 (.947) | 50,60 (1.994) | 7 spaces | 6 spaces | 15,37 (.605) |
| DL2-96PW6 DL2-96PW6A | 65,80 (2.592) | 57,91 (2.280) | 50,60 (1.994) | 19,38 (.763) | 28,12 (1.108) | 34,54 (1.360) | 24,05 (.947) | 50,60 (1.994) | 7 spaces | 6 spaces | 7,11 (.280) |
| DL2-96PW9A | 65,80 (2.592) | 57,91 (2.280) | 50,60 (1.994) | 19,38 (.763) | 28,12 (1.108) | 34,54 (1.360) | 24,05 (.947) | 50,60 (1.994) | 7 spaces | 6 spaces | 3,18 (.125) |
| DL1-156PW4 DL1-156PW4A | 108,00 (4.255) | 100,03 (3.983) | 92,26 (3.631) | 16,26 (.640) | 24,90 (.981) | 50,16 (1.975) | 20,10 (.792) | 92,10 (3.626) | 5 spaces | 12 spaces | 15,37 (.605) |
| DL1-156PW6 DL1-156PW6A | 108,00 (4.255) | 100,03 (3.983) | 92,26 (3.631) | 16,26 (.640) | 24,90 (.981) | 50,16 (1.975) | 20,10 (.792) | 92,10 (3.626) | 5 spaces | 12 spaces | 7,11 (.380) |
| DL1-156PW9A | 108,00 (4.255) | 100,03 (3.983) | 92,26 (3.631) | 16,26 (.640) | 24,90 (.981) | 50,16 (1.975) | 20,10 (.792) | 92,10 (3.626) | 5 spaces | 12 spaces | 3,18 (.125) |
| DL5-260PW4 DL5-260PW4A | 108,00 (4.255) | 100,03 (3.983) | 92,26 (3.631) | 26,00 (1.024) | 35,00 (1.378) | 49,61 (1.953) | 30,30 (1.193) | 92,10 (3.626) | 9 spaces | 12 spaces | 15,37 (.604) |
| DL5-260PW6 DL5-260PW6A | 108,00 (4.255) | 100,03 (3.983) | 92,26 (3.631) | 26,00 (1.024) | 35,00 (1.378) | 49,61 (1.953) | 30,30 (1.193) | 92,10 (3.626) | 9 spaces | 12 spaces | 7,11 (.280) |
| DL5-260PW9A | 108,00 (4.255) | 100,03 (3.983) | 92,26 (3.631) | 26,00 (1.024) | 35,00 (1.378) | 49,61 (1.953) | 30,30 (1.193) | 92,10 (3.626) | 9 spaces | 12 spaces | 3,18 (.125) |

Notes:
Front removable 0,64 (0.025) square posts 2,54 (0.100) Centers.
1 space at 2,54 (0.100)

Dimensions shown in mm (inch)
Specifications and dimensions subject to change



Receptacle



- For contact cavity arrangements see pages 69-70.
- For panel cutout and mounting hole pattern, see page 66.
- For PC hole pattern, see pages 59-61.

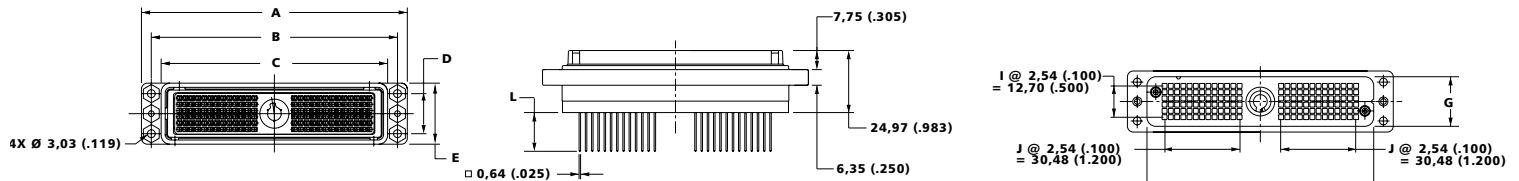

| Description | A | B | C | D | E | G | H | I | J | L |
|---|-------------------|-------------------|------------------|------------------|------------------|------------------|------------------|-------------|--------------|-----------------|
| DL3-60RW4 DL3-60RW4B | 65,80 (2.592) | 57,91 (2.280) | 50,50 (1.988) | 11,89 (.466) | 24,90 (.980) | 19,94 (.785) | 49,02 (1.931) | 5 spaces | 4 spaces | 15,37 (.605) |
| DL3-60RW6 DL3-60RW6B | 65,80 (2.592) | 57,91 (2.280) | 50,50 (1.988) | 11,89 (.466) | 24,90 (1.360) | 19,94 (.785) | 49,02 (1.931) | 5 spaces | 4 spaces | 7,11 (.280) |
| DL3-60RW9B | 65,80 (2.592) | 57,91 (2.280) | 50,50 (1.988) | 11,89 (.466) | 24,90 (1.360) | 19,94 (.785) | 49,02 (1.931) | 5 spaces | 4 spaces | 3,18 (.125) |
| DL2-96TW4 DL2-96RW4B | 65,80 (2.592) | 57,91 (2.280) | 50,60 (1.994) | 19,38 (.763) | 28,12 (1.108) | 24,05 (.947) | 50,60 (1.994) | 7 spaces | 6 spaces | 15,37 (.605) |
| DL2-96RW6 DL2-96RW6B | 65,80 (2.592) | 57,91 (2.280) | 50,60 (1.994) | 19,38 (.763) | 28,12 (1.108) | 24,05 (.947) | 50,60 (1.994) | 7 spaces | 6 spaces | 7,11 (.280) |
| DL2-96RW9B | 65,80 (2.592) | 57,91 (2.280) | 50,60 (1.994) | 19,38 (.763) | 28,12 (1.108) | 24,05 (.947) | 50,60 (1.994) | 7 spaces | 6 spaces | 3,18 (.125) |
| DL1-156RW4 DL1-156RW4B | 108,00 (4.255) | 100,03 (3.983) | 92,00 (3.622) | 16,26 (.640) | 24,90 (.980) | 20,10 (.792) | 92,10 (3.626) | 5 spaces | 12 spaces | 15,37 (.605) |
| DL1-156RW6 DL1-156RW6B | 108,00 (4.255) | 100,03 (3.983) | 92,00 (3.622) | 16,26 (.640) | 24,90 (.980) | 20,10 (.792) | 92,10 (3.626) | 5 spaces | 12 spaces | 7,11 (.380) |
| DL1-156RW9B | 108,00 (4.255) | 100,03 (3.983) | 92,00 (3.622) | 16,26 (.640) | 24,90 (.980) | 20,10 (.792) | 92,10 (3.626) | 5 spaces | 12 spaces | 3,18 (.125) |
| DL5-260RW4 DL5-260RW4B | 108,00 (4.255) | 100,03 (3.983) | 92,00 (3.622) | 26,00 (1.024) | 35,00 (1.378) | 30,30 (1.193) | 92,10 (3.626) | 9 spaces | 12 spaces | 15,37 (.604) |
| DL5-260RW6 DL5-260RW6B | 108,00 (4.255) | 100,03 (3.983) | 92,00 (3.622) | 26,00 (1.024) | 35,00 (1.378) | 30,30 (1.193) | 92,10 (3.626) | 9 spaces | 12 spaces | 7,11 (.280) |
| DL5-260RW9B | 108,00 (4.255) | 100,03 (3.983) | 92,00 (3.622) | 26,00 (1.024) | 35,00 (1.378) | 30,30 (1.193) | 92,10 (3.626) | 9 spaces | 12 spaces | 3,18 (.125) |

Notes:

Front removable 0,64 (0.025) square posts 2,54 (0.100) Centers.
1 space at 2,54 (0.100)

Dimensions shown in mm (inch)
Specifications and dimensions subject to change

www.ittcannon.com



Receptacle only



- For contact cavity arrangements see page 70.
- For panel cutout and mounting hole pattern, see page 66.
- For PC hole pattern, see page 62.

| Part Number | Nomenclature |
|-------------|--------------|
| 11987-0008 | DL5-260R-F |

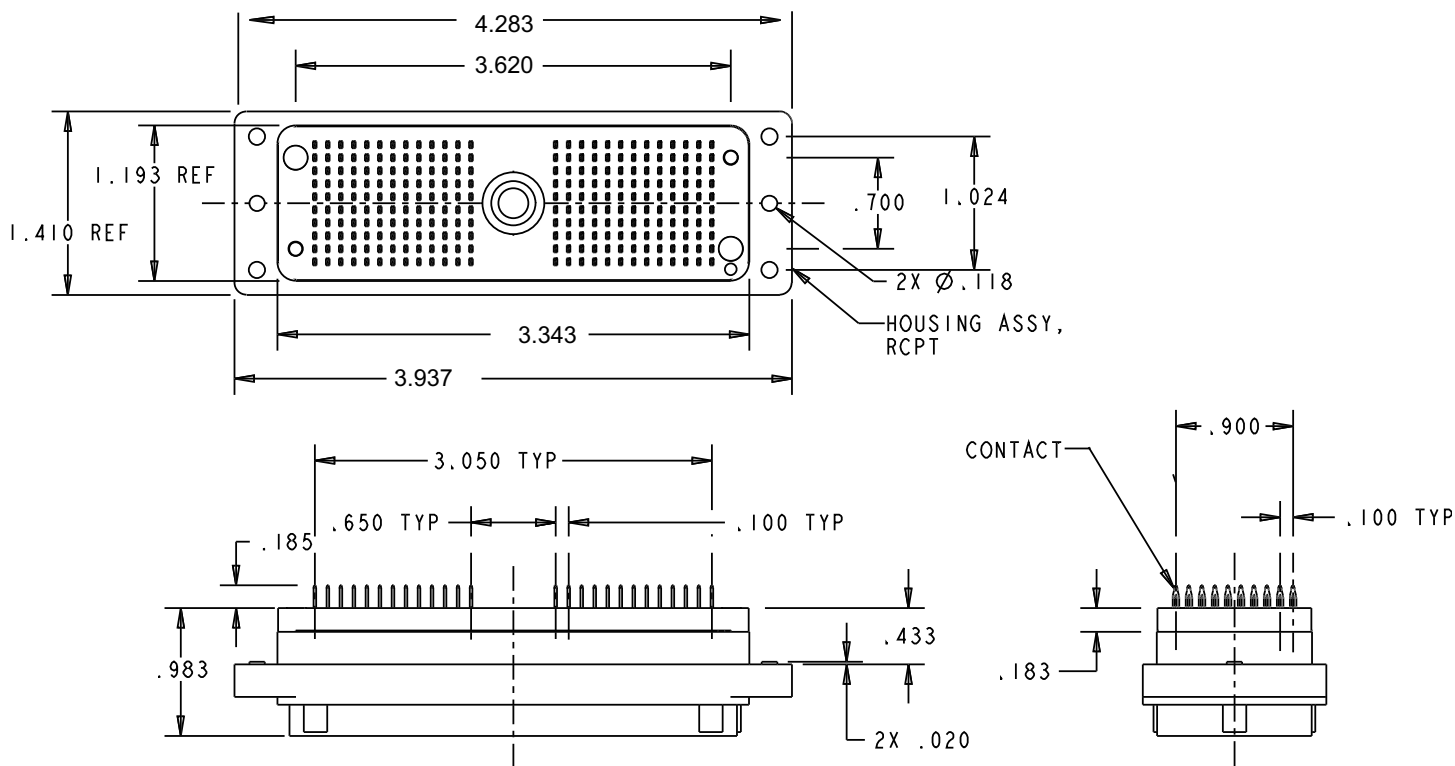

Cannon has combined Zero Insertion Force (ZIF) technology with remote electrical engagement. The DLD Drawer allows the movement of a drawer or panel to effortlessly mate/unmate the connector halves. As an example: electrical sub-systems can be easily removed for service, interchangeability, or portability.

By specifying DLD Drawer interconnect systems, your packaging design is simplified as the need for expensive, complicated, and space-consuming manual actuation mechanisms is eliminated. Tight space requirements no longer restrict your use of ZIF connectors.

The contacts in the DLD Drawer product line do not touch each other while the connector halves are mating. This unique ZIF technology, introduced in the Cannon DL series in the early 1970's, has time-tested proven reliability and durability.

The DLD Drawer's remote mating feature utilizes the axial thrust of a cam to move and mate the contacts. At the end of the cam travel, the cam ramps on a flat surface thereby negating any uncoupling forces.

This rack-and-panel connector is available with crimp or square post contacts, allowing cable, PCB, or flat-flex termination.



Standard Materials and Finishes

| | |
|-----------------------------------|---|
| DLD Housing: | Glass Filled Thermoplastic, UL 94V-1 rated, Color: Black |
| Crimp Contacts: | Copper alloy, 20 or 50 microinches gold over 50 microinches nickel in mated area, gold flash on balance |
| Insulator Retainer (1): | Stainless steel, Passivated |
| Actuating Camshaft (2): | Stainless steel |
| Spring Mounting Screw (2): | Stainless steel, Passivated |

Electrical Data

| | |
|-----------------------------|-------------------------------------|
| No. of Contacts: | 96 and 156 signal |
| Wire Size: | #18 AWG through #42 AWG |
| Contact Termination: | Crimp, Square Post, Wrap Post, Buss |

Mechanical Data

| | |
|-------------------------|-------------------------|
| Actuation: | Sliding |
| Coupling: | Guide Cam |
| Polarization: | Polarizing Posts |
| Contact Spacing: | 2,54 (.100) Square Grid |
| Shell Styles: | Plug and Receptacle |

Performance Data

| | |
|---|---|
| Dielectric Withstanding Voltage: | 1200 VAC RMS - Crimp/Square Post Contact |
| Insulation Resistance | 5000 Megaohms minimum |
| Durability: | 100,000 Cycles minimum |
| Contact Resistance: | - 15 milliohms maximum - Crimp/Square Post Contact - 20 milliohms maximum - Crimp #30- #32 AWG contact |
| Contact Retention: | 6 lb (35,564 N) minimum |

How to Order

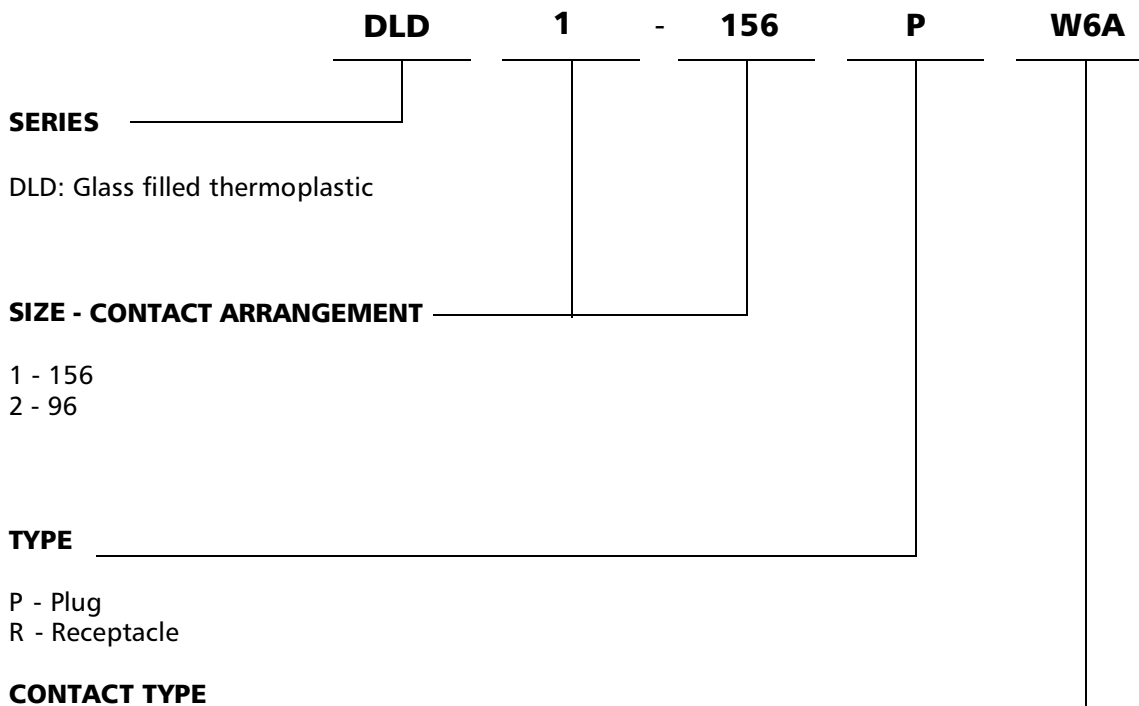

No letter - Crimp #18 thru #42 AWG
TO BE ORDERED SEPARATELY AND INSTALLED BY CUSTOMER

- W4 - Wrap Post 15,37 (0.605), 20 μinches Gold
- W4A - Wrap Post 15,37 (0.605), 50 μinches Gold, Plug only
- W4B - Wrap Post 15,37 (0.605), 50 μinches Gold, Receptacle only
- W6 - Square Post 7,11 (0.280), 20 μinches Gold
- W6A - Square Post 7,11 (0.280), 50 μinches Gold, Plug only
- W6B - Square Post 7,11 (0.280), 50 μinches Gold, Receptacle only
- W9A - Square Post 3,18 (0.125), 50 μinches Gold
- W9B - Square Post 3,18 (0.125), 50 μinches Gold, Receptacle only

Plug



- Crimp contacts are to be ordered separately and to be installed by customer, see pages 48-50.
- For contact cavity arrangements see page 69.
- For panel cutout and mounting hole pattern, see pages 67-68.

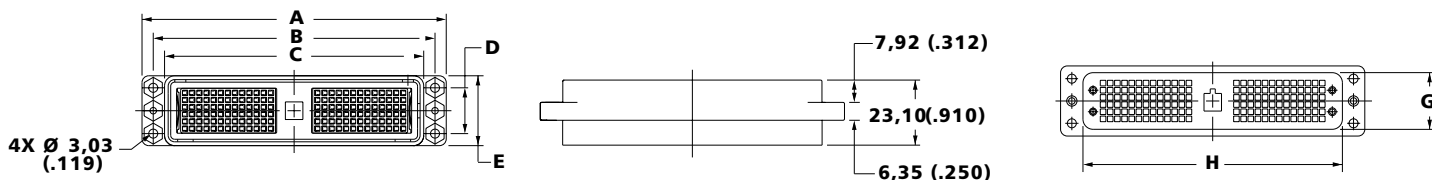

| Description | A | B | C | D | E | G | H |
|------------------|-------------------|-------------------|------------------|------------------|------------------|------------------|------------------|
| DLD2-96P | 65,80 (2.592) | 57,91 (2.280) | 50,60 (1.994) | 19,38 (0.763) | 26,12 (1.108) | 24,05 (0.947) | 50,60 (1.994) |
| DLD1-156P | 108,00 (4.255) | 100,03 (3.983) | 92,26 (3.631) | 16,26 (0.640) | 24,90 (0.980) | 20,10 (0.792) | 92,10 (3.626) |

Receptacle



- Crimp contacts are to be ordered separately and to be installed by customer, see pages 48-50.
- For contact cavity arrangements see page 69.
- For panel cutout and mounting hole pattern, see pages 67-68.

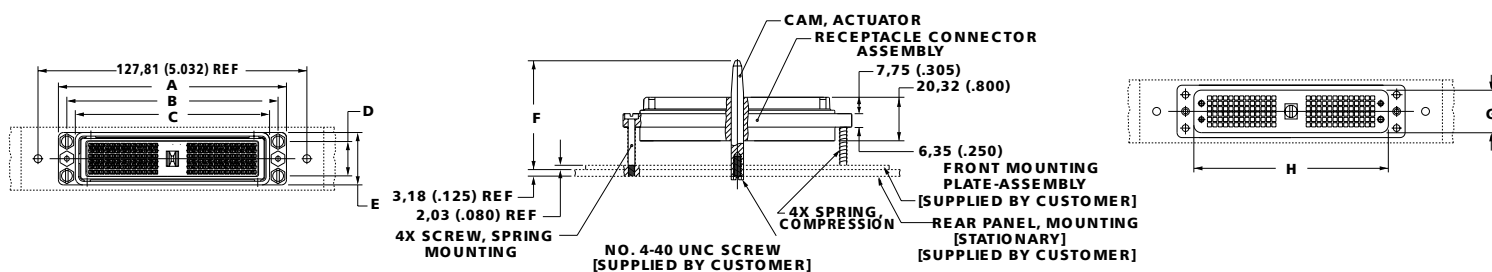

| Description | A | B | C | D | E | F | G | H |
|-----------------|-------------------|-------------------|------------------|------------------|------------------|------------------|------------------|------------------|
| DLD2-96R | 65,80 (2.592) | 57,91 (2.280) | 50,60 (1.994) | 19,38 (.763) | 28,12 (1.108) | 46,87 (1.845) | 24,05 (0.947) | 50,60 (1.994) |
| DLD-156R | 108,00 (4.255) | 100,03 (3.983) | 92,00 (3.622) | 16,26 (0.640) | 24,90 (0.980) | 46,86 (1.845) | 20,10 (0.792) | 92,10 (3.626) |

Dimensions shown in mm (inch)
Specifications and dimensions subject to change

Cannon ZIF Connectors

DLD - Plastic Body - Square / Wrap Post Contacts

Plug



- For contact cavity arrangements see page 69.
- For panel cutout and mounting hole pattern, see pages 67-68.
- For PC hole pattern, see pages 60-61.

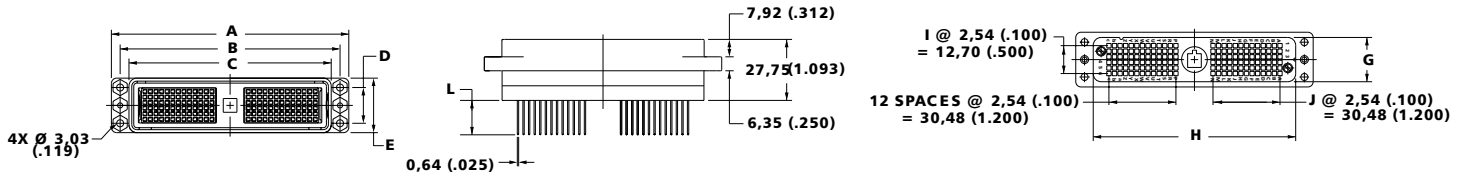

| Description | A | B | C | D | E | G | H | I | J | L |
|---|-------------------|-------------------|------------------|-----------------|------------------|-----------------|------------------|-------------|--------------|-----------------|
| DLD2-96PW4 DLD2-96PW4A | 65,80 (2.592) | 57,91 (2.280) | 50,60 (1.994) | 19,38 (.763) | 28,12 (1.108) | 24,05 (.947) | 50,60 (1.994) | 7 spaces | 6 spaces | 15,37 (.605) |
| DLD2-96PW6 DLD2-96PW6A | 65,80 (2.592) | 57,91 (2.280) | 50,60 (1.994) | 19,38 (.763) | 28,12 (1.108) | 24,05 (.947) | 50,60 (1.994) | 7 spaces | 6 spaces | 7,11 (.280) |
| DLD2-96PW9A | 65,80 (2.592) | 57,91 (2.280) | 50,60 (1.994) | 19,38 (.763) | 28,12 (1.108) | 24,05 (.947) | 50,60 (1.994) | 7 spaces | 6 spaces | 3,18 (.125) |
| DLD1-156PW4 DLD1-156PW4A | 108,00 (4.255) | 100,03 (3.983) | 92,26 (3.631) | 16,26 (.640) | 24,80 (.977) | 20,10 (.792) | 92,10 (3.626) | 5 spaces | 12 spaces | 15,37 (.605) |
| DLD1-156PW6 DLD1-156PW6A | 108,00 (4.255) | 100,03 (3.983) | 92,26 (3.631) | 16,26 (.640) | 24,90 (.980) | 20,10 (.792) | 92,10 (3.626) | 5 spaces | 12 spaces | 7,11 (.280) |
| DLD1-156PW9A | 108,00 (4.255) | 100,03 (3.983) | 92,26 (3.631) | 16,26 (.640) | 24,90 (.980) | 20,10 (.792) | 92,10 (3.626) | 5 spaces | 12 spaces | 3,18 (.125) |

Receptacle



- For contact cavity arrangements see page 69.
- For panel cutout and mounting hole pattern, see pages 67-68.
- For PC hole pattern, see pages 60-61.

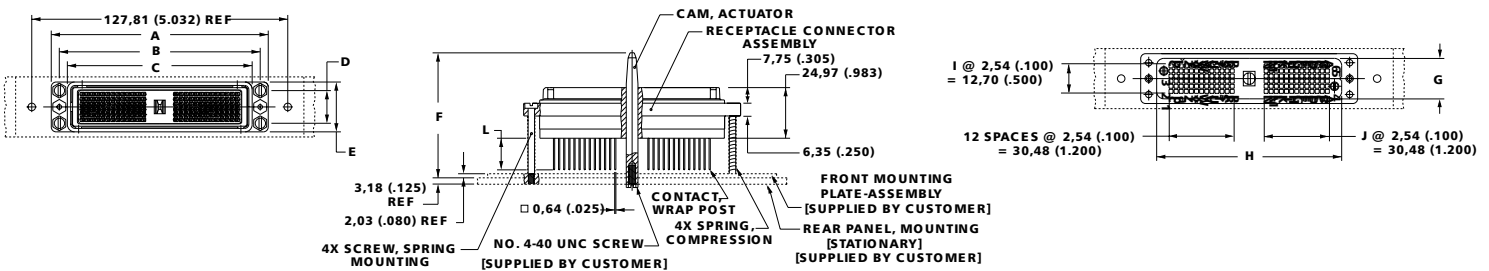

| Description | A | B | C | D | E | F | G | H | I | J | L |
|---|-------------------|-------------------|------------------|-----------------|------------------|------------------|-----------------|------------------|-------------|--------------|------------------|
| DLD2-96RW4 DLD2-96RW4B | 65,80 (2.592) | 57,91 (2.280) | 50,60 (1.994) | 19,38 (.763) | 28,12 (1.108) | 57,03 (1.245) | 24,05 (.947) | 50,60 (1.994) | 7 spaces | 6 spaces | 15,37 (0.605) |
| DLD2-96RW6 DLD2-96RW6B | 65,80 (2.592) | 57,91 (2.280) | 50,60 (1.994) | 19,38 (.763) | 26,12 (1.108) | 57,03 (1.245) | 24,05 (.947) | 50,60 (1.994) | 7 spaces | 6 spaces | 7,11 (0.280) |
| DLD1-156RW4 DLD1-156RW4B | 108,00 (4.255) | 100,03 (3.983) | 92,26 (3.631) | 16,26 (.640) | 24,80 (.977) | 57,03 (1.245) | 20,10 (.792) | 92,10 (3.626) | 5 spaces | 12 spaces | 15,37 (0.605) |
| DLD1-156RW6 DLD1-156RW6B | 108,00 (4.255) | 100,03 (3.983) | 92,00 (3.622) | 16,26 (.640) | 24,90 (.980) | 57,03 (1.245) | 20,10 (.792) | 92,10 (3.626) | 5 spaces | 12 spaces | 7,11 (0.380) |
| DLD1-156RW9A | 108,00 (4.255) | 100,03 (3.983) | 92,00 (3.622) | 16,26 (.640) | 24,90 (.980) | 57,03 (1.245) | 20,10 (.792) | 92,10 (3.626) | 5 spaces | 12 spaces | 7,11 (0.380) |



Dimensions shown in mm (inch)
Specifications and dimensions subject to change

www.ittcannon.com

Cannon has expanded the DL-ZIF series offering with the addition of the DLM (Metal Shell) versions. The DLM uses a rugged nickel plated aluminum housing. The Shield-Locking Mechanism feature (see illustration below) ensures uniform mating pressure around the perimeter of the mated connector to create an EMI/RFI shield which facilitates compliance of equipment to CE EMC directives.



The DLM Series connectors are intermateable to the DL (Plastic) versions for backwards/forwards compatibility. The DLM Series are offered with all of the DL plastic contacts from crimp, square post, and round PL/RC tail contacts.

Derating Curves

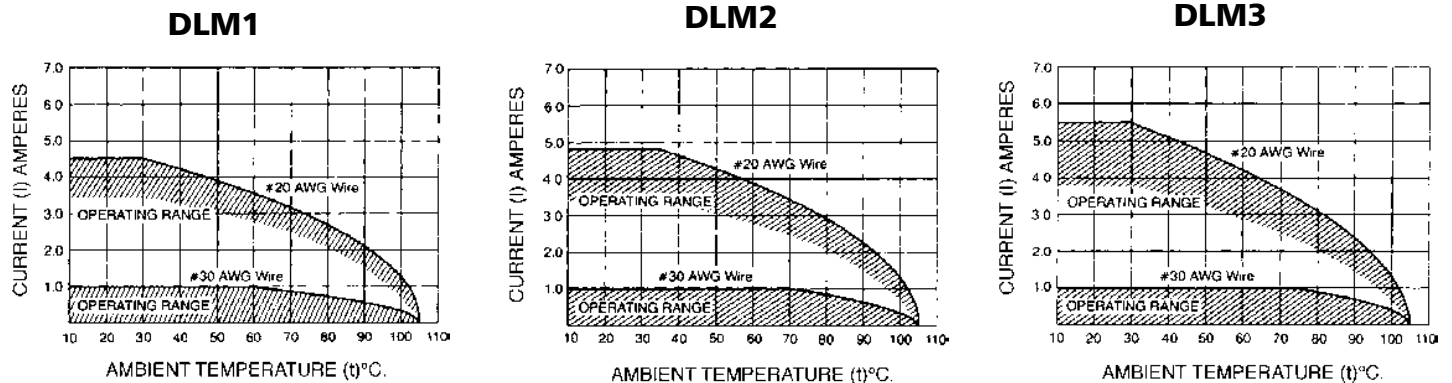

The ambient temperature curves shown represent the rated current carrying capacity of the Cannon DL1/2/3/4, DLM1/2/3 and DLD1/2 electrical connectors, derated to 80% of the values recorded during the methods specified by International Electro-Technical Commission Document 48 (1975).

Current was applied to the total connector (all contacts) in one-half ampere increments and maintained at each current level until thermal stability was achieved. A thermocouple inserted into the "hottest area" of each connector then measured the connector temperature at the same time that an ambient temperature reading was taken. The difference between the two measured values is the heat rise or self-heating created solely by the current flow, and this temperature rise for the current level was deducted from the insulator material rated temperature. These values were then derated to 80% to obtain the curves shown.

Standard Materials and Finishes

| | |
|---|---|
| DLM Housing: | Aluminum alloy, nickel plated |
| DLM Insulator Crimp Contacts and Square Post Contacts: | Copper alloy, 20 or 50 microinches gold over 50 microinches nickel in mated area, gold flash on balance |
| PC/RC Contacts: | Copper alloy, 20 microinches gold over nickel in mated area, Sn over Nickel in tail area |
| Actuating Camshaft: | Stainless steel, Passivated |
| Insulator Retainer (Plug only): | Stainless steel, Passivated |

Electrical Data

| | |
|-----------------------------|--|
| No. of Contacts: | 60, 96, 156, 260 and 360 signal |
| Wire Size: | #18 AWG through #42 AWG |
| Contact Termination: | <ul style="list-style-type: none"> - PC/RC - Crimp - Square Post - Wrap Post - Buss - Pressfit |

Mechanical Data

| | |
|-------------------------|-------------------------|
| Actuation: | Single Hand |
| Coupling: | Rotating Latch |
| Polarization: | Polarizing Posts |
| Contact Spacing: | 2,54 (.100) Square Grid |
| Shell Styles: | Plug and Receptacle |
| Actuation: | Single Hand |

Performance Data

| | |
|---|---|
| Dielectric Withstanding Voltage: | 1200 VAC RMS - Crimp/Square Post Contact 1000 VAC RMS - PC/RC Contacts |
| Insulation Resistance | 5000 Megaohms minimum |
| Durability: | 10,000 Cycles minimum |
| Contact Resistance: | <ul style="list-style-type: none"> - 15 milliohms maximum - Crimp/Square Post Contact - 20 milliohms maximum - Crimp #30- #32 AWG contact - 30 milliohms maximum - PC/RC Contact |
| Contact Retention: | 8 lb (35,585 N) minimum |



How to Order

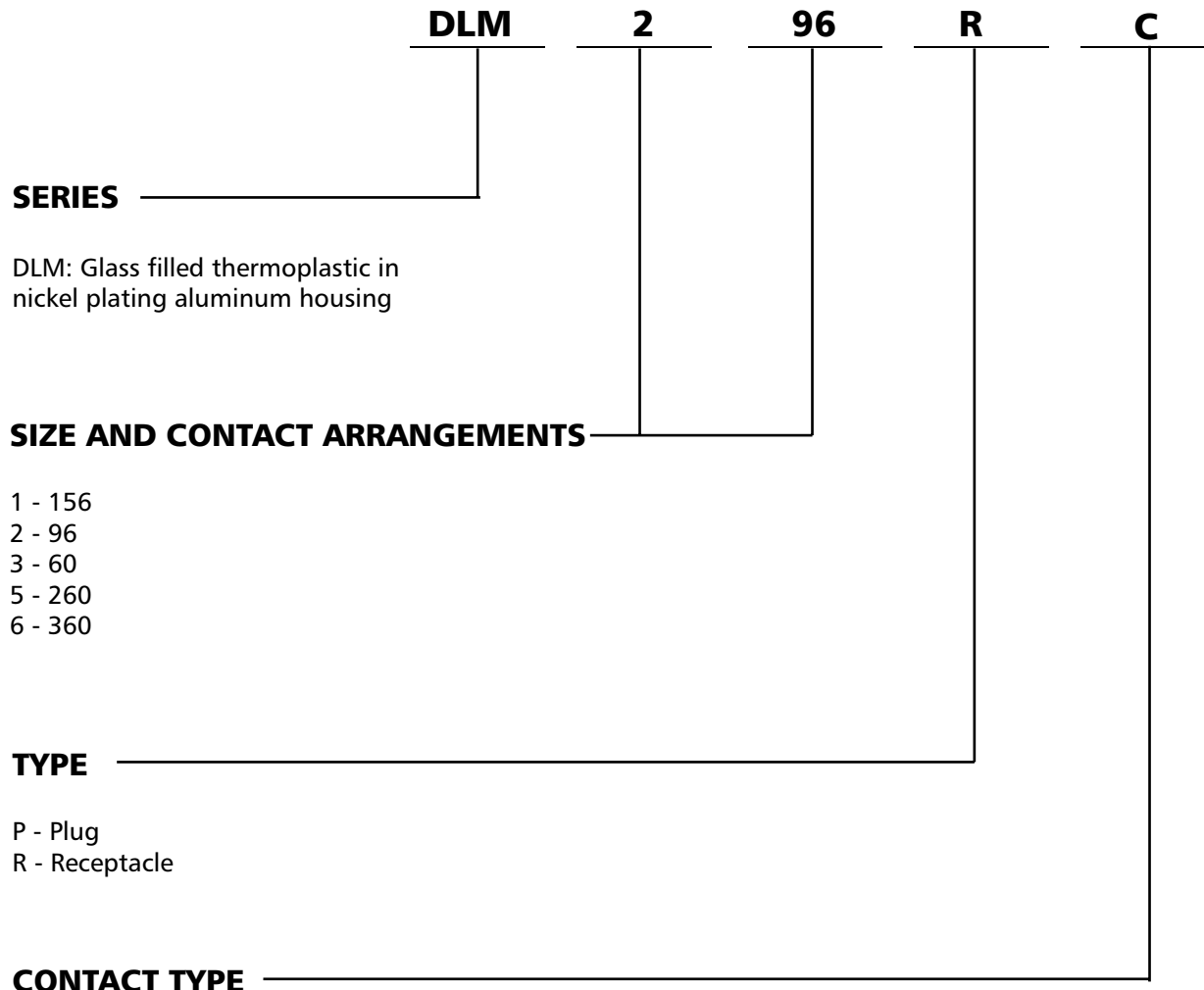

DLM: Glass filled thermoplastic in nickel plating aluminum housing

- 1 - 156
- 2 - 96
- 3 - 60
- 5 - 260
- 6 - 360

- P - Plug
- R - Receptacle

No letter - Crimp #18 thru #42 AWG.
TO BE ORDERED SEPARATELY AND INSTALLED BY CUSTOMER

- W4 - Wrap Post 15,37 (0.605) 20 μ inches Gold
- W4A - Wrap Post 15,37 (0.605) 50 μ inches Gold, Plug only
- W4B - Wrap Post 15,37 (0.605) 50 μ inches Gold, Receptacle only
- W6 - Square Post 7,11 (0.260) 20 μ inches Gold
- W6A - Square Post 7,11 (0.260) 50 μ inches Gold, Plug only
- W6B - Square Post 7,11 (0.260) 50 μ inches Gold, Receptacle only
- W9A - Square Post 3,18 (0.125), 50 μ iinches Gold, Plug only
- W9B - Square Post 3,18 (0.125), 50 μ inches Gold, Receptacle only
- C - F - PC / RC 4,50 (0.177), 20 μ inches Gold
- PF - Pressfit - DLM5 Plug and Receptacle only

Plug

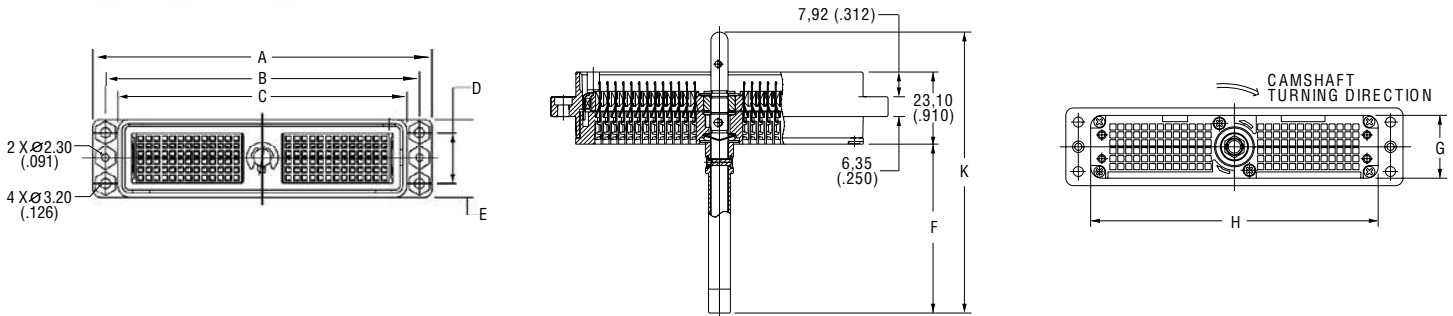

- Order Actuating Handle Kit sold separately, see page 44.
- Crimp contacts are to be ordered separately and to be installed by customer, see pages 48-50.
- For contact cavity arrangements see pages 69-70.
- For panel cutout and mounting hole pattern, see page 66.

| Description | A | B | C | D | E | F | G | H | K |
|------------------|-------------------|-------------------|-------------------|------------------|------------------|------------------|------------------|-------------------|-------------------|
| DLM3-60P | 65,80 (2.592) | 57,91 (2.280) | 50,55 (1.992) | 11,89 (.468) | 24,90 (.981) | 38,85 (1.530) | 24,90 (.981) | 49,02 (1.931) | 74,75 (2.945) |
| DLM2-96P | 65,80 (2.592) | 57,91 (2.280) | 50,60 (1.994) | 19,38 (.763) | 28,12 (1.108) | 38,85 (1.530) | 24,05 (.947) | 50,60 (1.994) | 74,75 (2.945) |
| DLM1-156P | 108,00 (4.255) | 100,03 (3.983) | 92,00 (3.622) | 16,26 (.640) | 24,80 (.977) | 54,10 (2.132) | 20,10 (0.792) | 92,10 (3.626) | 90,00 (3.546) |
| DLM5-260P | 108,00 (4.255) | 100,03 (3.983) | 92,00 (3.622) | 26,00 (1.024) | 35,00 (1.378) | 54,81 (2.158) | 26,00 (1.024) | 92,00 (3.626) | 90,00 (3.546) |
| DLM6-360P | 125,00 (4.921) | 115,00 (4.528) | 104,30 (4.106) | 29,00 (1.142) | 42,60 (1.677) | 69,00 (2.717) | 37,80 (1.488) | 107,30 (4.224) | 104,70 (4.122) |

Receptacle



- Crimp contacts are to be ordered separately and to be installed by customer, see pages 48-50.
- For contact cavity arrangement see pages 69-70.
- For panel cutout and mounting hole pattern, see page 66.

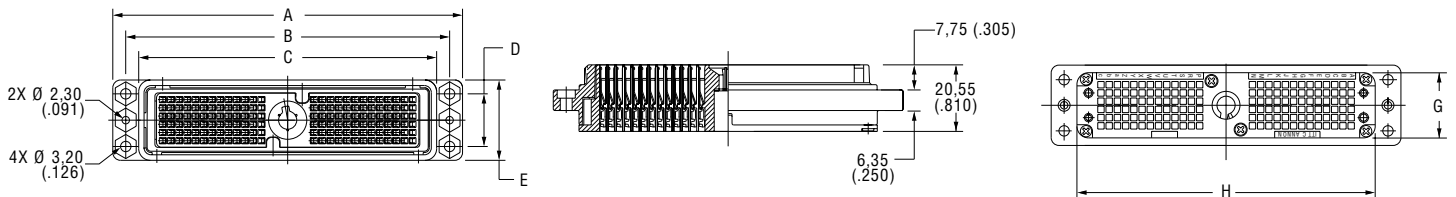

| Description | A | B | C | D | E | G | H |
|------------------|-------------------|-------------------|-------------------|------------------|------------------|------------------|-------------------|
| DLM3-60R | 65,80 (2.592) | 57,91 (2.280) | 50,55 (1.992) | 11,89 (.468) | 24,90 (.981) | 19,94 (.785) | 49,02 (1.931) |
| DLM2-96PR | 65,80 (2.592) | 57,91 (2.280) | 50,60 (1.994) | 19,38 (.763) | 28,12 (1.108) | 24,05 (.947) | 50,60 (1.994) |
| DLM1-156R | 108,00 (4.255) | 100,03 (3.983) | 92,00 (3.622) | 16,26 (.640) | 24,80 (.977) | 20,10 (.792) | 92,10 (3.629) |
| DLM5-260R | 108,00 (4.255) | 100,03 (3.983) | 92,00 (3.626) | 26,00 (1.024) | 35,00 (1.378) | 30,30 (1.193) | 92,10 (3.629) |
| DLM6-360R | 125,00 (4.921) | 115,00 (4.528) | 104,30 (4.106) | 29,00 (1.142) | 42,60 (1.677) | 37,80 (1.488) | 107,30 (4.224) |

Plug



- Order Actuating Handle Kit sold separately, see page 44.
- For contact cavity arrangements see pages 69-70
- For panel cutout and mounting hole pattern, see page 66.
- For PC hole pattern, see pages 59-61.

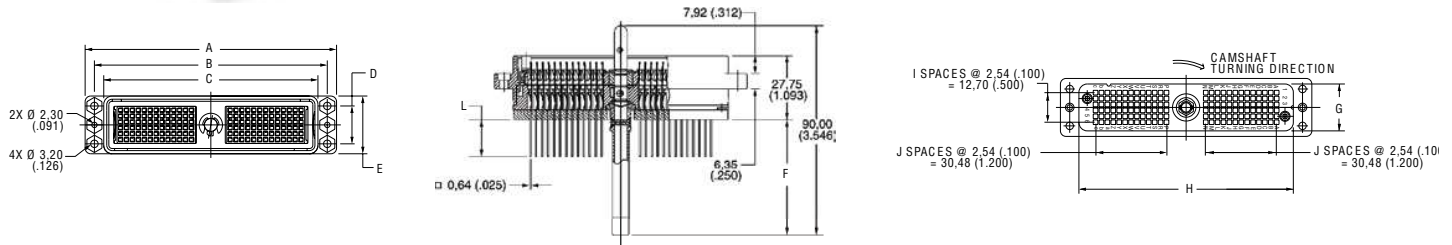

| Description | A | B | C | D | E | F | G | H | I | J | L |
|---------------------|---------|---------|---------|---------|---------|---------|---------|---------|--------|--------|--------|
| DLM3-60PW4 | 65,80 | 57,91 | 50,55 | 11,89 | 24,90 | 34,20 | 19,94 | 49,02 | 5 | 4 | 15,37 |
| DLM3-60PW4A | (2.592) | (2.280) | (1.992) | (.468) | (.981) | (1.347) | (.785) | (1.931) | spaces | spaces | (.605) |
| DLM3-60PW6 | 65,80 | 57,91 | 50,55 | 11,89 | 24,90 | 34,20 | 19,94 | 49,02 | 5 | 4 | 15,37 |
| DLM3-60PW6A | (2.592) | (2.280) | (1.992) | (.468) | (.981) | (1.347) | (.785) | (1.931) | spaces | spaces | (.605) |
| DLM3-60PW9A | 65,80 | 57,91 | 50,55 | 11,89 | 24,90 | 34,20 | 19,94 | 49,02 | 5 | 4 | 7,11 |
| | (2.592) | (2.280) | (1.992) | (.468) | (.981) | (1.347) | (.785) | (1.931) | spaces | spaces | (.280) |
| DLM2-96PW4 | 65,80 | 57,91 | 50,60 | 19,38 | 26,12 | 34,20 | 24,05 | 50,60 | 7 | 6 | 15,37 |
| DLM2-96PW4A | (2.592) | (2.280) | (1.994) | (.763) | (1.108) | (1.347) | (.947) | (1.994) | spaces | spaces | (.605) |
| DLM2-96PW6 | 65,80 | 57,91 | 50,60 | 19,38 | 26,12 | 34,20 | 24,05 | 50,60 | 7 | 6 | 7,11 |
| DLM2-96PW6A | (2.592) | (2.280) | (1.994) | (.763) | (1.108) | (1.347) | (.947) | (1.994) | spaces | spaces | (.280) |
| DLM2-96PW9A | 65,80 | 57,91 | 50,60 | 19,38 | 26,12 | 34,20 | 24,05 | 50,60 | 7 | 6 | 3,18 |
| | (2.592) | (2.280) | (1.994) | (.763) | (1.108) | (1.347) | (.947) | (1.994) | spaces | spaces | (.125) |
| DLM1-156PW4 | 108,00 | 100,03 | 92,00 | 16,26 | 24,90 | 49,45 | 20,10 | 92,10 | 5 | 12 | 15,37 |
| DLM1-156PW4A | (4.255) | (3.983) | (3.622) | (.640) | (.981) | (1.948) | (.792) | (3.626) | spaces | spaces | (.605) |
| DLM1-156PW6 | 108,00 | 100,03 | 92,00 | 16,26 | 24,90 | 49,45 | 20,10 | 92,10 | 5 | 12 | 7,11 |
| DLM1-156PW6A | (4.255) | (3.983) | (3.622) | (.640) | (.981) | (1.948) | (.792) | (3.626) | spaces | spaces | (.280) |
| DLM1-156PW9A | 108,00 | 100,03 | 92,00 | 16,26 | 24,90 | 49,45 | 20,10 | 92,10 | 5 | 12 | 3,18 |
| | (4.255) | (3.983) | (3.622) | (.640) | (.981) | (1.948) | (.792) | (3.626) | spaces | spaces | (.125) |
| DLM5-260PW4 | 108,00 | 100,03 | 92,00 | 26,00 | 35,00 | 49,90 | 30,30 | 92,10 | 9 | 12 | 15,37 |
| DLM5-260PW4A | (4.255) | (3.983) | (3.622) | (1.024) | (1.378) | (1.965) | (1.193) | (3.626) | spaces | spaces | (.604) |
| DLM5-260PW6 | 108,00 | 100,03 | 92,00 | 26,00 | 35,00 | 49,90 | 30,30 | 92,10 | 9 | 12 | 7,11 |
| DLM5-260PW6A | (4.255) | (3.983) | (3.622) | (1.024) | (1.378) | (1.965) | (1.193) | (3.626) | spaces | spaces | (.280) |
| DLM5-260PW9A | 108,00 | 100,03 | 92,00 | 26,00 | 35,00 | 49,90 | 30,30 | 92,10 | 9 | 12 | 3,18 |
| | (4.255) | (3.983) | (3.622) | (1.024) | (1.378) | (1.965) | (1.193) | (3.626) | spaces | spaces | (.125) |
| DLM6-260PW4 | 125,00 | 115,00 | 104,30 | 29,00 | 42,60 | 64,30 | 37,80 | 107,30 | 9 | 14 | 15,37 |
| DLM6-260PW4A | (4.291) | (4.528) | (4.106) | (1.142) | (1.677) | (2.531) | (1.488) | (4.224) | spaces | spaces | (.604) |
| DLM6-360PW6 | 125,00 | 115,00 | 104,30 | 29,00 | 42,60 | 64,30 | 37,80 | 107,30 | 9 | 14 | 7,11 |
| DLM6-360PW6A | (4.291) | (4.528) | (4.106) | (1.142) | (1.677) | (2.531) | (1.488) | (4.224) | spaces | spaces | (.280) |
| DLM6-360PW9A | 125,00 | 115,00 | 104,30 | 29,00 | 42,60 | 64,30 | 37,80 | 107,30 | 9 | 14 | 3,18 |
| | (4.291) | (4.528) | (4.106) | (1.142) | (1.677) | (2.531) | (1.488) | (4.224) | spaces | spaces | (.125) |

Notes:

Front removable 0,64 (0.025) square posts 2,54 (0.100) Centers.
1 space at 2,54 (0.100)

Dimensions shown in mm (inch)

Specifications and dimensions subject to change