



Chipsmall Limited consists of a professional team with an average of over 10 year of expertise in the distribution of electronic components. Based in Hongkong, we have already established firm and mutual-benefit business relationships with customers from,Europe,America and south Asia,supplying obsolete and hard-to-find components to meet their specific needs.

With the principle of "Quality Parts,Customers Priority,Honest Operation,and Considerate Service",our business mainly focus on the distribution of electronic components. Line cards we deal with include Microchip,ALPS,ROHM,Xilinx,Pulse,ON,Everlight and Freescale. Main products comprise IC,Modules,Potentiometer,IC Socket,Relay,Connector.Our parts cover such applications as commercial,industrial, and automotives areas.

We are looking forward to setting up business relationship with you and hope to provide you with the best service and solution. Let us make a better world for our industry!



Contact us

Tel: +86-755-8981 8866 Fax: +86-755-8427 6832

Email & Skype: info@chipsmall.com Web: www.chipsmall.com

Address: A1208, Overseas Decoration Building, #122 Zhenhua RD., Futian, Shenzhen, China



THIS DRAWING IS UNPUBLISHED.
 VERTRAULICHE UNVERÖFFENTLICHTE ZEICHNUNG
 © COPYRIGHT - By -
 RELEASED FOR PUBLICATION
 FREI FUER VERÖFFENTLICHUNG
 ALL RIGHTS RESERVED.
 ALLE RECHTE VORBEHALTEN

PROJEKT NR. **EGGMN 04410**

REVISIONS ÄNDERUNGEN		DATE	DWN	APVD
P	LTR	DESCRIPTION BESCHREIBUNG		
-		NEW DRAWN	14-02-2006	SR AG
B		ECR-15-007667	16JUL2015	GSK JB

**CONTACT ARRANGEMENT
VIEW FROM CONECTING SIDE**

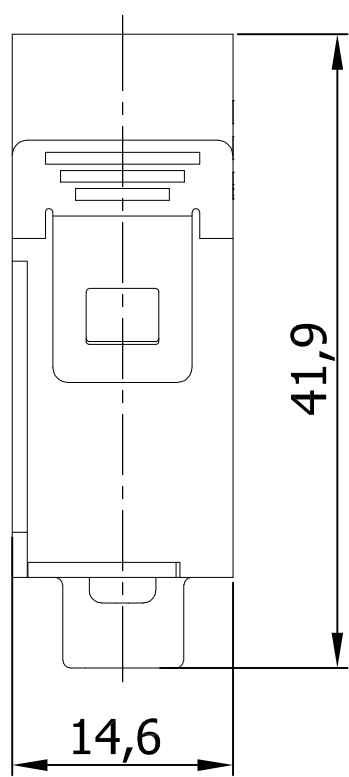
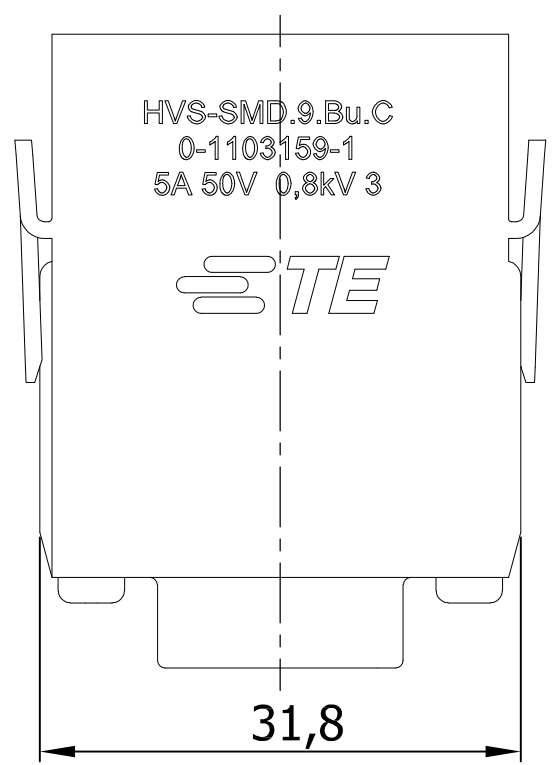
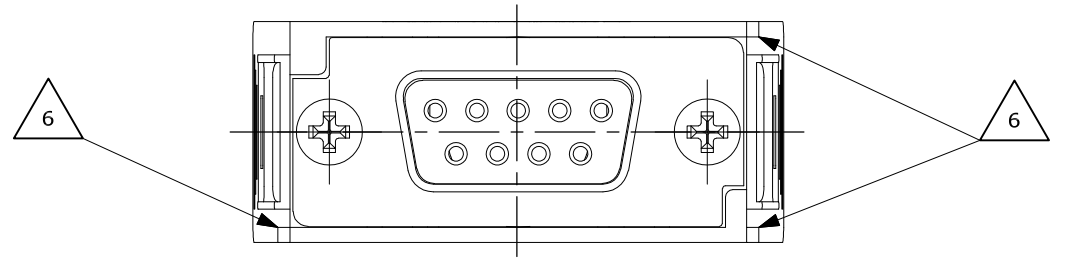

NOTES

- SUITABLE CRIMP CONTACTS: SERIES S20DF
 CATALOG: 889745
 OUTER DIMENSIONS OF INSULATION: MAX. Ø1,6 MM
- SUITABLE MODULE FIXING FRAME: SERIES HVS SIZE 3 TO 8
 CUSTOMER DRAWING: 1103250
- SUITABLE INSERTION TOOL:
 CUSTOMER DRAWING: 1102855
- SUITABLE EXTRACTION TOOL:
 CUSTOMER DRAWING: 1102855
- STANDARDS:
 DIN EN 61984; DIN EN 60664-1
- POLARIZATION RIPS
- MARKING OF POLARIZATION ACCORDING MARKING OF
 MODULE FRAME
- PACKAGING:
 10 SETS IN A CARTON, PRE-MOUNTED

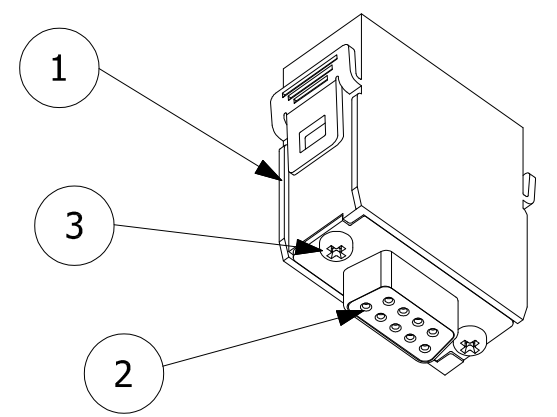

**CONTACT ARRANGEMENT
VIEW FROM TERMINATION SIDE**

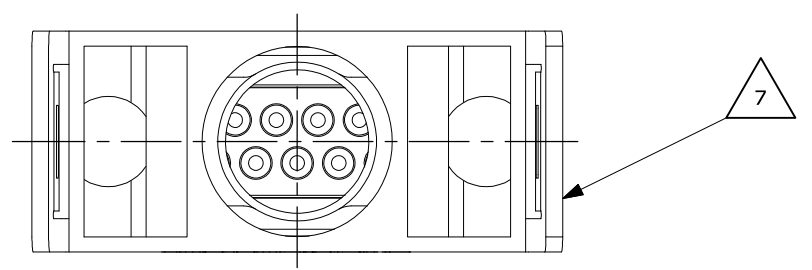

QTY.	DESCRIPTION	MATERIAL	SURFACE	COLOR	NOTE	ITEM
2	SCREW 2,5X8	Steel	ZINC PLATED	BLUE	FOR PLASTICS	3
1	ASSY RECCEPTACLE	---				2
1	MODULE INSERT	PBT-GF10	SURFACE	LIGHT GREY	---	1

PARTS LIST

THIS DRAWING IS A CONTROLLED DOCUMENT. DIESE ZEICHNUNG IST EIN KONTROLLIERTES DOKUMENT.		DWN SCHNEIDER 14.02.2006	TE Connectivity		
DIMENSIONS: MASSE/MAßSTÄBE: mm		CHK A.GAST 14.02.2006			
TOLERANCES UNLESS OTHERWISE SPECIFIED: ALLGEMEINTOLERANZEN n. ISO 8015 - n. ISO 2768 - mH-E n. DIN 16901- 140		APVD T.SCHNURPFEIL 14.02.2006	NAME FEMALE INSERT HVS-SMD.9.BU.C		
		PRODUCT SPEC PRODUKTSPEZ. 108-74076	DRAWING NO ZEICHNUNGS-NR. G-1103159		
MATERIAL		APPLICATION SPEC. VERARBEITUNGSSPEZ. 114-74075	SIZE A3	CAGE CODE 00779	RESTRICTED TO NUR FUER -
FINISH/OBERFLÄCHE/FARBE		WEIGHT GEWICHT 0.001 KG	SCALE MAßSTAB 2:1		
		CUSTOMER DRAWING/KUNDENZEICHNUNG			SHEET BLATT 1 OF VON 1
					REV B