



Chipsmall Limited consists of a professional team with an average of over 10 year of expertise in the distribution of electronic components. Based in Hongkong, we have already established firm and mutual-benefit business relationships with customers from,Europe,America and south Asia,supplying obsolete and hard-to-find components to meet their specific needs.

With the principle of “Quality Parts,Customers Priority,Honest Operation,and Considerate Service”,our business mainly focus on the distribution of electronic components. Line cards we deal with include Microchip,ALPS,ROHM,Xilinx,Pulse,ON,Everlight and Freescale. Main products comprise IC,Modules,Potentiometer,IC Socket,Relay,Connector.Our parts cover such applications as commercial,industrial, and automotives areas.

We are looking forward to setting up business relationship with you and hope to provide you with the best service and solution. Let us make a better world for our industry!



## Contact us

Tel: +86-755-8981 8866 Fax: +86-755-8427 6832

Email & Skype: info@chipsmall.com Web: www.chipsmall.com

Address: A1208, Overseas Decoration Building, #122 Zhenhua RD., Futian, Shenzhen, China



LOC  
A1

DIST

REVISIONS

P	LTR	DESCRIPTION	DATE	DWN	APVD
	C	ECR-15-007490	08JUN2015	GSK	JB

Contact arrangement  
view from connecting side  
PN 0-1 As Shown

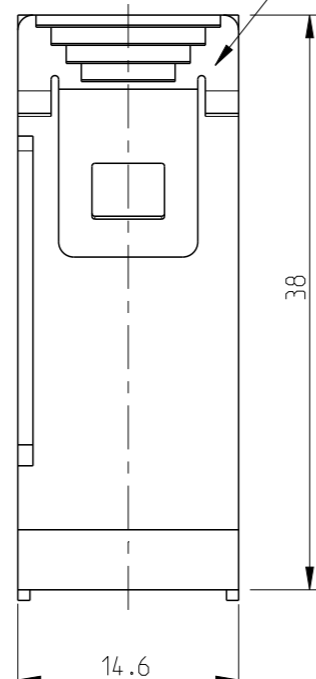
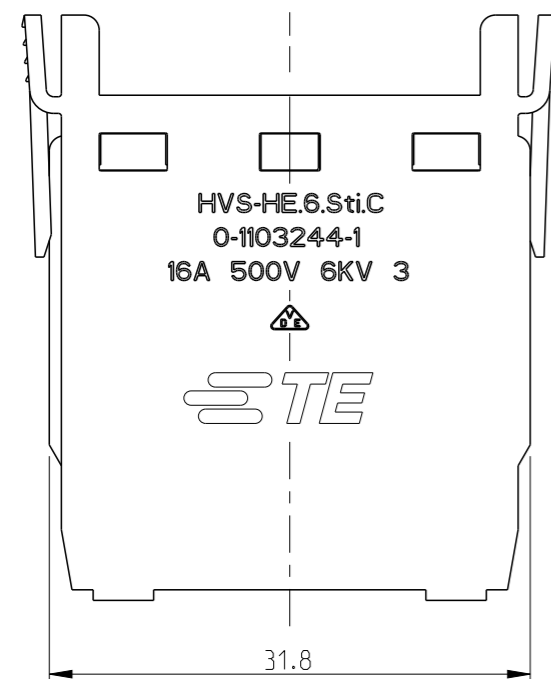
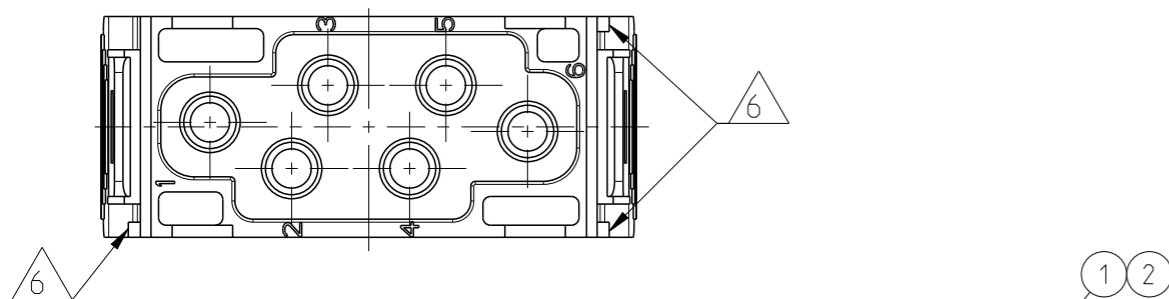

NOTES

- SUITABLE CRIMP CONTACTS: SERIES HE  
CUSTOMER DRAWING: 1105100  
OUTER DIMENSIONS OF INSULATION: MAX. Ø4.9mm
- SUITABLE MODULE FIXING FRAME: SERIES HVS SIZE 3 TO 8  
CUSTOMER DRAWING: 1103250
- SUITABLE INSERTION TOOL:  
CUSTOMER DRAWING: 0-1102855-6
- SUITABLE EXTRACTION TOOL:  
CUSTOMER DRAWING: 0-1102855-7
- STANDARDS:  
DIN EN 61984; DIN EN 60664-1
- POLARIZATION RIBS
- MARKING OF POLARIZATION ACCORDING TO MARKING OF  
MODULE FRAME
- PACKAGING:  
10 SETS IN A CARTON, PRE-MOUNTED

PN 0-1 As Shown

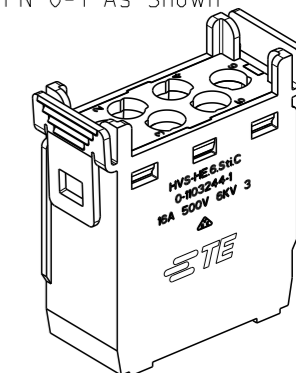

Contact arrangement  
view from termination side

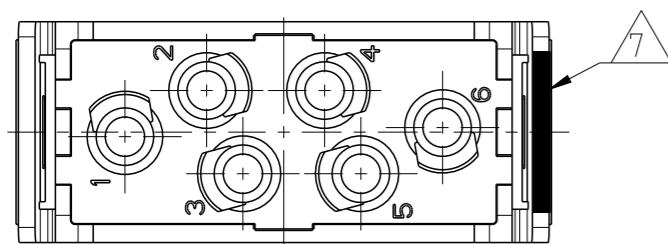

QTY	DESCRIPTION	MATERIAL	COLOR	NOTE	ITEM
1	MALE INSERT HVS-HE.6	PBT-GF10	LIGHT GREY		2
1	COVER MALE INSERT HVS-HE.6	PBT-GF15	LIGHT GREY		1

HVS-HE.6.Sti.C		DWN 24.05.2005 M.SCHWEIGER		TE Connectivity	
CHK 22.05.2005 T.SCHNURPFEL		APVD 20.12.2006 T.SCHNURPFEL			
PRODUCT SPEC		NAME		MALE INSERT HVS-HE.6.STI.C	
APPLICATION SPEC		SIZE	CAGE CODE	DRAWING NO	RESTRICTED TO
MATERIAL		A3	00779	C-1103244	
WEIGHT		CUSTOMER DRAWING		SCALE 2:1	SHEET 1 OF 1
FINISH		REV C			

THIS DRAWING IS A CONTROLLED DOCUMENT.

DIMENSIONS: mm	TOLERANCES UNLESS OTHERWISE SPECIFIED: ISO 8075 DIN ISO 2768 mH-E DIN 16901-120
	0 PLC ± 1 PLC ± 2 PLC ± 3 PLC ± 4 PLC ± ANGLES ±
MATERIAL	FINISH