



Chipsmall Limited consists of a professional team with an average of over 10 year of expertise in the distribution of electronic components. Based in Hongkong, we have already established firm and mutual-benefit business relationships with customers from,Europe,America and south Asia,supplying obsolete and hard-to-find components to meet their specific needs.

With the principle of "Quality Parts,Customers Priority,Honest Operation,and Considerate Service",our business mainly focus on the distribution of electronic components. Line cards we deal with include Microchip,ALPS,ROHM,Xilinx,Pulse,ON,Everlight and Freescale. Main products comprise IC,Modules,Potentiometer,IC Socket,Relay,Connector.Our parts cover such applications as commercial,industrial, and automotives areas.

We are looking forward to setting up business relationship with you and hope to provide you with the best service and solution. Let us make a better world for our industry!



Contact us

Tel: +86-755-8981 8866 Fax: +86-755-8427 6832

Email & Skype: info@chipsmall.com Web: www.chipsmall.com

Address: A1208, Overseas Decoration Building, #122 Zhenhua RD., Futian, Shenzhen, China



MALE PCB PINS

WRAPOST TERMINALS

1096

1096-X-05-XX-00-00-01-0

Press-fit in .057 mounting hole

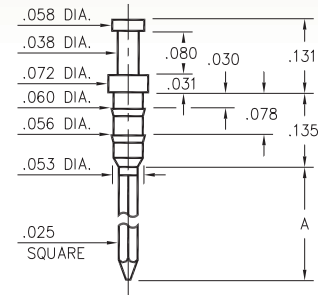

Basic Part Number	# of Wraps	Length A
1096-2	2	.381
1096-3	3	.527

1106

1106-X-23-XX-00-00-01-0

Press-fit in .057 mounting hole

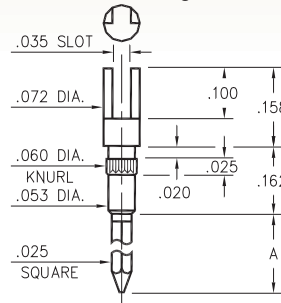

Basic Part Number	# of Wraps	Length A
1106-2	2	.370
1106-3	3	.510

1093

1093-0-05-XX-00-00-01-0

Press-fit in .056 mounting hole

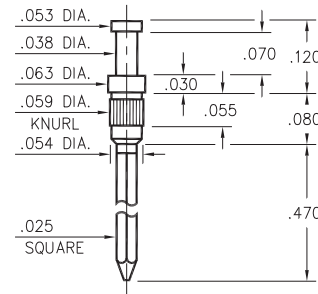

0730

0730-3-05-XX-00-00-01-0

Press-fit in .057 mounting hole

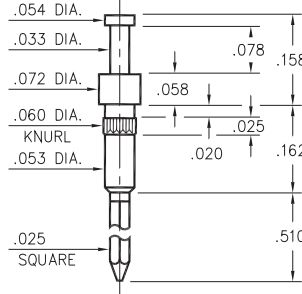

1122

1122-0-22-XX-00-00-01-0

Press-fit in .053 mounting hole

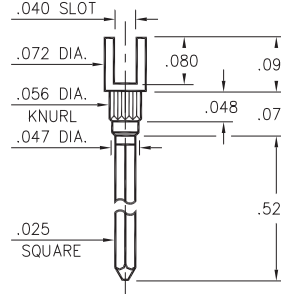

1064

1064-0-23-XX-00-00-01-0

Press-fit in .056 mounting hole

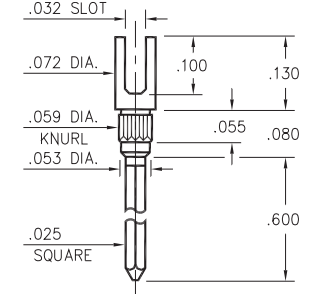

1092

1092-0-05-XX-00-00-01-0

Press-fit in .056 mounting hole

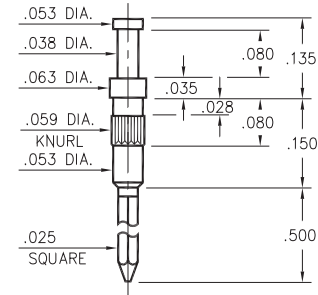

1068

1068-0-23-XX-00-00-01-0

Press-fit in .057 mounting hole

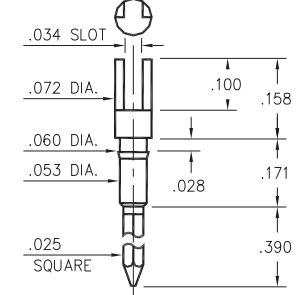

1070 → 1072

107X-X-23-XX-00-00-01-0

Press-fit in .057 mounting hole

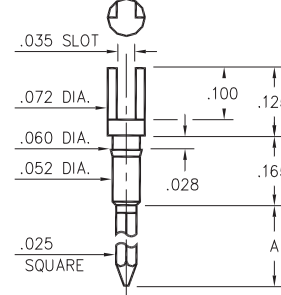

Basic Part Number	# of Wraps	Length A
1072-1	1	.260
1071-2	2	.370
1070-3	3	.510

SPECIFICATIONS:

Pin Material: Brass Alloy 360, 1/2 Hard
(Except where noted)

Dimensions: Inches

Tolerances On: Lengths: ±.005
Diameters: ±.002
Angles: ±2°



ORDER CODE: XXXX - X - XX - XX - 00 - 00 - 01 - 0

BASIC PART #

SPECIFY PIN FINISH:

- 01 200 μ" TIN/LEAD OVER NICKEL
- ◆ 80 200 μ" TIN OVER NICKEL (RoHS)
- ◆ 15 10 μ" GOLD OVER NICKEL (RoHS)
- ◆ 21 20 μ" GOLD OVER NICKEL (RoHS)

