



Chipsmall Limited consists of a professional team with an average of over 10 year of expertise in the distribution of electronic components. Based in Hongkong, we have already established firm and mutual-benefit business relationships with customers from,Europe,America and south Asia,supplying obsolete and hard-to-find components to meet their specific needs.

With the principle of “Quality Parts,Customers Priority,Honest Operation,and Considerate Service”,our business mainly focus on the distribution of electronic components. Line cards we deal with include Microchip,ALPS,ROHM,Xilinx,Pulse,ON,Everlight and Freescale. Main products comprise IC,Modules,Potentiometer,IC Socket,Relay,Connector.Our parts cover such applications as commercial,industrial, and automotives areas.

We are looking forward to setting up business relationship with you and hope to provide you with the best service and solution. Let us make a better world for our industry!



Contact us

Tel: +86-755-8981 8866 Fax: +86-755-8427 6832

Email & Skype: info@chipsmall.com Web: www.chipsmall.com

Address: A1208, Overseas Decoration Building, #122 Zhenhua RD., Futian, Shenzhen, China



REV.	DATE	ECR NO.	DESCRIPTION
NC	05/22/03	—	INITIAL RELEASE
A	05/18/05	—	CORRECT PART NO. AND DESCRIPTION
B	10/24/06	—	ADD "75 ohm" TO DESCRIPTION
C	10/27/08	—	REVISE NOTE 1 TO .178" HEX CRIMP

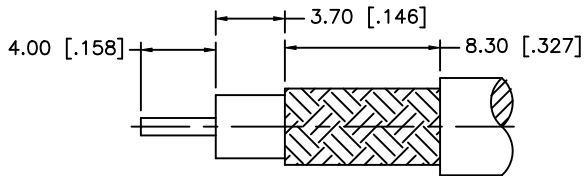

RECOMMENDED CABLE
STRIPPING DIM'S

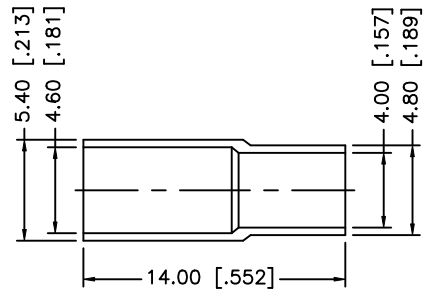
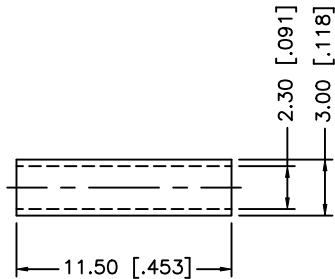
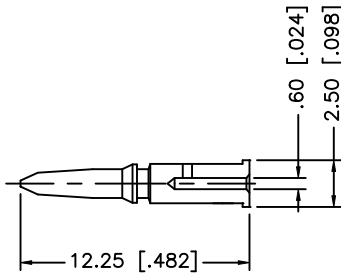
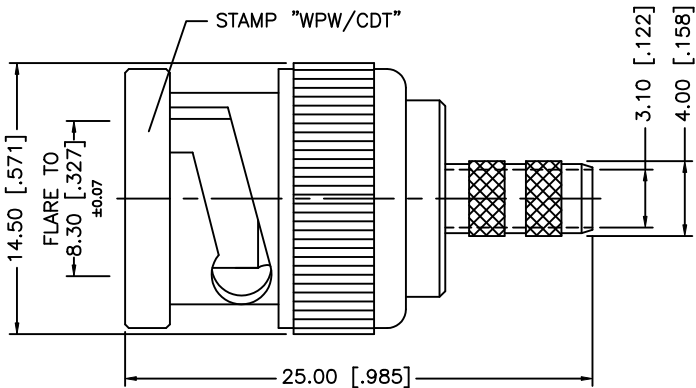

NOTES:

1. CRIMPED FERRULE HEX CRIMP SIZE .178" [4.52]
2. CRIMPED CONTACT PIN HEX CRIMP SIZE .068" [1.73]

					<div>UNLESS OTHERWISE SPECIFIED DIMENSIONS ARE IN MILLIMETERS. DIMENSIONS IN [] ARE IN INCHES AND FOR CUSTOMER REFERENCE ONLY.</div> <div>UNLESS OTHERWISE SPECIFIED TOLERANCES FOR MILLIMETERS ARE: 0.5 – 8mm ± 0.20mm 8 – 30mm ± 0.40mm 30 – 120mm ± 0.50mm</div> <div>UNLESS OTHERWISE SPECIFIED TOLERANCES FOR INCHES ARE: .020 – .315 = ± 0.007" .315 – 1.180 = ± 0.015" 1.180 – 4.724 = ± 0.020"</div> <div>DO NOT SCALE DRAWING</div>	APPROVALS		DATE		<div>Amphenol Connex</div>								
8						DRAWN	GRS	10/27/08										
7						CHECKED												
6	FERRULE	COPPER	NICKEL	1			ISSUED				<div>PART DESCRIPTION</div> <div>BNC CRIMP PLUG – 75ohm (FOR B573945, MINI MAX 500 CABLE)</div>							
5	SLEEVE	DELTRIN	NATURAL	1			SHEET	1 OF 1										
4	GASKET	RUBBER	RED	1														
3	CONTACT PIN	BRASS	GOLD	1							<div>PART NO.</div> <div>112556</div>							
2	INSULATOR	PTFE	NATURAL	1														
1	SHELL/BODY	BRASS	NICKEL	1														
DESCRIPTION		MATERIAL	FINISH	QTY		CAD FILE		C:/112/112556.DWG		DWG. NO.		112556.DWG		REV.	C	SIZE	A	SCALE

UNLESS OTHERWISE SPECIFIED DIMENSIONS ARE IN MILLIMETERS. DIMENSIONS IN [] ARE IN INCHES AND FOR CUSTOMER REFERENCE ONLY.

UNLESS OTHERWISE SPECIFIED TOLERANCES FOR MILLIMETERS ARE:
0.5 – 8mm ± 0.20mm
8 – 30mm ± 0.40mm
30 – 120mm ± 0.50mm

UNLESS OTHERWISE SPECIFIED TOLERANCES FOR INCHES ARE:
.020 – .315 = ± 0.007"
.315 – 1.180 = ± 0.015"
1.180 – 4.724 = ± 0.020"