



Chipsmall Limited consists of a professional team with an average of over 10 year of expertise in the distribution of electronic components. Based in Hongkong, we have already established firm and mutual-benefit business relationships with customers from,Europe,America and south Asia,supplying obsolete and hard-to-find components to meet their specific needs.

With the principle of “Quality Parts,Customers Priority,Honest Operation,and Considerate Service”,our business mainly focus on the distribution of electronic components. Line cards we deal with include Microchip,ALPS,ROHM,Xilinx,Pulse,ON,Everlight and Freescale. Main products comprise IC,Modules,Potentiometer,IC Socket,Relay,Connector.Our parts cover such applications as commercial,industrial, and automotives areas.

We are looking forward to setting up business relationship with you and hope to provide you with the best service and solution. Let us make a better world for our industry!



## Contact us

Tel: +86-755-8981 8866 Fax: +86-755-8427 6832

Email & Skype: [info@chipsmall.com](mailto:info@chipsmall.com) Web: [www.chipsmall.com](http://www.chipsmall.com)

Address: A1208, Overseas Decoration Building, #122 Zhenhua RD., Futian, Shenzhen, China



REV.	DATE	DESCRIPTION
A	10/08/03	MODIFY PART DIMENSIONS / UPDATE DRAWING FORMAT
B	01/24/06	ADD FLAT ON BODY THREAD AREA

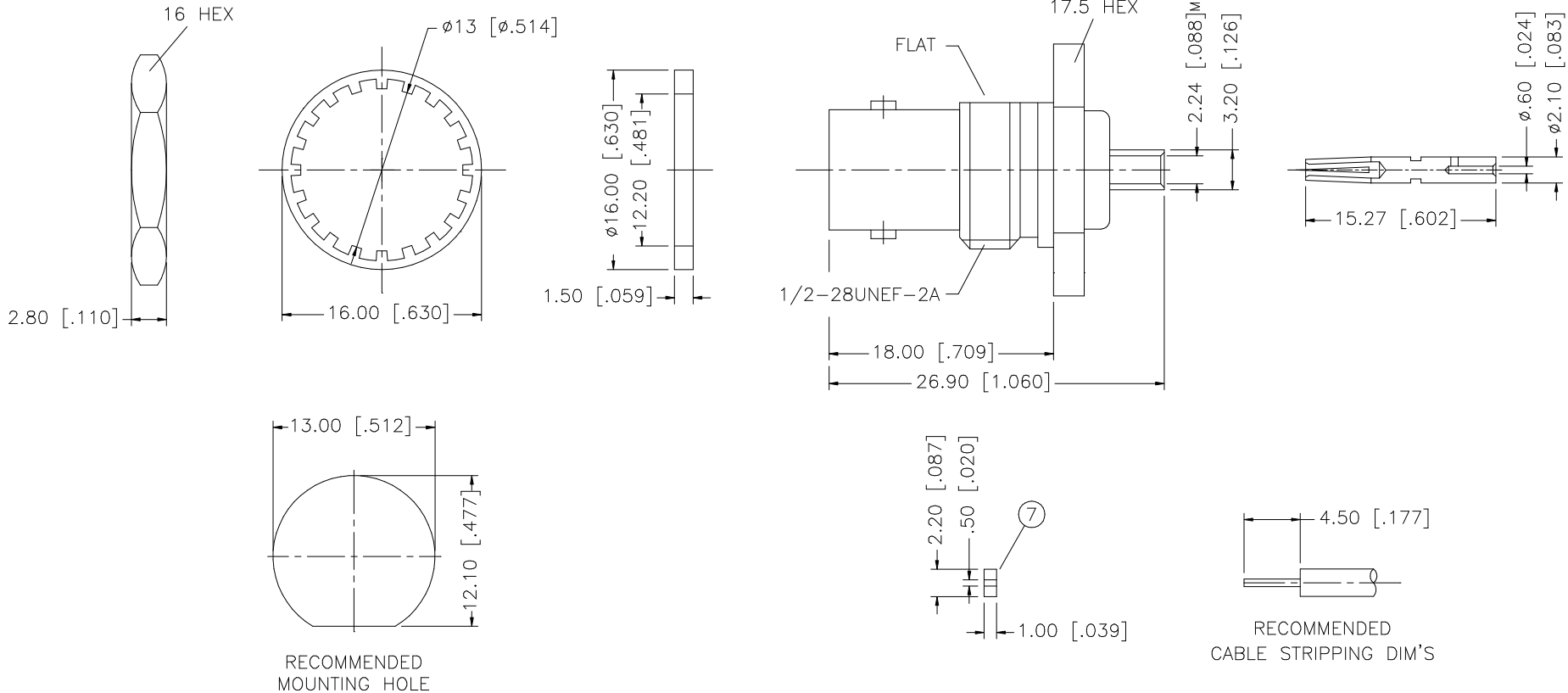

8					UNLESS OTHERWISE SPECIFIED DIMENSIONS ARE IN MILLIMETERS; DIMENSIONS IN [ ] ARE IN INCHES AND FOR CUSTOMER REFERENCE ONLY.	APPROVALS	DATE	Amphenol Connex								
7	INSULATOR	TEFLON	NATURAL	1		DRAWN	G.R.S.						01/24/06			
6	HEX NUT	BRASS	NICKEL	1	UNLESS OTHERWISE SPECIFIED TOLERANCES FOR MILLIMETERS ARE: 0.5 – 8mm ± 0.20mm 8 – 30mm ± 0.40mm 30 – 120mm ± 0.50mm	CHECKED		PART DESCRIPTION  BNC BULKHEAD DIRECT SOLDER JACK (FOR .085”, .086” CABLE)								
5	LOCK WASHER	BRASS	NICKEL	1		ISSUED										
4	GASKET	RUBBER	RED	1		UNLESS OTHERWISE SPECIFIED TOLERANCES FOR INCHES ARE: .020 – .315 = ± 0.007” .315 – 1.180 = ± 0.015” 1.180 – 4.724 = ± 0.020”	SHEET	1 OF 1	PART NO.  112580							
3	CONTACT PIN	PHOS. BRONZE	GOLD	1												
2	INSULATOR	TEFLON	NATURAL	1	DO NOT SCALE DRAWING		CAD FILE		DWG. NO.		112580.DWG	REV.	B	SIZE	A	SCALE
1	BODY	BRASS	NICKEL	1		C:/112/112580.DWG										
	DESCRIPTION	MATERIAL	FINISH	QTY												