



Chipsmall Limited consists of a professional team with an average of over 10 year of expertise in the distribution of electronic components. Based in Hongkong, we have already established firm and mutual-benefit business relationships with customers from,Europe,America and south Asia,supplying obsolete and hard-to-find components to meet their specific needs.

With the principle of "Quality Parts,Customers Priority,Honest Operation,and Considerate Service",our business mainly focus on the distribution of electronic components. Line cards we deal with include Microchip,ALPS,ROHM,Xilinx,Pulse,ON,Everlight and Freescale. Main products comprise IC,Modules,Potentiometer,IC Socket,Relay,Connector.Our parts cover such applications as commercial,industrial, and automotives areas.

We are looking forward to setting up business relationship with you and hope to provide you with the best service and solution. Let us make a better world for our industry!



Contact us

Tel: +86-755-8981 8866 Fax: +86-755-8427 6832

Email & Skype: info@chipsmall.com Web: www.chipsmall.com

Address: A1208, Overseas Decoration Building, #122 Zhenhua RD., Futian, Shenzhen, China



6

5

4

3

2

1

E

E

D

D

C

C

B

B

A

A

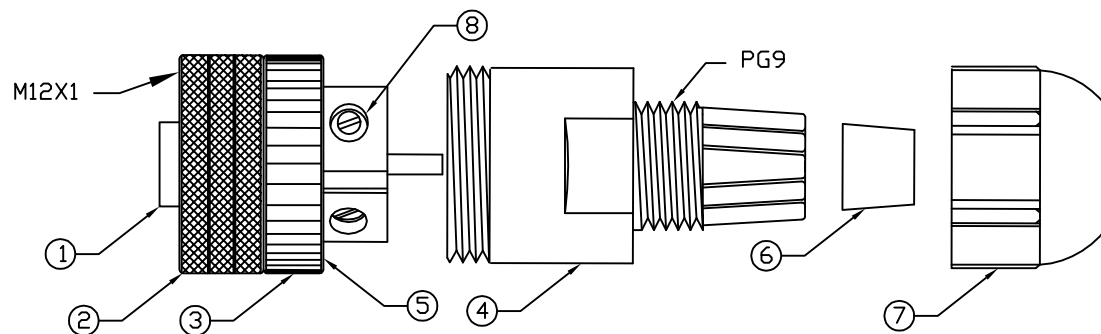

NOTES:

MATERIALS:

MOLDED BODY:	BLACK POLYAMIDE
COUPLING NUT:	NI PLATED BRASS
COMPRESSION NUT:	BLACK POLYAMIDE
GROMMETT	NITRILE RUBBER
CONTACTS:	GOLD/NICKEL OVER COPPER ALLOY
INSERT:	BLACK NYLON
INSERT HOUSING:	BLACK POLYAMIDE
SET SCREWS:	NI PLATED BRASS

ELECTRICAL:

CURRENT RATING:	4AMP MAX
VOLTAGE RATING:	250V

MECHANICAL:

TEMPERATURE RANGE:	-20° TO 80°C
INGRESS PROTECTION:	IP 67

AGENCY CERTIFICATIONS:

AGENCY:	cCSAus FILE LR6837
---------	--------------------

TABLE 2 - COMPONENT INFORMATION

ITEM	QTY	DESCRIPTION
1	1	INSULATOR
2	1	COUPLNG NUT
3	1	INSERT BODY
4	1	CONNECTOR BODY
5	1	O-RING
6	1	GROMMET
7	1	COMPRESSION NUT
8	4	SCREW, M3 x 5

UPDATE PER JM EC NO: WNA209-0313 DRWN: LHARTMAN 2008/10/27 CHKD: YOU 2008/11/07 APPR: JFMURPHY 2008/11/10	QUALITY SYMBOLS ▽=0 ▽C=0	GENERAL TOLERANCES (UNLESS SPECIFIED)		DIMENSION STYLE ----		SCALE 1:1	DESIGN UNITS INCH	THIRD ANGLE PROJECTION	
			mm	INCH	DRAWN BY LHARTMAN	DATE 2008/10/27	TITLE MICRO-CHANGE FIELD ATTCH 4 POLE FEMALE ST FF PG9 FITTING SCREW		
		4 PLACES	±---	±---	CHECKED BY VOU	DATE 2008/10/27			
		3 PLACES	±---	±.005	APPROVED BY JFMURPHY		DATE 2008/10/27	MOLEX INCORPORATED	
2 PLACES	±---	±.010	MATERIAL NO. 1200710036		DOCUMENT NO. SD-130044-003	SHEET NO. 1 OF 1			
1 PLACE	±---	±.020	ANGULAR ±1°		THIS DRAWING CONTAINS INFORMATION THAT IS PROPRIETARY TO MOLEX INCORPORATED AND SHOULD NOT BE USED WITHOUT WRITTEN PERMISSION				
DRAFT WHERE APPLICABLE MUST REMAIN WITHIN DIMENSIONS									
B	REV								

6

5

4

3

2

1