



Chipsmall Limited consists of a professional team with an average of over 10 year of expertise in the distribution of electronic components. Based in Hongkong, we have already established firm and mutual-benefit business relationships with customers from,Europe,America and south Asia,supplying obsolete and hard-to-find components to meet their specific needs.

With the principle of "Quality Parts,Customers Priority,Honest Operation,and Considerate Service",our business mainly focus on the distribution of electronic components. Line cards we deal with include Microchip,ALPS,ROHM,Xilinx,Pulse,ON,Everlight and Freescale. Main products comprise IC,Modules,Potentiometer,IC Socket,Relay,Connector.Our parts cover such applications as commercial,industrial, and automotives areas.

We are looking forward to setting up business relationship with you and hope to provide you with the best service and solution. Let us make a better world for our industry!



## Contact us

Tel: +86-755-8981 8866 Fax: +86-755-8427 6832

Email & Skype: info@chipsmall.com Web: www.chipsmall.com

Address: A1208, Overseas Decoration Building, #122 Zhenhua RD., Futian, Shenzhen, China



# Control cabinet key - USS 4 - 1203149

Please be informed that the data shown in this PDF Document is generated from our Online Catalog. Please find the complete data in the user's documentation. Our General Terms of Use for Downloads are valid (<http://download.phoenixcontact.com>)



Control cabinet key, metal, for all common types of control cabinet

## Key commercial data

Packing unit	1
Minimum order quantity	1
Catalog page	Page 293 (CL2-2011)
GTIN	 4 017918 018108
Custom tariff number	83017000
Country of origin	CHINA

## Technical data

### General

Length (b)	72 mm
Width (a)	72 mm
Material	Zinc die-cast

## Classifications

### eclass

eCl@ss 4.0	21040301
eCl@ss 4.1	21040301
eCl@ss 5.0	21043090
eCl@ss 5.1	21043090
eCl@ss 6.0	21049190
eCl@ss 7.0	21049190

### etim

ETIM 2.0	EC001186
ETIM 3.0	EC001186
ETIM 4.0	EC001186

# Control cabinet key - USS 4 - 1203149

## Classifications

unspsc

UNSPSC 6.01	30211811
UNSPSC 7.0901	39121410
UNSPSC 11	39121410
UNSPSC 12.01	39121410
UNSPSC 13.2	39121410

## Drawings

Dimensioned drawing

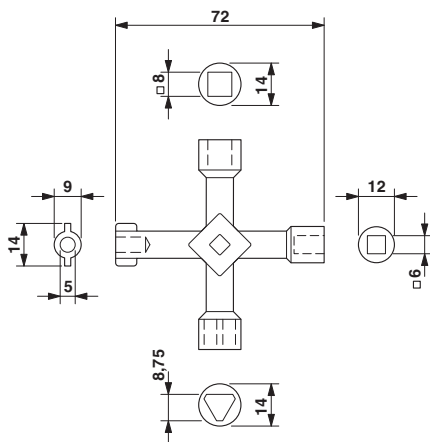

Schematic diagram



1



2



3