



Chipsmall Limited consists of a professional team with an average of over 10 year of expertise in the distribution of electronic components. Based in Hongkong, we have already established firm and mutual-benefit business relationships with customers from,Europe,America and south Asia,supplying obsolete and hard-to-find components to meet their specific needs.

With the principle of “Quality Parts,Customers Priority,Honest Operation,and Considerate Service”,our business mainly focus on the distribution of electronic components. Line cards we deal with include Microchip,ALPS,ROHM,Xilinx,Pulse,ON,Everlight and Freescale. Main products comprise IC,Modules,Potentiometer,IC Socket,Relay,Connector.Our parts cover such applications as commercial,industrial, and automotives areas.

We are looking forward to setting up business relationship with you and hope to provide you with the best service and solution. Let us make a better world for our industry!



Contact us

Tel: +86-755-8981 8866 Fax: +86-755-8427 6832

Email & Skype: info@chipsmall.com Web: www.chipsmall.com

Address: A1208, Overseas Decoration Building, #122 Zhenhua RD., Futian, Shenzhen, China



LOC		DIST		REVISIONS				
AD	00	REV	PER	ECO	NO	DATE	BY	APP'D
A2		REV	PER	ECO-07-002646		06MAR2007	BC	RP

- 1 MATERIAL: HOUSING : POLYESTER, GRAY, UL 94V-0.
CONTACT: HIGH CURRENT COPPER ALLOY.
 - 2 FINISH: CONTACT MATING AREA: 1.27µm MIN GOLD OR 0.08µm MIN GOLD OVER
0.76µm MIN PALLADIUM-NICKEL.
ACTION PIN AREA, 0.5µm MIN TIN/LEAD PLATE,
ALL OVER 1.27µm MIN NICKEL UNDERPLATE.
 - 3 DIMENSION APPLIES AFTER CONNECTOR IS APPLIED TO PC BOARD.
 - 4 DATE CODE THIS APPROXIMATE AREA, OPPOSITE SIDE.
 - 5 REFERENCE APPLICATION SPEC 114-1103 FOR RECOMMENDED
PLATED THRU HOLE DIAMETER AND PLATING THICKNESSES.
6. CURRENT RATING 16A/CONTACT PER PRODUCT SPEC 108-1651.

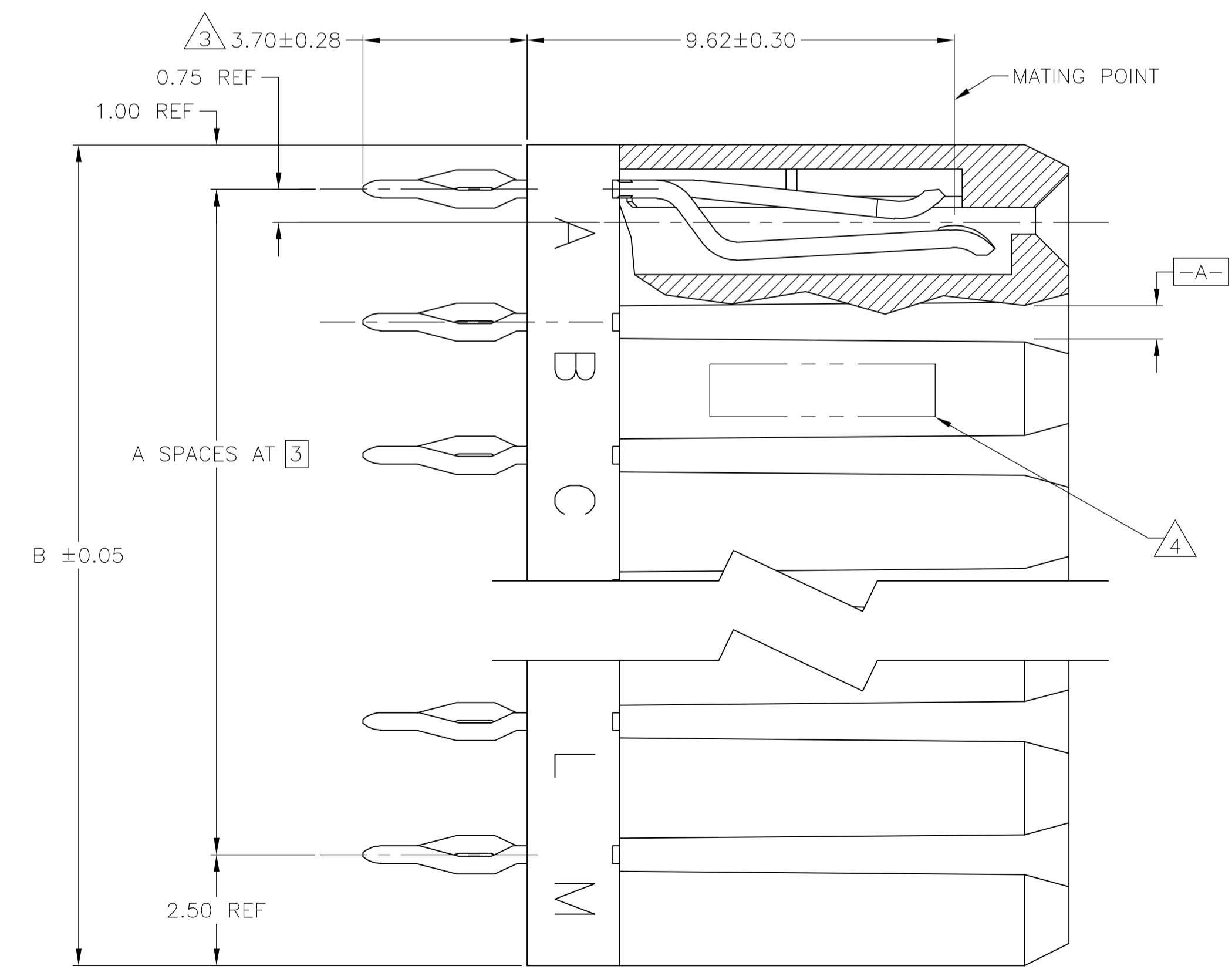
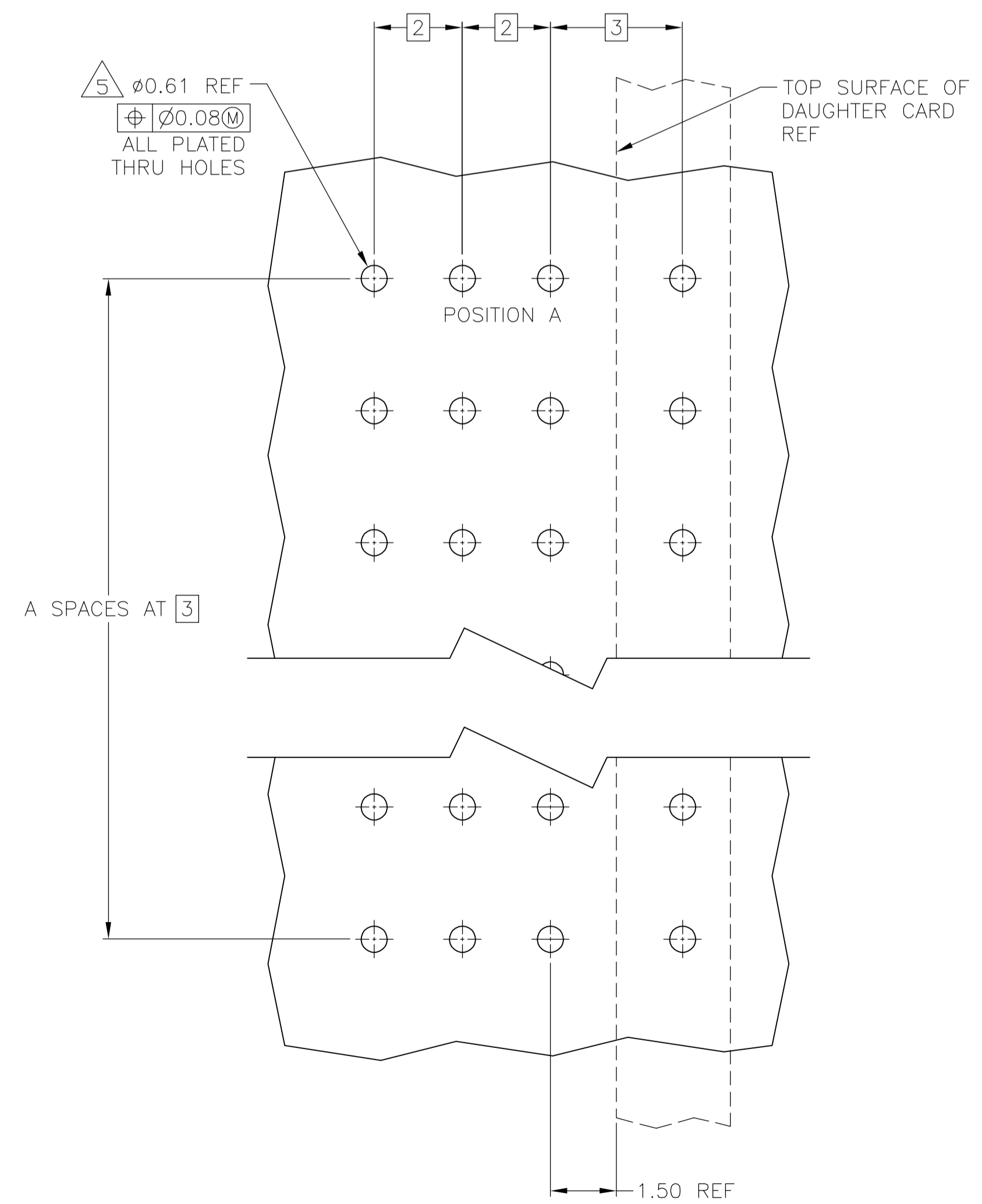
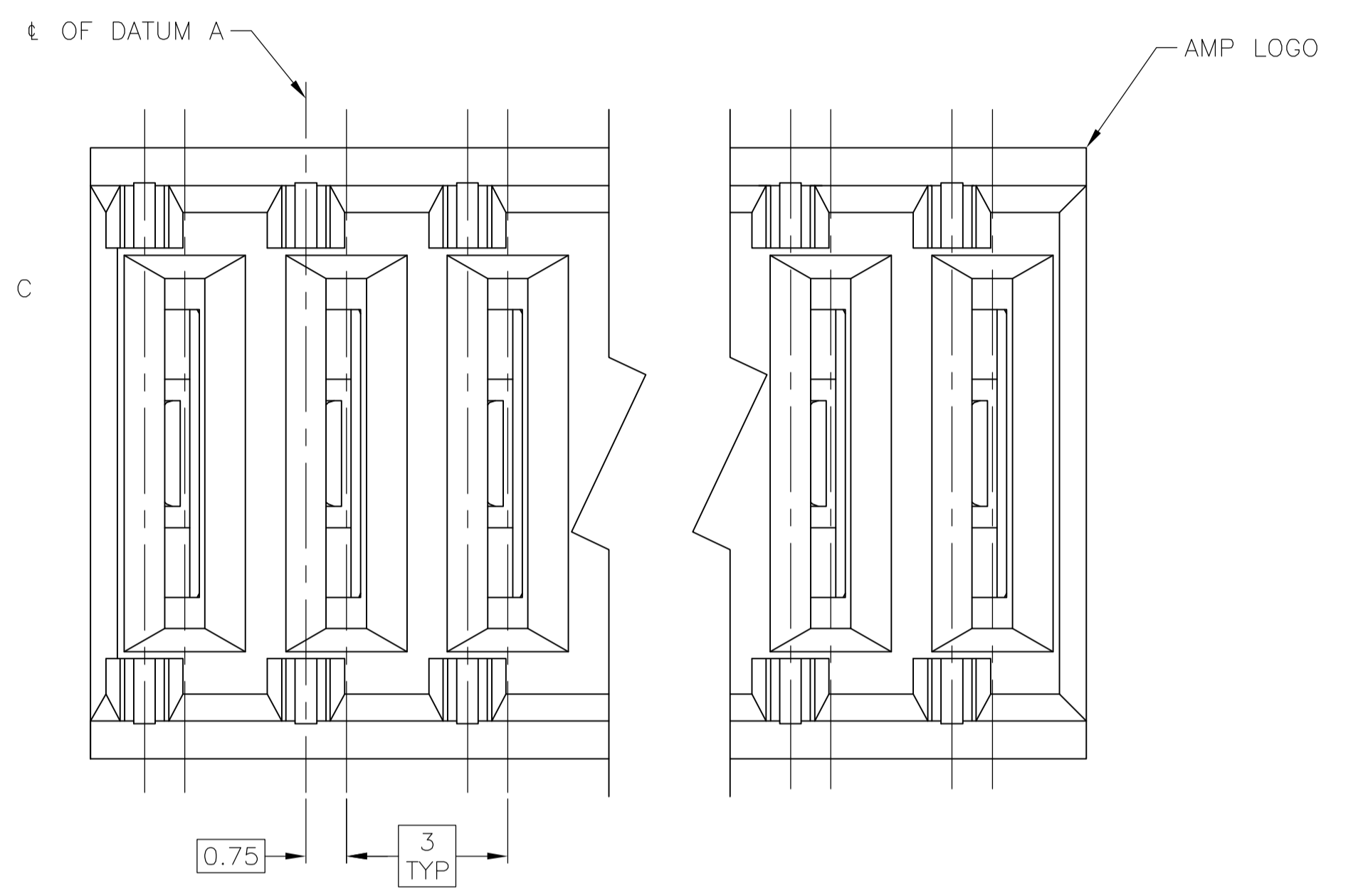
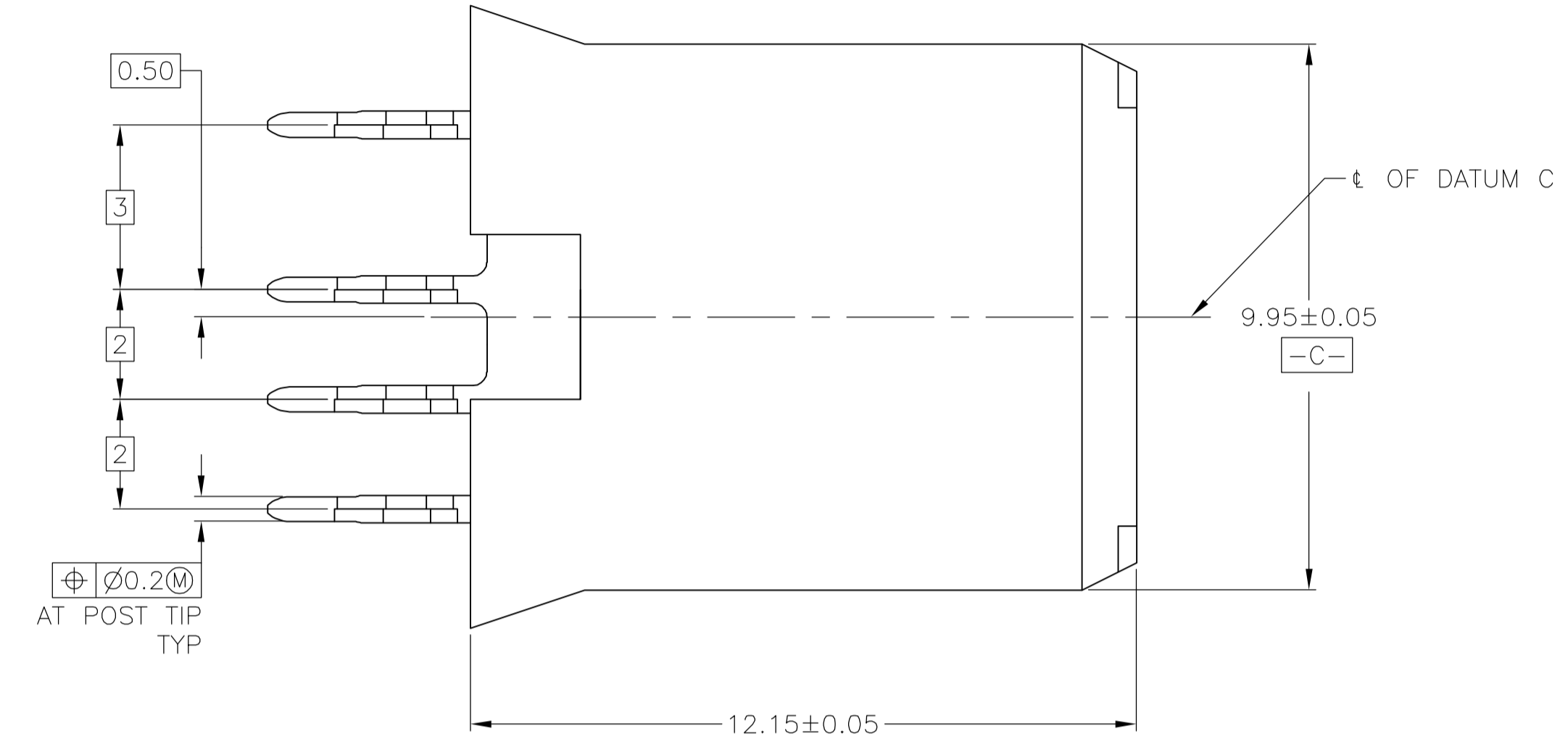
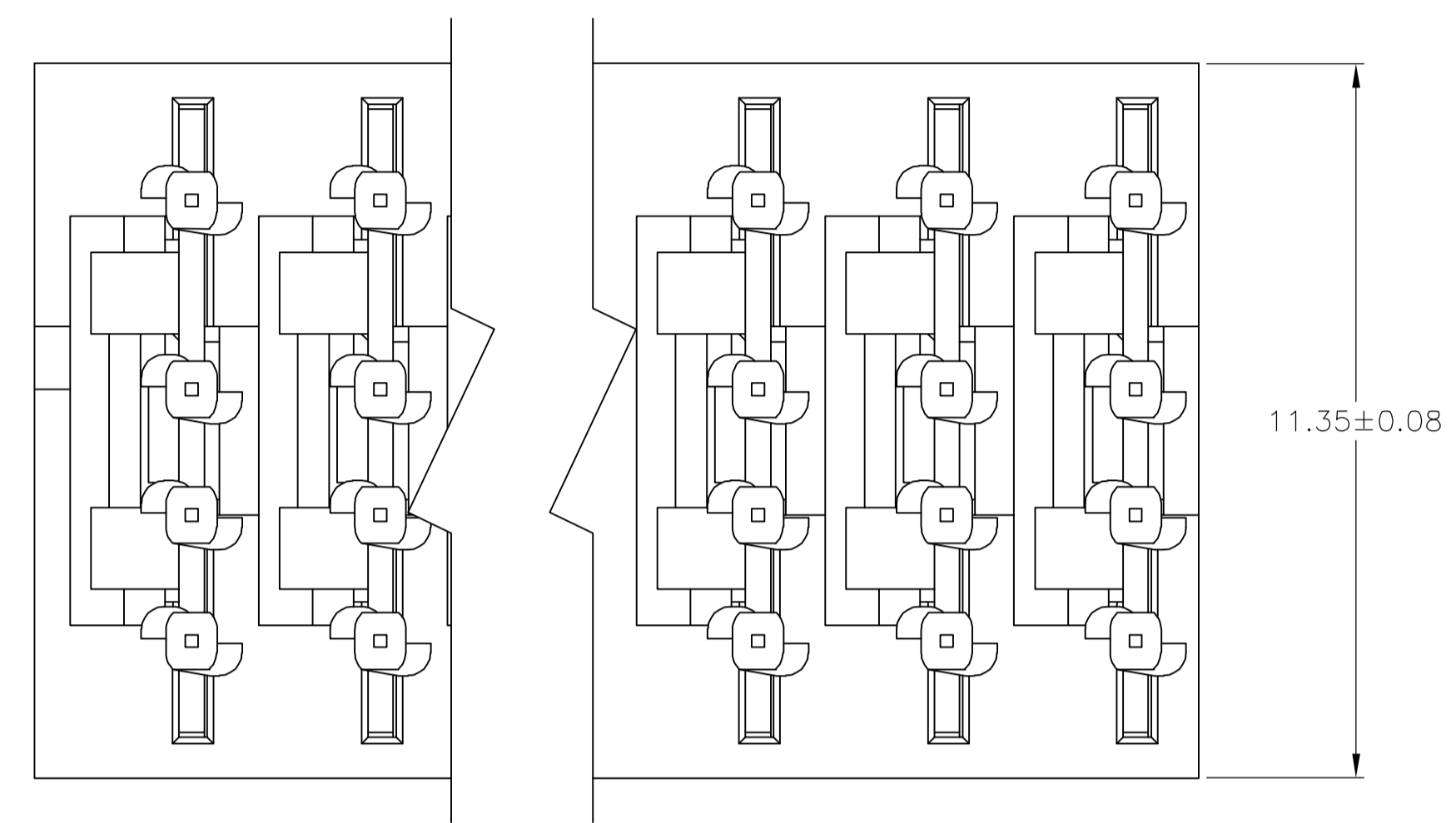

RECOMMENDED PCB HOLE LAYOUT

SIZE	DATE CODE	DRAWING NO	RESTRICTED TO
B	A	POSITION	PART NUMBER
36.5	11	12	120992-9
27.5	8	9	120992-6

THIS DRAWING IS A CONTROLLED DOCUMENT.

DIMENSIONS:	TOLERANCES UNLESS OTHERWISE SPECIFIED:	DIN	06OCT06	tyco	Tyco Electronics Corporation
mm	0 PLC ± -	CHK	06OCT06	Electronics	Harrisburg, Pa 17105-3608
	1 PLC ± -	APP'D	06OCT06		
	2 PLC ± 0.13	NAME			
	3 PLC ± -	PRODUCT SPEC			RECEPTACLE ASSEMBLY, UNIVERSAL POWER MODULE
	4 PLC ± -	APPLICATION SPEC			
	ANGLES ± -	SIZE	A1	00779	120992
MATERIAL	FINISH	WEIGHT			
1	2	CUSTOMER DRAWING	SCALE	10:1	SHEET 1 OF 1 REV A2