



Chipsmall Limited consists of a professional team with an average of over 10 year of expertise in the distribution of electronic components. Based in Hongkong, we have already established firm and mutual-benefit business relationships with customers from,Europe,America and south Asia,supplying obsolete and hard-to-find components to meet their specific needs.

With the principle of “Quality Parts,Customers Priority,Honest Operation,and Considerate Service”,our business mainly focus on the distribution of electronic components. Line cards we deal with include Microchip,ALPS,ROHM,Xilinx,Pulse,ON,Everlight and Freescale. Main products comprise IC,Modules,Potentiometer,IC Socket,Relay,Connector.Our parts cover such applications as commercial,industrial, and automotives areas.

We are looking forward to setting up business relationship with you and hope to provide you with the best service and solution. Let us make a better world for our industry!



Contact us

Tel: +86-755-8981 8866 Fax: +86-755-8427 6832

Email & Skype: info@chipsmall.com Web: www.chipsmall.com

Address: A1208, Overseas Decoration Building, #122 Zhenhua RD., Futian, Shenzhen, China



Push button for PCB mounting



PMS IP67



PMS Variable height, IP40



Description

- Switches are possible with different heights
- High-quality gold contacts
- Solder terminals

Unique Selling Proposition

- Reliable tactile feedback on input
- Simple assembly
- Long life time

Weblinks

[html-datasheet](#), [General Product Information](#), [CE declaration of conformity](#), [RoHS](#), [CHINA-RoHS](#), [CAD-Drawings](#), [Product News](#), [Detailed request for product](#)

Technical Data

Electrical Data

Switching Voltage	30 VAC/ 42 VDC
Switching Current	50 mA
Rated Switching Capacity	0.12 W
Lifetime	> 1 million actuations at Rated Switching Capacity
Contact Resistance	< 50 mΩ < 150 mΩ after lifetime
Insulation Resistance	> 100 MΩ
Duration of Bounce	typ. 0.15 ms

Mechanical Data

Actuating Force	IP 40: 1.8 ± 0.4 N IP 67: 2.2 ± 0.4 N
Actuating Travel	0.35 ± 0.1 mm
End Stop Strength	< 100 N
Lifetime	> 1 million actuations

Climatical Data

Operating Temperature	-40 °C to 85 °C
Storage Temperature	-40 °C to 85 °C
IP-Protection	IP 40 and IP 67

Soldering Data

Soldering Methods	Wave
Solderability	245 °C / 5 sec (IEC 60068-2-58 Test Td)
Resistance to Soldering Heat	260 °C / 10 sec (IEC 60068-2-58 Test Td)

Material

Sealing membrane IP 67	VMQ
Contact Material Gold	CuZn37 1.5 μm Ni 0.5 μm Au
Terminals	CuZn37 8 μm SnPb
Socket	Thermoplastic (PA 4.6)
Actuator	Thermoplastic (PPS)
Cover of Actuator	X 12 CrNi 17 7
Elongated Button	Thermoplastic (PC)

Detailed information on product approvals, code requirements, usage instructions and detailed test conditions can be looked up in [General Product Information](#)

Dimension

PMS PCB Base module

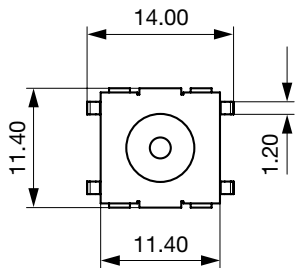
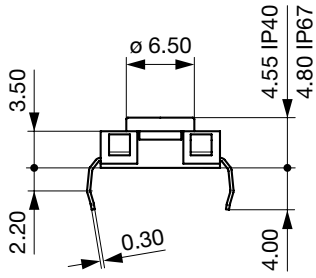

PMS PCB Variable height

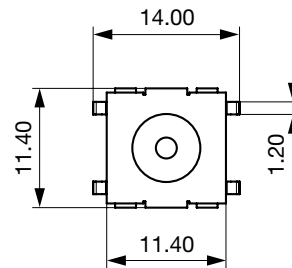
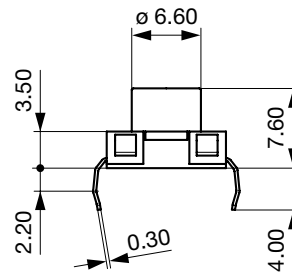

PMS PCB with elongated button

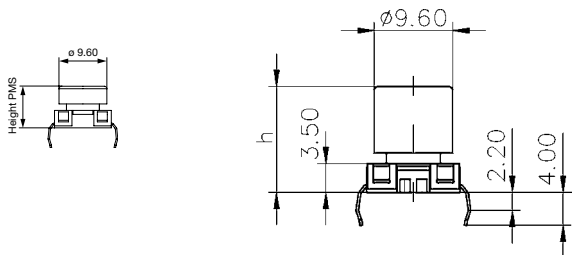

Diagrams

Circuit Diagram SMS/PMS

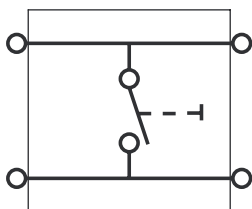

All Variants

IP Protection Class Front Side	Terminal	Type	Overall height / Color	Order Number
IP 40	-	Short actuator	-	1241.1602
IP 40	-	Long actuator	-	1241.1614
IP 67	-	Short actuator	-	1241.1608
IP 67	-	Long actuator	-	1241.1620
IP 40	-	Height variable	8.35 mm / yellow	1241.1624.1
IP 67	-	Height variable	8.35 mm / yellow	1241.1625.1
IP 40	-	Height variable	9.10 mm / orange	1241.1624.2
IP 67	-	Height variable	9.10 mm / orange	1241.1625.2
IP 40	-	Height variable	9.85 mm / red	1241.1624.3
IP 67	-	Height variable	9.85 mm / red	1241.1625.3
IP 40	-	Height variable	10.60 mm / blue	1241.1624.4
IP 67	-	Height variable	10.60 mm / blue	1241.1625.4
IP 40	-	Height variable	11.35 mm / green	1241.1624.5
IP 67	-	Height variable	11.35 mm / green	1241.1625.5
IP 40	-	Height variable	12.10 mm / grey	1241.1624.6
IP 67	-	Height variable	12.10 mm / grey	1241.1625.6
IP 40	-	Height variable	12.85 mm / black	1241.1624.7
IP 67	-	Height variable	12.85 mm / black	1241.1625.7
IP 40	-	Height variable	13.60 mm / white	1241.1624.8
IP 67	-	Height variable	13.60 mm / white	1241.1625.8
IP 40	-	Height variable	14.35 mm / yellow + black	1241.1624.11
IP 67	-	Height variable	14.35 mm / yellow + black	1241.1625.11
IP 40	-	Height variable	15.10 mm / orange + black	1241.1624.21
IP 67	-	Height variable	15.10 mm / orange + black	1241.1625.21
IP 40	-	Height variable	15.85 mm / red + black	1241.1624.31
IP 67	-	Height variable	15.85 mm / red + black	1241.1625.31
IP 40	-	Height variable	16.60 mm / blue + black	1241.1624.41
IP 67	-	Height variable	16.60 mm / blue + black	1241.1625.41
IP 40	-	Height variable	17.35 mm / green + black	1241.1624.51
IP 67	-	Height variable	17.35 mm / green + black	1241.1625.51
IP 40	-	Height variable	18.10 mm / grey + black	1241.1624.61
IP 67	-	Height variable	18.10 mm / grey + black	1241.1625.61
IP 40	-	Height variable	18.85 mm / black + black	1241.1624.71
IP 67	-	Height variable	18.85 mm / black + black	1241.1625.71
IP 40	-	Height variable	19.60 mm / white + black	1241.1624.81
IP 67	-	Height variable	19.60 mm / white + black	1241.1625.81

Availability for all products can be searched real-time:<http://www.schurter.com/en/Stock-Check/Stock-Check-SCHURTER>

Starting with 14:50 mm the heights are realized with an additional (second) elongated button in black color

Packaging unit loose in boxes (100 pcs.)