



Chipsmall Limited consists of a professional team with an average of over 10 year of expertise in the distribution of electronic components. Based in Hongkong, we have already established firm and mutual-benefit business relationships with customers from,Europe,America and south Asia,supplying obsolete and hard-to-find components to meet their specific needs.

With the principle of "Quality Parts,Customers Priority,Honest Operation,and Considerate Service",our business mainly focus on the distribution of electronic components. Line cards we deal with include Microchip,ALPS,ROHM,Xilinx,Pulse,ON,Everlight and Freescale. Main products comprise IC,Modules,Potentiometer,IC Socket,Relay,Connector.Our parts cover such applications as commercial,industrial, and automotives areas.

We are looking forward to setting up business relationship with you and hope to provide you with the best service and solution. Let us make a better world for our industry!



## Contact us

Tel: +86-755-8981 8866 Fax: +86-755-8427 6832

Email & Skype: info@chipsmall.com Web: www.chipsmall.com

Address: A1208, Overseas Decoration Building, #122 Zhenhua RD., Futian, Shenzhen, China



THIS DRAWING IS UNPUBLISHED.  
 VERTRÄULICHE UNVERÖFFENTLICHTE ZEICHNUNG  
 © COPYRIGHT 2010 By -  
 RELEASED FOR PUBLICATION  
 FREI FUER VERÖFFENTLICHUNG  
 ALL RIGHTS RESERVED.  
 ALLE RECHTE VORBEHALTEN  
 SEP, 1998.

LOC		DIST		REVISIONS				
IR		-		ÄNDERUNGEN		DATE	DWN	APVD
P	LTR	DESCRIPTION		BESCHREIBUNG				
	A10	PACKAGING QTY AND BLISTER BELT COLOR CHANGE		22NOV2012		KJK	RP	

Pos.	L -1.0	PN	
2	5.08	966709-2	
3	7.62	966709-3	
4	10.16	966709-4	
5	12.7	<del>966709-5</del>	OBSOLETE
6	15.24	966709-6	
7	17.78	966709-7	
8	20.32	966709-8	
9	22.86	966709-9	
10	25.4	<del>966709-0</del>	OBSOLETE
11	27.94	<del>966709-1</del>	OBSOLETE
12	30.48	<del>966709-2</del>	OBSOLETE
13	33.02	<del>966709-3</del>	OBSOLETE
14	35.56	<del>966709-4</del>	OBSOLETE
15	38.1	<del>966709-5</del>	OBSOLETE
16	40.64	<del>966709-6</del>	OBSOLETE
17	43.18	<del>966709-7</del>	OBSOLETE

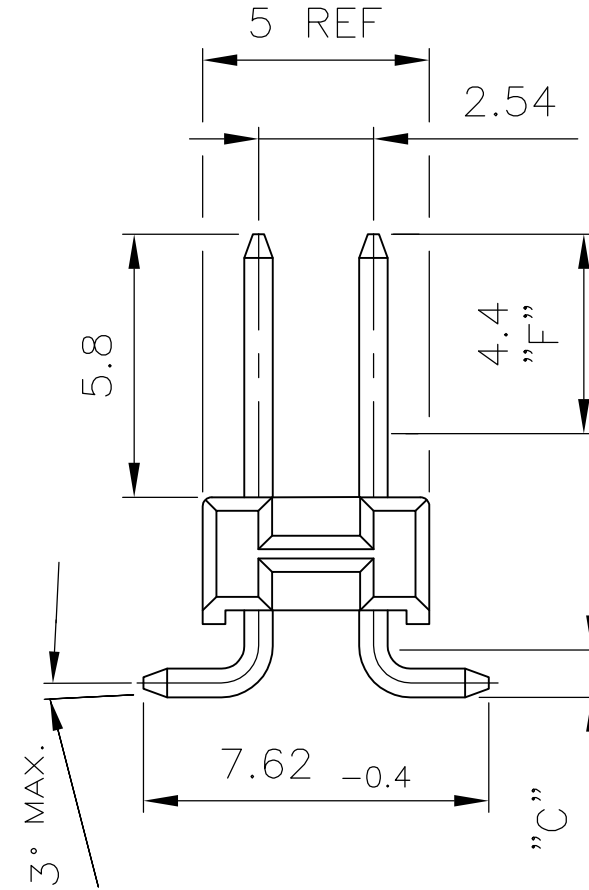
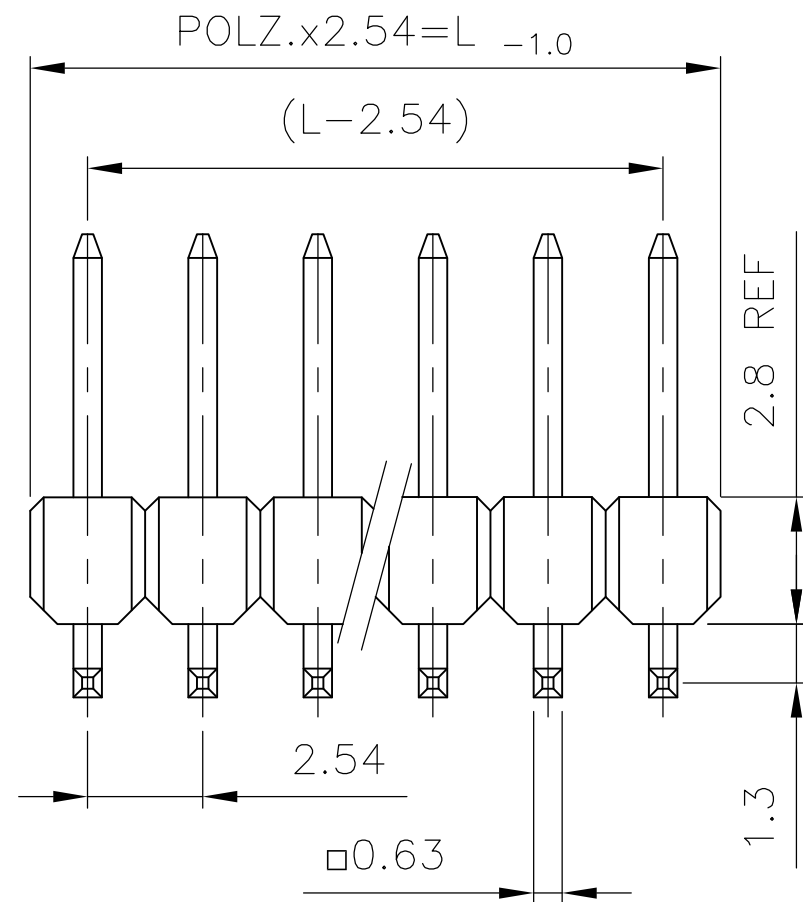

EMPFHOLENES LEITERPLATTEN LAYOUT  
 RECOMMENDED PCB-LAYOUT

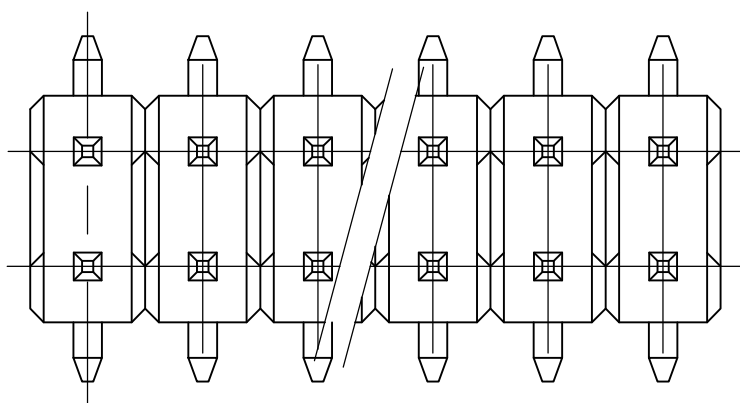
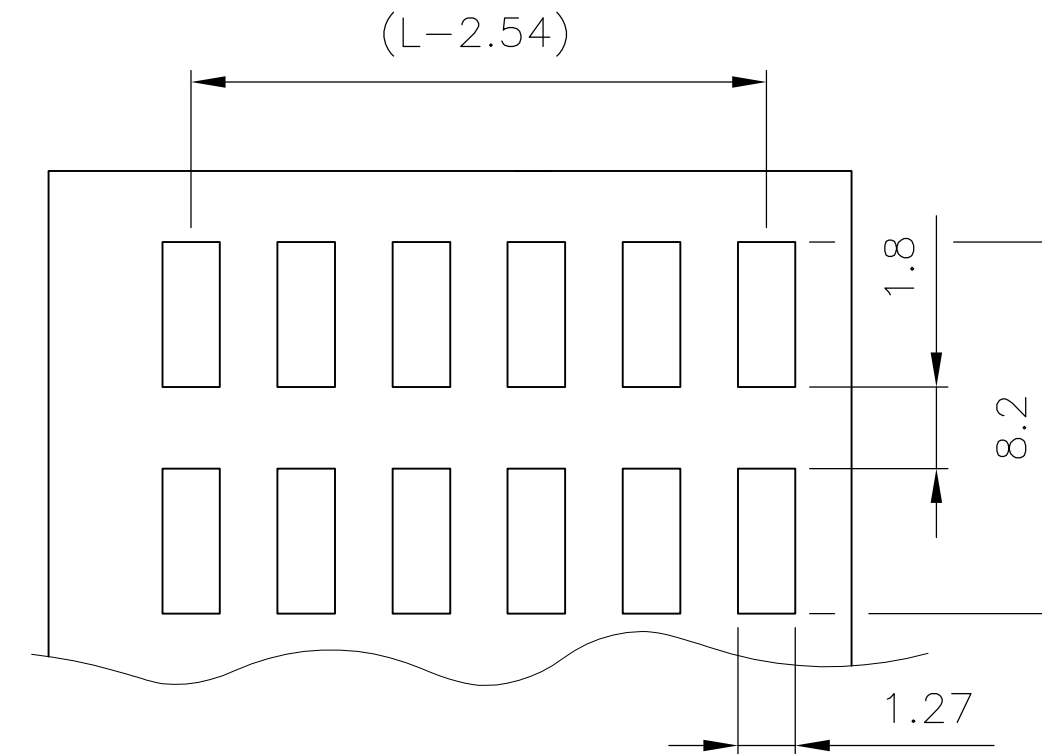

1 MATING SIDE: WITHIN THE RANGE "F" 0.8µm GOLD OVER 1.27µm NI  
 SOLDER SIDE: WITHIN THE RANGE "C" MIN. 2.5µm TIN OVER 1.27µm NI  
 STECKSEITE: IM BEREICH "F" 0.8µm GOLD ÜBER 1.27µm Ni  
 LÖTSEITE: IM BEREICH "C" MIN. 2.5µm ZINN ÜBER 1.27µm Ni

KONTAKTSTIFT / CONTACT PIN	Cu Sn	1	2
STIFTGEHÄUSE / PIN HOUSING	PCT-GV	SCHWARZ / BLACK	1
BENENNUNG EINZELTEIL PART DESCRIPTION	WERKSTOFF MATERIAL	OBERFLÄCHE / FARBE SURFACE / COLOR	SI No

THIS DRAWING IS A CONTROLLED DOCUMENT. DIESE ZEICHNUNG IST EIN KONTROLLIERTES DOKUMENT.		DWN F.REICHARDT 16-SEP-98	TE Connectivity	
DIMENSIONS: MASSENHETEN mm		CHK M.SCHAARSCHMIDT 16-SEP-98	NAME	
TOLERANCES UNLESS OTHERWISE SPECIFIED: ALL GEMEINTOLERANZEN TOL ± 0.2		APVD G.FELDMEIER	AMPMODU II PIN HEADER PACKED IN BLISTER AMPMODU II STIFTELEISTE VERPACKT IN BLISTER	
MATERIAL SEE TABLE SIEHE TABELLE		PRODUCT SPEC PRODUKTSPEZ.	SIZE A2	RESTRICTED TO NUR FUER
FINISH/OBERFLÄCHE/FARBE SEE TABLE SIEHE TABELLE		APPLICATION SPEC. VERARBEITUNGSSPEZ.	CAGE CODE 00779	DRAWING NO. ZEICHNUNGS-NR. 1241050
WEIGHT GEWICHT		SCALE MASSSTAB	SHEET BLATT	REV A10
CUSTOMER DRAWING / KUNDENZEICHNUNG		SCALE 1:2	SHEET 1 OF 3	REV A10

LOC	DIST	P	LTR	REVISIONS ÄNDERUNGEN	DATE	DWN	APVD
IR	-	-	-	DESCRIPTION BESCHREIBUNG	-	-	-
SEE SHEET 1							

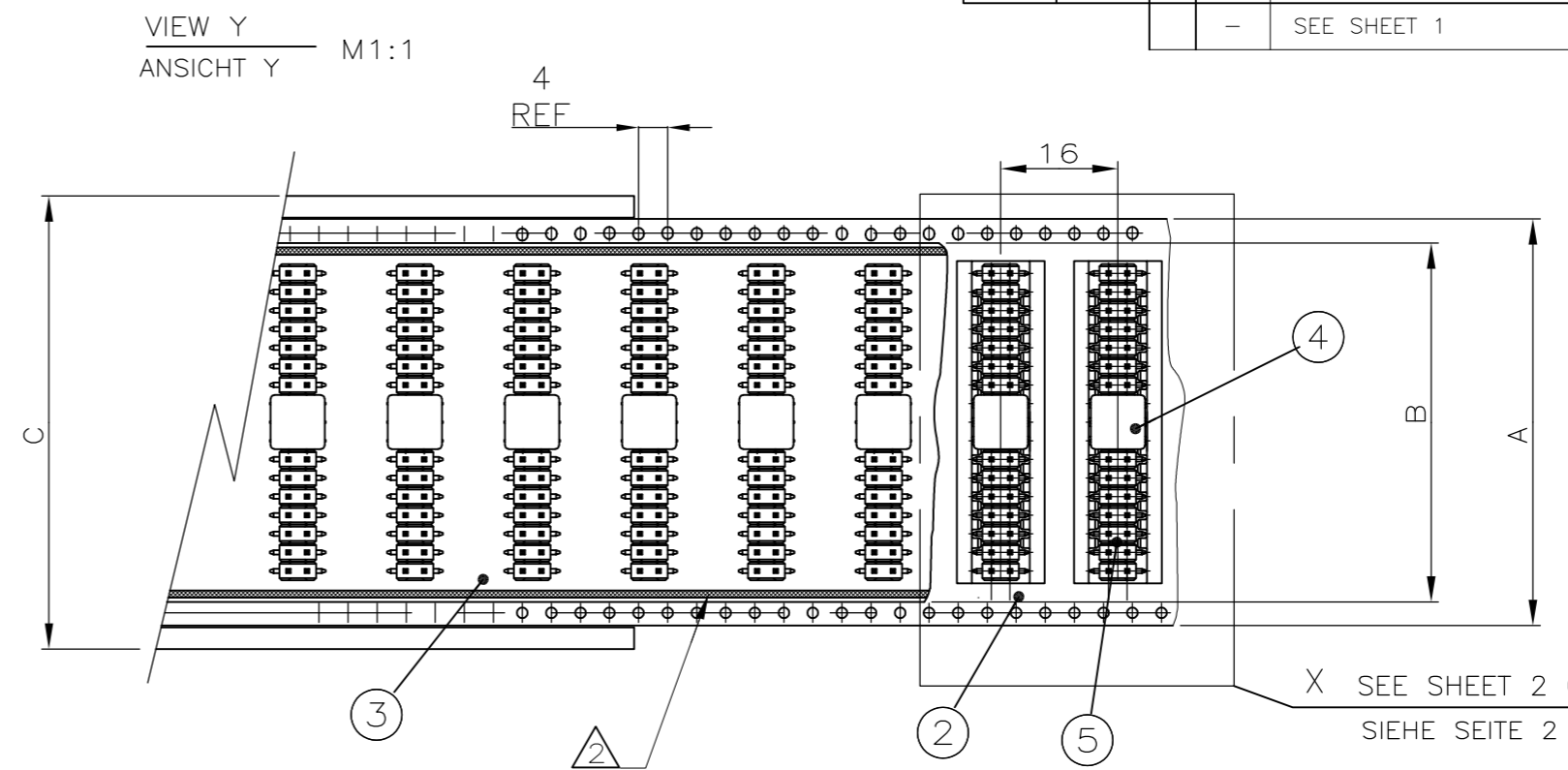
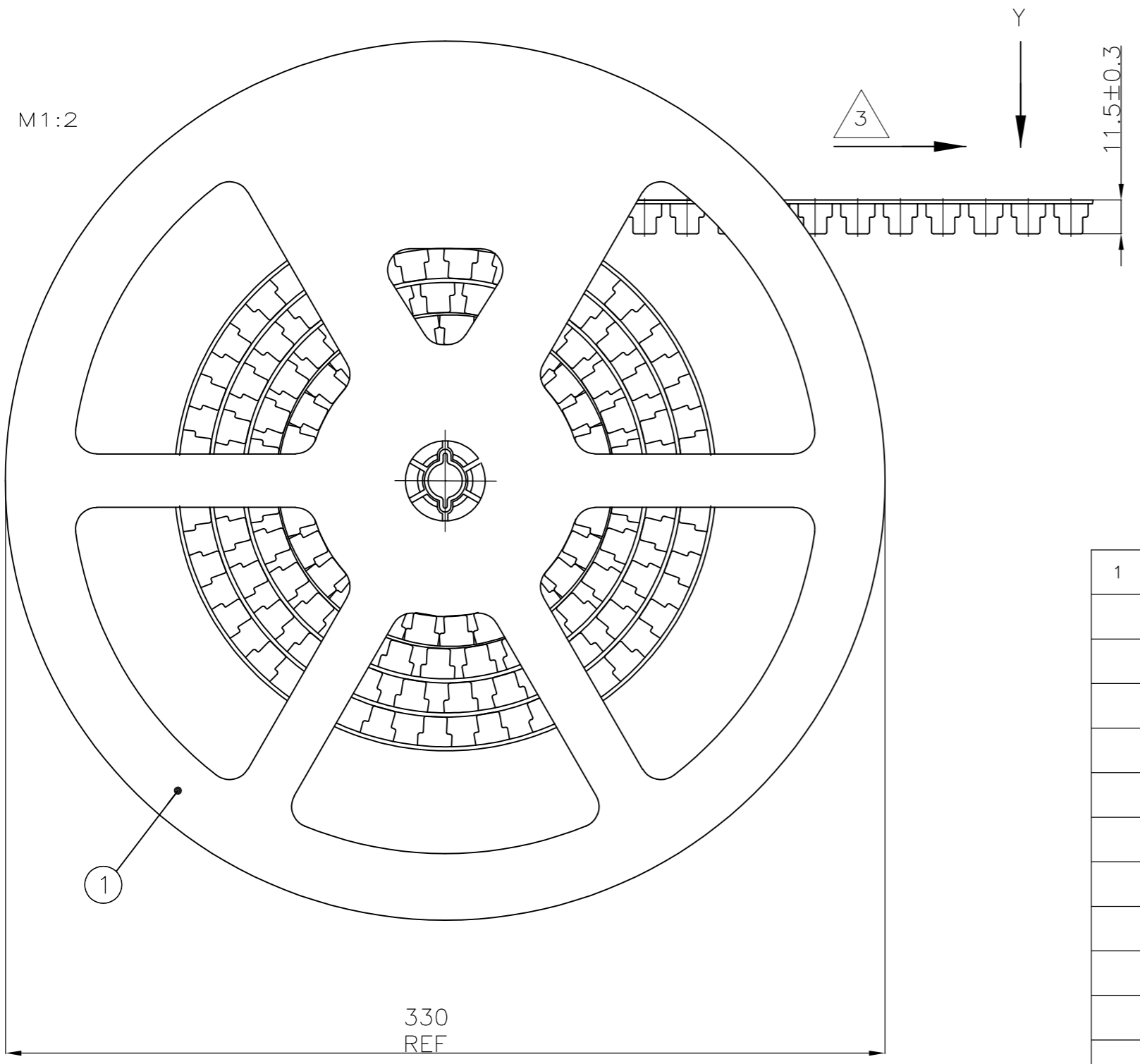

X SEE SHEET 2 OF 2  
SIEHE SEITE 2 VON 2

- NOTES:
- ⚠ SEE SHEET 1 OF 3
  - ⚠ PACKING: 350 PINHEADERS WITH ADAPTER PER REEL  
6.8m BLISTER PER REEL  
6.8m COVER TAPE
  - ⚠ DIRECTION OF THE TOP OF THE REEL
  - ⚠ COVER TAPE WITH BLISTER BELT WELDED
  - 5. PACKING ACCORDING DIN/IEC 286 RESPECTIVE EIA 481  
INCLUSIVE DECLARATIONS ABOUT THE FIRST AND LAST RUNNING  
(DIN/IEC 286 PART 3)
  - 6. ARRANGEMENT OF PIN HEADERS IN BLISTER BELT SEE SHEET 2 OF 3
  - ⚠ PACKING: 300 PINHEADERS WITH ADAPTER PER REEL  
6.0m BLISTER PER REEL  
6.0m COVER TAPE
  - ⚠ OBSOLETE
- 
- BEMERKUNGEN:
- ⚠ SIEHE BLATT 1 VON 3
  - ⚠ VERPACKUNG: 375 STIFTLAISTEN MIT ADAPTER PRO SPULE  
6.8m BLISTER PRO SPULE  
6.8m ABDECKFOLIE PRO SPULE
  - ⚠ ABWICKELRICHTUNG
  - ⚠ ABDECKFOLIE MIT BLISTERGURT VERSCHWEIßT
  - 5. VERPACKUNG ENTSPRECHEND DIN/IEC 286 BZW. EIA 481  
INKLUSIVE ANGABEN ÜBER DEN VOR- UND NACHLAUF  
(DIN/IEC 286 TEIL 3)
  - 6. ANORDNUNG DER STIFTLAISTEN IM BLISTERGURT SIEHE BLATT 2 VON 3
  - ⚠ VERPACKUNG: 325 STIFTLAISTEN MIT ADAPTER PRO SPULE  
6.0m BLISTER PRO SPULE  
6.0m ABDECKFOLIE PRO SPULE

1																		5	AMPMODU II PIN HEADER,SMD,2x17pos 1- 966709-7 AMPMODU II STIFTLAISTE,SMD, 2x17pol.	1	1
	1																	5	AMPMODU II PIN HEADER,SMD,2x16pos 1- 966709-6 AMPMODU II STIFTLAISTE,SMD, 2x16pol.	1	1
		1																5	AMPMODU II PIN HEADER,SMD,2x15pos 1- 966709-5 AMPMODU II STIFTLAISTE,SMD, 2x15pol.	1	1
			1															5	AMPMODU II PIN HEADER,SMD,2x14pos 1- 966709-4 AMPMODU II STIFTLAISTE,SMD, 2x14pol.	1	1
				1														5	AMPMODU II PIN HEADER,SMD,2x13pos 1- 966709-3 AMPMODU II STIFTLAISTE,SMD, 2x13pol.	1	1
					1													5	AMPMODU II PIN HEADER,SMD,2x12pos 1- 966709-2 AMPMODU II STIFTLAISTE,SMD, 2x12pol.	1	1
						1												5	AMPMODU II PIN HEADER,SMD,2x11pos 1- 966709-1 AMPMODU II STIFTLAISTE,SMD, 2x11pol.	1	1
							1											5	AMPMODU II PIN HEADER,SMD,2x10pos 1- 966709-0 AMPMODU II STIFTLAISTE,SMD, 2x10pol.	1	1
								1										5	AMPMODU II PIN HEADER,SMD,2x9pos 966709-9 AMPMODU II STIFTLAISTE,SMD, 2x9pol.	1	1
									1									5	AMPMODU II PIN HEADER,SMD,2x8pos 966709-8 AMPMODU II STIFTLAISTE,SMD, 2x8pol.	1	1
										1								5	AMPMODU II PIN HEADER,SMD,2x7pos 966709-7 AMPMODU II STIFTLAISTE,SMD, 2x7pol.	1	1
											1							5	AMPMODU II PIN HEADER,SMD,2x6pos 966709-6 AMPMODU II STIFTLAISTE,SMD, 2x6pol.	1	1
												1						5	AMPMODU II PIN HEADER,SMD,2x5pos 966709-5 AMPMODU II STIFTLAISTE,SMD, 2x5pol.	1	1
													1					5	AMPMODU II PIN HEADER,SMD,2x4pos 966709-4 AMPMODU II STIFTLAISTE,SMD, 2x4pol.	1	1
														1				5	AMPMODU II PIN HEADER,SMD,2x3pos 966709-3 AMPMODU II STIFTLAISTE,SMD, 2x3pol.	1	1
															1			5	AMPMODU II PIN HEADER,SMD,2x2pos 966709-2 AMPMODU II STIFTLAISTE,SMD, 2x2pol.	1	1
1	1	1	1	1	1	1	1	1	1	1	1	1	1	1	1	-	4	ADAPTER	LCP	BLACK / SCHWARZ	
-	-	-	-	-	-	-	-	-	-	-	-	-	-	-	-	1	4	ADAPTER	LCP	BLACK / SCHWARZ	
⚠	⚠	⚠	⚠	⚠	⚠	⚠	⚠	⚠	⚠	⚠	⚠	⚠	⚠	⚠	⚠	⚠	3	COVER TAPE/ABDECKFOLIE B=49.4	PET	TRANSPARENT	
																	3	COVER TAPE/ABDECKFOLIE B=37.4	PET	TRANSPARENT	
																	3	COVER TAPE/ABDECKFOLIE B=25.4	PET	TRANSPARENT	
																	3	COVER TAPE/ABDECKFOLIE B=13.4	PET	TRANSPARENT	
⚠	⚠	⚠	⚠	⚠	⚠	⚠	⚠	⚠	⚠	⚠	⚠	⚠	⚠	⚠	⚠	⚠	2	BLISTER BELT/BLISTERGURT A=56.0	PS	BLACK / SCHWARZ	
																	2	BLISTER BELT/BLISTERGURT A=44.0	PS	BLACK / SCHWARZ	
																	2	BLISTER BELT/BLISTERGURT A=32.0	PS	BLACK / SCHWARZ	
																	2	BLISTER BELT/BLISTERGURT A=16.0	PS	BLACK / SCHWARZ	
⚠	⚠	⚠	⚠	⚠	⚠	⚠	⚠	⚠	⚠	⚠	⚠	⚠	⚠	⚠	⚠	⚠	1	REEL C=62.4	PS	GREY/GRAU	
																	1	REEL C=50.4	PS	GREY/GRAU	
																	1	REEL C=38.4	PS	GREY/GRAU	
																	1	REEL C=22.4	PS	GREY/GRAU	
1-7	1-6	1-5	1-4	1-3	1-2	1-1	1-0	-9	-8	-7	-6	-5	-4	-3	-2	POS.	DESCRIPTION / BENENNUNG	SURFACE / OBERFLÄCHE COLOUR / FARBE	MATERIAL		

THIS DRAWING IS A CONTROLLED DOCUMENT. DIESE ZEICHNUNG IST EIN KONTROLLIERTES DOKUMENT.		DWN	F.REICHARDT	16-SEP-98
DIMENSIONS: MASSENGHEITEN mm		CHK	M.SCHAARSCHMIDT	16-SEP-98
TOLERANCES UNLESS OTHERWISE SPECIFIED: ALLGEMEINTOLERANZEN		APVD	G.FELDMEIER	-
0 PLC ± 0.2		NAME		
1 PLC ± 0.1		AMPMODU II PIN HEADER PACKED IN BLISTER AMPMODU II STIFTLAISTE VERPACKT IN BLISTER		
2 PLC ± 0.1		SIZE	A2	CAGE CODE
3 PLC ± -		DRAWING NO	00779	ZEICHNUNGS-NR.
4 PLC ± -		SCALE	1:2	SHEET
ANGLES / WINKEL ± -		WEIGHT	1:1	BLATT
FINISH / OBERFLÄCHE / FARBE		RESTRICTED TO		NUR FUER
MATERIAL		REV		
SEE TABLE SIEHE TABELLE		CUSTOMER DRAWING / KUNDENZEICHNUNG		

THIS DRAWING IS UNPUBLISHED.  
 VERTRÄULICHE UNVERÖFFENTLICHTE ZEICHNUNG  
 © COPYRIGHT 2010 By -

RELEASED FOR PUBLICATION  
 FREI FUER VERÖFFENTLICHUNG  
 ALL RIGHTS RESERVED.  
 ALLE RECHTE VORBEHALTEN

SEP, 1998.

LOC	DIST	REVISIONS			DATE	DWN	APVD
IR	-	P	LTR	AENDERUNGEN	-	-	-
		DESCRIPTION					
		BESCHREIBUNG					
		SEE SHEET 1					

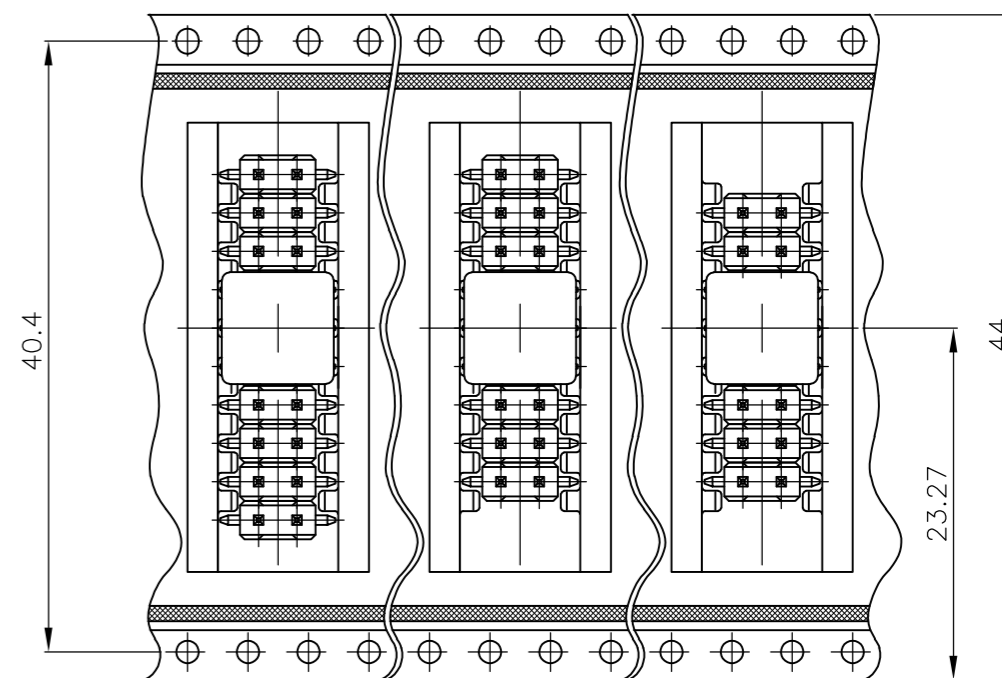
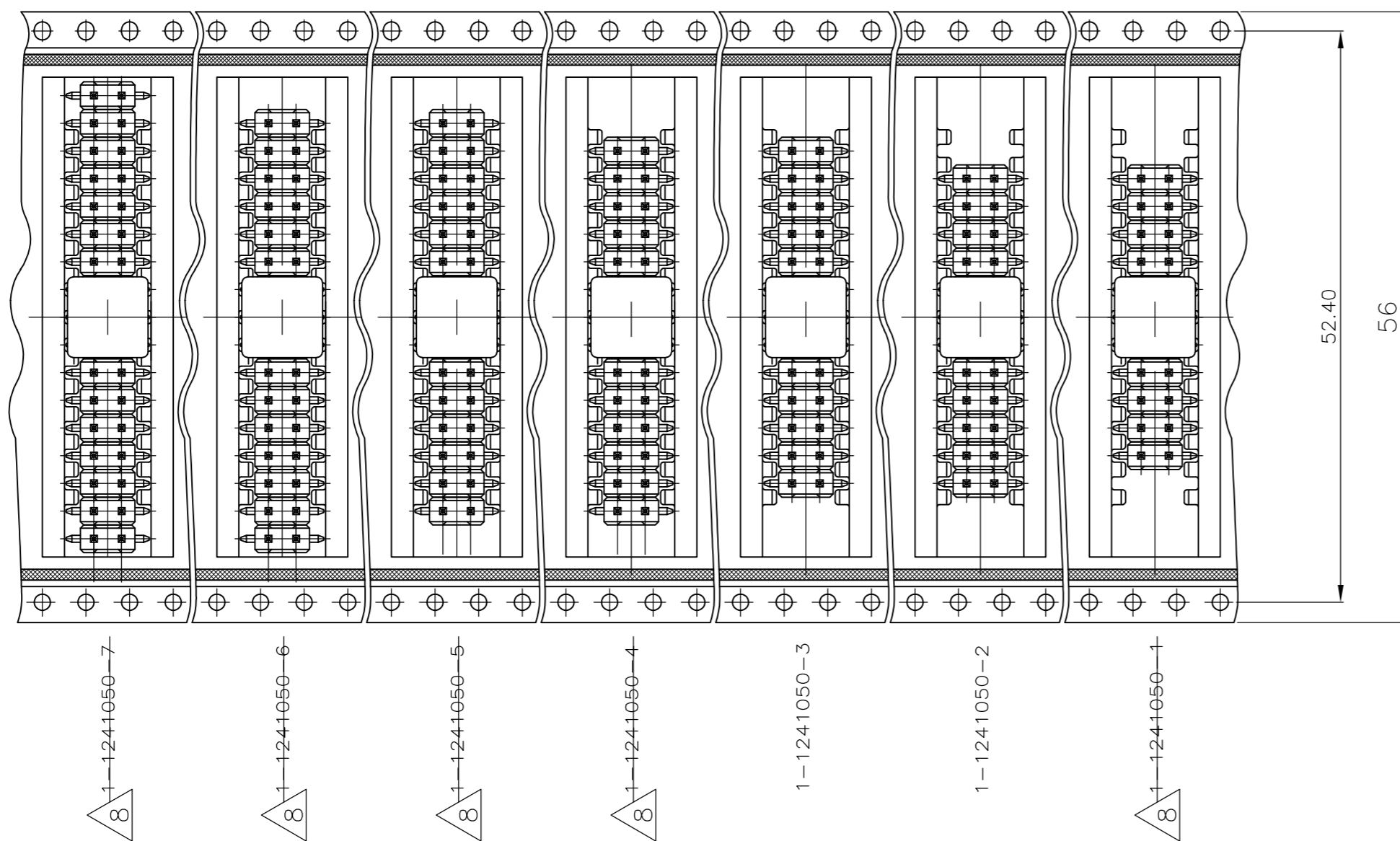
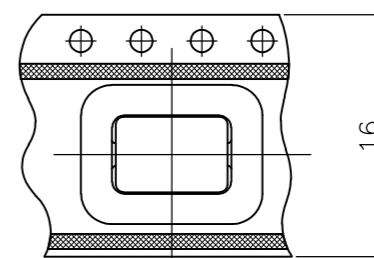
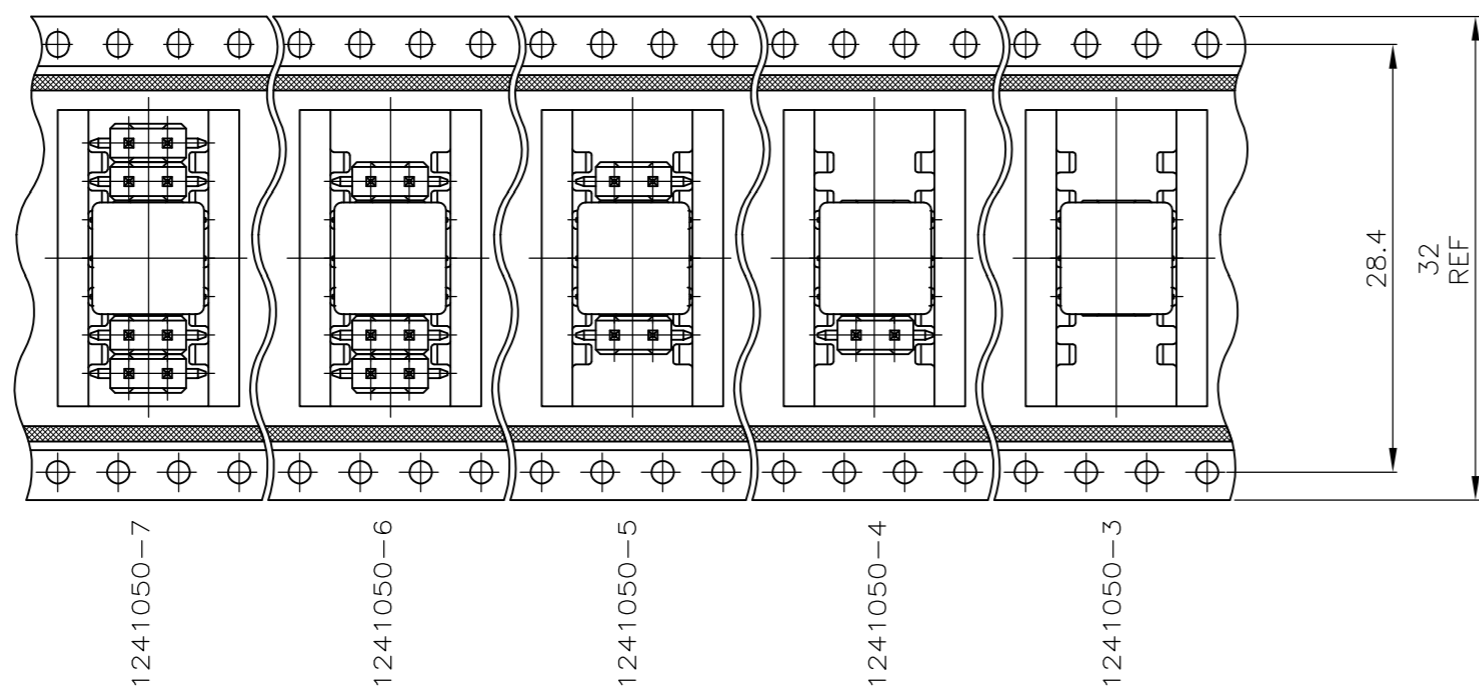

THIS DRAWING IS A CONTROLLED DOCUMENT. DIESE ZEICHNUNG IST EIN KONTROLLIERTES DOKUMENT.		DWN F.REICHARDT 16-SEP-98	 TE Connectivity			
DIMENSIONS: MASSENGHEITEN mm		CHK M.SCHAARSCHMIDT 16-SEP-98				
TOLERANCES UNLESS OTHERWISE SPECIFIED: ALLGEMEINTOLERANZEN		APVD G.FELDMEIER	NAME AMPMODU II PIN HEADER PACKED IN BLISTER AMPMODU II STIFTLISTE VERPACKT IN BLISTER			
 0 PLC ± 0.2 1 PLC ± 0.1 2 PLC ± 0.1 3 PLC ± - 4 PLC ± - ANGLES / WINKEL ± - FINISH / OBERFLAECHE / FARBE		PRODUCT SPEC PRODUKTSPEZ. -	SIZE A2	CAGE CODE 00779	DRAWING NO. ZEICHNUNGS-NR. 1241050	RESTRICTED TO NUR FUER -
MATERIAL		APPLICATION SPEC. VERARBEITUNGSSPEZ. -	SCALE MASSTAB 1:1	SHEET BLATT 3	OF VON 3	REV A10
		WEIGHT GEWICHT -	CUSTOMER DRAWING / KUNDENZEICHNUNG			