



Chipsmall Limited consists of a professional team with an average of over 10 year of expertise in the distribution of electronic components. Based in Hongkong, we have already established firm and mutual-benefit business relationships with customers from,Europe,America and south Asia,supplying obsolete and hard-to-find components to meet their specific needs.

With the principle of “Quality Parts,Customers Priority,Honest Operation,and Considerate Service”,our business mainly focus on the distribution of electronic components. Line cards we deal with include Microchip,ALPS,ROHM,Xilinx,Pulse,ON,Everlight and Freescale. Main products comprise IC,Modules,Potentiometer,IC Socket,Relay,Connector.Our parts cover such applications as commercial,industrial, and automotives areas.

We are looking forward to setting up business relationship with you and hope to provide you with the best service and solution. Let us make a better world for our industry!



Contact us

Tel: +86-755-8981 8866 Fax: +86-755-8427 6832

Email & Skype: info@chipsmall.com Web: www.chipsmall.com

Address: A1208, Overseas Decoration Building, #122 Zhenhua RD., Futian, Shenzhen, China



THIS DRAWING IS UNPUBLISHED. RELEASED FOR PUBLICATION .19
 © COPYRIGHT 19 BY AMP INCORPORATED. ALL RIGHTS RESERVED.

LOC		DIST		REVISIONS			
P	LTR	DESCRIPTION	DATE	DWN	APVD		
	A	REV PER EC 0A00-0088-99	3-1-99	DDE	JE		
	B	REVISE PER ECR-05-010010	01SEPT2005	BB	SB		
	B1	REVISED PER ECO-10-000445	27JAN10	KK	HMR		

1 MATERIAL:
 HOUSING: ZINC
 RETAINER: PEI-GF30, COLOR: BLACK*
 ALIGNMENT SLEEVE: SEE DASH NO'S
 PROTECTIVE CAP: VINYL
 PROTECTIVE COVER: TPE, COLOR: BLACK*
 RETENTION CLIP: STAINLESS STEEL
 *UL94 V-0 RATED AT QUALIFYING THICKNESS.

2 BULK PACKAGE.

3 OBSOLETE PARTS: OBSOLETE CIS STREAMLINING PER D.RENAUD/D.SINISI

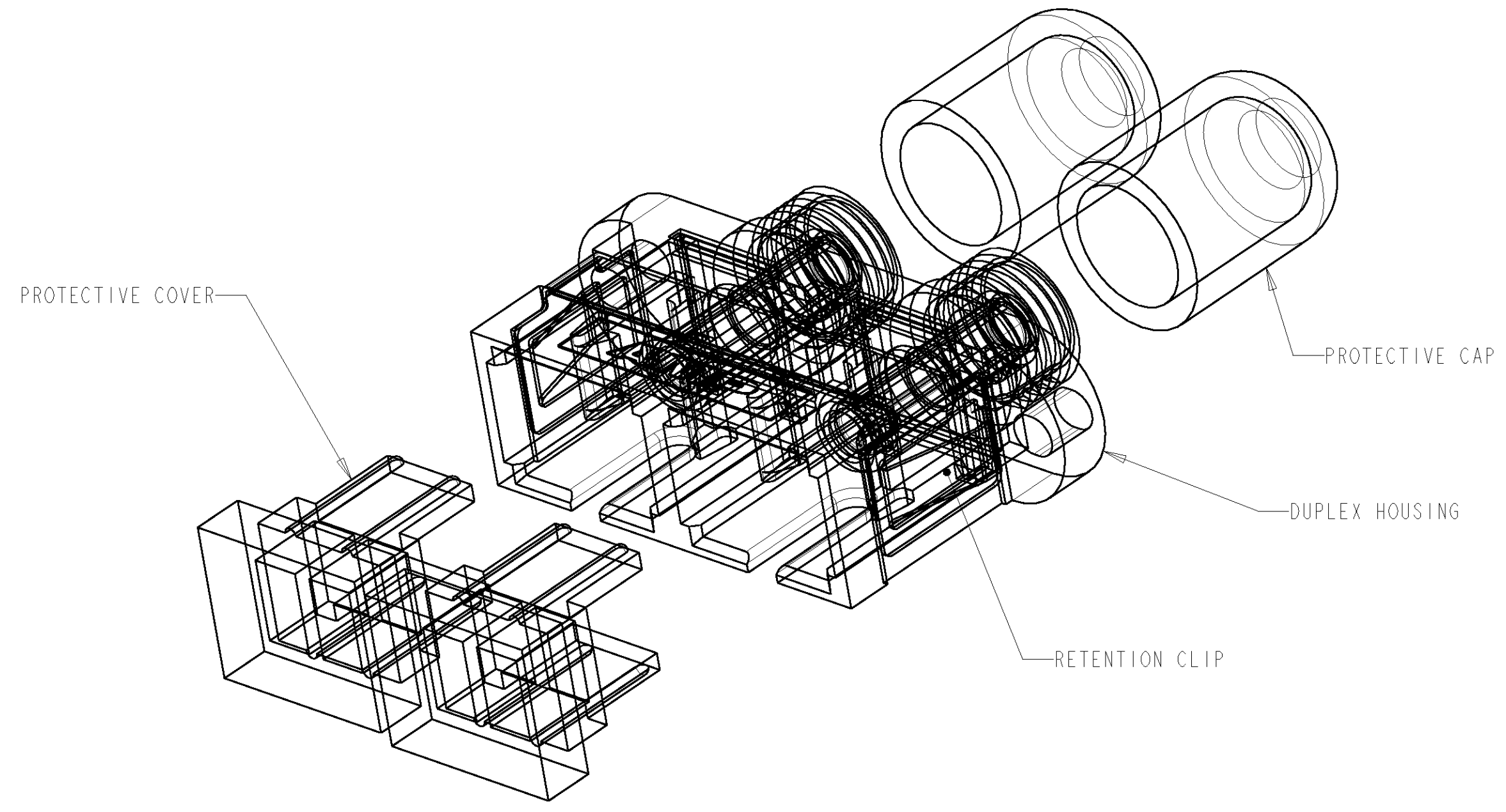
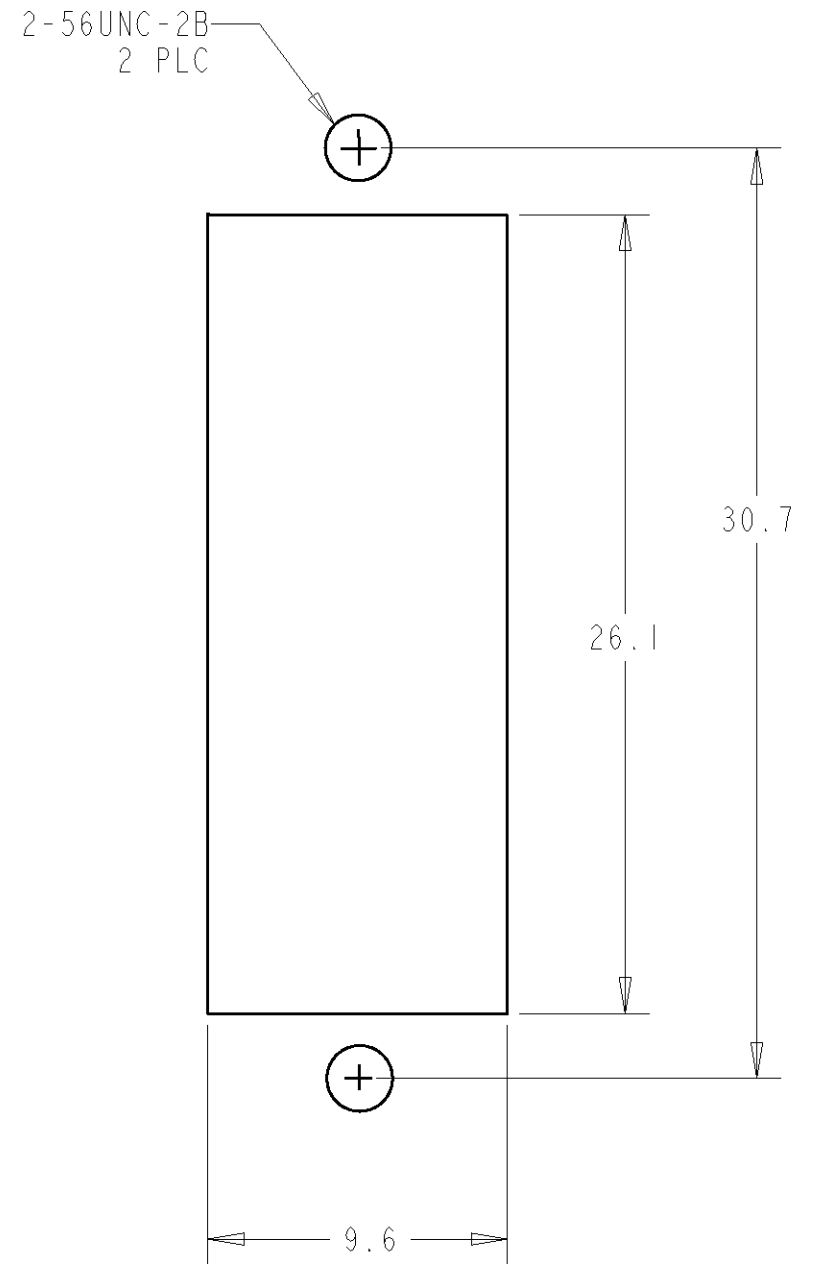
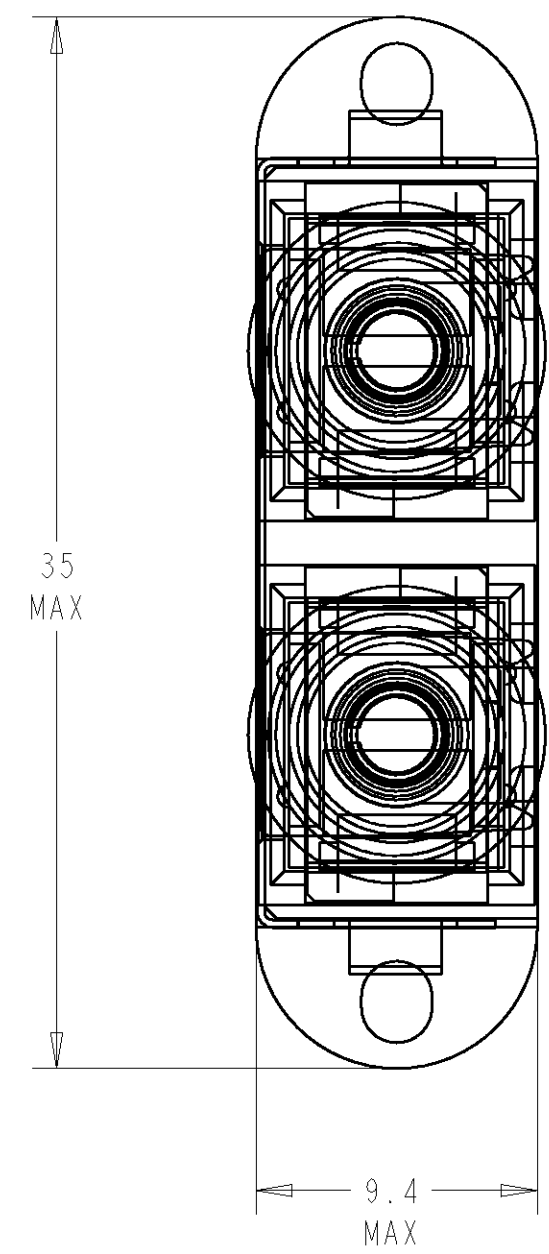
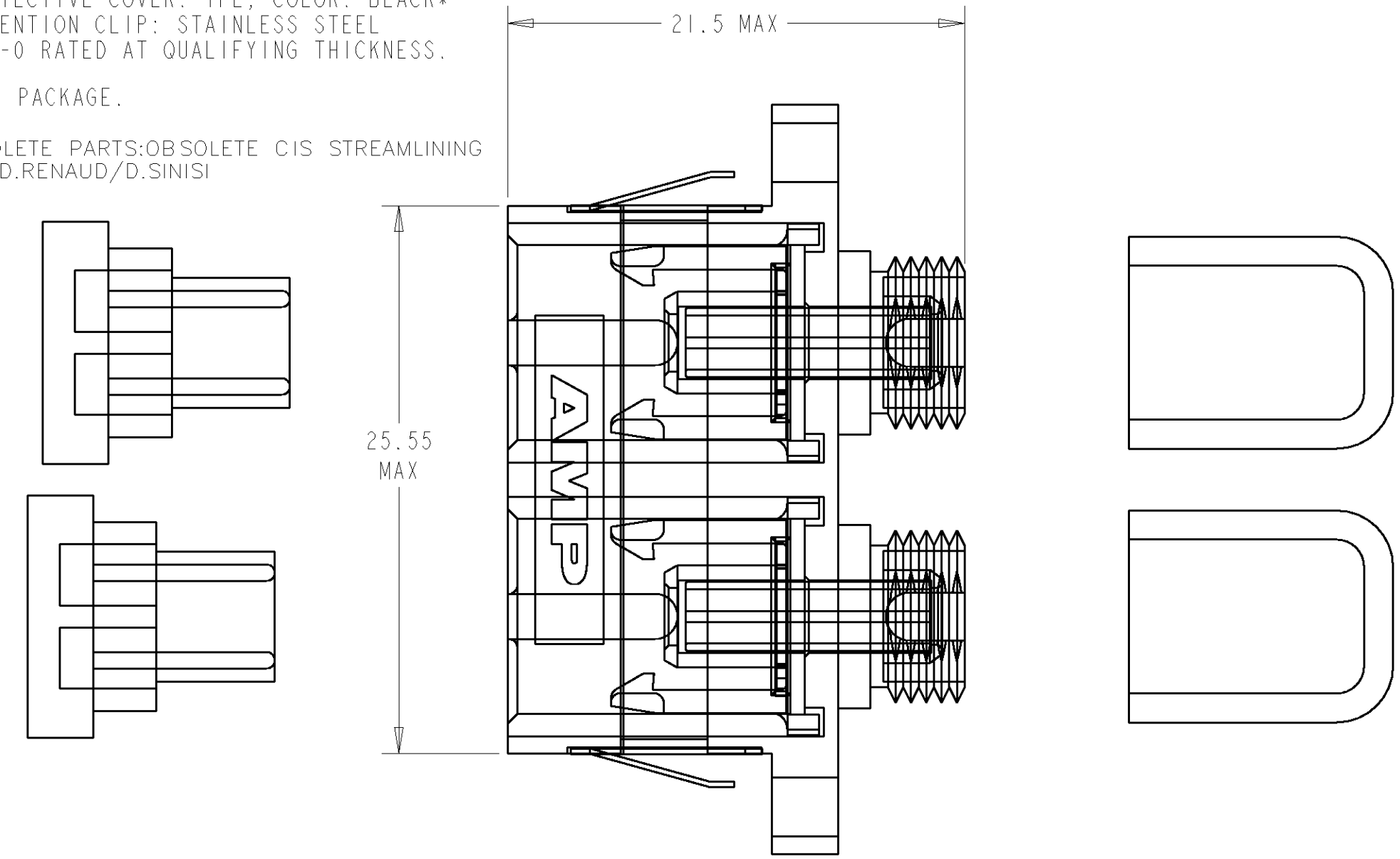

2 3 SUPERCEDED BY 6278050-4

CERAMIC	1278050-4
CERAMIC	1278050-3
METAL	1278050-1
ALIGNMENT SLEEVE	PART NO

THIS DRAWING IS A CONTROLLED DOCUMENT FOR AMP INCORPORATED. IT IS SUBJECT TO CHANGE AND THE CONTROLLING ENGINEERING ORGANIZATION SHOULD BE CONTACTED FOR THE LATEST REVISION.		DWN D ERDMAN 3-31-98	AMP Incorporated Harrisburg, PA 17105-3608	NAME ASSEMBLY, DUPLEX RECEPTACLE, SC/FC DIECAST HOUSING		
DIMENSIONS: mm		CHR J ENGLISH 3-31-98		SIZE A2	CAGE CODE 00779	DRAWING NO C=1278050
TOLERANCES UNLESS OTHERWISE SPECIFIED:		APVD K MONROE 3-31-98		RESTRICTED TO	SCALE 4:1	SHEET 1 OF 1
0 PLC ± 1 PLC ± 2 PLC ± 3 PLC ± 4 PLC ± ANGLES ± FINISH -		PRODUCT SPEC -	REV B1			
MATERIAL - 1		APPLICATION SPEC -	CUSTOMER DRAWING			