



Chipsmall Limited consists of a professional team with an average of over 10 year of expertise in the distribution of electronic components. Based in Hongkong, we have already established firm and mutual-benefit business relationships with customers from,Europe,America and south Asia,supplying obsolete and hard-to-find components to meet their specific needs.

With the principle of “Quality Parts,Customers Priority,Honest Operation,and Considerate Service”,our business mainly focus on the distribution of electronic components. Line cards we deal with include Microchip,ALPS,ROHM,Xilinx,Pulse,ON,Everlight and Freescale. Main products comprise IC,Modules,Potentiometer,IC Socket,Relay,Connector.Our parts cover such applications as commercial,industrial, and automotives areas.

We are looking forward to setting up business relationship with you and hope to provide you with the best service and solution. Let us make a better world for our industry!



Contact us

Tel: +86-755-8981 8866 Fax: +86-755-8427 6832

Email & Skype: info@chipsmall.com Web: www.chipsmall.com

Address: A1208, Overseas Decoration Building, #122 Zhenhua RD., Futian, Shenzhen, China



4

3

2

1

THIS DRAWING IS UNPUBLISHED.

RELEASED FOR PUBLICATION

,19 .

© COPYRIGHT 19

BY AMP INCORPORATED. ALL RIGHTS RESERVED.

LOC	DIST	REVISIONS					
		P	LTR	DESCRIPTION	DATE	DWN	APVD
CE	16		A	REVISE PER 0A00-0342-98	18JUN98	JPM	SB

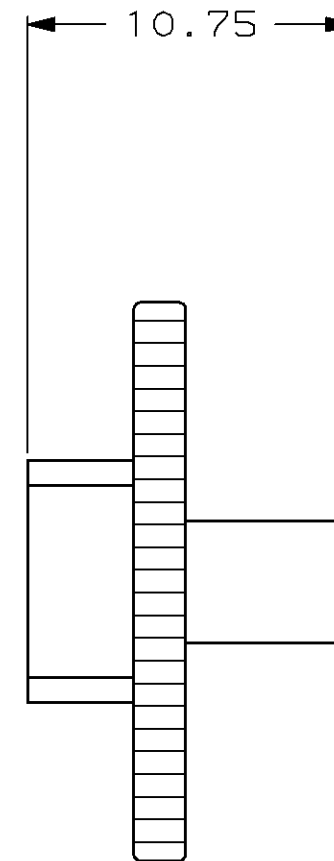
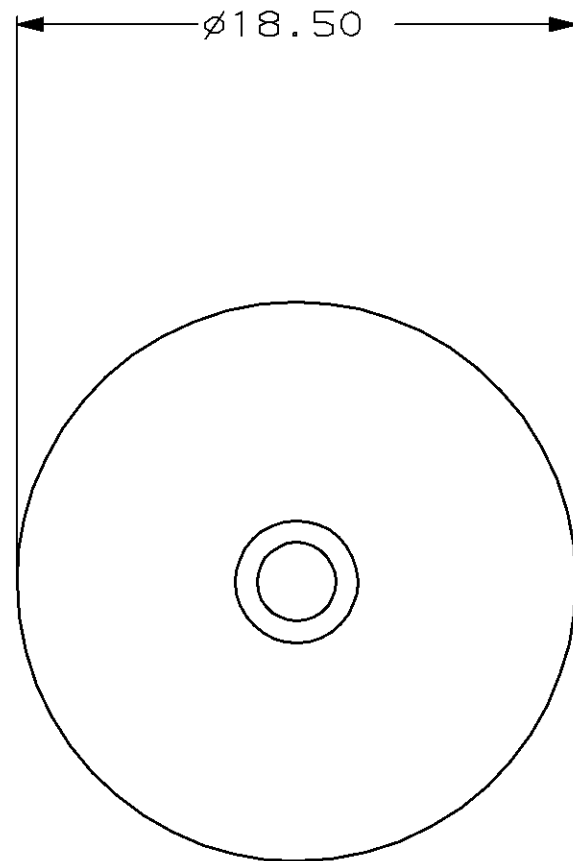

1278134-1
PART NUMBER

THIS DRAWING IS A CONTROLLED DOCUMENT.		DWN J.P. MARSHALL 20MAY98	AMP AMP Incorporated Harrisburg, PA 17105-3608	
		CHK J. SABO 20MAY98		
DIMENSIONS: mm		APVD J.P. MARSHALL 20MAY98	NAME 2.5mm ADAPTER ECONOMY MICROSCOPE	
TOLERANCES UNLESS OTHERWISE SPECIFIED:		PRODUCT SPEC -	RESTRICTED TO -	
0 PLC ±-		APPLICATION SPEC -	SIZE A3	
1 PLC ±-		WEIGHT -	CAGE CODE 00779	
2 PLC ±-		CUSTOMER DRAWING	DRAWING NO C- 1278134	
3 PLC ±-		SCALE 4:1	SHEET 1 OF 1	
4 PLC ±-			REV A	
ANGLES ±-				
MATERIAL -	FINISH -			