



Chipsmall Limited consists of a professional team with an average of over 10 year of expertise in the distribution of electronic components. Based in Hongkong, we have already established firm and mutual-benefit business relationships with customers from,Europe,America and south Asia,supplying obsolete and hard-to-find components to meet their specific needs.

With the principle of "Quality Parts,Customers Priority,Honest Operation,and Considerate Service",our business mainly focus on the distribution of electronic components. Line cards we deal with include Microchip,ALPS,ROHM,Xilinx,Pulse,ON,Everlight and Freescale. Main products comprise IC,Modules,Potentiometer,IC Socket,Relay,Connector.Our parts cover such applications as commercial,industrial, and automotives areas.

We are looking forward to setting up business relationship with you and hope to provide you with the best service and solution. Let us make a better world for our industry!



Contact us

Tel: +86-755-8981 8866 Fax: +86-755-8427 6832

Email & Skype: info@chipsmall.com Web: www.chipsmall.com

Address: A1208, Overseas Decoration Building, #122 Zhenhua RD., Futian, Shenzhen, China



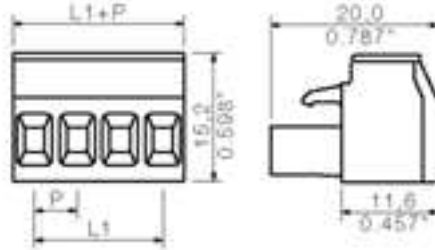

General ordering data

Order No.	1281760000
Part designation	BLA 2 SN OR
Version	PCB plug-in connector, Female connectors, Clamping yoke connection, Clamping range, max.: 3.32 mm ² , Pitch: 5.08 mm, No. of poles: 2, 180°, Box
EAN	4008190008079
Qty.	100 pc(s).

System parameters

Conductor connection system	Clamping yoke connection
Outgoing direction of conductor	180°
Pitch	5.08 mm
Pitch in inch	0.2 inch
No. of poles	2
No. of rows	1
Screwdriver blade	0.6 x 3.5
Screwdriver blade standard	DIN 5264
Tightening torque, min.	0.4 Nm
Tightening torque, max.	0.5 Nm
Clamping screw	M 2.5
Stripping length	7 mm
L1 in mm	5.08 mm
L1 in inch	0.2 inch
Electric shock protection to DIN VDE 0470	Finger-safe unplugged/ back-of-hand-safe plugged

Material data

Insulating material	PBT GF
Colour	orange
colour chart	Similar to RAL 2000
Insulating material group	IIIa
Flammability class UL 94	V-0
CTI	>= 200

Material data

Contact base material	CuSn
Contact surface	tinned

Connectable conductors

Clamping range, min.	0.13 mm ²
Clamping range, max.	3.32 mm ²
AWG, min.	28
AWG, max.	16
Solid, min. H05(07) V-U	0.2 mm ²
Solid, max. H05(07) V-U	2.5 mm ²
Flexible, min. H05(07) V-K	0.2 mm ²
Flexible, max. H05(07) V-K	1.5 mm ²
With wire end ferrule, acc. to DIN 46 228/1, min.	0.2 mm ²
With wire end ferrule, acc. to DIN 46 228/1, max.	1.5 mm ²
w. plastic collar ferrule, DIN 46228 pt 4, min.	0.2 mm ²
w. plastic collar ferrule, DIN 46228 pt 4, max.	1.5 mm ²
Gauge to EN 60999 a x b; ø	2.4 mm x 1.5 mm;

DIN IEC rating data

Rated current, min. No. pins (Tu=20°C)	17.5 A
Rated current, max. No. pins (Tu=20°C)	12.5 A
Rated current, min. No. pins (Tu=40°C)	16 A
Rated current, max. No. pins (Tu=40°C)	11 A
Rated voltage for overvoltage class/pollution severity II/2	400 V
Rated voltage for overvoltage class/pollution severity III/2	320 V
Rated voltage for overvoltage class/pollution severity III/3	250 V
Rated impulse withstand voltage for overvoltage class/pollution severity II/2	4 kV
Rated impulse withstand voltage for overvoltage class/pollution severity III/2	4 kV
Rated impulse withstand voltage for overvoltage class/pollution severity III/3	4 kV
Short-time withstand current resistance	3 x 1s with 100 A

CSA rating data

Rated voltage (Use group D)	300 V
Rated current (Use group D)	10 A
AWG conductor (field wiring), min.	26
AWG conductor (field wiring), max.	12

UL 1059 rating data

Rated voltage (Use group D)	300 V
Rated current (Use group D)	10 A
AWG conductor, min.	26
AWG conductor, max.	12

Approvals

Approvals institutes



Classifications

ETIM 2.0	NK
ETIM 3.0	EC001284
eClass 4.1	27-26-07-01
eClass 5.0	27-26-07-01
eClass 5.1	27-26-07-04

Similar products

Order No.	Part designation	Version
1281860000	BLA 3 SN OR	PCB plug-in connector, Female connectors, Clamping yoke connection, Clamping range, max.: 3.32 mm ² , Pitch: 5.08 mm, No. of poles: 3, 180°, Box
1281960000	BLA 4 SN OR	PCB plug-in connector, Female connectors, Clamping yoke connection, Clamping range, max.: 3.32 mm ² , Pitch: 5.08 mm, No. of poles: 4, 180°, Box
1282060000	BLA 5 SN OR	PCB plug-in connector, Female connectors, Clamping yoke connection, Clamping range, max.: 3.32 mm ² , Pitch: 5.08 mm, No. of poles: 5, 180°, Box
1282160000	BLA 6 SN OR	PCB plug-in connector, Female connectors, Clamping yoke connection, Clamping range, max.: 3.32 mm ² , Pitch: 5.08 mm, No. of poles: 6, 180°, Box
1282260000	BLA 7 SN OR	PCB plug-in connector, Female connectors, Clamping yoke connection, Clamping range, max.: 3.32 mm ² , Pitch: 5.08 mm, No. of poles: 7, 180°, Box
1282360000	BLA 8 SN OR	PCB plug-in connector, Female connectors, Clamping yoke connection, Clamping range, max.: 3.32 mm ² , Pitch: 5.08 mm, No. of poles: 8, 180°, Box
1282460000	BLA 9 SN OR	PCB plug-in connector, Female connectors, Clamping yoke connection, Clamping range, max.: 3.32 mm ² , Pitch: 5.08 mm, No. of poles: 9, 180°, Box

1282560000	BLA 10 SN OR	PCB plug-in connector, Female connectors, Clamping yoke connection, Clamping range, max.: 3.32 mm ² , Pitch: 5.08 mm, No. of poles: 10, 180°, Box
1282660000	BLA 11 SN OR	PCB plug-in connector, Female connectors, Clamping yoke connection, Clamping range, max.: 3.32 mm ² , Pitch: 5.08 mm, No. of poles: 11, 180°, Box
1282760000	BLA 12 SN OR	PCB plug-in connector, Female connectors, Clamping yoke connection, Clamping range, max.: 3.32 mm ² , Pitch: 5.08 mm, No. of poles: 12, 180°, Box
1282860000	BLA 13 SN OR	PCB plug-in connector, Female connectors, Clamping yoke connection, Clamping range, max.: 3.32 mm ² , Pitch: 5.08 mm, No. of poles: 13, 180°, Box
1282960000	BLA 14 SN OR	PCB plug-in connector, Female connectors, Clamping yoke connection, Clamping range, max.: 3.32 mm ² , Pitch: 5.08 mm, No. of poles: 14, 180°, Box
1283060000	BLA 15 SN OR	PCB plug-in connector, Female connectors, Clamping yoke connection, Clamping range, max.: 3.32 mm ² , Pitch: 5.08 mm, No. of poles: 15, 180°, Box
1283160000	BLA 16 SN OR	PCB plug-in connector, Female connectors, Clamping yoke connection, Clamping range, max.: 3.32 mm ² , Pitch: 5.08 mm, No. of poles: 16, 180°, Box
1283260000	BLA 17 SN OR	PCB plug-in connector, Female connectors, Clamping yoke connection, Clamping range, max.: 3.32 mm ² , Pitch: 5.08 mm, No. of poles: 17, 180°, Box
1283360000	BLA 18 SN OR	PCB plug-in connector, Female connectors, Clamping yoke connection, Clamping range, max.: 3.32 mm ² , Pitch: 5.08 mm, No. of poles: 18, 180°, Box
1283460000	BLA 19 SN OR	PCB plug-in connector, Female connectors, Clamping yoke connection, Clamping range, max.: 3.32 mm ² , Pitch: 5.08 mm, No. of poles: 19, 180°, Box
1283560000	BLA 20 SN OR	PCB plug-in connector, Female connectors, Clamping yoke connection, Clamping range, max.: 3.32 mm ² , Pitch: 5.08 mm, No. of poles: 20, 180°, Box
1283660000	BLA 21 SN OR	PCB plug-in connector, Female connectors, Clamping yoke connection, Clamping range, max.: 3.32 mm ² , Pitch: 5.08 mm, No. of poles: 21, 180°, Box
1314260000	BLA 22 SN OR	PCB plug-in connector, Female connectors, Clamping yoke connection, Clamping range, max.: 3.32 mm ² , Pitch: 5.08 mm, No. of poles: 22, 180°, Box
1314360000	BLA 23 SN OR	PCB plug-in connector, Female connectors, Clamping yoke connection, Clamping range, max.: 3.32 mm ² , Pitch: 5.08 mm, No. of poles: 23, 180°, Box
1314460000	BLA 24 SN OR	PCB plug-in connector, Female connectors, Clamping yoke connection, Clamping range, max.: 3.32 mm ² , Pitch: 5.08 mm, No. of poles: 24, 180°, Box