



Chipsmall Limited consists of a professional team with an average of over 10 year of expertise in the distribution of electronic components. Based in Hongkong, we have already established firm and mutual-benefit business relationships with customers from,Europe,America and south Asia,supplying obsolete and hard-to-find components to meet their specific needs.

With the principle of “Quality Parts,Customers Priority,Honest Operation,and Considerate Service”,our business mainly focus on the distribution of electronic components. Line cards we deal with include Microchip,ALPS,ROHM,Xilinx,Pulse,ON,Everlight and Freescale. Main products comprise IC,Modules,Potentiometer,IC Socket,Relay,Connector.Our parts cover such applications as commercial,industrial, and automotives areas.

We are looking forward to setting up business relationship with you and hope to provide you with the best service and solution. Let us make a better world for our industry!



Contact us

Tel: +86-755-8981 8866 Fax: +86-755-8427 6832

Email & Skype: info@chipsmall.com Web: www.chipsmall.com

Address: A1208, Overseas Decoration Building, #122 Zhenhua RD., Futian, Shenzhen, China



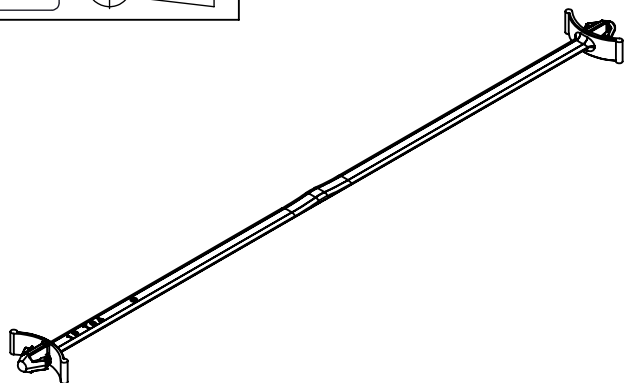

Technical drawing of a 1U TCA module. The drawing shows a side view of the module with a central section broken out to show internal details. The module has a total length of $7.87 \pm .25$ inches and a width of 200.0 ± 6.4 inches. The part revision level is indicated as 1.0. The drawing also shows the module's mounting brackets and the location of the part revision level, which may vary.

Panel Hole Dia.
0.23in to 0.26in
[5.8mm to 6.6mm]

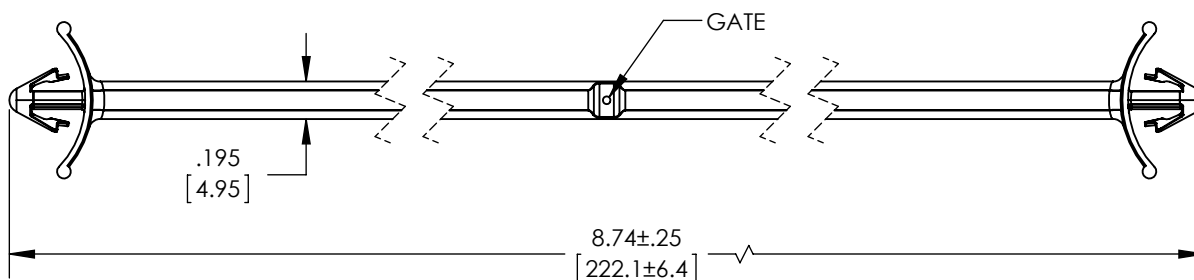
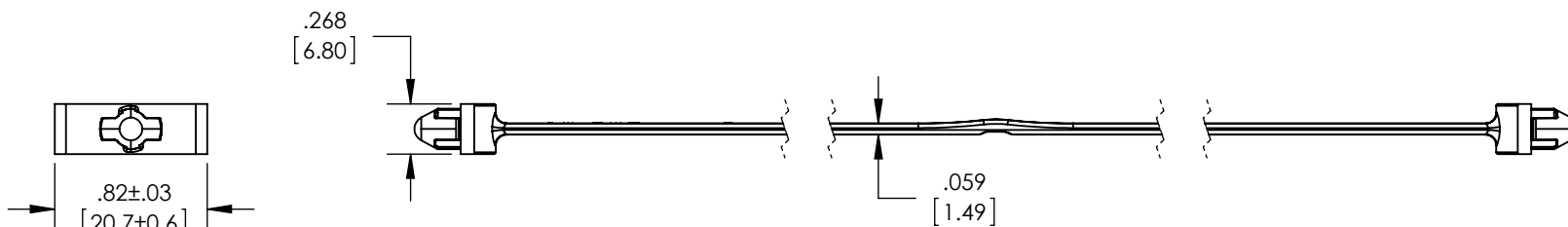

Scale	1:1
Project Number	PRP 13-1053
Format	AH
Sheet	1/1