



Chipsmall Limited consists of a professional team with an average of over 10 year of expertise in the distribution of electronic components. Based in Hongkong, we have already established firm and mutual-benefit business relationships with customers from,Europe,America and south Asia,supplying obsolete and hard-to-find components to meet their specific needs.

With the principle of "Quality Parts,Customers Priority,Honest Operation,and Considerate Service",our business mainly focus on the distribution of electronic components. Line cards we deal with include Microchip,ALPS,ROHM,Xilinx,Pulse,ON,Everlight and Freescale. Main products comprise IC,Modules,Potentiometer,IC Socket,Relay,Connector.Our parts cover such applications as commercial,industrial, and automotives areas.

We are looking forward to setting up business relationship with you and hope to provide you with the best service and solution. Let us make a better world for our industry!



Contact us

Tel: +86-755-8981 8866 Fax: +86-755-8427 6832

Email & Skype: info@chipsmall.com Web: www.chipsmall.com

Address: A1208, Overseas Decoration Building, #122 Zhenhua RD., Futian, Shenzhen, China



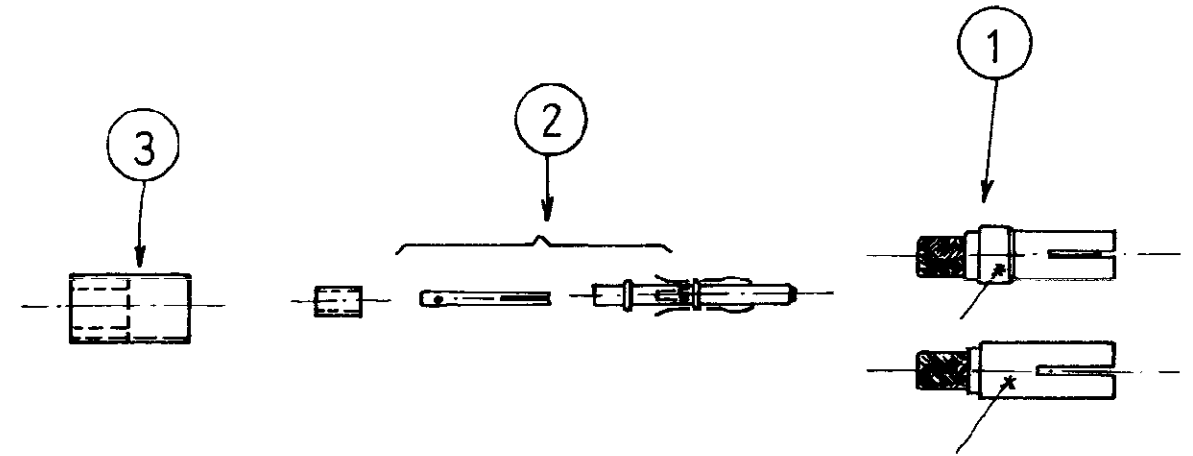

Identification par la référence
sur le corps du contact taille 5 ou
taille 9

1	2	3	4	5	DESCRIPTION	REFERENCE	REP
1	*	*	*	*	CONTACT COAX "MINIATURE"	134393.1	2
*	1	1	*	*	FERRULE.	133959.3	3
1	*	*	1	1	FERRULE.	133959.1	3
*	1	1	1	1	CONTACT COAX "MINIATURE"	133969.1	2
1	1	*	1	*	CONTACT COAX FEMELLE T5	133967.1	1
*	*	1	*	1	CONTACT COAX FEMELLE T9	133964.1	1
133953.5	133953.4	133953.3	133953.2	133953.1			

Emballage: Les composants sont disposés dans
des sacs plastiques "AMP" ou sous "blister"
3 alvéoles dans un tube translucide.

- NOTES: 1. Contacts références 133953.1 & 133953.2 pour
utilisation avec câble FILECA F2709/9 ©
Instruction de sertissage IS n° 15916 para. 2
Dutil insertion/extraction P/W 91074.1
2. Contacts références 133953.3 & 133953.4 pour
utilisation avec câbles FILECA F2709/3
Instruction de sertissage IS n° 15916 para. 2
Dutil insertion/extraction P/W 91074.1
3. Contacts références 133953.3 & 133953.4 pour
utilisation avec câble FILOTEX Etude 46123
Instruction de sertissage IS n° 15916 para. 3
Dutil insertion/extraction P/W 91074.1
- ④ 4. Contacts références 133953.3 & 133953.4 pour
utilisation avec câble FILECA F2709/13.CA
Instruction de sertissage IS n° 15916 para. 2
Dutil insertion/extraction P/W: 31074.1
5. Contacts références 133953.5 par utilisation
avec câble FILECA 2E 22.07 BLANC + BLEU
Mise en OEUVRE: voir Spec AMP 114-15016
Dutil Insertion/Extraction P/W: 31074.1

MASSÉ DES CONTACTS: 4.6 grs

94

DESSIN CLIENT UNIFORMEMENT
POUR REFERENCES

AMP DE FRANCE
15301 PONTAISE

AMP

BSP
22.10.84

E ACOYTE - 5
D AJOUTE CABLE F 2709.13 CA 05.86
C SUPPRIME CABLE LEE. ASP 09.85
B REDESINEE ASMT.3.1 AMP 10.84
A AJOUTE MASSE AMP 09.81

F B C.133953 E

CONTACT COAX FEMELLE T5&9