



Chipsmall Limited consists of a professional team with an average of over 10 year of expertise in the distribution of electronic components. Based in Hongkong, we have already established firm and mutual-benefit business relationships with customers from,Europe,America and south Asia,supplying obsolete and hard-to-find components to meet their specific needs.

With the principle of "Quality Parts,Customers Priority,Honest Operation,and Considerate Service",our business mainly focus on the distribution of electronic components. Line cards we deal with include Microchip,ALPS,ROHM,Xilinx,Pulse,ON,Everlight and Freescale. Main products comprise IC,Modules,Potentiometer,IC Socket,Relay,Connector.Our parts cover such applications as commercial,industrial, and automotives areas.

We are looking forward to setting up business relationship with you and hope to provide you with the best service and solution. Let us make a better world for our industry!



## Contact us

Tel: +86-755-8981 8866 Fax: +86-755-8427 6832

Email & Skype: [info@chipsmall.com](mailto:info@chipsmall.com) Web: [www.chipsmall.com](http://www.chipsmall.com)

Address: A1208, Overseas Decoration Building, #122 Zhenhua RD., Futian, Shenzhen, China



4

3

2

1

THIS DRAWING IS UNPUBLISHED.

RELEASED FOR PUBLICATION

2000

© COPYRIGHT 2000

BY TYCO ELECTRONICS CORPORATION. ALL RIGHTS RESERVED.

LOC

DIST

REVISIONS

P

LTR

DESCRIPTION

DATE

DWN

APVD

A1

-

A

PART NUMBERS CHANGED TO TYCO ELECTRONICS

11SEP2001

ACK

GF

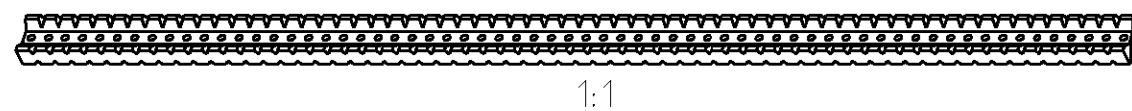
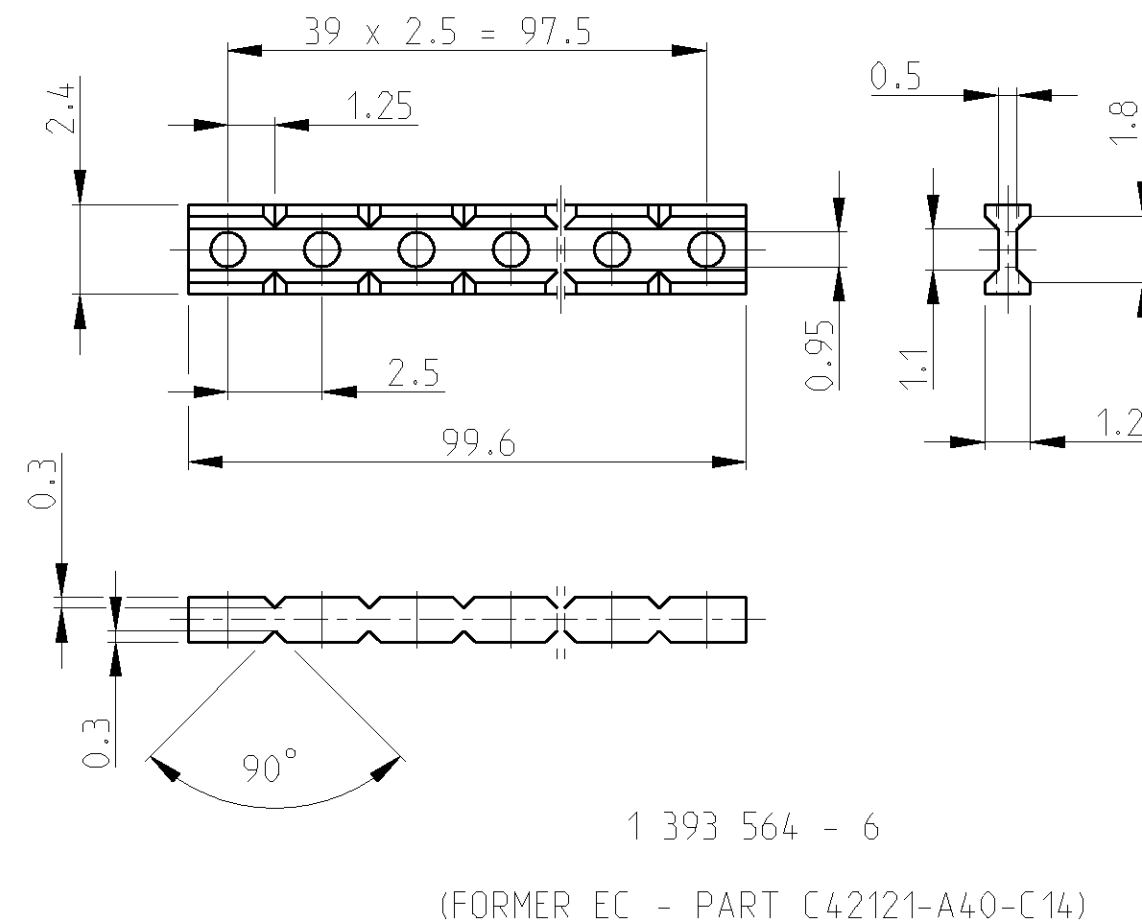
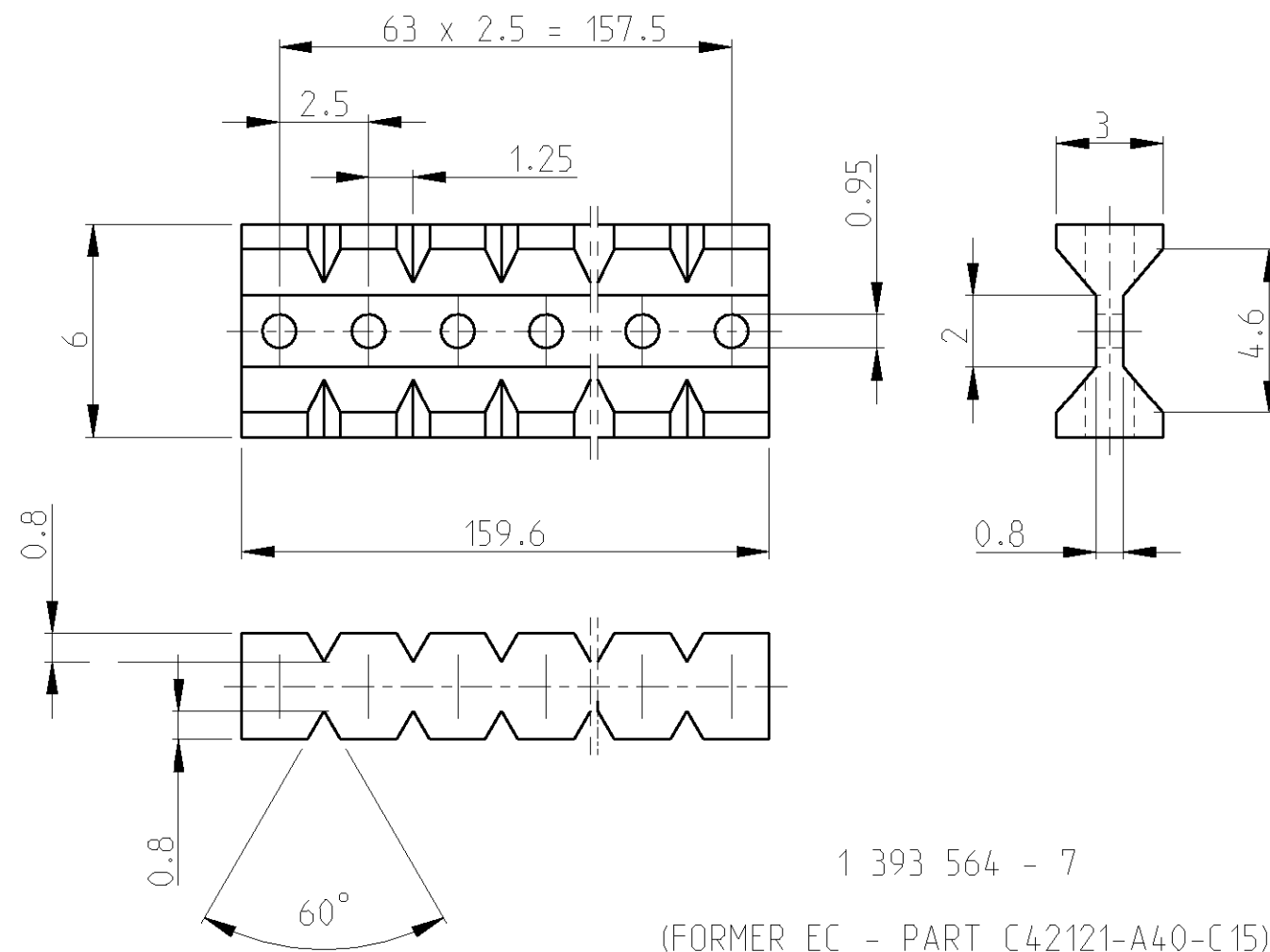

APPLICATION EXAMBLE  
2:1

CUTTED TO LENGHT  
BEFORE MOUNTING

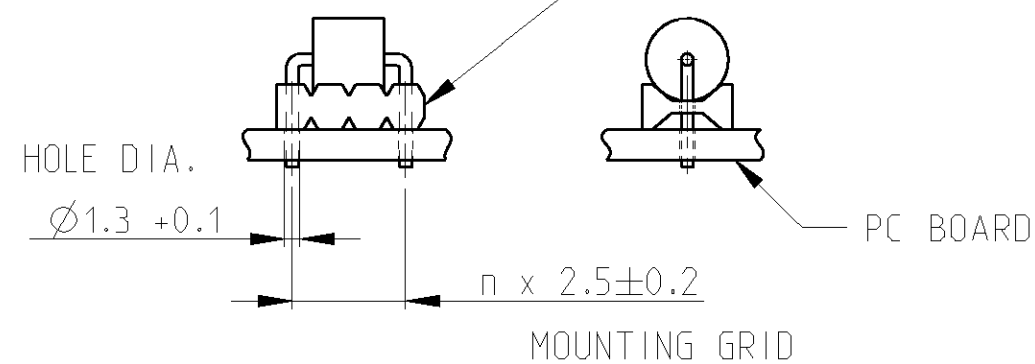

THIS DRAWING IS A CONTROLLED DOCUMENT FOR TYCO ELECTRONICS CORPORATION  
IT IS SUBJECT TO CHANGE AND THE CONTROLLING ENGINEERING ORGANIZATION  
SHOULD BE CONTACTED FOR THE LATEST REVISION.

DWN 11SEP2001

G.ACKERMANN

CHK M.SCHLEIHAUF

APVD G.FELDMEIER

PRODUCT SPEC

APPLICATION SPEC

WEIGHT

-

-

-

-

-

-

-

**tyco**  
**Electronics**

tyco Electronics AMP GmbH

D - 67346 Speyer

MOUNTING FIXTURES  
HALTERUNG

SIZE

CAGE CODE

DRAWING NO

-

-

-

RESTRICTED TO

A3

00779

C=1393564-7

-

-

-

-

CUSTOMER DRAWING

SCALE 5:1

SHEET 1

OF 1

REV A