



Chipsmall Limited consists of a professional team with an average of over 10 year of expertise in the distribution of electronic components. Based in Hongkong, we have already established firm and mutual-benefit business relationships with customers from,Europe,America and south Asia,supplying obsolete and hard-to-find components to meet their specific needs.

With the principle of “Quality Parts,Customers Priority,Honest Operation,and Considerate Service”,our business mainly focus on the distribution of electronic components. Line cards we deal with include Microchip,ALPS,ROHM,Xilinx,Pulse,ON,Everlight and Freescale. Main products comprise IC,Modules,Potentiometer,IC Socket,Relay,Connector.Our parts cover such applications as commercial,industrial, and automotives areas.

We are looking forward to setting up business relationship with you and hope to provide you with the best service and solution. Let us make a better world for our industry!



## Contact us

Tel: +86-755-8981 8866 Fax: +86-755-8427 6832

Email & Skype: info@chipsmall.com Web: www.chipsmall.com

Address: A1208, Overseas Decoration Building, #122 Zhenhua RD., Futian, Shenzhen, China



# Control cabinet feed-through - VS-BH-M12FSX-10G-RJ45/90 - 1404548

Please be informed that the data shown in this PDF Document is generated from our Online Catalog. Please find the complete data in the user's documentation. Our General Terms of Use for Downloads are valid (<http://download.phoenixcontact.com>)



Control cabinet feed-through, M12, 8-pos., X-encoded to RJ45 socket, socket input 90°, IP65/67



**Ethernet**

## Key commercial data

|                        |   |
|------------------------|---|
| Packing unit           | 0   |
| Minimum order quantity | 1   |
| GTIN                   | <br>4 046356 699419 |
| Custom tariff number   | 85366990  |
| Country of origin      | GERMANY   |

## Technical data

### Mechanical characteristics

|                                 |                  |
|---------------------------------|------------------|
| Number of positions             | 8                |
| Insertion/withdrawal cycles     | ≥ 100            |
| Cable exit                      | angled           |
| Color                           | black            |
| Ambient temperature (operation) | -25 °C ... 85 °C |

### Material data

|   |              |
|---|--------------|
| Inflammability class according to UL 94 | V0           |
| Housing material                        | PA           |
| Contact material                        | Copper alloy |
| Degree of protection                    | IP65/67      |

### Electrical characteristics

|                       |      |
|-----------------------|------|
| Number of positions   | 8    |
| Nominal voltage $U_N$ | 60 V |

# Control cabinet feed-through - VS-BH-M12FSX-10G-RJ45/90 - 1404548

## Technical data

### Electrical characteristics

|   |                   |
|---|-------------------|
| Nominal current $I_N$                   | 0.5 A             |
| Transmission characteristics (category) | CAT6 <sub>A</sub> |
| Rated current                           | 1 A               |

## Classifications

### ETIM

|          |          |
|----------|----------|
| ETIM 4.0 | EC001121 |
| ETIM 5.0 | EC002641 |

### UNSPSC

|               |          |
|---------------|----------|
| UNSPSC 11     | 31261501 |
| UNSPSC 12.01  | 31261501 |
| UNSPSC 13.2   | 31261501 |
| UNSPSC 6.01   | 31261501 |
| UNSPSC 7.0901 | 31261501 |

### eCl@ss

|            |          |
|------------|----------|
| eCl@ss 4.0 | 272607xx |
| eCl@ss 4.1 | 27260701 |
| eCl@ss 5.0 | 27260701 |
| eCl@ss 5.1 | 27260701 |
| eCl@ss 6.0 | 27279220 |
| eCl@ss 7.0 | 27440103 |

## Drawings

### Dimensioned drawing

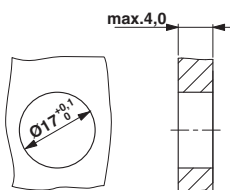

Panel cutout

### Dimensioned drawing

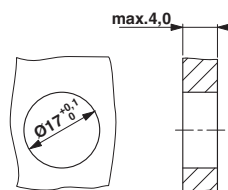

Panel cutout

# Control cabinet feed-through - VS-BH-M12FSX-10G-RJ45/90 - 1404548

## Circuit diagram

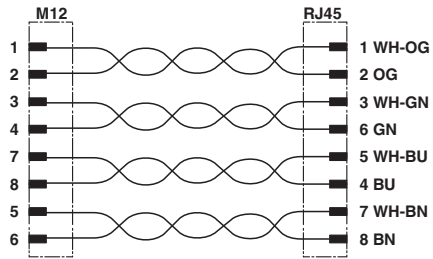

© Phoenix Contact 2012 - all rights reserved  
<http://www.phoenixcontact.com>