



Chipsmall Limited consists of a professional team with an average of over 10 year of expertise in the distribution of electronic components. Based in Hongkong, we have already established firm and mutual-benefit business relationships with customers from,Europe,America and south Asia,supplying obsolete and hard-to-find components to meet their specific needs.

With the principle of “Quality Parts,Customers Priority,Honest Operation,and Considerate Service”,our business mainly focus on the distribution of electronic components. Line cards we deal with include Microchip,ALPS,ROHM,Xilinx,Pulse,ON,Everlight and Freescale. Main products comprise IC,Modules,Potentiometer,IC Socket,Relay,Connector.Our parts cover such applications as commercial,industrial, and automotives areas.

We are looking forward to setting up business relationship with you and hope to provide you with the best service and solution. Let us make a better world for our industry!



## Contact us

Tel: +86-755-8981 8866 Fax: +86-755-8427 6832

Email & Skype: info@chipsmall.com Web: www.chipsmall.com

Address: A1208, Overseas Decoration Building, #122 Zhenhua RD., Futian, Shenzhen, China



## Panel mounting frames - CUC-V04-F-POBK-90 - 1407411

Please be informed that the data shown in this PDF Document is generated from our Online Catalog. Please find the complete data in the user's documentation. Our General Terms of Use for Downloads are valid (<http://phoenixcontact.com/download>)



Panel mounting frames, Degree of protection: IP65/67, Material: Plastic



### Key Commercial Data

|                                      |          |
|--------------------------------------|----------|
| Packing unit                         | 1 STK    |
| Weight per Piece (excluding packing) | 20.000 g |
| Custom tariff number                 | 85389099 |
| Country of origin                    | Germany  |

### Technical data

#### Mechanical characteristics

|                             |                 |
|-----------------------------|-----------------|
| Standards/specifications    | IEC 61076-3-106 |
| Locking type                | Push Pull       |
| Insertion/withdrawal cycles | ≥ 750           |
| Color                       | black           |

#### Ambient conditions

|   |                  |
|---|------------------|
| Ambient temperature (operation)         | -40 °C ... 70 °C |
| Ambient temperature (storage/transport) | -40 °C ... 70 °C |
| Degree of protection                    | IP65             |

#### Material data

|  |         |
|--|---------|
| Flammability rating according to UL 94 | V0      |
| Housing material                       | Plastic |

### Standards and Regulations

|                       |                 |
|-----------------------|-----------------|
| Standards/regulations | IEC 61076-3-106 |
|-----------------------|-----------------|

# Panel mounting frames - CUC-V04-F-POBK-90 - 1407411

## Technical data

### Standards and Regulations

|  |    |
|--|----|
| Flammability rating according to UL 94 | V0 |
|--|----|

## Drawings

Dimensional drawing

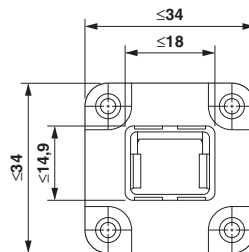

Panel mounting frame dimensional drawing

## Classifications

### eCl@ss

|            |          |
|------------|----------|
| eCl@ss 4.0 | 272607xx |
| eCl@ss 4.1 | 27260701 |
| eCl@ss 5.0 | 27260701 |
| eCl@ss 5.1 | 27260701 |
| eCl@ss 6.0 | 27261207 |
| eCl@ss 7.0 | 27440210 |
| eCl@ss 8.0 | 27440210 |
| eCl@ss 9.0 | 27440210 |

### ETIM

|          |          |
|----------|----------|
| ETIM 3.0 | EC002310 |
| ETIM 4.0 | EC002310 |
| ETIM 5.0 | EC002310 |

### UNSPSC

|               |          |
|---------------|----------|
| UNSPSC 6.01   | 31261501 |
| UNSPSC 7.0901 | 31261501 |
| UNSPSC 11     | 31261501 |
| UNSPSC 12.01  | 31261501 |
| UNSPSC 13.2   | 31261501 |

## Panel mounting frames - CUC-V04-F-POBK-90 - 1407411

### Accessories

#### Accessories

#### Female insert

RJ45 socket insert - CUC-V04-BU-90 - 1407408



RJ45 socket insert, Type: RJ45, IP20, Degree of protection: IP20, Number of positions: 8, CAT5, Material: Copper alloy, Connection method: Solder connection