



Chipsmall Limited consists of a professional team with an average of over 10 year of expertise in the distribution of electronic components. Based in Hongkong, we have already established firm and mutual-benefit business relationships with customers from,Europe,America and south Asia,supplying obsolete and hard-to-find components to meet their specific needs.

With the principle of “Quality Parts,Customers Priority,Honest Operation,and Considerate Service”,our business mainly focus on the distribution of electronic components. Line cards we deal with include Microchip,ALPS,ROHM,Xilinx,Pulse,ON,Everlight and Freescale. Main products comprise IC,Modules,Potentiometer,IC Socket,Relay,Connector.Our parts cover such applications as commercial,industrial, and automotives areas.

We are looking forward to setting up business relationship with you and hope to provide you with the best service and solution. Let us make a better world for our industry!



## Contact us

Tel: +86-755-8981 8866 Fax: +86-755-8427 6832

Email & Skype: [info@chipsmall.com](mailto:info@chipsmall.com) Web: [www.chipsmall.com](http://www.chipsmall.com)

Address: A1208, Overseas Decoration Building, #122 Zhenhua RD., Futian, Shenzhen, China



## Cable gland - HC-K-KV-M32(12-21)BK - 1407673

Please be informed that the data shown in this PDF Document is generated from our Online Catalog. Please find the complete data in the user's documentation. Our General Terms of Use for Downloads are valid (<http://phoenixcontact.com/download>)



Plastic screw connection up to 5 bar, thread length: 10 mm, cable diameter: 12 - 21 mm, WAF 36, screw connection: M32

### Product Description

Plastic cable gland



### Key Commercial Data

Packing unit	1 pc
Minimum order quantity	10 pc
Weight per Piece (excluding packing)	30.0 g
Custom tariff number	39269097
Country of origin	Germany

### Technical data

#### Dimensions

Wrench size, union nut	36 mm
Wrench size, support	36 mm
External cable diameter	12 mm ... 21 mm

#### Ambient conditions

Degree of protection	IP68, to 5 bar
	IP68 (Up to 5 bar)
Ambient temperature (operation)	-20 °C ... 100 °C

#### General

Type of the screw connection	M32
No. of conductors	1
Material	PA
Cable gland material	Polyamide

## Cable gland - HC-K-KV-M32(12-21)BK - 1407673

### Technical data

#### General

Material, pressure screw	Polyamide
Seal material	TPE
Shielded	No
Thread type on connection side	M32
Tightening torque, union nut	7.50 Nm
Flammability rating according to UL 94	V2
Color	black
	black

#### Standards and Regulations

Flammability rating according to UL 94	V2
--	----

### Classifications

#### eCl@ss

eCl@ss 4.0	27141209
eCl@ss 4.1	27141209
eCl@ss 5.0	27149109
eCl@ss 5.1	27143424
eCl@ss 6.0	27149109
eCl@ss 7.0	27149109
eCl@ss 8.0	27149109

#### ETIM

ETIM 3.0	EC000441
ETIM 4.0	EC000441
ETIM 5.0	EC000441

#### UNSPSC

UNSPSC 6.01	31261502
UNSPSC 7.0901	31261502
UNSPSC 11	31261502
UNSPSC 12.01	31261502
UNSPSC 13.2	31261502

### Approvals

#### Approvals

## Cable gland - HC-K-KV-M32(12-21)BK - 1407673

### Approvals

Approvals

EAC

---

Ex Approvals

---

Approvals submitted

---

### Approval details

EAC
-----

### Drawings

Dimensional drawing

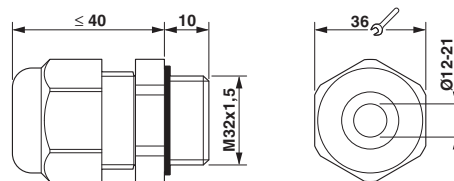

Dimensional drawing

---