



Chipsmall Limited consists of a professional team with an average of over 10 year of expertise in the distribution of electronic components. Based in Hongkong, we have already established firm and mutual-benefit business relationships with customers from,Europe,America and south Asia,supplying obsolete and hard-to-find components to meet their specific needs.

With the principle of “Quality Parts,Customers Priority,Honest Operation,and Considerate Service”,our business mainly focus on the distribution of electronic components. Line cards we deal with include Microchip,ALPS,ROHM,Xilinx,Pulse,ON,Everlight and Freescale. Main products comprise IC,Modules,Potentiometer,IC Socket,Relay,Connector.Our parts cover such applications as commercial,industrial, and automotives areas.

We are looking forward to setting up business relationship with you and hope to provide you with the best service and solution. Let us make a better world for our industry!



Contact us

Tel: +86-755-8981 8866 Fax: +86-755-8427 6832

Email & Skype: info@chipsmall.com Web: www.chipsmall.com

Address: A1208, Overseas Decoration Building, #122 Zhenhua RD., Futian, Shenzhen, China



Crimp contact - CC1,0-T-1,0-M AU PU100 - 1414275

Please be informed that the data shown in this PDF Document is generated from our Online Catalog. Please find the complete data in the user's documentation. Our General Terms of Use for Downloads are valid (<http://phoenixcontact.com/download>)



Turned 1.0 mm crimp contact, individual pin contact, connection cross section up to 1.0 mm², gold-plated



Key Commercial Data

Packing unit	1 pc
Minimum order quantity	100 pc
Custom tariff number	85389099
Country of origin	Germany

Technical data

Electrical characteristics

Rated current	4 A
---------------	-----

Ambient conditions

Ambient temperature (operation)	-40 °C ... 85 °C
---------------------------------	------------------

Mechanical characteristics

Connection cross section AWG	22 ... 18
Stripping length of the individual wire	4.5 mm +0,5 mm
Conductor cross section AWG max.	18
Conductor cross section AWG min.	22
Insertion/withdrawal cycles	≥ 100

General

Type	Individual male contact
Connection method	Crimp connection

Material data

Contact material	CuZn
------------------	------

Crimp contact - CC1,0-T-1,0-M AU PU100 - 1414275

Technical data

Material data

Contact surface material	Ni/Au
--------------------------	-------

Classifications

eCl@ss

eCl@ss 5.1	27260701
eCl@ss 6.0	27279221

ETIM

ETIM 5.0	EC000796
----------	----------

Drawings

Dimensional drawing

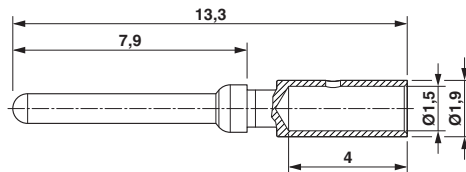

Crimp contact, diameter 1.0 mm