



Chipsmall Limited consists of a professional team with an average of over 10 year of expertise in the distribution of electronic components. Based in Hongkong, we have already established firm and mutual-benefit business relationships with customers from,Europe,America and south Asia,supplying obsolete and hard-to-find components to meet their specific needs.

With the principle of "Quality Parts,Customers Priority,Honest Operation,and Considerate Service",our business mainly focus on the distribution of electronic components. Line cards we deal with include Microchip,ALPS,ROHM,Xilinx,Pulse,ON,Everlight and Freescale. Main products comprise IC,Modules,Potentiometer,IC Socket,Relay,Connector.Our parts cover such applications as commercial,industrial, and automotives areas.

We are looking forward to setting up business relationship with you and hope to provide you with the best service and solution. Let us make a better world for our industry!



## Contact us

Tel: +86-755-8981 8866 Fax: +86-755-8427 6832

Email & Skype: [info@chipsmall.com](mailto:info@chipsmall.com) Web: [www.chipsmall.com](http://www.chipsmall.com)

Address: A1208, Overseas Decoration Building, #122 Zhenhua RD., Futian, Shenzhen, China



## Housing - HC-B 16-KMQ-H-O1STM40 - 1414349

Please be informed that the data shown in this PDF Document is generated from our Online Catalog. Please find the complete data in the user's documentation. Our General Terms of Use for Downloads are valid (<http://phoenixcontact.com/download>)



HEAVYCON B16 coupling housing, with double locking latch, height: 82 mm, with 1 x M40 thread, straight cable outlet



### Key Commercial Data

Packing unit	1 pc
Weight per Piece (excluding packing)	240.0 g
Custom tariff number	85389099
Country of origin	Germany

### Technical data

#### Dimensions

Height	82 mm
--------	-------

#### Ambient conditions

Degree of protection	IP65
Ambient temperature (operation)	-40 °C ... 125 °C

#### General

Note	For contact inserts HC-B16, BB32, BBB40, D40, DD72, HS6, M, K
Type	B16
Degree of protection	IP65
Locking type	With double locking latch
Type of the screw connection	1x M40
Pg screw connection	none
Cable exit	straight
Housing material	Aluminum die-cast
Housing surface material	Powder-coated, gray
Seal material	NBR

# Housing - HC-B 16-KMQ-H-O1STM40 - 1414349

## Technical data

### General

Ambient temperature (operation)	-40 °C ... 125 °C
---------------------------------	-------------------

## Classifications

### eCl@ss

eCl@ss 5.1	27143424
eCl@ss 6.0	27143424

## Approvals

### Approvals

#### Approvals

#### EAC

#### Ex Approvals

#### Approvals submitted

### Approval details

EAC
-----

## Drawings

Dimensional drawing

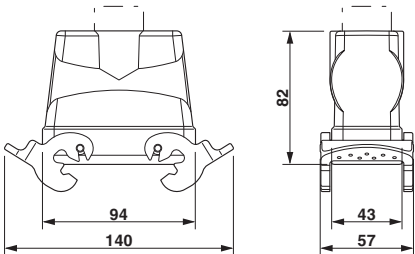

### Dimensional drawing

