



Chipsmall Limited consists of a professional team with an average of over 10 year of expertise in the distribution of electronic components. Based in Hongkong, we have already established firm and mutual-benefit business relationships with customers from,Europe,America and south Asia,supplying obsolete and hard-to-find components to meet their specific needs.

With the principle of “Quality Parts,Customers Priority,Honest Operation,and Considerate Service”,our business mainly focus on the distribution of electronic components. Line cards we deal with include Microchip,ALPS,ROHM,Xilinx,Pulse,ON,Everlight and Freescale. Main products comprise IC,Modules,Potentiometer,IC Socket,Relay,Connector.Our parts cover such applications as commercial,industrial, and automotives areas.

We are looking forward to setting up business relationship with you and hope to provide you with the best service and solution. Let us make a better world for our industry!



## Contact us

Tel: +86-755-8981 8866 Fax: +86-755-8427 6832

Email & Skype: info@chipsmall.com Web: www.chipsmall.com

Address: A1208, Overseas Decoration Building, #122 Zhenhua RD., Futian, Shenzhen, China



## Control cabinet feed-through - CUC-BH-M12D1PBK-S/R4BE - 1414398

Please be informed that the data shown in this PDF Document is generated from our Online Catalog. Please find the complete data in the user's documentation. Our General Terms of Use for Downloads are valid (<http://phoenixcontact.com/download>)



Control cabinet feed-through, M12, 4-pos., D-coded to RJ45 socket, socket entry: 180°, IP65/IP67

### Why buy this product

- Compact design
- 100 Mbps
- IP65/67
- UL



Ethernet

### Key Commercial Data

Packing unit	1 STK
Weight per Piece (excluding packing)	40.0 g
Custom tariff number	85366990
Country of origin	Germany

### Technical data

#### Mechanical characteristics

Shielded	yes
Insertion/withdrawal cycles	≥ 100
Cable exit	straight
Color	black
Mounting type	Rear mounting

#### Ambient conditions

Ambient temperature (operation)	-25 °C ... 85 °C
---------------------------------	------------------

#### Material data

# Control cabinet feed-through - CUC-BH-M12D1PBK-S/R4BE - 1414398

## Technical data

### Material data

Flammability rating according to UL 94	V0
Housing material	PA
Contact material	Copper alloy

### Electrical characteristics

Nominal voltage $U_N$	60 V
Nominal current $I_N$	0.5 A
Transmission characteristics (category)	CAT5 (IEC 11801:2002)
GRP transmission properties	Ethernet
Transmission speed	100 Mbps
Rated current	1.75 A

### Standards and Regulations

Flammability rating according to UL 94	V0
--	----

## Drawings

Explosion drawing

Dimensional drawing

Exploded drawing

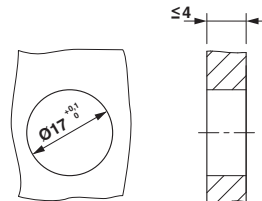

Panel cutout

Dimensional drawing

Circuit diagram

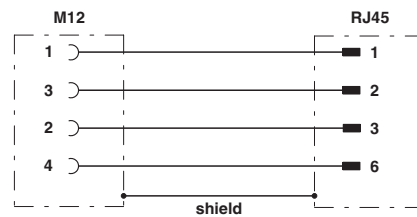
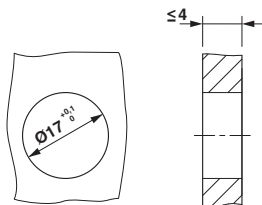

Panel cutout

Circuit diagram

# Control cabinet feed-through - CUC-BH-M12D1PBK-S/R4BE - 1414398

## Classifications

eCl@ss

eCl@ss 8.0	27141134
eCl@ss 9.0	27141134

ETIM

ETIM 5.0	EC001283
----------	----------

## Approvals

Approvals

Approvals

EAC / UL Listed / cUL Listed / EAC / cULus Listed

Ex Approvals

Approvals submitted

## Approval details

EAC
-----

UL Listed 	
Nominal current IN	0.5 A
Nominal voltage UN	60 V

cUL Listed 	
Nominal current IN	0.5 A
Nominal voltage UN	60 V

## Control cabinet feed-through - CUC-BH-M12D1PBK-S/R4BE - 1414398

### Approvals

EAC

cULus Listed 