



Chipsmall Limited consists of a professional team with an average of over 10 year of expertise in the distribution of electronic components. Based in Hongkong, we have already established firm and mutual-benefit business relationships with customers from,Europe,America and south Asia,supplying obsolete and hard-to-find components to meet their specific needs.

With the principle of “Quality Parts,Customers Priority,Honest Operation,and Considerate Service”,our business mainly focus on the distribution of electronic components. Line cards we deal with include Microchip,ALPS,ROHM,Xilinx,Pulse,ON,Everlight and Freescale. Main products comprise IC,Modules,Potentiometer,IC Socket,Relay,Connector.Our parts cover such applications as commercial,industrial, and automotives areas.

We are looking forward to setting up business relationship with you and hope to provide you with the best service and solution. Let us make a better world for our industry!



## Contact us

Tel: +86-755-8981 8866 Fax: +86-755-8427 6832

Email & Skype: info@chipsmall.com Web: www.chipsmall.com

Address: A1208, Overseas Decoration Building, #122 Zhenhua RD., Futian, Shenzhen, China



# RJ45 connector - CUC-V06-C1PGY-S/R4CEA:1 - 1414406

Please be informed that the data shown in this PDF Document is generated from our Online Catalog. Please find the complete data in the user's documentation. Our General Terms of Use for Downloads are valid (<http://phoenixcontact.com/download>)



RJ45 connector, contact inserts: x , degree of protection: IP67, 10 Gbps, CAT6<sub>A</sub>, material: PA, connection method: Crimp connection, connection cross section: AWG 24- 27, cable outlet: straight, color: gray



## Key Commercial Data

Packing unit	1 STK
GTIN	 4 055626 028279
GTIN	4055626028279

## Technical data

### Mechanical characteristics

Connection profile	RJ45
Insertion/withdrawal cycles	≥ 1000
Connection method	Crimp connection
Type of contact	Crimp contacts
Conductor cross section	0.1 mm <sup>2</sup> ... 0.2 mm <sup>2</sup> (flexible)
Connection cross section AWG	24 ... 27 (flexible)
External cable diameter	5 mm ... 8.5 mm
Cable outlet	straight
Color	gray
Degree of protection	IP67
Type	RJ45, IP67, version 6
No. of cable outlets	1

### Ambient conditions

Ambient temperature (operation)	-25 °C ... 60 °C
---------------------------------	------------------

### Material data

Flammability rating according to UL 94	V0
Housing material	PA

# RJ45 connector - CUC-V06-C1PGY-S/R4CEA:1 - 1414406

## Technical data

### Material data

Contact carrier material	PC
Contact material	Phosphor bronze
Contact surface material	Gold
O-ring material	FPM
Cable seal material	NBR

### Electrical characteristics

Nominal voltage $U_N$	72 V (DC)
Nominal current $I_N$	1.75 A
Transmission characteristics (category)	CAT6 <sub>A</sub>
GRP transmission properties	CAT6 <sub>A</sub> CAT6 <sub>A</sub>
Transmission speed	10 Gbps (500 MHz)
Frequency range	to 500 MHz
Rated current	1 A
Overvoltage category	I
Degree of pollution	2
Rated voltage (III/3)	72 V (DC)

### Standards and Regulations

Flammability rating according to UL 94	V0
----------------------------------------	----

### Environmental Product Compliance

China RoHS	Environmentally friendly use period: unlimited = EFUP-e
	No hazardous substances above threshold values

## Drawings

Dimensional drawing

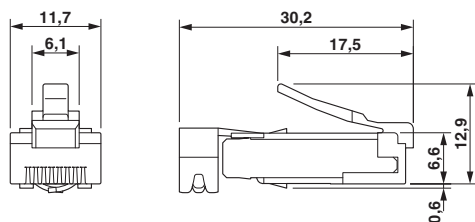

RJ45 male insert

Dimensional drawing

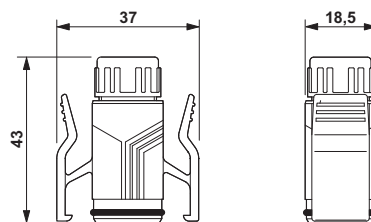

RJ45 sleeve housing IP67

## Approvals

### Approvals

Approvals

EAC

## RJ45 connector - CUC-V06-C1PGY-S/R4CEA:1 - 1414406

### Approvals

---

Ex Approvals

---

### Approval details

EAC		B.01742
-----	-----------------------------------------------------------------------------------	---------

---

Phoenix Contact 2018 © - all rights reserved  
<http://www.phoenixcontact.com>

PHOENIX CONTACT GmbH & Co. KG  
Flachsmarktstr. 8  
32825 Blomberg  
Germany  
Tel. +49 5235 300  
Fax +49 5235 3 41200  
<http://www.phoenixcontact.com>