



Chipsmall Limited consists of a professional team with an average of over 10 year of expertise in the distribution of electronic components. Based in Hongkong, we have already established firm and mutual-benefit business relationships with customers from,Europe,America and south Asia,supplying obsolete and hard-to-find components to meet their specific needs.

With the principle of “Quality Parts,Customers Priority,Honest Operation,and Considerate Service”,our business mainly focus on the distribution of electronic components. Line cards we deal with include Microchip,ALPS,ROHM,Xilinx,Pulse,ON,Everlight and Freescale. Main products comprise IC,Modules,Potentiometer,IC Socket,Relay,Connector.Our parts cover such applications as commercial,industrial, and automotives areas.

We are looking forward to setting up business relationship with you and hope to provide you with the best service and solution. Let us make a better world for our industry!



## Contact us

Tel: +86-755-8981 8866 Fax: +86-755-8427 6832

Email & Skype: info@chipsmall.com Web: www.chipsmall.com

Address: A1208, Overseas Decoration Building, #122 Zhenhua RD., Futian, Shenzhen, China



## Membrane screw connection - MG-INC-M20-S67L-PTES-LG - 1415187

Please be informed that the data shown in this PDF Document is generated from our Online Catalog. Please find the complete data in the user's documentation. Our General Terms of Use for Downloads are valid (<http://phoenixcontact.com/download>)



Membrane screw connection, Cable gland material: Polypropylene, Application: Standard, External cable diameter 6 mm ... 13 mm, Shielding: No, Connecting thread: M20, Color: lightgrey RAL 7035

The figure shows version MG-INC-M25-M67L-PTES-LG



### Key Commercial Data

Packing unit	1 STK
Minimum order quantity	20 STK
Custom tariff number	39269097
Country of origin	Germany

### Technical data

#### Dimensions

Length	15 mm
Length without connecting thread	7 mm
Connecting thread diameter	20 mm
Hexagon angular dimension GRP	34 mm
Length of the connecting thread	8 mm
External cable diameter	6 mm ... 13 mm

#### Ambient conditions

Degree of protection	IP66
	IP67
Ambient temperature (operation)	-40 °C ... 65 °C

#### General

# Membrane screw connection - MG-INC-M20-S67L-PTES-LG - 1415187

## Technical data

### General

Cable gland material	Polypropylene
Seal material	TPE
Shielded	No
Thread type on connection side	M20
Color	light grey RAL 7035
	lightgrey RAL 7035
Assembly instructions	for 0.8 mm ... 3.5 mm wall thickness, for 20 mm ... 20.7 mm bore hole

## Drawings

Dimensional drawing

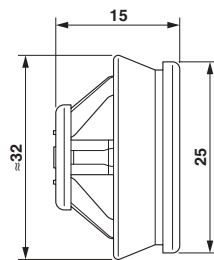

## Classifications

### eCl@ss

eCl@ss 5.1	27149109
eCl@ss 6.0	27149109
eCl@ss 8.0	27379216
eCl@ss 9.0	27379216

### ETIM

ETIM 5.0	EC002024
----------	----------