



Chipsmall Limited consists of a professional team with an average of over 10 year of expertise in the distribution of electronic components. Based in Hongkong, we have already established firm and mutual-benefit business relationships with customers from,Europe,America and south Asia,supplying obsolete and hard-to-find components to meet their specific needs.

With the principle of “Quality Parts,Customers Priority,Honest Operation,and Considerate Service”,our business mainly focus on the distribution of electronic components. Line cards we deal with include Microchip,ALPS,ROHM,Xilinx,Pulse,ON,Everlight and Freescale. Main products comprise IC,Modules,Potentiometer,IC Socket,Relay,Connector.Our parts cover such applications as commercial,industrial, and automotives areas.

We are looking forward to setting up business relationship with you and hope to provide you with the best service and solution. Let us make a better world for our industry!



Contact us

Tel: +86-755-8981 8866 Fax: +86-755-8427 6832

Email & Skype: info@chipsmall.com Web: www.chipsmall.com

Address: A1208, Overseas Decoration Building, #122 Zhenhua RD., Futian, Shenzhen, China



D-SUB crimp contact - CUC-DSC-C1BAU-S/DSC22 - 1418789

Please be informed that the data shown in this PDF Document is generated from our Online Catalog. Please find the complete data in the user's documentation. Our General Terms of Use for Downloads are valid (<http://phoenixcontact.com/download>)



D-SUB crimp contact, connection method: Crimp connection, connection cross section: AWG 28- 22, High Density

Product Description

High-density contact for D-SUB contact inserts

Why buy this product

- Various connection methods for every application
- High grade
- Turned contact

Key Commercial Data

Packing unit	100 STK
GTIN	 4 055626 150765
GTIN	4055626150765

Technical data

Mechanical characteristics

Insertion/withdrawal cycles	≥ 200
Connection method	Crimp connection
Type of contact	Pin
Conductor cross section	0.08 mm ² ... 0.34 mm ²
Connection cross section AWG	28 ... 22
Mounting type	Crimp connection
Contact type	turned

Ambient conditions

Ambient temperature (operation)	-55 °C ... 115 °C
---------------------------------	-------------------

Material data

D-SUB crimp contact - CUC-DSC-C1BAU-S/DSC22 - 1418789

Technical data

Material data

Contact material	Copper alloy
Contact surface material	0.2 µm, gold over nickel

Electrical characteristics

Rated current	3 A
---------------	-----

Environmental Product Compliance

China RoHS	Environmentally friendly use period: unlimited = EFUP-e
	No hazardous substances above threshold values

Drawings

Dimensional drawing

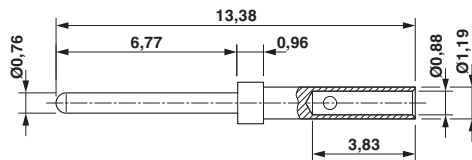

D-SUB crimp contact pin

Phoenix Contact 2018 © - all rights reserved
<http://www.phoenixcontact.com>

PHOENIX CONTACT GmbH & Co. KG
Flachsmarktstr. 8
32825 Blomberg
Germany
Tel. +49 5235 300
Fax +49 5235 3 41200
<http://www.phoenixcontact.com>