



Chipsmall Limited consists of a professional team with an average of over 10 year of expertise in the distribution of electronic components. Based in Hongkong, we have already established firm and mutual-benefit business relationships with customers from,Europe,America and south Asia,supplying obsolete and hard-to-find components to meet their specific needs.

With the principle of “Quality Parts,Customers Priority,Honest Operation,and Considerate Service”,our business mainly focus on the distribution of electronic components. Line cards we deal with include Microchip,ALPS,ROHM,Xilinx,Pulse,ON,Everlight and Freescale. Main products comprise IC,Modules,Potentiometer,IC Socket,Relay,Connector.Our parts cover such applications as commercial,industrial, and automotives areas.

We are looking forward to setting up business relationship with you and hope to provide you with the best service and solution. Let us make a better world for our industry!



Contact us

Tel: +86-755-8981 8866 Fax: +86-755-8427 6832

Email & Skype: info@chipsmall.com Web: www.chipsmall.com

Address: A1208, Overseas Decoration Building, #122 Zhenhua RD., Futian, Shenzhen, China



BF2 FUSE RATED 58V



Specifications

Housing:	Out of thermoplastic (UL 94-V0, heat-resistant) Visible melting element
Terminal:	Copper alloy, gal. Sn 2 x M8 bolts, Distance 51 mm
Mounting Torque:	12.0 Nm +/- 1Nm
Breaking Capacity:	1000A, 58V DC
Complies with:	ISO 8820-5 UL 248 Special Purpose Fuses

Ordering Information

Part Number	Package Size
142.5395.xxx2	200





Description

This BF2 fuse is rated at 58V and offers a bolt-on fuse for high current wiring protection. Current rating 100A - 300A; with transparent housing for easy detection of blown fuses.

Time-Current Characteristics

% of Rating	Opening Time Min / Max (s)	
	100A - 250A	300A
75	- / -	- / -
100	4 h / -	4 h / -
135	120 s / 1,800 s	- / -
200	1 s / 15 s	1 s / 15 s
350	0.300 s / 5 s	0.500 s / 5 s
600	0.100 s / 1 s	0.100 s / 1 s

Ratings

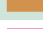
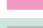
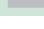
Part Number	Current Rating	Housing Color	Typ. Voltage Drop	Cold Resistance	I ² t
142.5395.6102	100 A		110 mV	0.70 mΩ	46,800 A ² s
142.5395.6122	125 A		110 mV	0.52 mΩ	118,100 A ² s
142.5395.6152	150 A		110 mV	0.42 mΩ	113,400 A ² s
142.5395.6172	175 A		110 mV	0.36 mΩ	154,400 A ² s
142.5395.6202	200 A		110 mV	0.34 mΩ	288,000 A ² s
142.5395.6222	225 A		110 mV	0.29 mΩ	236,000 A ² s
142.5395.6252	250 A		110 mV	0.25 mΩ	292,500 A ² s
142.5395.6302 ¹	300 A		110 mV	0.21 mΩ	486,000 A ² s

Note 1: Short circuit protectors only.

BF2 FUSE RATED 58V



Dimensions

Dimensions in mm

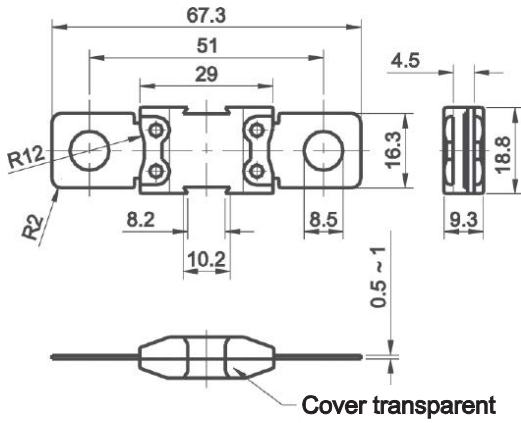

Pre-Arcing Time-Limits

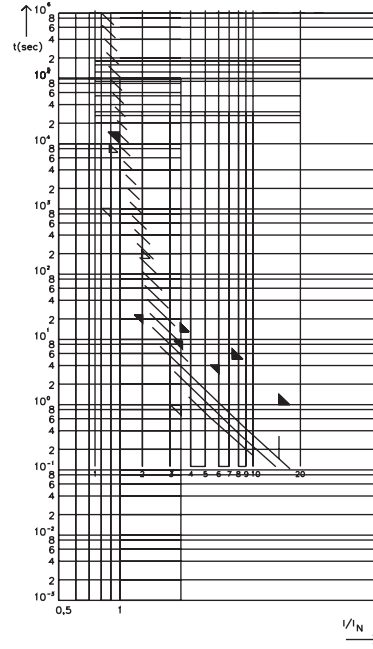

FI = 1.25 (max. operating current: $0.8 \times I_{rat}$ at 23°C)