



Chipsmall Limited consists of a professional team with an average of over 10 year of expertise in the distribution of electronic components. Based in Hongkong, we have already established firm and mutual-benefit business relationships with customers from,Europe,America and south Asia,supplying obsolete and hard-to-find components to meet their specific needs.

With the principle of “Quality Parts,Customers Priority,Honest Operation,and Considerate Service”,our business mainly focus on the distribution of electronic components. Line cards we deal with include Microchip,ALPS,ROHM,Xilinx,Pulse,ON,Everlight and Freescale. Main products comprise IC,Modules,Potentiometer,IC Socket,Relay,Connector.Our parts cover such applications as commercial,industrial, and automotives areas.

We are looking forward to setting up business relationship with you and hope to provide you with the best service and solution. Let us make a better world for our industry!



Contact us

Tel: +86-755-8981 8866 Fax: +86-755-8427 6832

Email & Skype: info@chipsmall.com Web: www.chipsmall.com

Address: A1208, Overseas Decoration Building, #122 Zhenhua RD., Futian, Shenzhen, China



Flush-type connector - SACC-E-MINF-3CON-NPT12-U20/1,0 - 1420953

Please be informed that the data shown in this PDF Document is generated from our Online Catalog. Please find the complete data in the user's documentation. Our General Terms of Use for Downloads are valid (<http://phoenixcontact.com/download>)



Flush-type connector, 3-position, Socket, straight, 7/8"-16UNF, on free cable end, Front mounting, with 1/2 inch-14 NPT mounting thread, Individual wires, cable length: 1 m

RoHS

Key Commercial Data

Packing unit	1 STK
Minimum order quantity	10 STK
GTIN	 4 055626 341460
GTIN	4055626341460

Technical data

Dimensions

Length of cable	1 m
-----------------	-----

Ambient conditions

Ambient temperature (operation)	-20 °C ... 80 °C (Plug)
Degree of protection	IP68

General

Rated current at 40°C	13 A
Rated voltage	600 V AC/DC
Number of positions	3
Insulation resistance	≥ 100 MΩ
Standards/regulations	7/8-inch connector UL 2238 Suitable for use in Class I, Division 2 Groups A, B, C, D hazardous locations according to ISA standard 12.12.01-2015, section 8.2 and 8.8.3
Status display	No
Degree of pollution	3
Connection method	Individual wires
Insertion/withdrawal cycles	> 500

Flush-type connector - SACC-E-MINF-3CON-NPT12-U20/1,0 - 1420953

Technical data

General

Torque	10 lb _F -in.
	1.12 Nm
Mounting type	Front mounting, with 1/2 inch-14 NPT mounting thread

Material

Flammability rating according to UL 94	V-0
Contact material	Copper alloy
Contact surface material	Au
Contact carrier material	PVC
Material, knurls	Anodized aluminum

Cable

Cable type	PVC litz wire
Conductor cross section	1.5 mm ²
AWG signal line	16
Conductor structure signal line	26 x AWG 30
Core diameter including insulation	2.6 mm
Thickness, insulation	Core insulation
Wire colors	Green 1, black 2, white 3
Material conductor insulation	PVC
Standards/specifications	7/8-inch connector UL 2238 Suitable for use in Class I, Division 2 Groups A, B, C, D hazardous locations according to ISA standard 12.12.01-2015, section 8.2 and 8.8.3

Standards and Regulations

Standard designation	7/8-inch connector
Standards/regulations	UL 2238
Flammability rating according to UL 94	V-0

Environmental Product Compliance

China RoHS	Environmentally Friendly Use Period = 50
	For details about hazardous substances go to tab "Downloads", Category "Manufacturer's declaration"

Drawings

Flush-type connector - SACC-E-MINF-3CON-NPT12-U20/1,0 - 1420953

Dimensional drawing

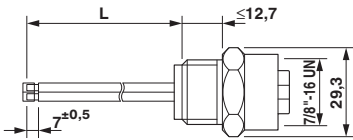

7/8" flush-type socket

Dimensional drawing

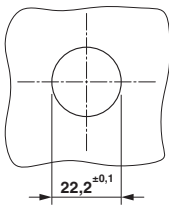

Housing cutout

Circuit diagram

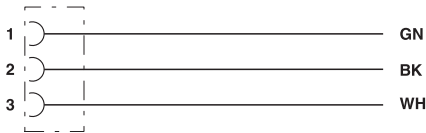

Contact assignment of 7/8" socket

Schematic diagram

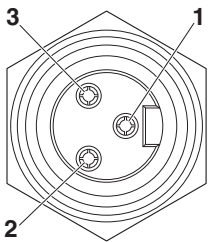

Pin assignment, socket, 7/8"-16UNF, 3-pos., view of female side

Approvals



Approvals

Approvals

UL Listed / cUL Listed / cULus Listed

Ex Approvals

Approval details

UL Listed		http://database.ul.com/cgi-bin/XYV/template/LISEXT/1FRAME/index.htm	FILE E 221474
cUL Listed		http://database.ul.com/cgi-bin/XYV/template/LISEXT/1FRAME/index.htm	FILE E 221474

Flush-type connector - SACC-E-MINF-3CON-NPT12-U20/1,0 - 1420953

Approvals

cULus Listed



Phoenix Contact 2018 © - all rights reserved
<http://www.phoenixcontact.com>

PHOENIX CONTACT GmbH & Co. KG
Flachsmarktstr. 8
32825 Blomberg
Germany
Tel. +49 5235 300
Fax +49 5235 3 41200
<http://www.phoenixcontact.com>