



Chipsmall Limited consists of a professional team with an average of over 10 year of expertise in the distribution of electronic components. Based in Hongkong, we have already established firm and mutual-benefit business relationships with customers from,Europe,America and south Asia,supplying obsolete and hard-to-find components to meet their specific needs.

With the principle of “Quality Parts,Customers Priority,Honest Operation,and Considerate Service”,our business mainly focus on the distribution of electronic components. Line cards we deal with include Microchip,ALPS,ROHM,Xilinx,Pulse,ON,Everlight and Freescale. Main products comprise IC,Modules,Potentiometer,IC Socket,Relay,Connector.Our parts cover such applications as commercial,industrial, and automotives areas.

We are looking forward to setting up business relationship with you and hope to provide you with the best service and solution. Let us make a better world for our industry!



## Contact us

Tel: +86-755-8981 8866 Fax: +86-755-8427 6832

Email & Skype: info@chipsmall.com Web: www.chipsmall.com

Address: A1208, Overseas Decoration Building, #122 Zhenhua RD., Futian, Shenzhen, China



THIS DRAWING IS UNPUBLISHED. RELEASED FOR PUBLICATION  
 © COPYRIGHT BY TYCO ELECTRONICS CORPORATION. ALL RIGHTS RESERVED.

LOC		DIST		REVISIONS			
P	LTR	DESCRIPTION		DATE	DWN	APVD	
	E	REV PER 0G3A-0696-03		04NOV03	JR	GP	
	E1	REVISED PER ECO-10-000443		18JAN10	KK	HMR	
	E2	REVISED PER ECR-12-021718		18DEC12	F.M	YHM	

- 1 INSULATED HEATER WIRE: #18-16 AWG.  
HEATER WIRE CORE DIA: 1.02 MAX
- 2 REF CRIMP INFO: WIRE BBL .090, F TYPE  
INSULATION BBL .120, F TYPE
- ③ TRAVERSE WINDING ON METAL REEL.
- ④ IN-LINE WINDING ON A CARDBOARD REEL
- ⑤ OBSOLETE PARTS: OBSOLETE CIS STREAMLINING PER D.RENAUD/D.SINISI

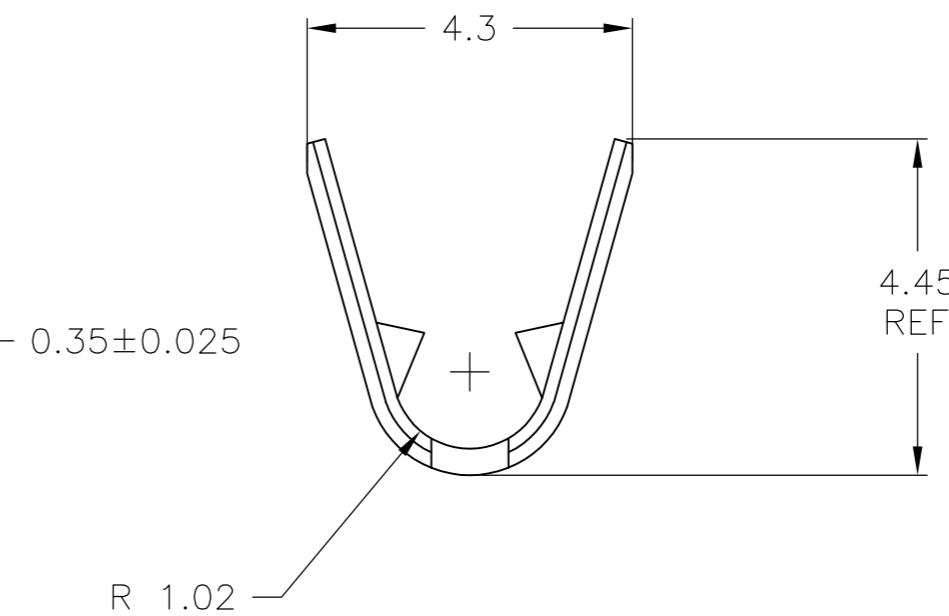
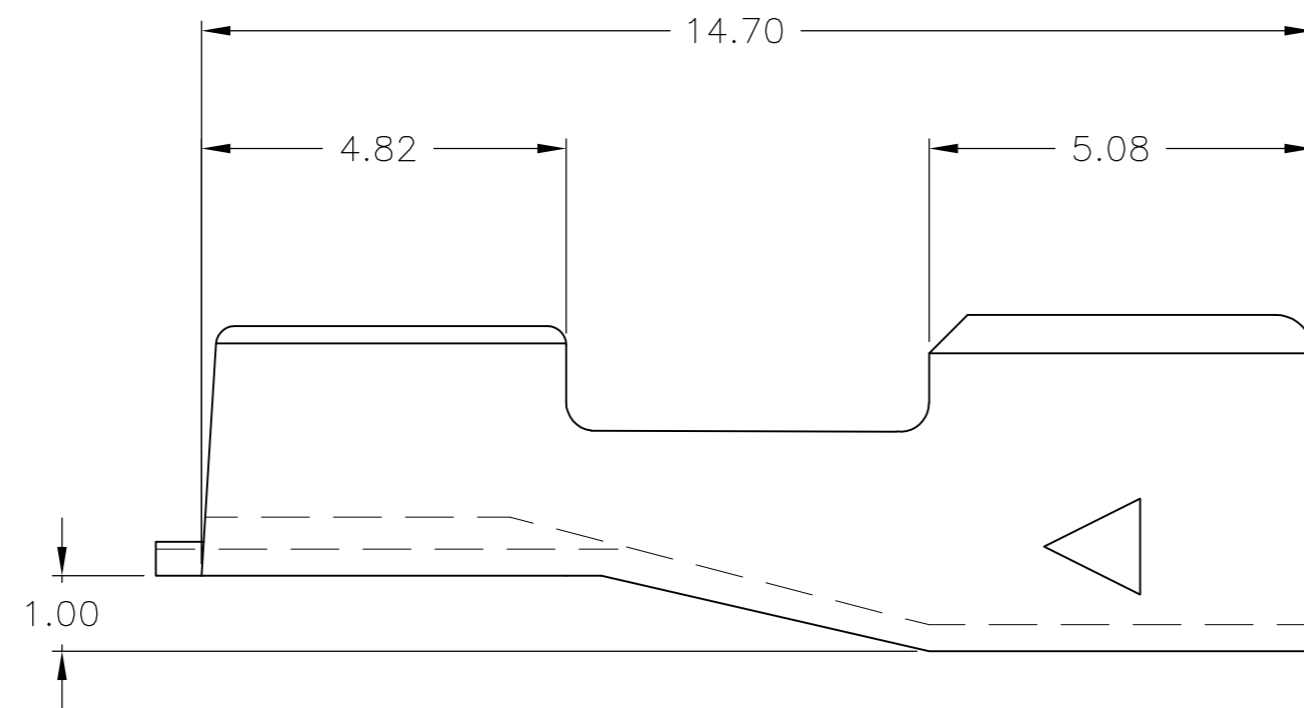
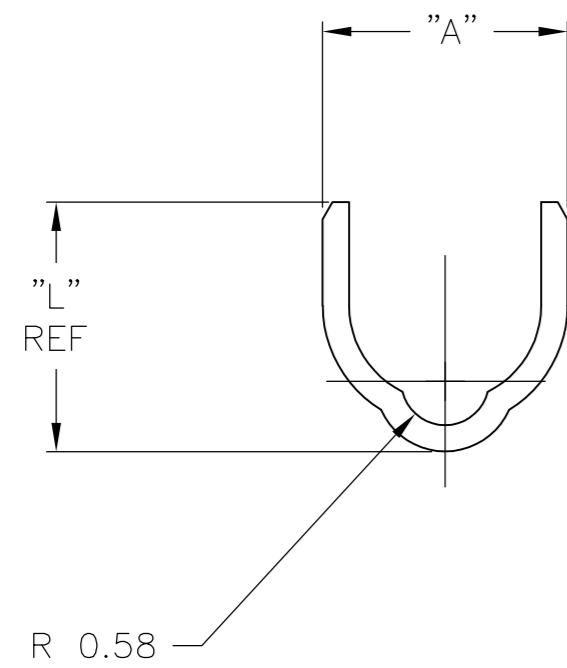
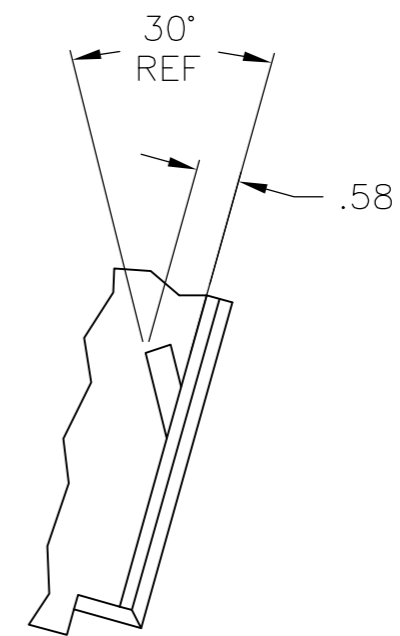
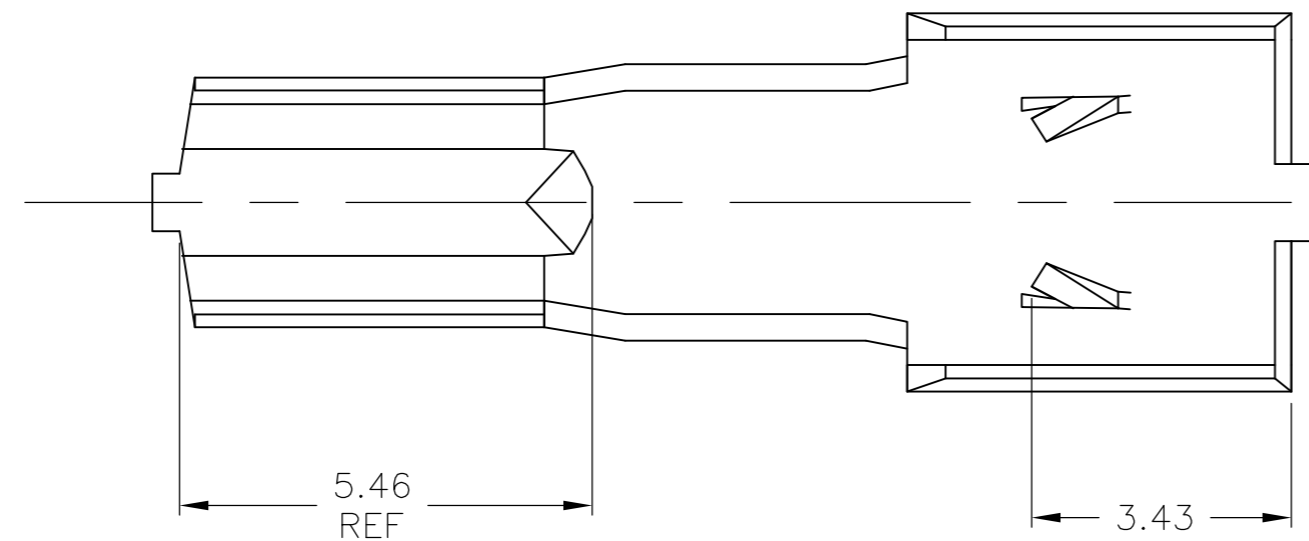

PCS/REEL	"L"	"A"	NOTES	STD. WIRE SIZE	FINISH	PART NO.
7,500	4.44	3.8	③	#14-12 AWG	PRE-TIN	1438246-6
5,000	4.44	3.8	④	#14-12 AWG	-	<del>1438246-5</del>
5,000	3.18	3.3	④	#18-16 AWG	-	1438246-4
7,500	4.44	3.8	③	#14-12 AWG	-	1438246-3
5,000	3.18	3.3	④	#18-16 AWG	PRE-TIN	1438246-2
12,500	3.18	3.3	③	#18-16 AWG	-	1438246-1

THIS DRAWING IS A CONTROLLED DOCUMENT.

DWN	B.P	21MAY2002	Tyco Electronics Corporation Harrisburg, PA 17105
CHK	F.M	21MAY02	
APVD	Y.H.M	21MAY02	
PRODUCT SPEC			
APPLICATION SPEC			NAME
			SPLICE, BUTT, HEATER WIRE
MATERIAL	081M BRASS	FINISH	SEE TABLE
WEIGHT	-	SCALE	A2 10:1
CUSTOMER DRAWING		SHEET	1 OF 1

RESTRICTED TO: -

REV E2