



Chipsmall Limited consists of a professional team with an average of over 10 year of expertise in the distribution of electronic components. Based in Hongkong, we have already established firm and mutual-benefit business relationships with customers from,Europe,America and south Asia,supplying obsolete and hard-to-find components to meet their specific needs.

With the principle of "Quality Parts,Customers Priority,Honest Operation,and Considerate Service",our business mainly focus on the distribution of electronic components. Line cards we deal with include Microchip,ALPS,ROHM,Xilinx,Pulse,ON,Everlight and Freescale. Main products comprise IC,Modules,Potentiometer,IC Socket,Relay,Connector.Our parts cover such applications as commercial,industrial, and automotives areas.

We are looking forward to setting up business relationship with you and hope to provide you with the best service and solution. Let us make a better world for our industry!



Contact us

Tel: +86-755-8981 8866 Fax: +86-755-8427 6832

Email & Skype: info@chipsmall.com Web: www.chipsmall.com

Address: A1208, Overseas Decoration Building, #122 Zhenhua RD., Futian, Shenzhen, China



THIS DRAWING IS UNPUBLISHED. RELEASED FOR PUBLICATION
 © COPYRIGHT BY TYCO ELECTRONICS CORPORATION. ALL RIGHTS RESERVED.

LOC	DIST	REVISIONS					
AF	50	P	LTR	DESCRIPTION	DATE	DWN	APVD
			0	REDRAWN	17JAN02	JR	GP

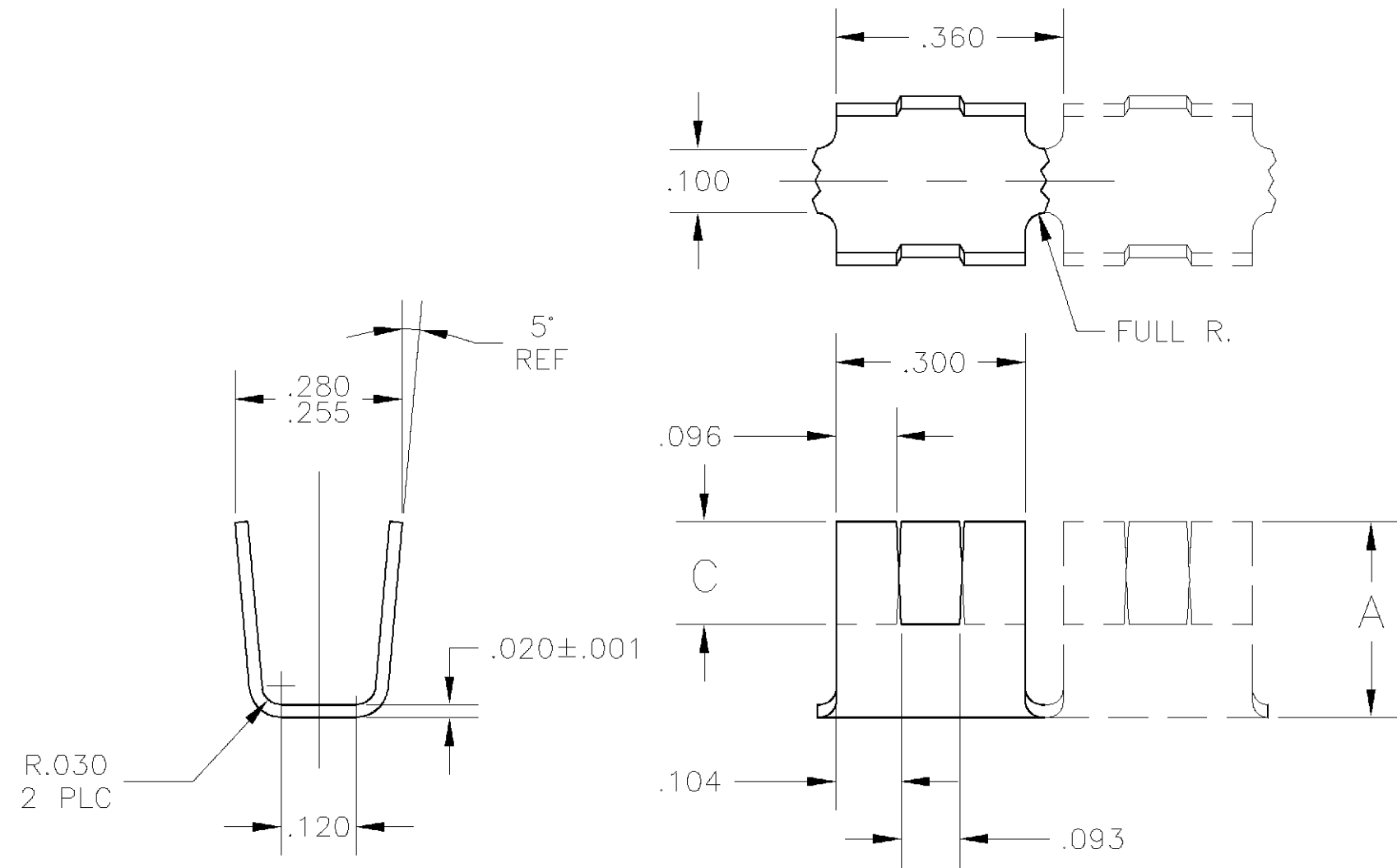

C01CA-W330R0	.345	.825	.198	1438254-2
C01CA-R330R0	.310	.750	.162	1438254-1
PART NO.	A ±.01	B ^{+0.00} _{-.005}	C ±.010	TYCO PART NO.

THIS DRAWING IS A CONTROLLED DOCUMENT.		DWN	JR RUTH	17JAN2002	Tyco Electronics Corporation City, State, Zip						
DIMENSIONS: INCHES		CHK	G PORTA	17JAN02				NAME IDENTIFICATION BAND - -			
		APVD	G PORTA	17JAN02	PRODUCT SPEC - APPLICATION SPEC -						
TOLERANCES UNLESS OTHERWISE SPECIFIED: 0 PLC ± - 1 PLC ± - 2 PLC ± - 3 PLC ± .010 4 PLC ± - ANGLES ± -		WEIGHT	-	SIZE				A3	CAGE CODE	00779	DRAWING NO
MATERIAL H 14 ALUMINUM		CUSTOMER DRAWING			SCALE	4:1	SHEET	1 OF 1	REV	0	