



Chipsmall Limited consists of a professional team with an average of over 10 year of expertise in the distribution of electronic components. Based in Hongkong, we have already established firm and mutual-benefit business relationships with customers from,Europe,America and south Asia,supplying obsolete and hard-to-find components to meet their specific needs.

With the principle of “Quality Parts,Customers Priority,Honest Operation,and Considerate Service”,our business mainly focus on the distribution of electronic components. Line cards we deal with include Microchip,ALPS,ROHM,Xilinx,Pulse,ON,Everlight and Freescale. Main products comprise IC,Modules,Potentiometer,IC Socket,Relay,Connector.Our parts cover such applications as commercial,industrial, and automotives areas.

We are looking forward to setting up business relationship with you and hope to provide you with the best service and solution. Let us make a better world for our industry!



## Contact us

Tel: +86-755-8981 8866 Fax: +86-755-8427 6832

Email & Skype: info@chipsmall.com Web: www.chipsmall.com

Address: A1208, Overseas Decoration Building, #122 Zhenhua RD., Futian, Shenzhen, China



# Flush-type connector - SACC-SQ-M12FS-5CON-25F/0,5 - 1440986

Please be informed that the data shown in this PDF Document is generated from our Online Catalog. Please find the complete data in the user's documentation. Our General Terms of Use for Downloads are valid (<http://phoenixcontact.com/download>)



Sensor/Actuator flush-type socket, 5-pos., M12, A-coded, front/square flange mounting, with 0.5 m TPE litz wire, 5 x 0.34 mm<sup>2</sup>

## Why buy this product

- ✓ 4 x fixing hole, 2.7 mm
- ✓ With form seal for M2.5 screws
- ✓ Pre-assembled with litz wires for immediate use
- ✓ Customer-specific assemblies and litz wire lengths available
- ✓ Sealed on the litz wire side for optimum leak-tightness
- ✓ All standard pin assignments and codings for signal, data, and power transmission with a uniform design-in design
- ✓ For high transmission safety: shield connection to the housing with optional EMC nut
- ✓ SPEEDCON fast locking system reduces cabling times



## Key Commercial Data

|              |               |
|--------------|---------------|
| Packing unit | 1 STK         |
| GTIN         |               |
| GTIN         | 4046356533843 |

## Technical data

### Dimensions

|                 |       |
|-----------------|-------|
| Length of cable | 0.5 m |
|-----------------|-------|

### Ambient conditions

|                                 |                                  |
|---------------------------------|----------------------------------|
| Ambient temperature (operation) | -25 °C ... 85 °C (Plug / socket) |
| Degree of protection            | IP67                             |

### General

|      |   |
|------|---|
| Note | The electrical and mechanical data specified assume that the connector pair is correctly locked and mounted. If the connector is unlocked and if there is a danger of contamination, the connector must be sealed using |
|------|---|

# Flush-type connector - SACC-SQ-M12FS-5CON-25F/0,5 - 1440986

## Technical data

### General

|                             |  |
|-----------------------------|--|
|                             | a protective cap > IP54. Influences arising from litz wires, cables or PCB assembly must also be taken into consideration. |
| Rated current at 40°C       | 4 A  |
| Rated voltage               | 60 V   |
| Rated surge voltage         | 1.5 kV   |
| Number of positions         | 5  |
| Insulation resistance       | ≥ 100 MΩ   |
| Coding                      | A - standard   |
| Standards/regulations       | M12 connector IEC 61076-2-101  |
| Status display              | No   |
| Overvoltage category        | II   |
| Degree of pollution         | 3  |
| Connection method           | Individual wires   |
| Insertion/withdrawal cycles | > 100  |
| Torque                      | 3 Nm ... 4 Nm (Installation-side)  |
| Mounting type               | Front mounting Square flange   |

### Material

|  |                              |
|--|------------------------------|
| Flammability rating according to UL 94 | V0                           |
| Contact material                       | CuZn                         |
| Contact surface material               | Ni/Au                        |
| Contact carrier material               | PA 6.6                       |
| Material of grip body                  | Zinc die-cast, nickel-plated |
| Material, knurls                       | Zinc die-cast, nickel-plated |
| Sealing material                       | FKM                          |

### Cable

|                                    |  |
|------------------------------------|--|
| Cable type                         | TPE litz wire                                |
| Conductor cross section            | 0.34 mm <sup>2</sup>                         |
| AWG signal line                    | 22   |
| Conductor structure signal line    | 7x 0.25 mm                                   |
| Core diameter including insulation | 1.2 mm ±0.07 mm                              |
| Thickness, insulation              | 0.21 mm (Core insulation)                    |
| Wire colors                        | Brown, white, blue, black, gray              |
| Material conductor insulation      | TPE  |
| Conductor material                 | Tin-plated Cu litz wires                     |
| Standards/specifications           | M12 connector IEC 61076-2-101                |
| Insulation resistance              | ≥ 20 MΩ*km                                   |
| Conductor resistance               | ≤ 57.6 mΩ/m                                  |
| Nominal voltage, cable             | 300 V  |
| Test voltage, cable                | 2000 V AC                                    |
| Ambient temperature (operation)    | -40 °C ... 85 °C (cable, fixed installation) |

# Flush-type connector - SACC-SQ-M12FS-5CON-25F/0,5 - 1440986

## Technical data

### Cable

|  |   |
|--|---|
|  | -25 °C ... 85 °C (cable, flexible installation) |
|--|---|

### Standards and Regulations

|  |                 |
|--|-----------------|
| Standard designation                   | M12 connector   |
| Standards/regulations                  | IEC 61076-2-101 |
| Flammability rating according to UL 94 | V0              |

### Environmental Product Compliance

|            |   |
|------------|---|
| REACH SVHC | Lead 7439-92-1  |
| China RoHS | Environmentally Friendly Use Period = 50  |
|            | For details about hazardous substances go to tab "Downloads", Category "Manufacturer's declaration" |

## Drawings

Schematic diagram

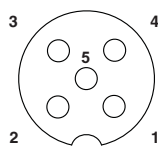

Pin assignment M12 socket, 5-pos., A-coded, socket side view

Dimensional drawing

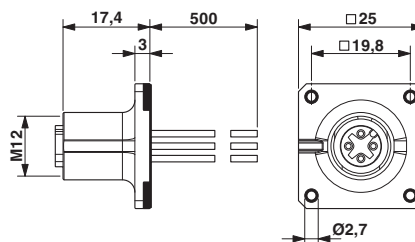

Circuit diagram

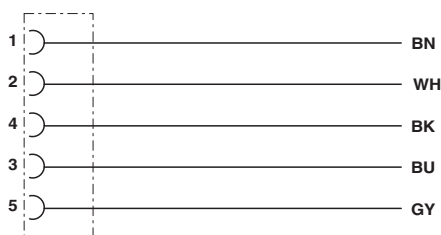

Contact assignment of the M12 plug and the M12 socket

## Approvals

### Approvals

### Approvals

cULus Recognized / EAC

# Flush-type connector - SACC-SQ-M12FS-5CON-25F/0,5 - 1440986

## Approvals

Ex Approvals

### Approval details

|   |       |
|---|-------|
| cULus Recognized  <a href="http://database.ul.com/cgi-bin/XYV/template/LISEXT/1FRAME/index.htm">http://database.ul.com/cgi-bin/XYV/template/LISEXT/1FRAME/index.htm</a> E221474-20140616 |       |
| Nominal voltage UN  | 60 V  |
| Nominal current IN  | 4 A   |
| mm <sup>2</sup> /AWG/kcmil  | 22-20 |

|   |
|---|
| EAC  B.00767 |
|---|

Phoenix Contact 2018 © - all rights reserved  
<http://www.phoenixcontact.com>

PHOENIX CONTACT GmbH & Co. KG  
Flachsmarktstr. 8  
32825 Blomberg  
Germany  
Tel. +49 5235 300  
Fax +49 5235 3 41200  
<http://www.phoenixcontact.com>