



Chipsmall Limited consists of a professional team with an average of over 10 year of expertise in the distribution of electronic components. Based in Hongkong, we have already established firm and mutual-benefit business relationships with customers from,Europe,America and south Asia,supplying obsolete and hard-to-find components to meet their specific needs.

With the principle of “Quality Parts,Customers Priority,Honest Operation,and Considerate Service”,our business mainly focus on the distribution of electronic components. Line cards we deal with include Microchip,ALPS,ROHM,Xilinx,Pulse,ON,Everlight and Freescale. Main products comprise IC,Modules,Potentiometer,IC Socket,Relay,Connector.Our parts cover such applications as commercial,industrial, and automotives areas.

We are looking forward to setting up business relationship with you and hope to provide you with the best service and solution. Let us make a better world for our industry!



## Contact us

Tel: +86-755-8981 8866 Fax: +86-755-8427 6832

Email & Skype: info@chipsmall.com Web: www.chipsmall.com

Address: A1208, Overseas Decoration Building, #122 Zhenhua RD., Futian, Shenzhen, China



THIS DRAWING IS UNPUBLISHED. RELEASED FOR PUBLICATION 20  
 © COPYRIGHT 20 ALL RIGHTS RESERVED.

REVISIONS				
P	LTR	DESCRIPTION	DATE	APVD
	A3	REVISED PER ECO-15-015644	01DEC2015	DD JS

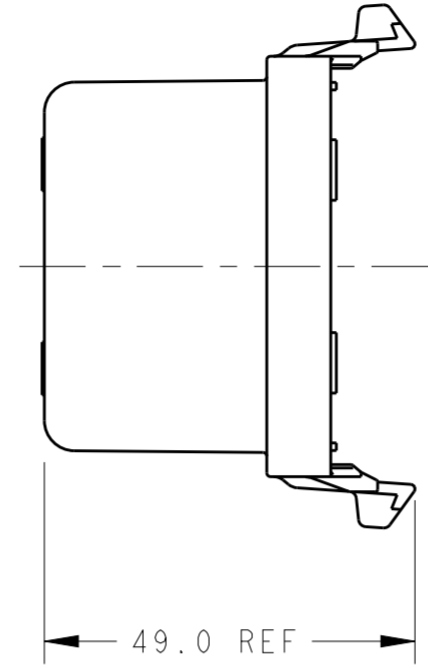
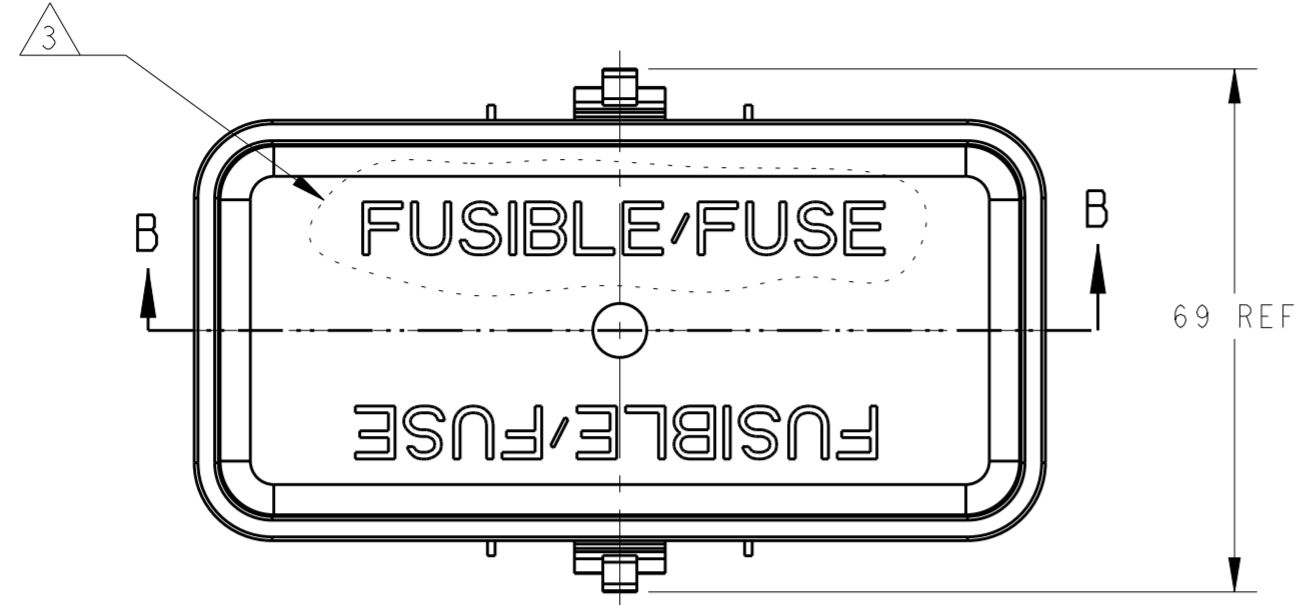

- ① MATERIAL- PBT, BLACK
- ② SPARE MINI FUSE HOLDERS, 1443996-1 AND 1443996-3 ONLY.
- ③ TOPSIDE RAISED TEXT: "FUSIBLE/FUSE", 1443996-1 AND 1443996-2 ONLY.

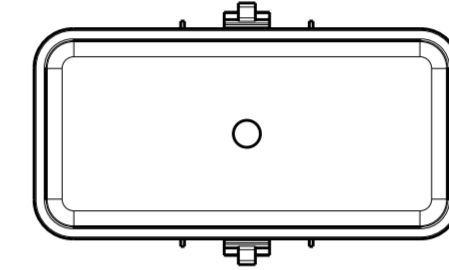

SCALE 1:2  
 NO TOPSIDE GRAPHICS  
 1443996-3 AND 1443996-4

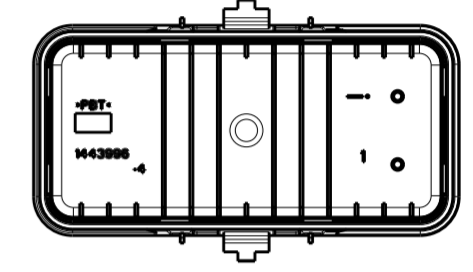

SCALE 1:2  
 W/O FUSE HOLDER  
 1443996-2 AND 1443996-4

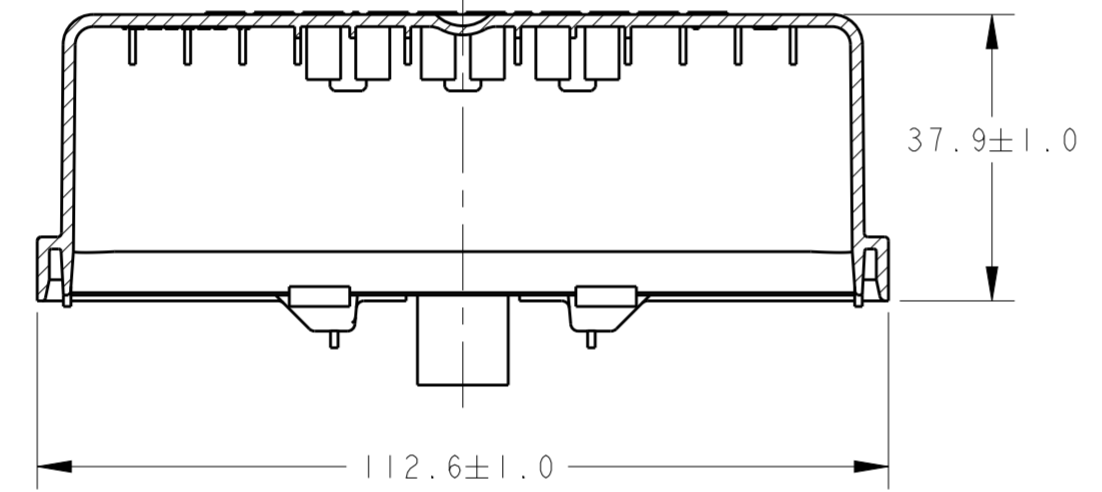

SECTION B-B

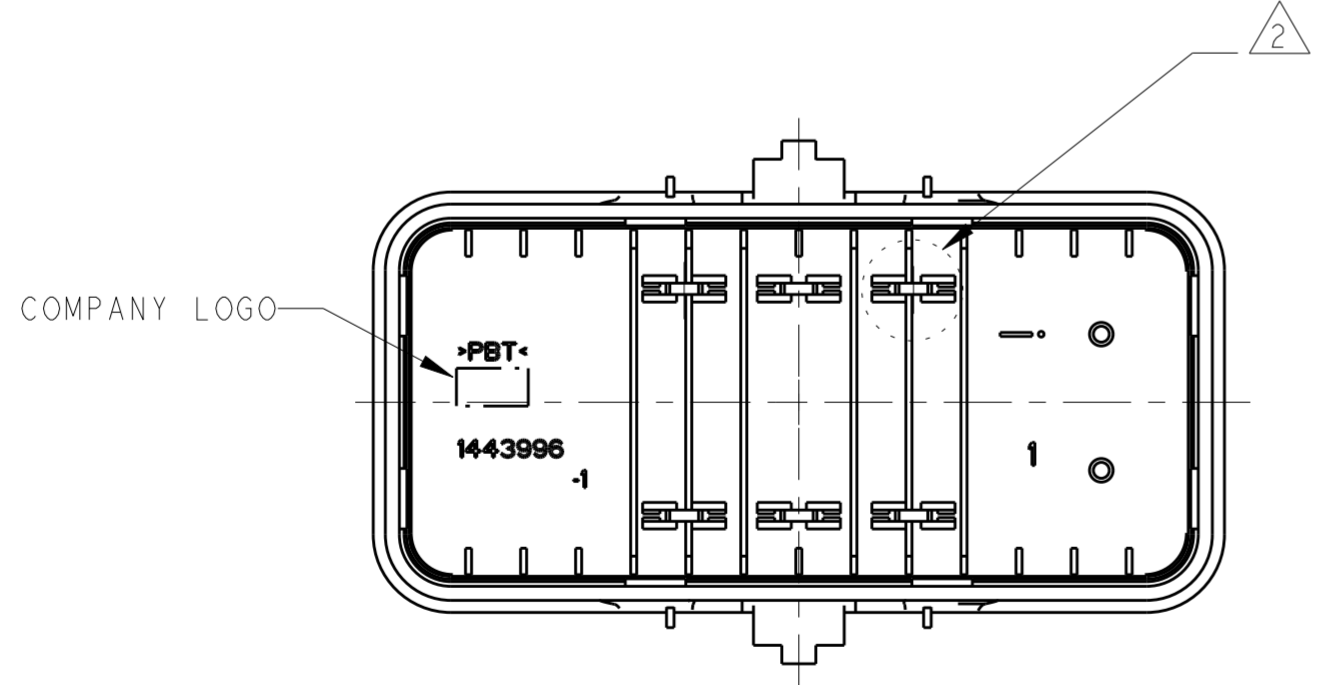

SCALE 1:1  
 1443996-1 SHOWN

COVER, 60 POS, W/O FUSE HOLDER, NO TOPSIDE GRAPHICS.	1443996-4
COVER, 60 POS, NO TOPSIDE GRAPHICS	1443996-3 ②
COVER, 60 POS, W/O FUSE HOLDER	1443996-2 ③
COVER, 60 POSITION	1443996-1 ② ③
DESCRIPTION	PART NUMBER

DIMENSIONS:		TOLERANCES UNLESS OTHERWISE SPECIFIED:	
mm			
0 PLC	±1		
1 PLC	±0.25		
2 PLC	±0.15		
3 PLC	±		
4 PLC	±		
ANGLES	±1		
FINISH	-		
	-		

THIS DRAWING IS A CONTROLLED DOCUMENT.		DWN	K BOYD	17MAY2005
		CHK	K BOYD	17MAY2005
		APVD	R MCCRAW	17MAY2005
		PRODUCT SPEC	-	
		APPLICATION SPEC	-	
		WEIGHT	-	
		CUSTOMER DRAWING	SCALE 1:1 SHEET OF REV A3	
		TE Connectivity		
		NAME COVER, 60 POSITION		
SIZE	A2	CAGE CODE	00779	DRAWING NO
				C-1443996
				RESTRICTED TO