



Chipsmall Limited consists of a professional team with an average of over 10 year of expertise in the distribution of electronic components. Based in Hongkong, we have already established firm and mutual-benefit business relationships with customers from,Europe,America and south Asia,supplying obsolete and hard-to-find components to meet their specific needs.

With the principle of “Quality Parts,Customers Priority,Honest Operation,and Considerate Service”,our business mainly focus on the distribution of electronic components. Line cards we deal with include Microchip,ALPS,ROHM,Xilinx,Pulse,ON,Everlight and Freescale. Main products comprise IC,Modules,Potentiometer,IC Socket,Relay,Connector.Our parts cover such applications as commercial,industrial, and automotives areas.

We are looking forward to setting up business relationship with you and hope to provide you with the best service and solution. Let us make a better world for our industry!



Contact us

Tel: +86-755-8981 8866 Fax: +86-755-8427 6832

Email & Skype: info@chipsmall.com Web: www.chipsmall.com

Address: A1208, Overseas Decoration Building, #122 Zhenhua RD., Futian, Shenzhen, China



LOC	DIST	REVISIONS				
AD	12	REV	DESCRIPTION	DATE	BY	APPD
		0	RELEASED	29OCT87	MK1	JS

△ MATERIAL: POLYCARBONATE
 COLOR: BLACK.
 2. 1 PART MASS IS APPROXIMATELY 5.5 GRAMS.
 3. USED IN KIT 145308.

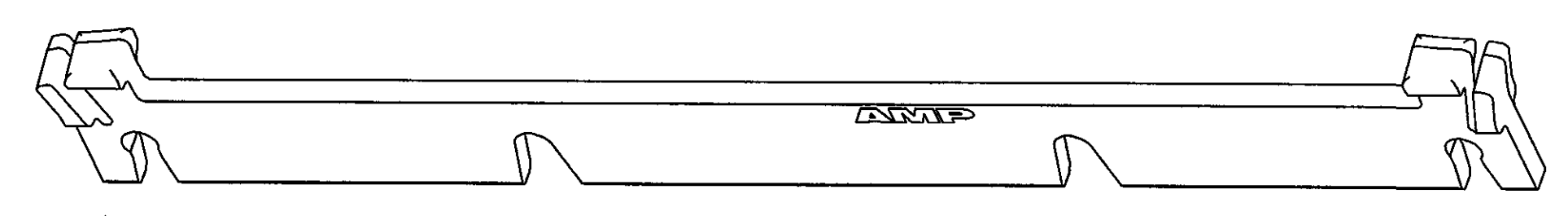
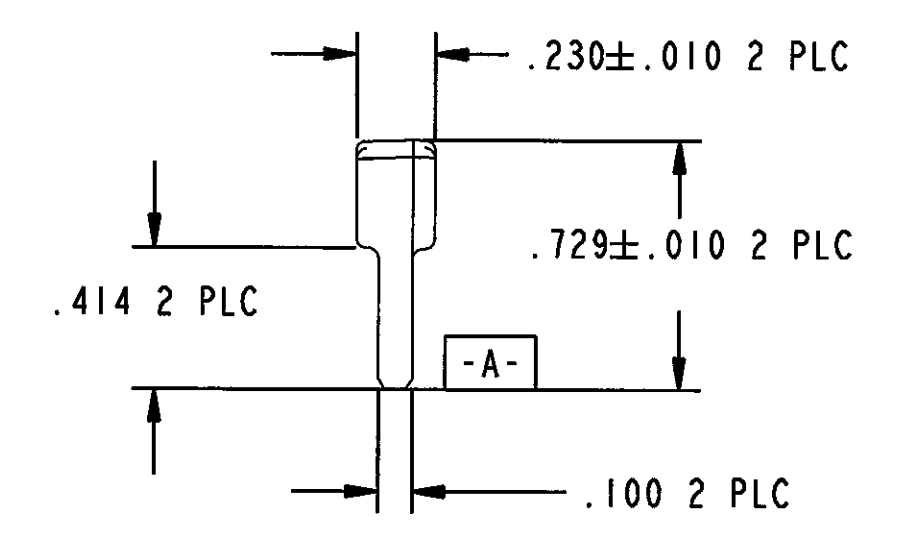
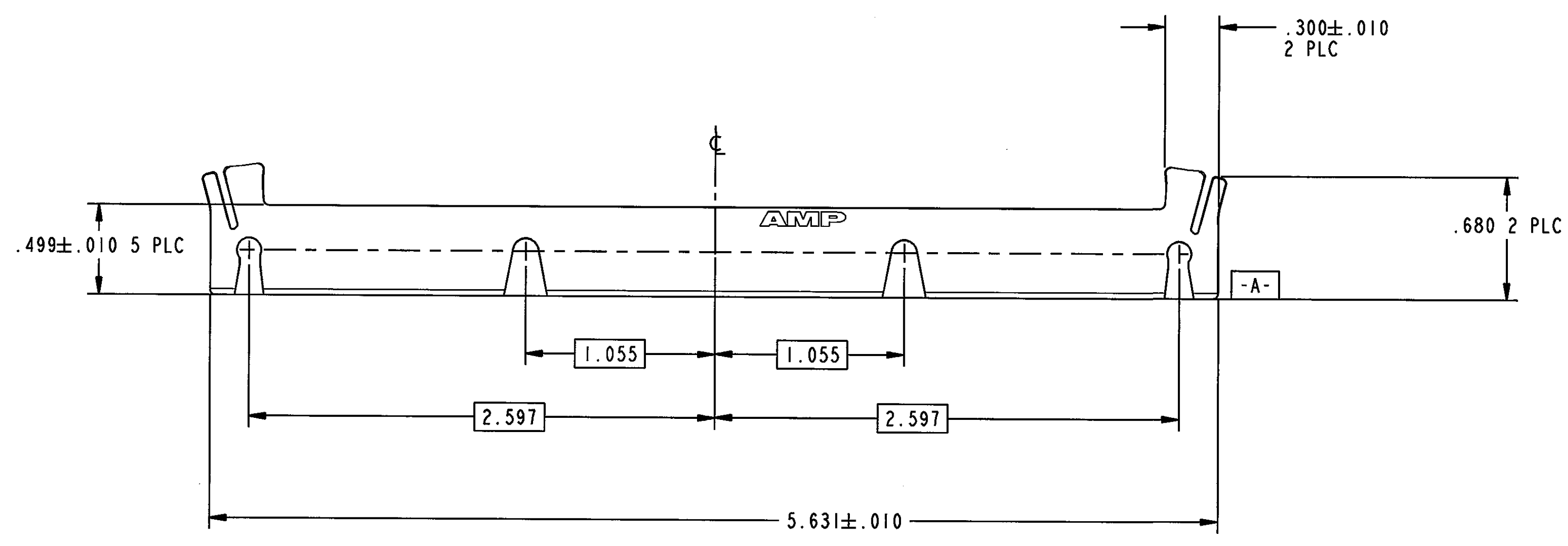
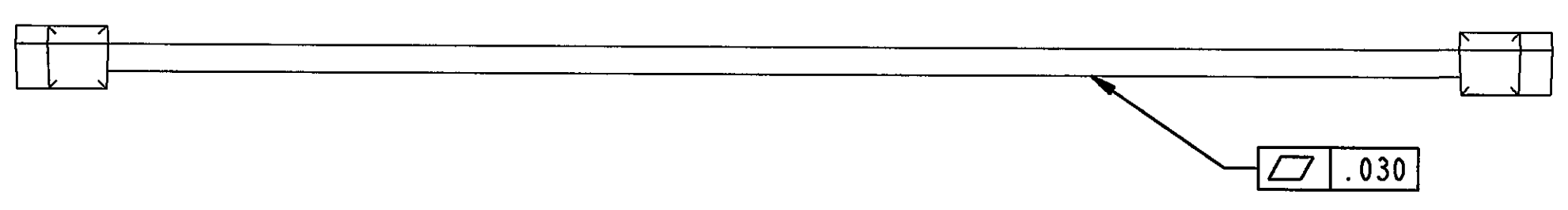

<small>THIS DRAWING IS A CONTROLLED DOCUMENT FOR AMP CORPORATION. IT IS SUBJECT TO CHANGE AND TO CONTROLLED REVISIONS. ORGANIZATION SHOULD BE CONTACTED FOR THE LATEST REVISIONS.</small>		DATE: 23JUN97 BY: E. F. Berkebile CHK: -	AMP Incorporated Harrisburg, PA 17105-3608	
DIMENSIONS: INCHES TOLERANCES UNLESS OTHERWISE SPECIFIED: 0 PLC ± 1 PLC ± 2 PLC ± 3 PLC ±.005 4 PLC ± ANGLE: 30°		NAME: TOP BAR, HEATSINK SUPPORT PRODUCT SPEC: - APPLICATION SPEC: -	SIZE: A1 CASE CODE: 00779 DRAWING NO: 145310	SCALE: 2:1 SHEET: 1 OF 1 REV: 0
MATERIAL: △ FINISH: -		WEIGHT: - CUSTOMER DRAWING: -		