



Chipsmall Limited consists of a professional team with an average of over 10 year of expertise in the distribution of electronic components. Based in Hongkong, we have already established firm and mutual-benefit business relationships with customers from,Europe,America and south Asia,supplying obsolete and hard-to-find components to meet their specific needs.

With the principle of “Quality Parts,Customers Priority,Honest Operation,and Considerate Service”,our business mainly focus on the distribution of electronic components. Line cards we deal with include Microchip,ALPS,ROHM,Xilinx,Pulse,ON,Everlight and Freescale. Main products comprise IC,Modules,Potentiometer,IC Socket,Relay,Connector.Our parts cover such applications as commercial,industrial, and automotives areas.

We are looking forward to setting up business relationship with you and hope to provide you with the best service and solution. Let us make a better world for our industry!



Contact us

Tel: +86-755-8981 8866 Fax: +86-755-8427 6832

Email & Skype: info@chipsmall.com Web: www.chipsmall.com

Address: A1208, Overseas Decoration Building, #122 Zhenhua RD., Futian, Shenzhen, China



LOC		DIST		REVISONS			
P	LTR	DESCRIPTION	DATE	DWN	APVD		
B		REVISED PER ECO-11-004232	03AUG2011	CJV	EDB		

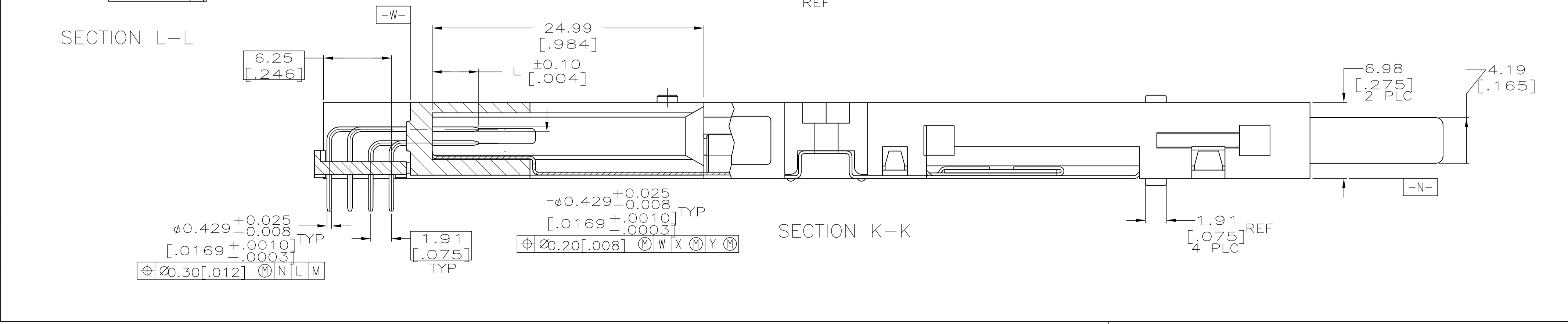
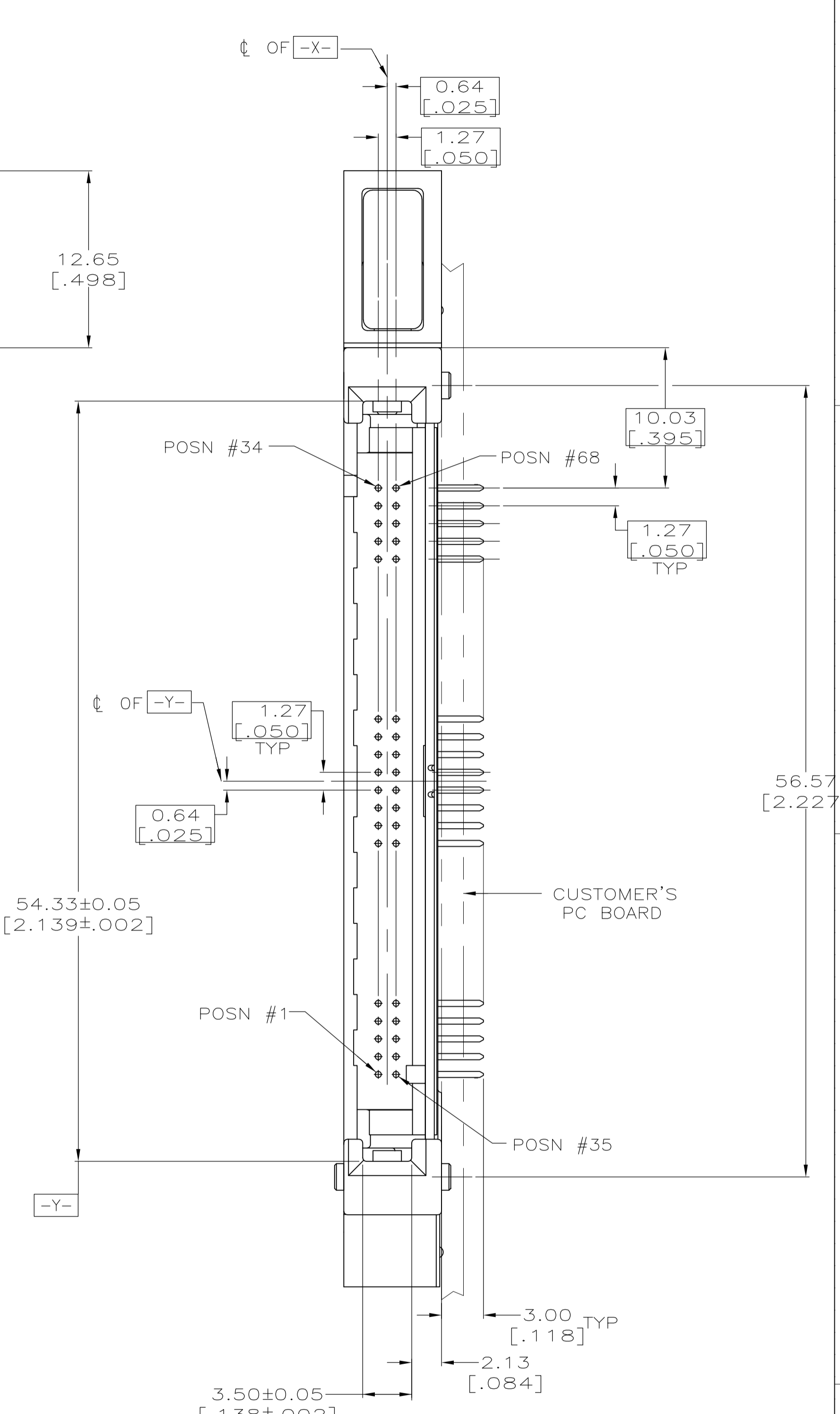
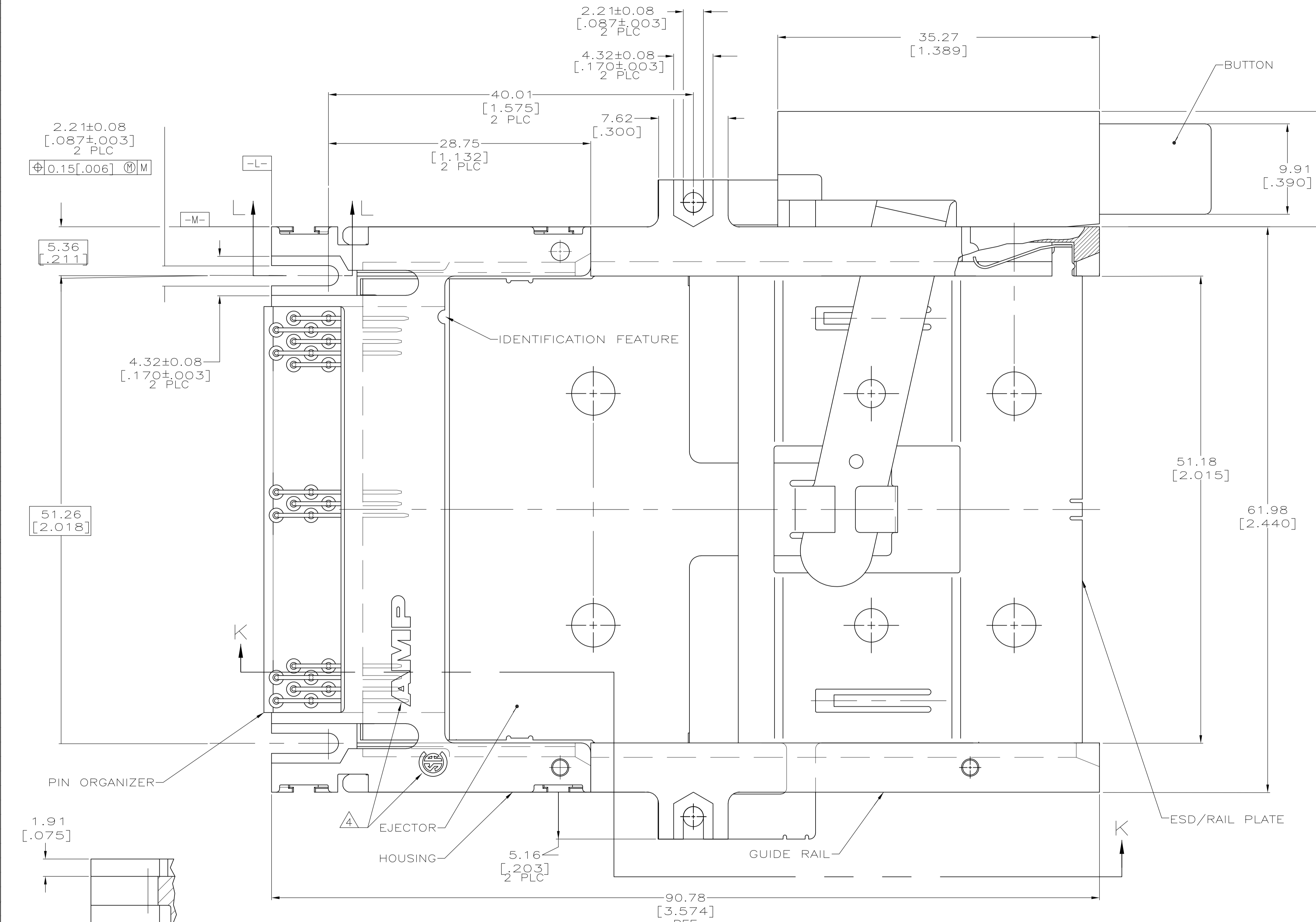

SUPERSEDED BY 5146025-1	1,17,34 35,51,68 5.0 [.197]	ALL OTHER PINS 4.25 [.167]	36,67 3.5 [.138]	146025-1
"L" (PIN LENGTH) AND LOCATION				
THIS DRAWING IS A CONTROLLED DOCUMENT.		DWN J MOSER 8/30/93	TE Connectivity	
DIMENSIONS: (mm) INCHES		CHK B ELICKER 8/30/93	APVD B ELICKER 8/30/93	
TOLERANCES UNLESS OTHERWISE SPECIFIED:		NAME		
0 PLC ±	1 PLC ±	PRODUCT SPEC		
2 PLC ±	3 PLC ±	APPLICATION SPEC		
4 PLC ±	ANGLES ±	SIZE CAGE CODE DRAWING NO RESTRICTED TO		
MATERIAL	FINISH	WEIGHT 24.4 GRAMS A1 00779 C-146025		
CUSTOMER DRAWING		SCALE 4:1 SHEET 1 OF 2 REV B		

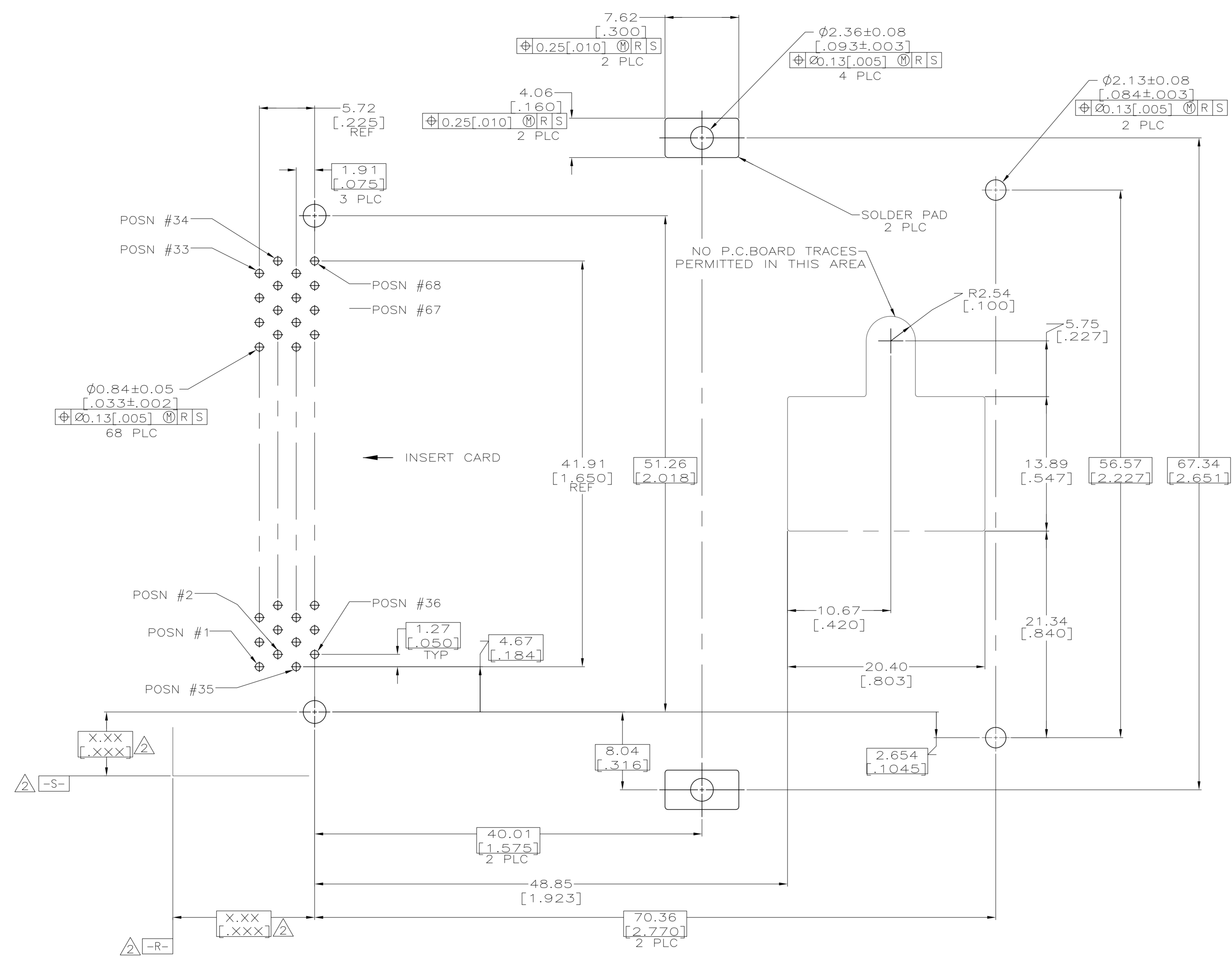

- 1. PIN FINISH: 0.00076[.000030] MINIMUM GOLD IN CONTACT AREA, 0.00381[.000150] MIN TIN-LEAD ON SOLDER TAILS, ALL OVER 0.00127[.000050] MINIMUM NICKEL
- 2. DATUMS AND BASIC DIMENSIONS ESTABLISHED BY CUSTOMER
- 3. CONNECTOR REQUIRES USE OF 4 - SIZE 2M SCREWS FOR FASTENING TO PRINTED CIRCUIT BOARD
- 4. RECESSED AMP AND CSA LOGOS LOCATED ON BOTH SIDES OF HOUSING.
- 5. HOUSING MATERIAL: LCP, BLACK
GUIDE MATERIAL: LCP, BLACK
SHROUD MATERIAL: LCP, BLACK
BUTTON MATERIAL: LCP, BLACK
ORGANIZER MATERIAL: LCP, BLACK
PIN MATERIAL: BRASS
EJECTOR MATERIAL: STAINLESS STEEL
RAIL PLATE MATERIAL: STAINLESS STEEL
LEVER MATERIAL: STAINLESS STEEL.

RECOMMENDED BOARD LAYOUT

THIS DRAWING IS A CONTROLLED DOCUMENT.		DWG J. MOSER 8/30/93	 TE Connectivity
DIMENSIONS: INCHES		CHK B. FLICKER 8/30/93	
TOLERANCES UNLESS OTHERWISE SPECIFIED:		NAME B. FLICKER 8/30/93	PRODUCT SPEC APPLICATION SPEC RESTRICTED TO
0 PLC ± - 1 PLC ± - 2 PLC ± 0.13 [0.005] 3 PLC ± - 4 PLC ± - ANGLES ± -		SIZE A1 CAGE CODE 00779 DRAWING NO. 146025	
MATERIAL		WEIGHT	CUSTOMER DRAWING SCALE 4:1 SHEET 2 OF 2 REV B