



Chipsmall Limited consists of a professional team with an average of over 10 year of expertise in the distribution of electronic components. Based in Hongkong, we have already established firm and mutual-benefit business relationships with customers from,Europe,America and south Asia,supplying obsolete and hard-to-find components to meet their specific needs.

With the principle of “Quality Parts,Customers Priority,Honest Operation,and Considerate Service”,our business mainly focus on the distribution of electronic components. Line cards we deal with include Microchip,ALPS,ROHM,Xilinx,Pulse,ON,Everlight and Freescale. Main products comprise IC,Modules,Potentiometer,IC Socket,Relay,Connector.Our parts cover such applications as commercial,industrial, and automotives areas.

We are looking forward to setting up business relationship with you and hope to provide you with the best service and solution. Let us make a better world for our industry!



## Contact us

Tel: +86-755-8981 8866 Fax: +86-755-8427 6832

Email & Skype: info@chipsmall.com Web: www.chipsmall.com

Address: A1208, Overseas Decoration Building, #122 Zhenhua RD., Futian, Shenzhen, China



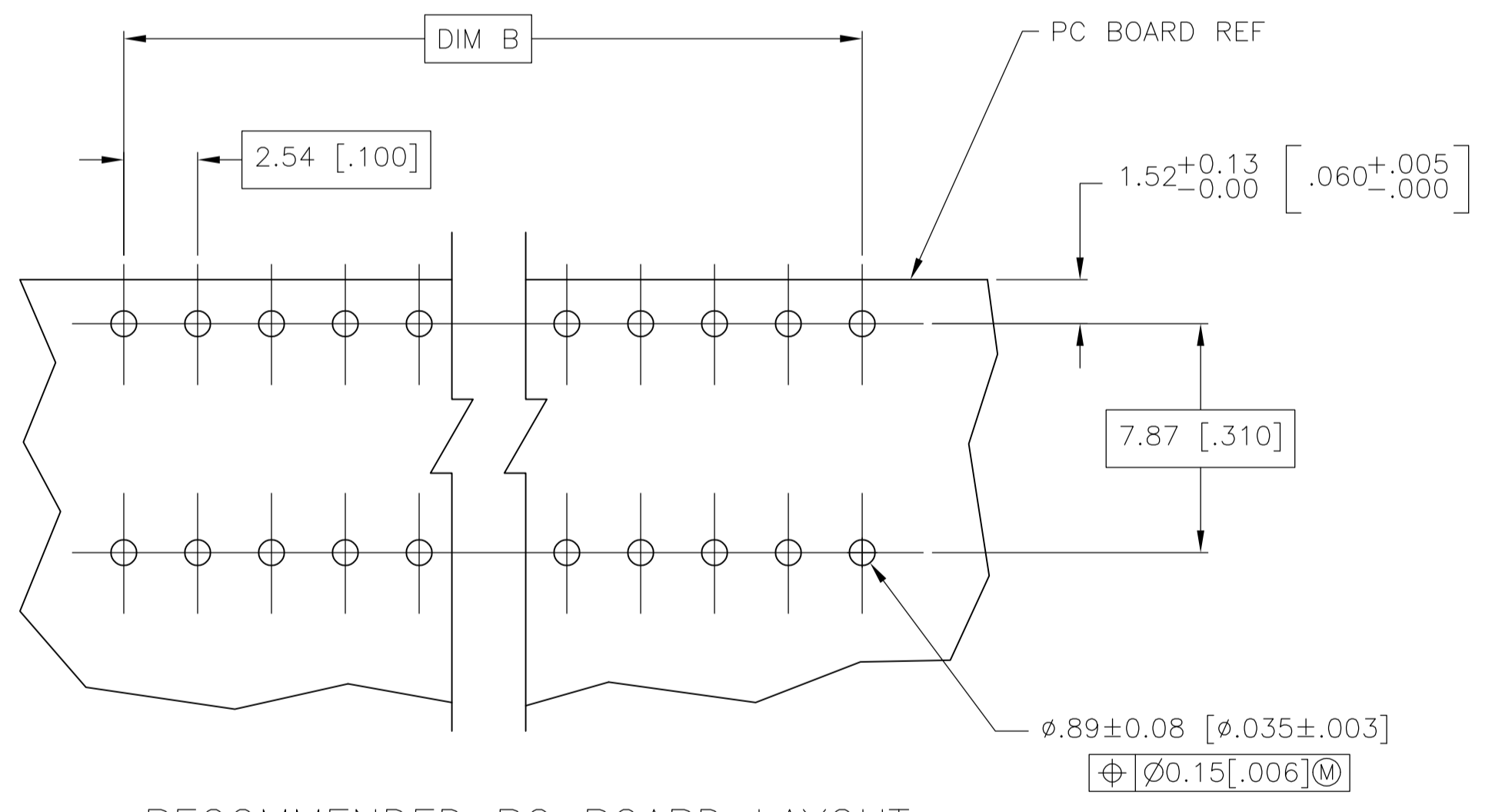
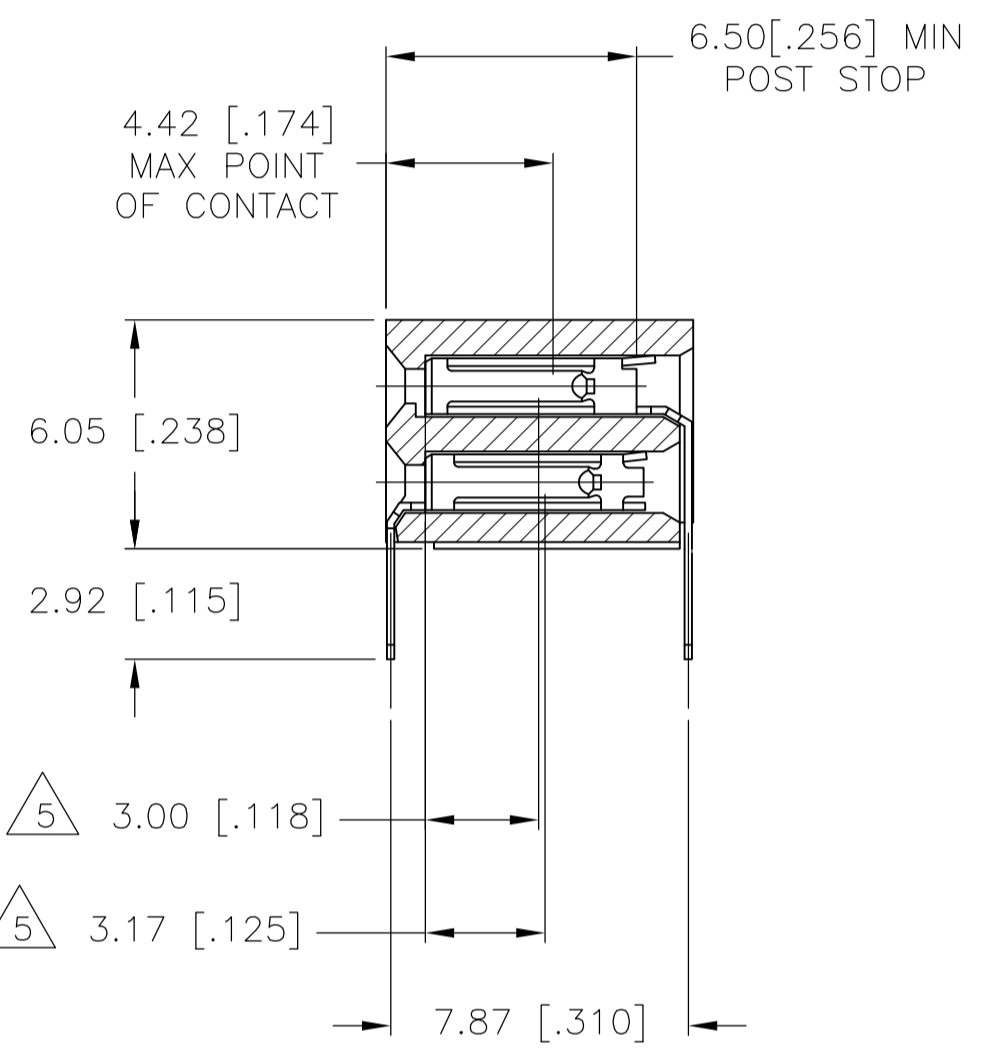
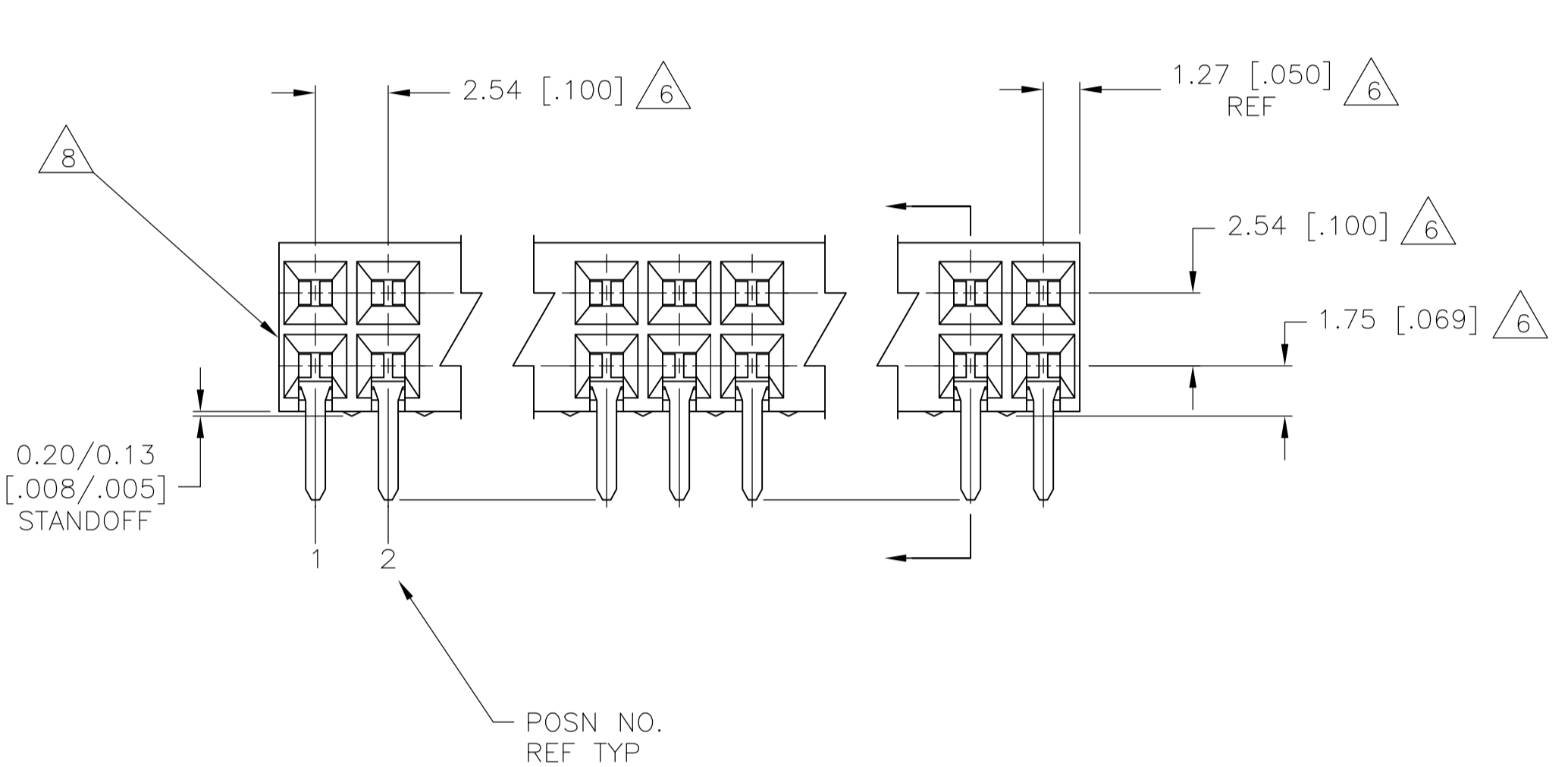
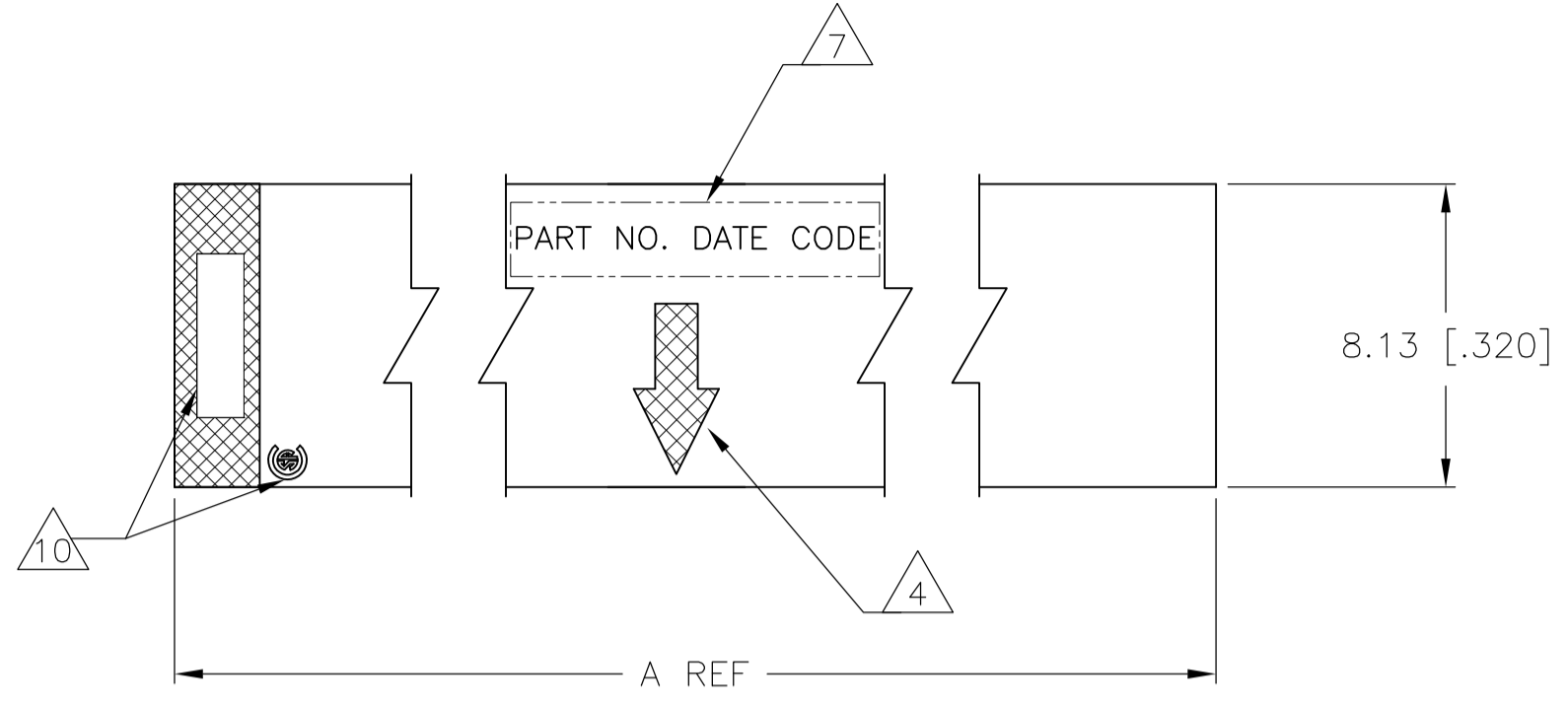

RECOMMENDED PC BOARD LAYOUT

- 1 HOUSING MATERIAL: GLASS FILLED POLYESTER, COLOR- BLACK
- 2 CONTACT MATERIAL: PHOSPHOR BRONZE
- 3 CONTACT FINISH: 0.00025[.000010] THK DUPLEX PLATED GOLD ON CONTACT AREA, 0.00127[.000050] MIN THK BRIGHT TIN-LEAD ON SOLDERLEADS, ALL OVER 0.00127[.000050] NICKEL
- 4 MOLDED IN ARROW DESIGNATES THE MATING FACE OF THE CONNECTOR
- 5 POINT OF MEASUREMENT FOR PLATING THICKNESS OF CONTACT AREA
- 6 DIMENSIONS PERTAIN TO HOUSING CAVITY CENTERLINES
- 7 MARK PART NUMBER AND DATE CODE IN APPROXIMATE LOCATION SHOWN, EITHER END.
- 8 ALTERNATE LOCATION FOR DATE CODE FOR 4 AND 6 POSITION.
- 9 NO PART NUMBER MARKING REQUIRED FOR THIS PART.
- 10 TE LOGO AND CSA LOGO ARE MOLDED INTO HOUSING, THIS LOCATION.

162.56[6.400]	165.10[6.500]	130	6-146140-4
160.02[6.300]	162.56[6.400]	128	6-146140-3
157.48[6.200]	160.02[6.300]	126	6-146140-2
154.94[6.100]	157.48[6.200]	124	6-146140-1
152.40[6.000]	154.94[6.100]	122	6-146140-0
149.86[5.900]	152.40[6.000]	120	5-146140-9
147.32[5.800]	149.86[5.900]	118	5-146140-8
144.78[5.700]	147.32[5.800]	116	5-146140-7
142.24[5.600]	144.78[5.700]	114	5-146140-6
139.70[5.500]	142.24[5.600]	112	5-146140-5
137.16[5.400]	139.70[5.500]	110	5-146140-4
134.62[5.300]	137.16[5.400]	108	5-146140-3
132.08[5.200]	134.62[5.300]	106	5-146140-2
129.54[5.100]	132.08[5.200]	104	5-146140-1
127.00[5.000]	129.54[5.100]	102	5-146140-0
124.46[4.900]	127.00[5.000]	100	4-146140-9
121.92[4.800]	124.46[4.900]	98	4-146140-8
119.38[4.700]	121.92[4.800]	96	4-146140-7
116.84[4.600]	119.38[4.700]	94	4-146140-6
114.30[4.500]	116.84[4.600]	92	4-146140-5
111.76[4.400]	114.30[4.500]	90	4-146140-4
109.22[4.300]	111.76[4.400]	88	4-146140-3
106.68[4.200]	109.22[4.300]	86	4-146140-2
104.14[4.100]	106.68[4.200]	84	4-146140-1
101.16[4.000]	104.14[4.100]	82	4-146140-0
99.06[3.900]	101.16[4.000]	80	3-146140-9
96.52[3.800]	99.06[3.900]	78	3-146140-8
93.98[3.700]	96.52[3.800]	76	3-146140-7
91.44[3.600]	93.98[3.700]	74	3-146140-6
88.90[3.500]	91.44[3.600]	72	3-146140-5
86.36[3.400]	88.90[3.500]	70	3-146140-4
83.82[3.300]	86.36[3.400]	68	3-146140-3
81.28[3.200]	83.82[3.300]	66	3-146140-2
78.74[3.100]	81.28[3.200]	64	3-146140-1
76.20[3.000]	78.74[3.100]	62	3-146140-0
73.66[2.900]	76.20[3.000]	60	2-146140-9
71.12[2.800]	73.66[2.900]	58	2-146140-8
68.58[2.700]	71.12[2.800]	56	2-146140-7
66.04[2.600]	68.58[2.700]	54	2-146140-6
63.50[2.500]	66.04[2.600]	52	2-146140-5
60.96[2.400]	63.50[2.500]	50	2-146140-4
58.42[2.300]	60.96[2.400]	48	2-146140-3
55.88[2.200]	58.42[2.300]	46	2-146140-2
53.34[2.100]	55.88[2.200]	44	2-146140-1
50.8[2.000]	53.34[2.100]	42	2-146140-0
48.26[1.900]	50.8[2.000]	40	1-146140-9
45.72[1.800]	48.26[1.900]	38	1-146140-8
43.18[1.700]	45.72[1.800]	36	1-146140-7
40.64[1.600]	43.18[1.700]	34	1-146140-6
38.10[1.500]	40.64[1.600]	32	1-146140-5
35.56[1.400]	38.10[1.500]	30	1-146140-4
33.02[1.300]	35.56[1.400]	28	1-146140-3
30.48[1.200]	33.02[1.300]	26	1-146140-2
27.94[1.100]	30.48[1.200]	24	1-146140-1
25.40[1.000]	27.94[1.100]	22	1-146140-0
22.86[.900]	25.40[1.000]	20	146140-9
20.32[.800]	22.86[.900]	18	146140-8
17.78[.700]	20.32[.800]	16	146140-7
15.24[.600]	17.78[.700]	14	146140-6
12.70[.500]	15.24[.600]	12	146140-5
10.16[.400]	12.70[.500]	10	146140-4
7.62[.300]	10.16[.400]	8	146140-3
5.08[.200]	7.62[.300]	6	146140-2
2.54[.100]	5.08[.200]	4	146140-1

SUPERSEDED BY 1-5146140-5

THIS DRAWING IS A CONTROLLED DOCUMENT.		DIN R BROWN 03JUN02		TE Connectivity AMPMODU MOD II RECEPTACLE ASSEMBLY, HORIZONTAL, .100 CL, 2 ROW, CLOSED-ENTRY, SHORT POINT OF CONTACT, END-TO-END STACKABLE	
DIMENSIONS: mm		TOLERANCES UNLESS OTHERWISE SPECIFIED:			
0 PLC ± - 1 PLC ± - 2 PLC ± - 3 PLC ± 0.1[.005] 4 PLC ± - ANGLES ± -		03JUN02 J. OLSON PRODUCT SPEC APPLICATION SPEC SIZE CAGE CODE DRAWING NO WEIGHT -- A1 00779 C=146140		RESTRICTED TO CUSTOMER DRAWING SCALE 5:1 SHEET 1 OF 1 REV N5	