



Chipsmall Limited consists of a professional team with an average of over 10 year of expertise in the distribution of electronic components. Based in Hongkong, we have already established firm and mutual-benefit business relationships with customers from,Europe,America and south Asia,supplying obsolete and hard-to-find components to meet their specific needs.

With the principle of "Quality Parts,Customers Priority,Honest Operation,and Considerate Service",our business mainly focus on the distribution of electronic components. Line cards we deal with include Microchip,ALPS,ROHM,Xilinx,Pulse,ON,Everlight and Freescale. Main products comprise IC,Modules,Potentiometer,IC Socket,Relay,Connector.Our parts cover such applications as commercial,industrial, and automotives areas.

We are looking forward to setting up business relationship with you and hope to provide you with the best service and solution. Let us make a better world for our industry!



## Contact us

Tel: +86-755-8981 8866 Fax: +86-755-8427 6832

Email & Skype: info@chipsmall.com Web: www.chipsmall.com

Address: A1208, Overseas Decoration Building, #122 Zhenhua RD., Futian, Shenzhen, China



THIS DRAWING IS UNPUBLISHED. RELEASED FOR PUBLICATION  
 © COPYRIGHT BY TYCO ELECTRONICS CORPORATION. ALL INTERNATIONAL RIGHTS RESERVED.

LOC		DIST		REVISIONS			
P	LTR	DESCRIPTION	DATE	DWN	APVD		
	C	REV PER ECO 08-024900	10-20-08	CT	KT		

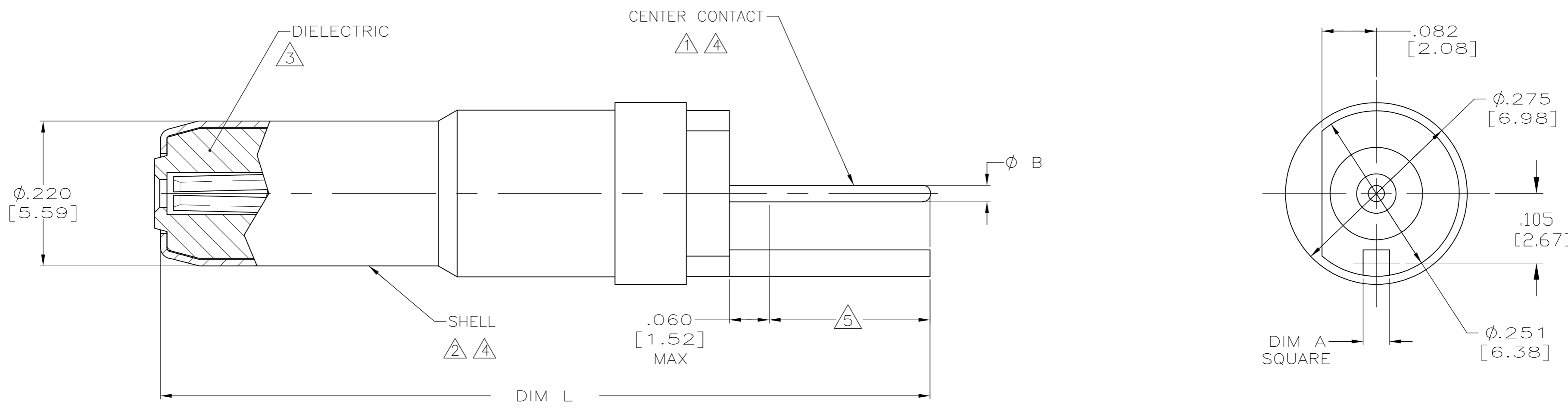

- 1 BERYLLIUM COPPER PER ASTM-B-197 OR ASTM-B-643.
- 2 BRASS PER ASTM-B-16.
- 3 PTFE PER ASTM-D-1710.
- 4 GOLD PLATE PER ASTM-B-488 (MIL-G-45204), TYPE 2, GRADE C, .000050 [0.00127] MIN THK OVER NICKEL PLATE PER QQ-N-290, .000050 [0.00127] MIN THK.
- 5 THIS AREA IS SOLDER DIPPED. (-4 ONLY)

.020±.002 [0.51±0.05]	.040±.003 [1.02±0.08]	NO	1.205 [30.61]	1484201-5
.026 [0.66] MAX	.047 [1.19] MAX	YES	1.277 [32.44]	1484201-4
.020±.002 [0.51±0.05]	.040±.003 [1.02±0.08]	NO	1.277 [32.44]	1484201-3
.020±.002 [0.51±0.05]	.040±.003 [1.02±0.08]	NO	1.249 [31.72]	1484201-2
.020±.002 [0.51±0.05]	.040±.003 [1.02±0.08]	NO	1.158 [29.41]	1484201-1
DIM B	DIM A	SOLDER DIPPED	L±.020 [±0.51]	PART NUMBER

THIS DRAWING IS A CONTROLLED DOCUMENT.		DWN C.C.THOMAS 1-10-02	Tyco Electronics Corporation Harrisburg, PA 17105-3608	
DIMENSIONS: INCHES [mm]		CHK S.GLATFELTER 1-10-02	NAME PIN CONTACT ASSY, COAX, SIZE 5 POSTED, ARINC 600	
TOLERANCES UNLESS OTHERWISE SPECIFIED: 0 PLC ± - 1 PLC ± - 2 PLC ± - 3 PLC ± .005 [0.13] 4 PLC ± - ANGLES ± -		APVD S.GLATFELTER 1-10-02	DRAWING NO A2 00779 C=1484201	
MATERIAL SEE CALLOUTS		FINISH SEE CALLOUTS	WEIGHT -	RESTRICTED TO -
CUSTOMER DRAWING		SCALE 8:1	SHEET 1 of 1	REV C