



Chipsmall Limited consists of a professional team with an average of over 10 year of expertise in the distribution of electronic components. Based in Hongkong, we have already established firm and mutual-benefit business relationships with customers from,Europe,America and south Asia,supplying obsolete and hard-to-find components to meet their specific needs.

With the principle of "Quality Parts,Customers Priority,Honest Operation,and Considerate Service",our business mainly focus on the distribution of electronic components. Line cards we deal with include Microchip,ALPS,ROHM,Xilinx,Pulse,ON,Everlight and Freescale. Main products comprise IC,Modules,Potentiometer,IC Socket,Relay,Connector.Our parts cover such applications as commercial,industrial, and automotives areas.

We are looking forward to setting up business relationship with you and hope to provide you with the best service and solution. Let us make a better world for our industry!



Contact us

Tel: +86-755-8981 8866 Fax: +86-755-8427 6832

Email & Skype: info@chipsmall.com Web: www.chipsmall.com

Address: A1208, Overseas Decoration Building, #122 Zhenhua RD., Futian, Shenzhen, China



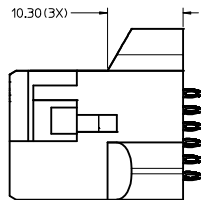
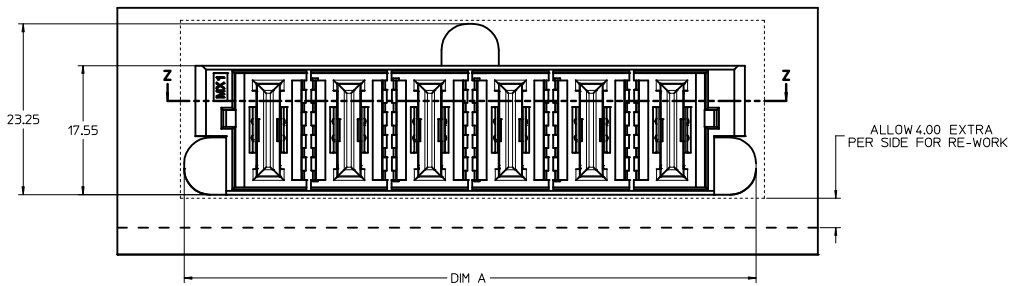

PART NO	CKT	DIM A	DIM B	DIM C	DIM D	DIM E	DIM F
151053-0002	2	33.90	30.84	28.20	14.10	7.25	34.90
151053-0003	3	44.90	41.84	39.20	19.60	12.75	45.90
151053-0004	4	55.90	52.84	50.20	25.10	18.25	56.90
151053-0005	5	66.90	63.84	61.20	30.60	23.75	67.90
151053-0006	6	77.90	74.84	72.20	36.10	29.25	78.90

- NOTES:
- MATERIAL:
HOUSING: LCP, UL94V-0, COLOR: BLACK
TERMINALS: COPPER ALLOY
 - FINISHES: TERMINALS : 304N MIN GOLD ON CONTACT
1004N MIN TIN ON TAIL
504N MIN NICKEL UNDERPLATE OVERALL.
 - PRODUCT SPECIFICATION: PS-151053-0000
 - PACKAGING SPECIFICATION: PK-151053-0001
 - MATING WITH CRIMP: 46819, CRIMP RECEPTACLE HOUSING: 151034
 - TAIL DESIGN : COMPLIANT PIN
 - PLATED THRU HOLE SIZE, REFER TO PS-151053-0000
 - RECOMMENDED SCREW: 2-32 TYPE AB X 0.300".
SCREWS ARE SOLD SEPARATELY.
 - USE FLAT ROCK APPLICATION TOOLING.
 - POWER CONTACTS ARE LUBRICATED.

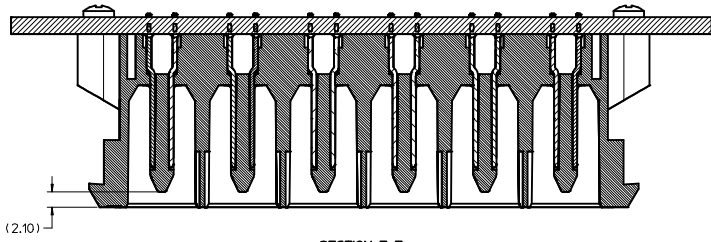
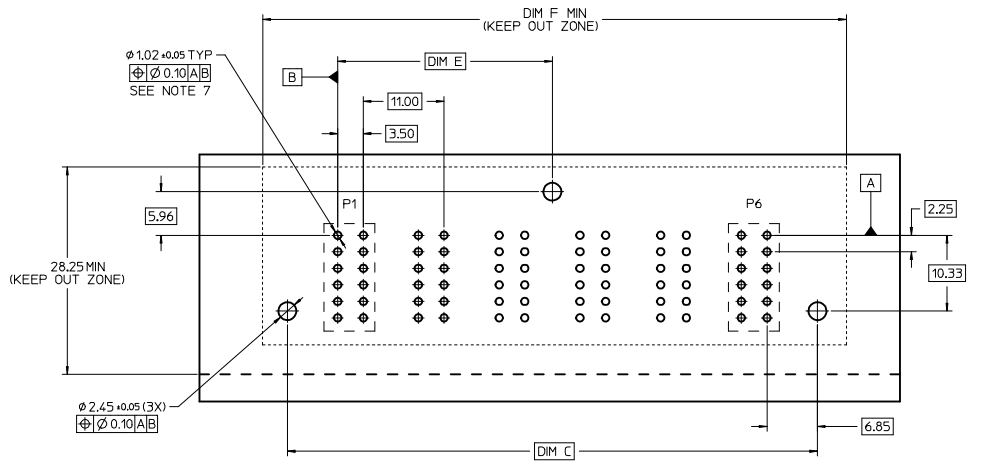
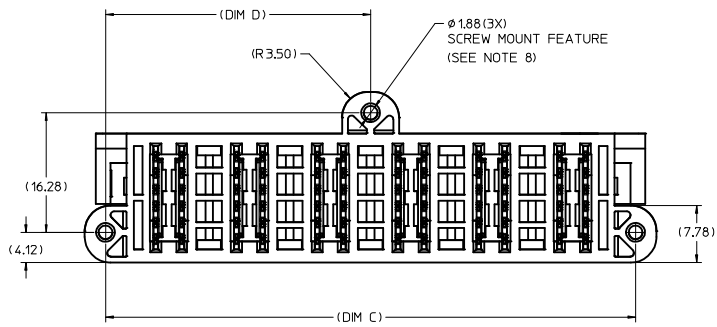
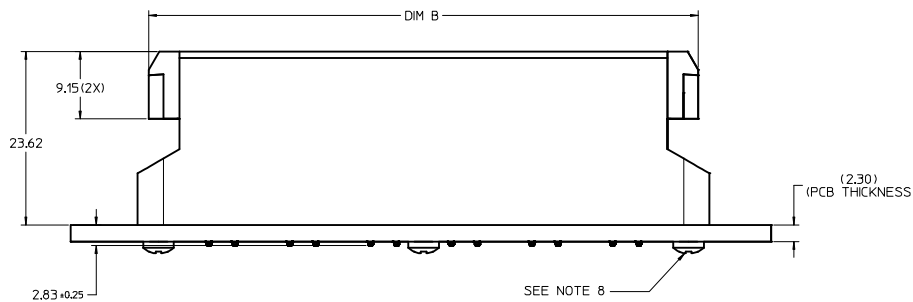

RELEASE IEC NO: S2016-0908 DRAWN BY: CGOH CHECKED BY: CHYKDEANG APPROVED BY: KHLIM DATE: 2016/04/01 DATE: 2016/04/07 DATE: 2016/04/08	QUALITY SYMBOLS	GENERAL TOLERANCES (UNLESS SPECIFIED)	DIMENSION STYLE	SCALE	DESIGN UNITS	THIRD ANGLE PROJECTION
	▽=0	4 PLACES ± mm	MM ONLY	3:1	METRIC	☉
	▽=0	3 PLACES ± ---	INCH			
	▽=0	2 PLACES ± 0.25				
		1 PLACE ± 0.25				
		0 PLACE ± ---				
		ANGULAR ± 3 °				
		DRAFT WHERE APPLICABLE MUST REMAIN WITHIN DIMENSIONS				
			MATERIAL NO.	DOCUMENT NO.		
			SEE TABLE	SD-151053-0001		
						SHEET NO. 1 OF 1

GUARDIAN
2 - 6CKT VERTICAL HEADER
POWER CONNECTOR
molex