



Chipsmall Limited consists of a professional team with an average of over 10 year of expertise in the distribution of electronic components. Based in Hongkong, we have already established firm and mutual-benefit business relationships with customers from,Europe,America and south Asia,supplying obsolete and hard-to-find components to meet their specific needs.

With the principle of “Quality Parts,Customers Priority,Honest Operation,and Considerate Service”,our business mainly focus on the distribution of electronic components. Line cards we deal with include Microchip,ALPS,ROHM,Xilinx,Pulse,ON,Everlight and Freescale. Main products comprise IC,Modules,Potentiometer,IC Socket,Relay,Connector.Our parts cover such applications as commercial,industrial, and automotives areas.

We are looking forward to setting up business relationship with you and hope to provide you with the best service and solution. Let us make a better world for our industry!



Contact us

Tel: +86-755-8981 8866 Fax: +86-755-8427 6832

Email & Skype: info@chipsmall.com Web: www.chipsmall.com

Address: A1208, Overseas Decoration Building, #122 Zhenhua RD., Futian, Shenzhen, China



Scale 8

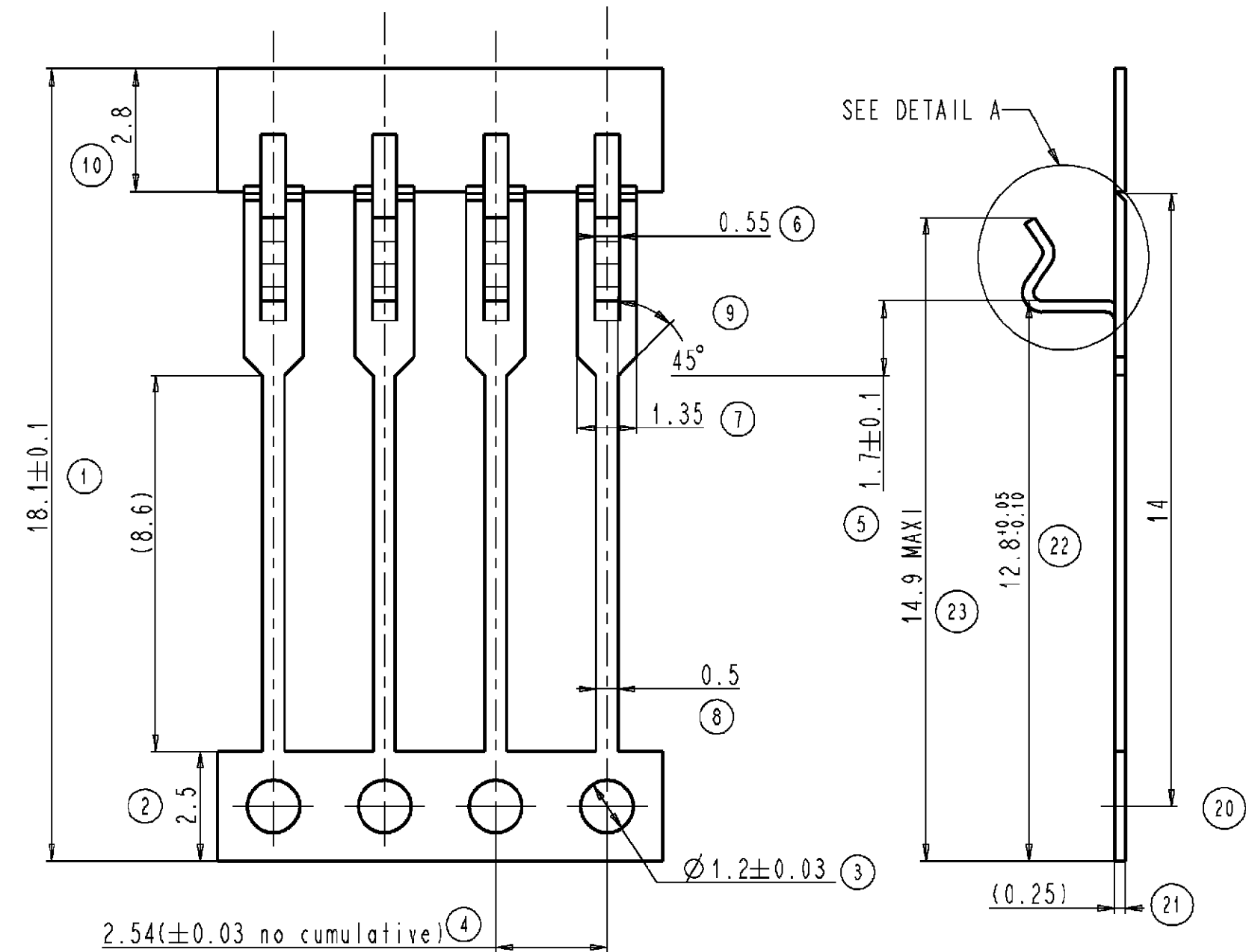

◆ BOWING: After upper tie bar removal: 1.5mm Maxi for 500mm
◆ SABRE: Après séparation du tie bar: 1.5mm Maxi sur 500mm
◆ PITCH: After upper tie bar removal: 2.54±0.127
◆ PAS: Après séparation du tie bar: 2.54±0.127

DETAIL A
Scale 50

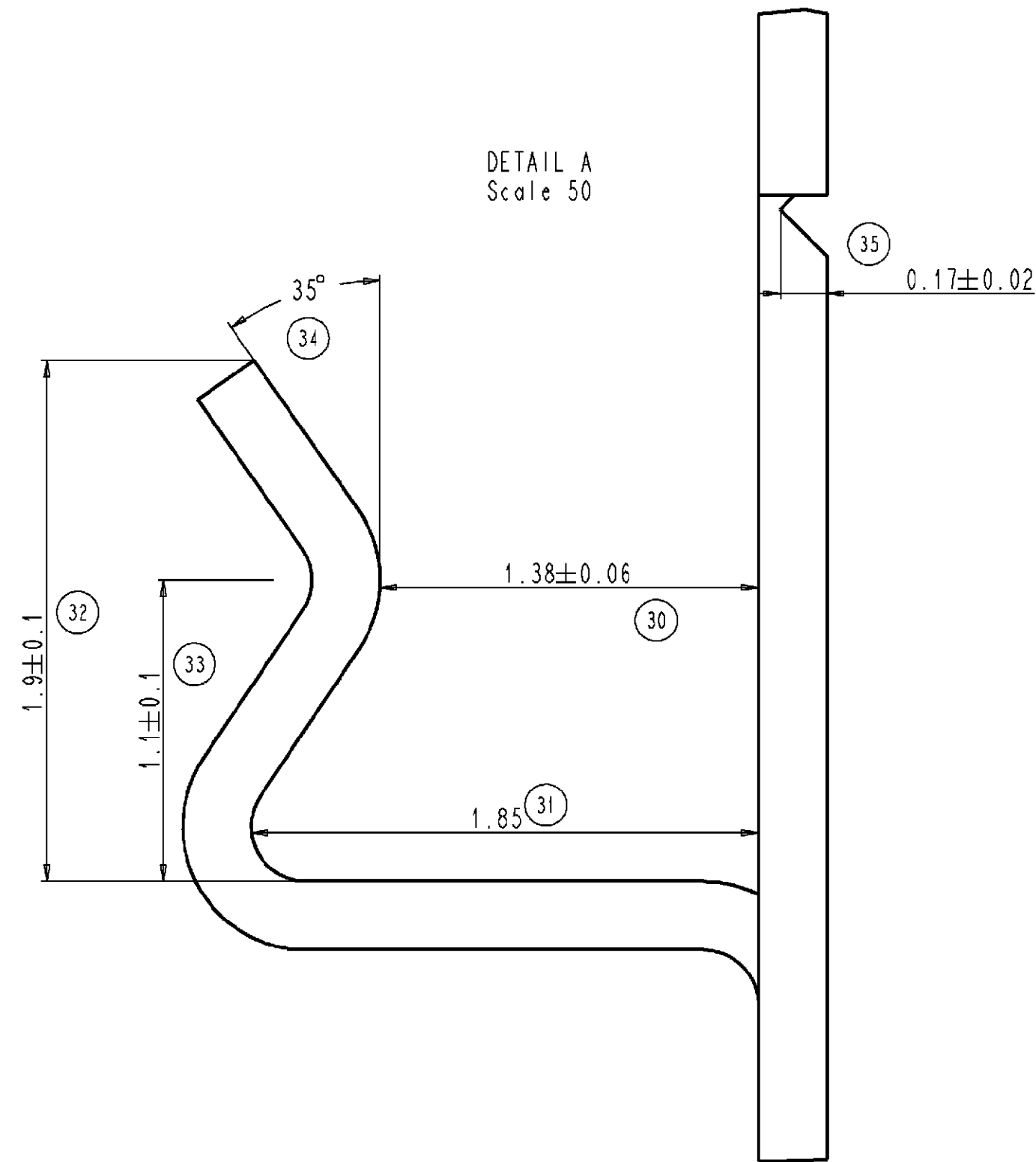

Scale 5

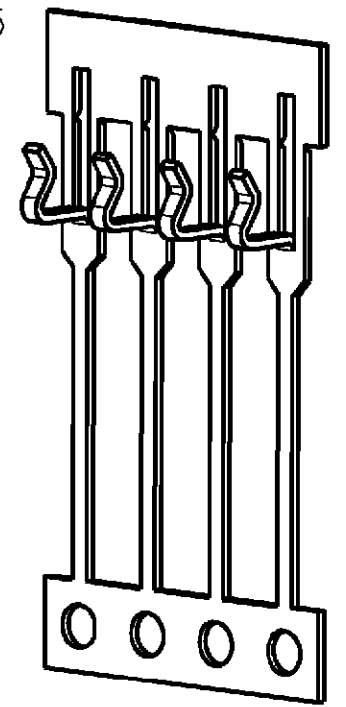

Winding direction 0
Sens d'enroulement 0

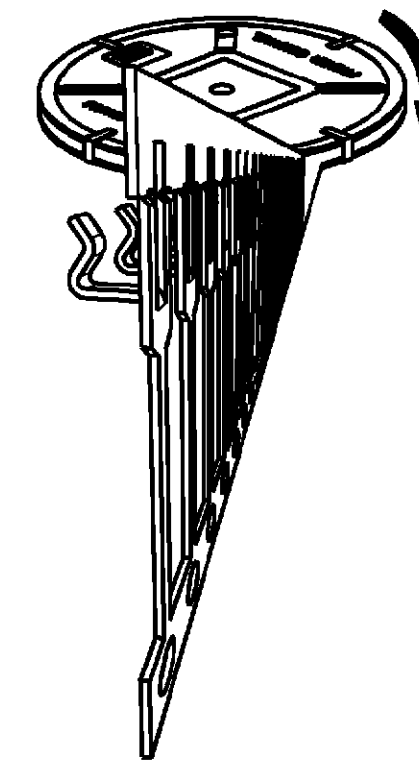

Winding direction 1
Sens d'enroulement 1

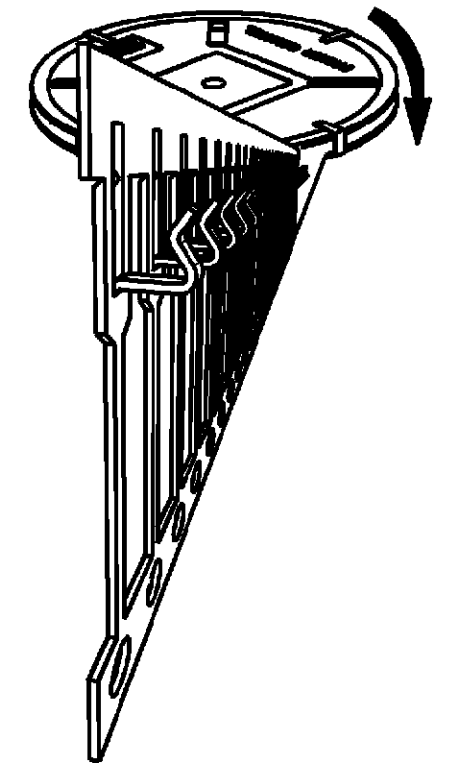

TYCO P/N	PRONER COMATEL P/N	PLATING	WINDING DIRECTION
0-1544210-1	510 2180 042 111	BEFORE STAMPING	0
0-1544207-1	510 2180 142 111	Sn: 112-18-4 3 à 7 µ	1
0-1544210-2	510 2180 044 111	AFTER STAMPING	0
		Ni: 112-25-3 1,27 à 3 µ Sn: 112-65-1 4 µ mini	0

	SM 105			
See table	Phophorous bronze	/	See table	/
Reference/Designation	Material	Traitment	Protection	Quantity
Sub-Assy. : //				POUR DIFFUSION
Assembly : //				

Lead frame SIL



PRONER COMATEL

DEPARTEMENT TECHNIQUE

38530 CHAPAREILLAN

Tél: 04 76 45 34 34 Fax: 04 76 45 28 21

Scale: 8

Mass: //

Lin. Tol.: ± 0.05

Ang. Tol.: ± 7°

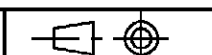

Format A2

4465 D 001

ER00-0283-04		SRd	11/6/04		B
MAJ, ajout enroulement annule et remplace 2180 B2, 2454	1482	JDt	24.08.2001	...	A1
Description of Modification	N° Avis Modif.	Drawn by	Date	Checked by	Ind.

Reproduction and diffusion forbidden without Proner Comatel agreement