



Chipsmall Limited consists of a professional team with an average of over 10 year of expertise in the distribution of electronic components. Based in Hongkong, we have already established firm and mutual-benefit business relationships with customers from,Europe,America and south Asia,supplying obsolete and hard-to-find components to meet their specific needs.

With the principle of “Quality Parts,Customers Priority,Honest Operation,and Considerate Service”,our business mainly focus on the distribution of electronic components. Line cards we deal with include Microchip,ALPS,ROHM,Xilinx,Pulse,ON,Everlight and Freescale. Main products comprise IC,Modules,Potentiometer,IC Socket,Relay,Connector.Our parts cover such applications as commercial,industrial, and automotives areas.

We are looking forward to setting up business relationship with you and hope to provide you with the best service and solution. Let us make a better world for our industry!



## Contact us

Tel: +86-755-8981 8866 Fax: +86-755-8427 6832

Email & Skype: info@chipsmall.com Web: www.chipsmall.com

Address: A1208, Overseas Decoration Building, #122 Zhenhua RD., Futian, Shenzhen, China



## Fuse Strips for Diesel Vehicles Rated 36V

RoHS



Non-housed fuse strips for Diesel vehicles.  
Current rating 25A - 150A, 36 VDC. 90° fork type lugs.

Sicherungsstreifen ohne Gehäuse für Dieselfahrzeuge.  
Nennstrom 25A bis 150A, 36 VDC. 90°-Anschluss in Gabelform.

### Dimensions in mm / Maße in mm

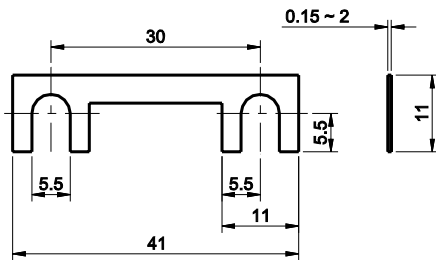

Part Number Artikel-Nr.	Current Rating Nennstrom	Typ. Voltage Drop Typ. Spannungsfall
156.5610.525_	25 A*	70 mV
156.5610.530_	30 A	70 mV
156.5610.540_	40 A*	70 mV
156.5610.550_	50 A	70 mV
156.5610.560_	60 A*	70 mV
156.5610.570_	70 A*	70 mV
156.5610.580_	80 A	70 mV
156.5610.610_	100 A	70 mV
156.5610.611_	120 A*	70 mV
156.5610.612_	125 A*	70 mV
156.5610.615_	150 A*	70 mV

\*Not mentioned in the standards  
Corresponding holder see Section "Fuse Holders."

### Specifications

DIN 72581/2

**Metal parts:** Zinc-alloy  
**Packaging:**

Series Serien	Pack Size Stückzahl
156.5610.xxx1	100
156.5610.xxx2	2000

### Pre-arcing Time - limits / Schmelzeit-Grenzwerte DIN

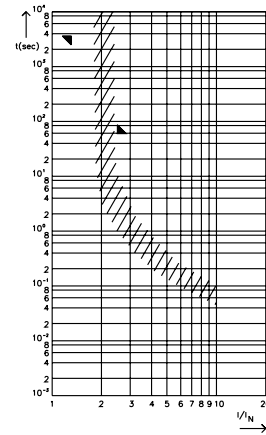

FI = 1.00 (max. operating current:  $1.0 \times I_{rat}$  at 23°C)

### Time-Current Characteristics / Schmelzeit-Grenzwerte

% of Rating % des Nennstromes	Opening Time Min / Max (s) Schmelzcharakteristik Min / Max (s)
130	3,600 s / -
250	- / 60 s