



Chipsmall Limited consists of a professional team with an average of over 10 year of expertise in the distribution of electronic components. Based in Hongkong, we have already established firm and mutual-benefit business relationships with customers from,Europe,America and south Asia,supplying obsolete and hard-to-find components to meet their specific needs.

With the principle of "Quality Parts,Customers Priority,Honest Operation,and Considerate Service",our business mainly focus on the distribution of electronic components. Line cards we deal with include Microchip,ALPS,ROHM,Xilinx,Pulse,ON,Everlight and Freescale. Main products comprise IC,Modules,Potentiometer,IC Socket,Relay,Connector.Our parts cover such applications as commercial,industrial, and automotives areas.

We are looking forward to setting up business relationship with you and hope to provide you with the best service and solution. Let us make a better world for our industry!



## Contact us

Tel: +86-755-8981 8866 Fax: +86-755-8427 6832

Email & Skype: [info@chipsmall.com](mailto:info@chipsmall.com) Web: [www.chipsmall.com](http://www.chipsmall.com)

Address: A1208, Overseas Decoration Building, #122 Zhenhua RD., Futian, Shenzhen, China



LOC	DIST	REVISIONS				
		P	LTR	DESCRIPTION	DATE	DWN APVD
AD	00		C1	REVISED PER ECO-11-005027	11MAR11	RK HMR

D

C

B

A

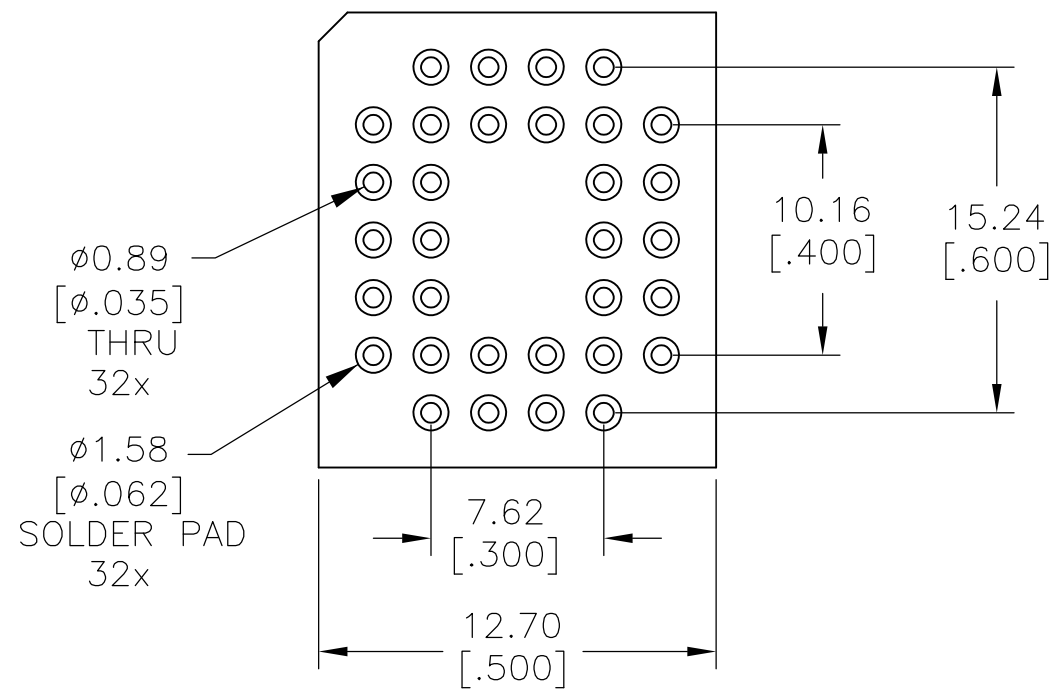

RECOMMENDED HOLE LAYOUT  
TOLERANCE:  $\pm 0.05$  [0.002]  
UNLESS OTHERWISE NOTED

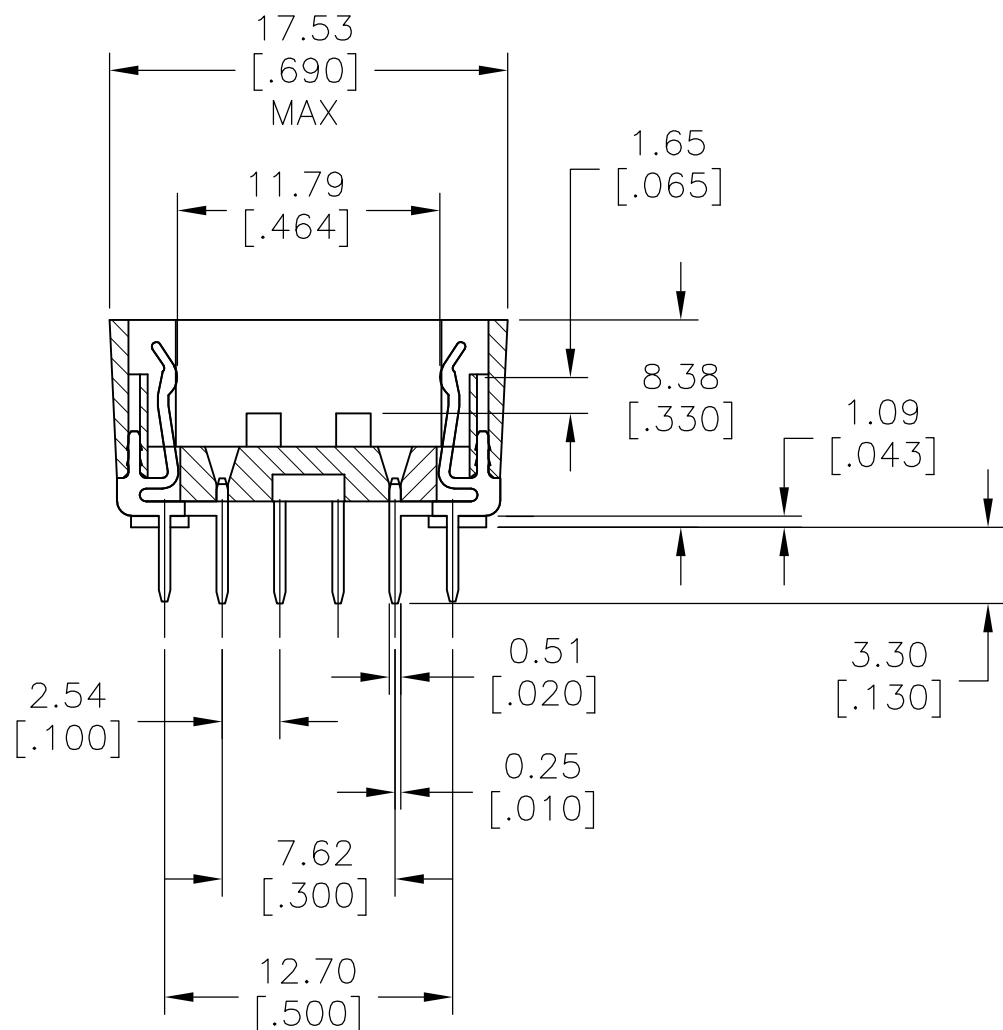
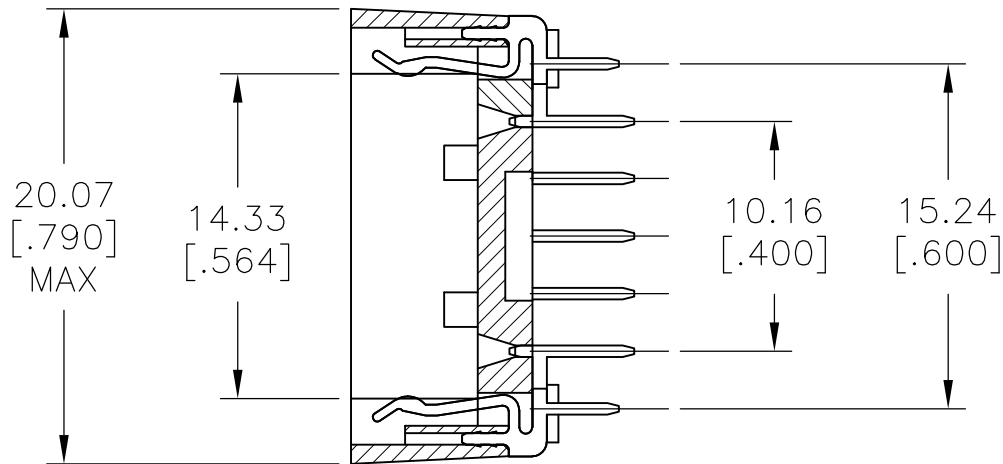
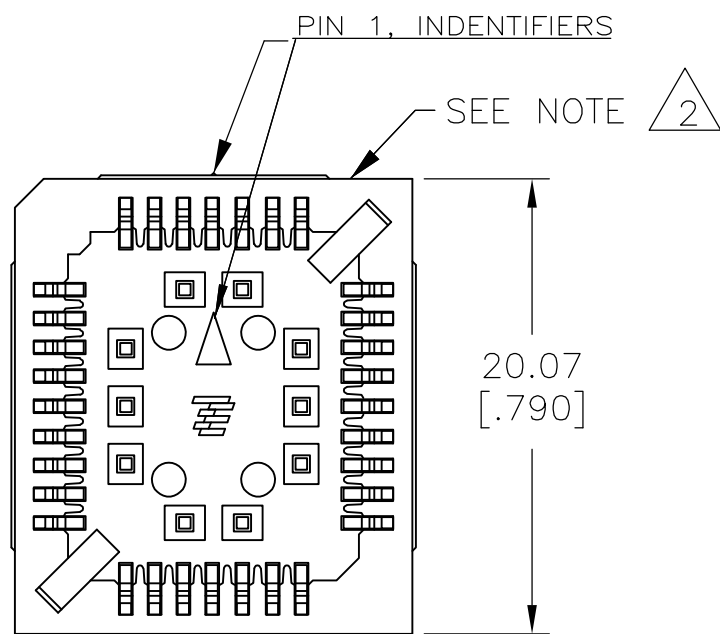

### NOTES:

- 1 MATERIALS:  
CONTACT: COPPER ALLOY, 0.004572[.000180] MIN TIN PLATE  
OVER 0.00127[.000050] MIN NICKEL.  
INSULATOR: PPS, 40% GLASS FILLED, UL 94V-0

- 2 DATE CODE (PER BELOW) TO BE LASER CODED  
AND CENTERED ON THIS SURFACE.

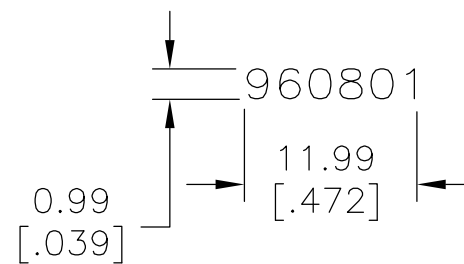

3. UL RECOGNITION E320916.

D

C

B

A

1571540

THIS DRAWING IS A CONTROLLED DOCUMENT.		DWN D. MURREN 26AUG03	TE Connectivity			
DIMENSIONS: mm [INCHES]		CHK K. WRIGHT 26AUG03				
		APVD K. WRIGHT 26AUG03	NAME OUTLINE DRAWING PLCC SOCKET			
		PRODUCT SPEC 108-38000 APPLICATION SPEC				
MATERIAL 1		TOLERANCES UNLESS OTHERWISE SPECIFIED: 0 PLC $\pm$ - 1 PLC $\pm$ - 2 PLC $\pm$ 0.25 [0.010] 3 PLC $\pm$ - 4 PLC $\pm$ - ANGLES $\pm$ 1° FINISH 1	SIZE A2	CAGE CODE 00779	DRAWING NO C=1571540	RESTRICTED TO -
CUSTOMER DRAWING				SCALE 1:1	SHEET 1 OF 1	REV C1