



Chipsmall Limited consists of a professional team with an average of over 10 year of expertise in the distribution of electronic components. Based in Hongkong, we have already established firm and mutual-benefit business relationships with customers from,Europe,America and south Asia,supplying obsolete and hard-to-find components to meet their specific needs.

With the principle of "Quality Parts,Customers Priority,Honest Operation,and Considerate Service",our business mainly focus on the distribution of electronic components. Line cards we deal with include Microchip,ALPS,ROHM,Xilinx,Pulse,ON,Everlight and Freescale. Main products comprise IC,Modules,Potentiometer,IC Socket,Relay,Connector.Our parts cover such applications as commercial,industrial, and automotives areas.

We are looking forward to setting up business relationship with you and hope to provide you with the best service and solution. Let us make a better world for our industry!



Contact us

Tel: +86-755-8981 8866 Fax: +86-755-8427 6832

Email & Skype: info@chipsmall.com Web: www.chipsmall.com

Address: A1208, Overseas Decoration Building, #122 Zhenhua RD., Futian, Shenzhen, China



Housing - VC-AL-T3-Z-M32-S - 1583694

Please be informed that the data shown in this PDF Document is generated from our Online Catalog. Please find the complete data in the user's documentation. Our General Terms of Use for Downloads are valid (<http://download.phoenixcontact.com>)



Aluminum die-cast sleeve housing, with grommet, locking screws with cylinder head, for a metric M32 cable gland, angled cable outlet, type VC3

The figure shows the product version with knurled screw

Product Features

- ✓ Housing with two cable entries is available
- ✓ Angled cable outlet so the cable can be routed as desired, from the side and straight
- ✓ Aluminum housing with extended cabling space for high-position and power contact inserts



Key commercial data

Packing unit	1 PCE
Weight per Piece (excluding packing)	262.6 GRM
Custom tariff number	85389099
Country of origin	Poland

Technical data

Dimensions

Height	85 mm
Width	38 mm
Length	94 mm

Ambient conditions

Ambient temperature (operation)	-40 °C ... 125 °C
---------------------------------	-------------------

General

Note	When using fiber optics, the bending radii of the cable manufacturers must be observed.
Design	VC3
Color	gray aluminum

Housing - VC-AL-T3-Z-M32-S - 1583694

Technical data

General

Locking type	Screw locking, cylinder head
Tightening torque, mounting screw	1.5 Nm \pm 0.3 Nm
Fixing screws	M4
No. of cable exits	1
Cable exit	Angled
Screw connection	None
Type of the screw connection	M32 x 1.5
Housing material	Aluminum die-cast
Seal material	NBR, conductive
Material of locking screw	V2A
Inflammability class according to UL 94	V0

Classifications

eCl@ss

eCl@ss 4.0	272607xx
eCl@ss 4.1	27260701
eCl@ss 5.0	27143424
eCl@ss 5.1	27143424
eCl@ss 6.0	27371205
eCl@ss 7.0	27371205
eCl@ss 8.0	27371205

ETIM

ETIM 3.0	EC000437
ETIM 4.0	EC000437
ETIM 5.0	EC000437

UNSPSC

UNSPSC 6.01	31261502
UNSPSC 7.0901	31261502
UNSPSC 11	31261502
UNSPSC 12.01	31261502
UNSPSC 13.2	31261502

Approvals

Approvals

Housing - VC-AL-T3-Z-M32-S - 1583694

Approvals

Approvals

GOST

Ex Approvals

Approvals submitted

Approval details

GOST 

Accessories

Accessories

Device marking

Engraving material - GPE 22X22 SR/R - 0806628



Engraving material, Sheet, silver, Unlabeled, Can be labeled with: Engraving, Plotter, Mounting type: Adhesive, Lettering field: 22 x 22 mm

Full screw connection

Cable gland - HC-M-KV-M32(14-21) - 1690587



Metal screw connection up to 5 bar, thread length: 8 mm, cable diameter: 14 - 21 mm, WAF 34, screw connection: M32

Housing - VC-AL-T3-Z-M32-S - 1583694

Accessories

Cable gland - HC-M-KV-M32(19-27) - 1646010



Metal screw connection up to 5 bar, thread length: 8 mm, cable diameter: 19 - 27 mm, WAF 43, screw connection: M32

Cable gland - HC-EMV-KV-M32(11-21) - 1690529



EMC screw connection up to 5 bar, thread length: 9 mm, cable diameter: 11.0 - 21.0 mm, WAF 36, screw connection: M32

Drawings

Dimensioned drawing

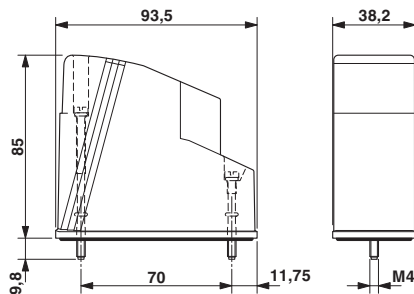

Dimensioned drawing

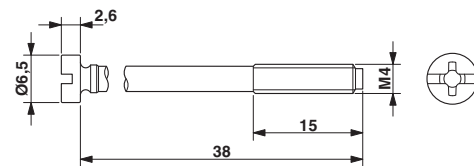

Dimensioned drawing

