



Chipsmall Limited consists of a professional team with an average of over 10 year of expertise in the distribution of electronic components. Based in Hongkong, we have already established firm and mutual-benefit business relationships with customers from,Europe,America and south Asia,supplying obsolete and hard-to-find components to meet their specific needs.

With the principle of “Quality Parts,Customers Priority,Honest Operation,and Considerate Service”,our business mainly focus on the distribution of electronic components. Line cards we deal with include Microchip,ALPS,ROHM,Xilinx,Pulse,ON,Everlight and Freescale. Main products comprise IC,Modules,Potentiometer,IC Socket,Relay,Connector.Our parts cover such applications as commercial,industrial, and automotives areas.

We are looking forward to setting up business relationship with you and hope to provide you with the best service and solution. Let us make a better world for our industry!



Contact us

Tel: +86-755-8981 8866 Fax: +86-755-8427 6832

Email & Skype: info@chipsmall.com Web: www.chipsmall.com

Address: A1208, Overseas Decoration Building, #122 Zhenhua RD., Futian, Shenzhen, China



| LOC | DIST | REVISIONS | | | | | |
|-----|------|-----------|-----|---------------------------|---------|-----|------|
| | | P | LTR | DESCRIPTION | DATE | DWN | APVD |
| CM | 00 | | B1 | REVISED PER ECO-08-027061 | 05NOV08 | HMR | CC |

1. WIRE RANGE: 1.31mm² (16 AWG)
2. INSULATION RANGE: 3.10 [.122] DIA.
- 3

FINISH: 0.76μm [.000030 in] GOLD IN LOCALIZED GOLD PLATE AREA OVER 1.27μm [.00005 in] MINIMUM NICKEL.
- 4

FINISH: 2.54μm [.00001 in] MINIMUM TIN IN LOCALIZED TIN PLATE AREA.

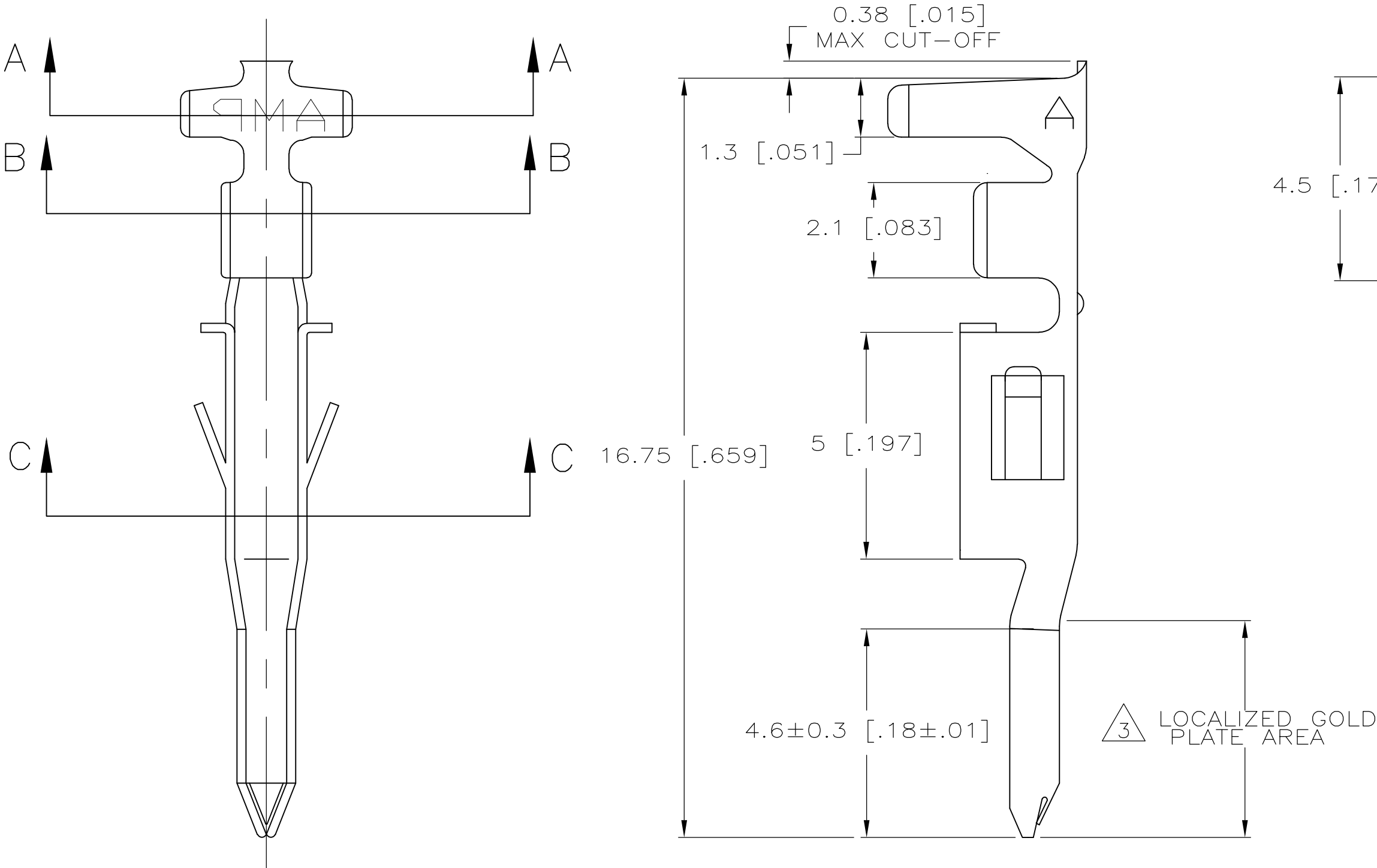

| | | |
|---------------|------------|-----------|
| <div>34</div> | PHOS. BRZ. | 1586840-4 |
| PRE-TIN | PHOS. BRZ. | 1586840-3 |
| <div>34</div> | BRASS | 1586840-2 |
| PRE-TIN | BRASS | 1586840-1 |
| FINISH | MATERIAL | PART NO. |

METRIC

| | | | | | | |
|--|---|---------------------------------|---|--------------------|-------------------------|-----------------|
| THIS DRAWING IS A CONTROLLED DOCUMENT. | | DWN K. WHITAKER 04APR2007 | <div><div>Tyco Electronics</div><div>Tyco Electronics Corporation Harrisburg, PA 17105-3608</div></div> | | | |
| DIMENSIONS: mm [INCHES] | TOLERANCES UNLESS OTHERWISE SPECIFIED: | CHK C.CASH 04APR2007 | | | | |
| | 0 PLC ± 1 PLC ± 2 PLC ± 0.13 [.005] 3 PLC ± 4 PLC ± | APVD C. CASH 04APR2007 | NAME TERMINAL, PIN (LOOSE PIECE) VAL-U-LOK(TM) | | | |
| | ANGLES ± 0°30' | PRODUCT SPEC | | | | |
| MATERIAL | FINISH | APPLICATION SPEC | SIZE A2 | CAGE CODE 00779 | DRAWING NO C=1586840 | RESTRICTED TO |
| | | WEIGHT | | | SCALE 10:1 | SHEET 1 OF 1 |
| | | CUSTOMER DRAWING | | | REV B1 | |