



Chipsmall Limited consists of a professional team with an average of over 10 year of expertise in the distribution of electronic components. Based in Hongkong, we have already established firm and mutual-benefit business relationships with customers from,Europe,America and south Asia,supplying obsolete and hard-to-find components to meet their specific needs.

With the principle of “Quality Parts,Customers Priority,Honest Operation,and Considerate Service”,our business mainly focus on the distribution of electronic components. Line cards we deal with include Microchip,ALPS,ROHM,Xilinx,Pulse,ON,Everlight and Freescale. Main products comprise IC,Modules,Potentiometer,IC Socket,Relay,Connector.Our parts cover such applications as commercial,industrial, and automotives areas.

We are looking forward to setting up business relationship with you and hope to provide you with the best service and solution. Let us make a better world for our industry!



Contact us

Tel: +86-755-8981 8866 Fax: +86-755-8427 6832

Email & Skype: info@chipsmall.com Web: www.chipsmall.com

Address: A1208, Overseas Decoration Building, #122 Zhenhua RD., Futian, Shenzhen, China



ProtoBox-1593L Kit (PCB+Box)



A Hammond 1593L handheld plastic enclosure packaged with a matching BPS ProtoBoard 2-hole per strip PCB.

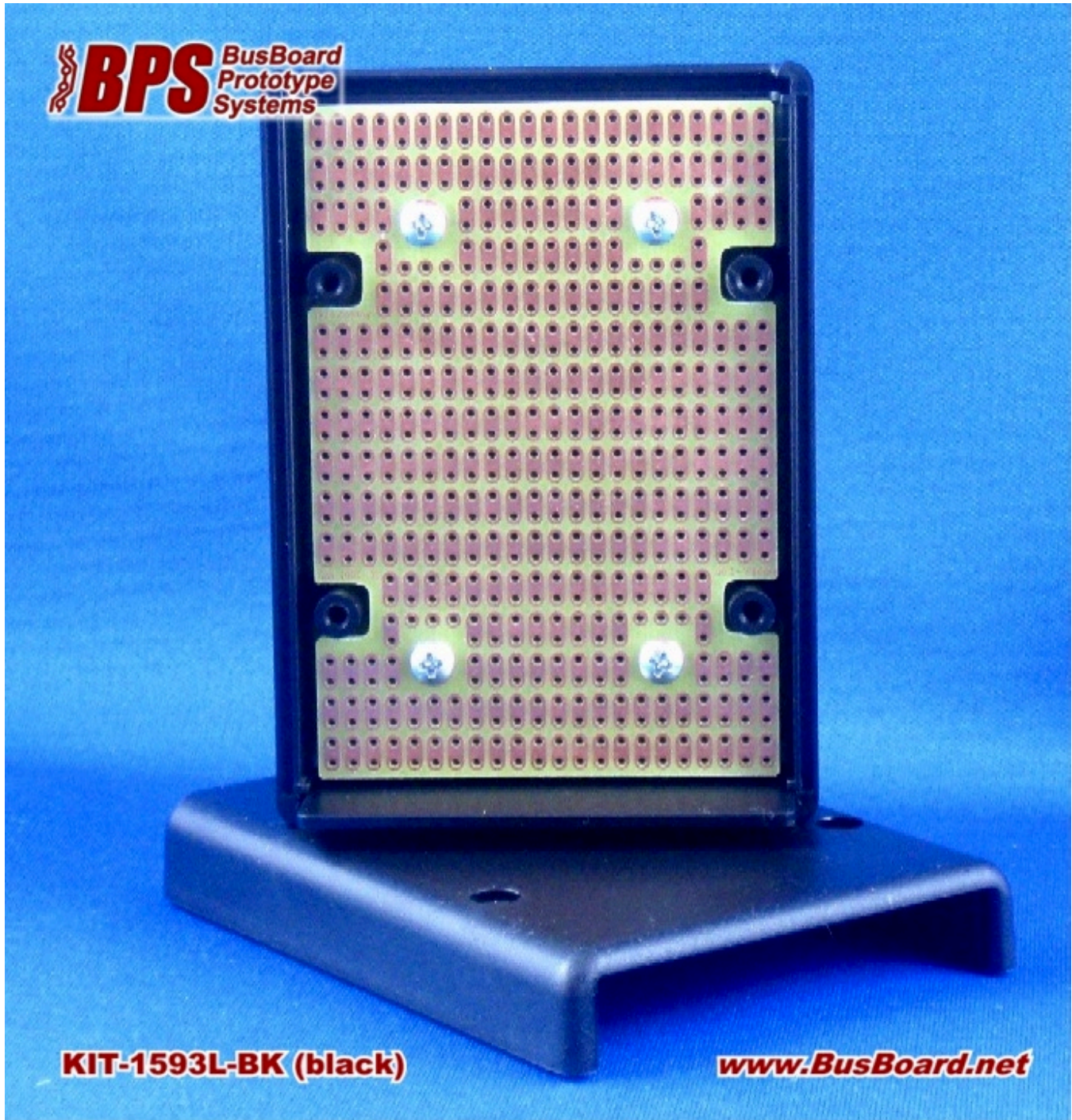

BusBoard Prototype Systems - Built for designers

www.BusBoard.com sales@busboard.com

BPS-MAR-(KIT-1593L)-001 Rev 4.00

A prototyping board designed for the Hammond 1593L handheld enclosure.

Features

ProtoBoard saves time! The PCB is designed specifically for the Hammond 1593L box. No cutting is required. The mounting holes are present in the right spots.

The convenient 2-hole ProtoBoard pattern provides an easy way to connect parts while maximizing usable board area.

Lead free etched copper PCB with an anti-tarnish coating for easy soldering.

PCB Specifications

- High-quality FR4 glass epoxy board.
- Four 0.125" (1/8") mounting holes.
- Four 4-40 PCB mounting screws provided.
- Single sided, 1oz/ft² copper PCB
- 0.042" holes drilled on 0.1" centers
- PCB Size 3.3 x 2.3 in. (83 x 58mm)

Order Part# PR1593L (for PCB only)

Board Layout (actual size)

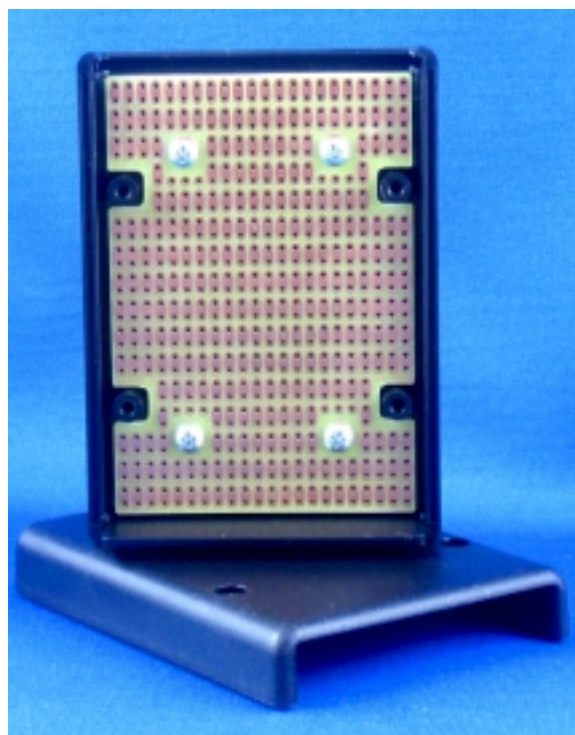
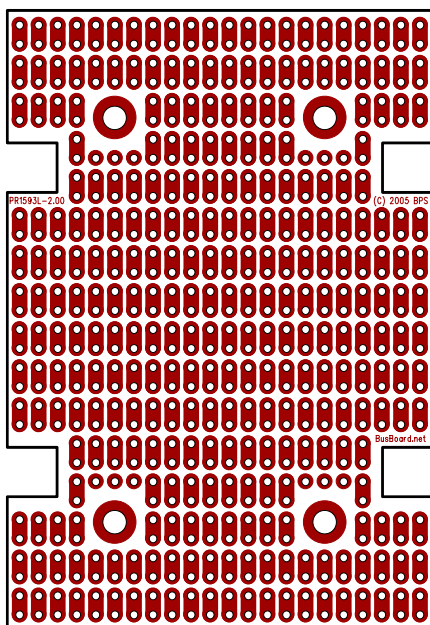

PR1593L Prototyping Board shown with the Hammond 1593LBK box (box not included).

**To purchase the PCB + Box together,
order BPS part# KIT-1593L-BK**

PCB Mechanical Dimensions

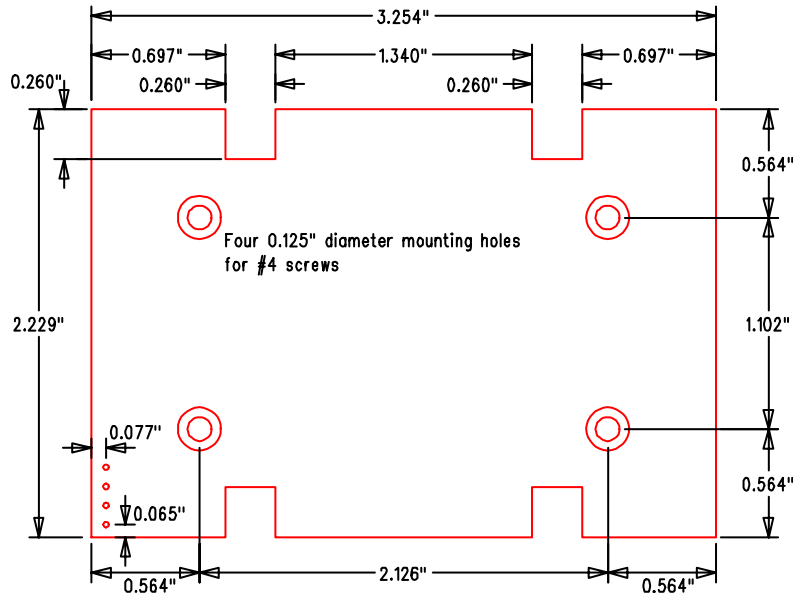

1. PCB is symmetrical in the X and Y directions.
 2. All solder pads are located on a 0.100" grid.
 3. The mounting holes are NOT located on the 0.100" grid.
- PCB Design Copyright 2005 BusBoard Prototype Systems Ltd.

Hammond 1593L Hand Held Case Features

Note: The box is **NOT** included with BPS part# PR1593L.

The box is included with part# KIT-1593L-BK.

Hand-held electronic instrument enclosure.

Built-in PCB standoffs.

2 removable end panels. 2 different styles included, flat and rounded.

Recessed top for membrane overlay or keypad.

Lap joint construction provides protection against dust accumulation and splashing water.

Black, gray, or blue general purpose ABS plastic.

Secured with self tapping screws (included).

Box Size 2.6 x 2.6 x 1.1 in. (66 x 66 x 28 mm)

To order the box by itself order Hammond part# 1593LBK (black), 1593LGY (gray) or 1593LTBU (translucent blue)

See <http://www.hammondmfg.com/dwg8.htm>
<http://www.hammondmfg.com/dwg8TBU.htm>

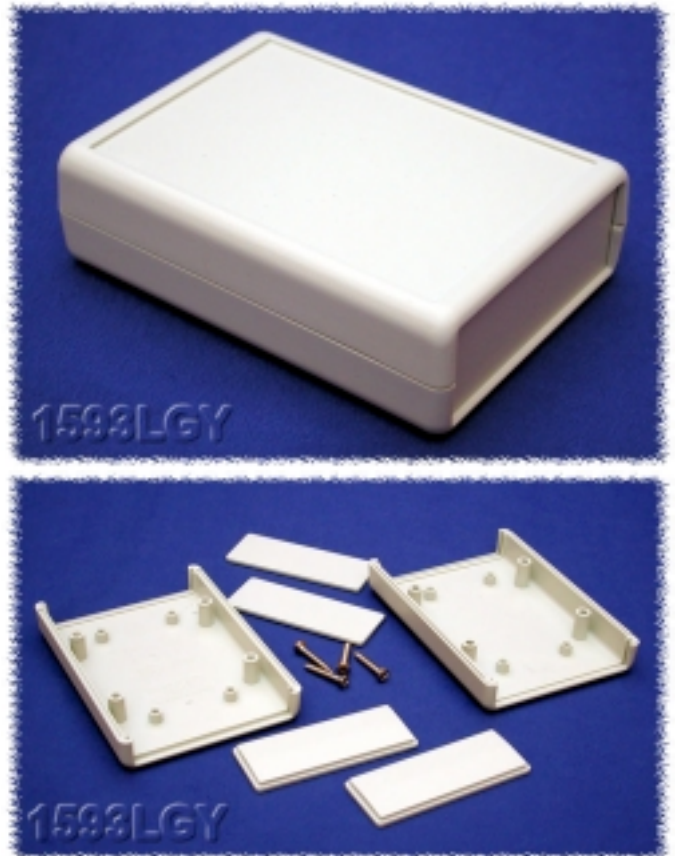

© 2013 BusBoard Prototype Systems Ltd.

BusBoard Prototype Systems - Built for designers

www.BusBoard.com sales@busboard.com

BPS-MAR-PR1593L-001 Rev 4.00

Top View of Assembly

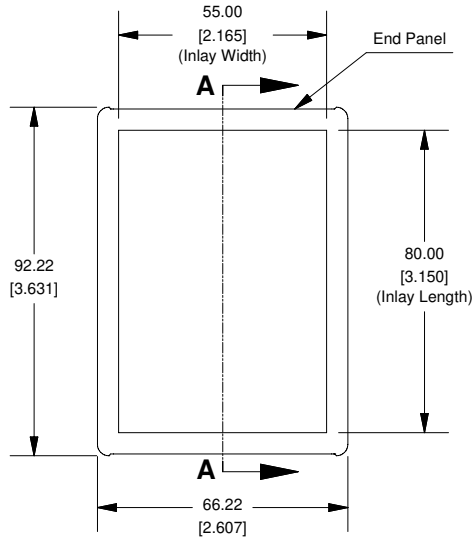

SECTION A-A (Side View Inside Assembly)

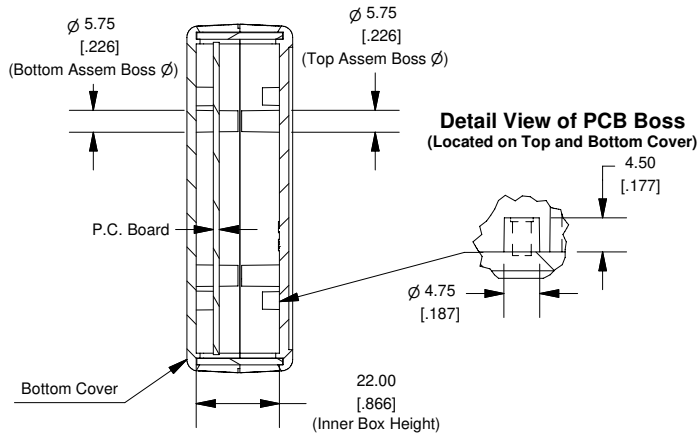

Detail View of PCB Boss (Located on Top and Bottom Cover)

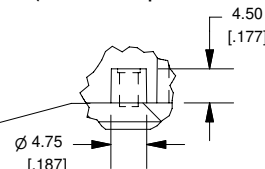

End View of Assembly

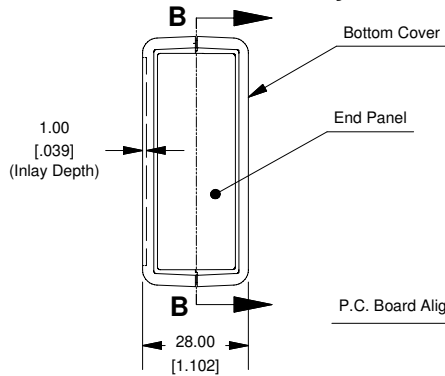

SECTION B-B (Inside of Bottom Cover)

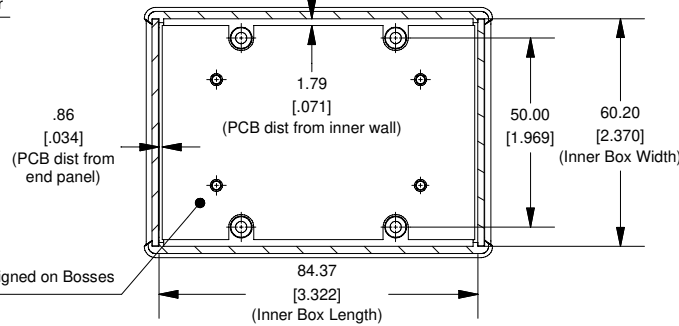

Maximum P.C. Board Size

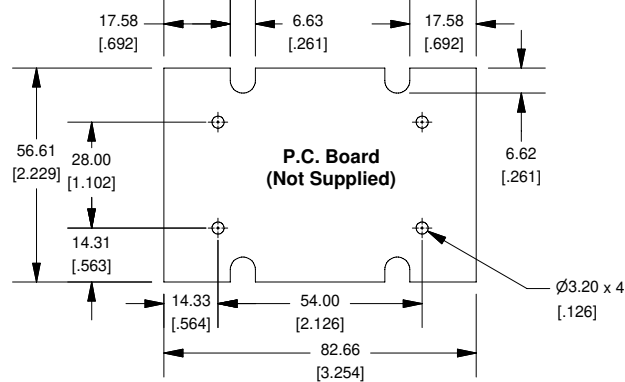

Front/Rear Panel (Dashed Line Indicates Viewing Area)

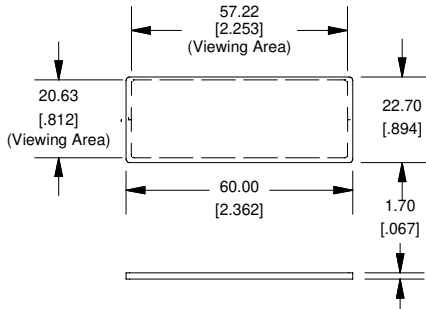

Hand Held Instrument (1593L)

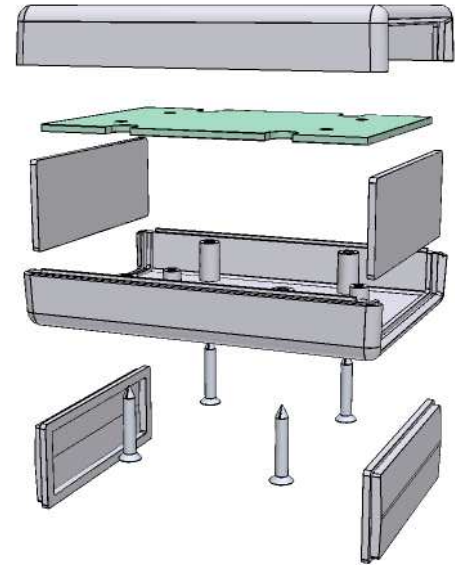

Enclosures can be Factory Modified (Milling, Drilling, Printing etc.)
 Solid models of this enclosure available in STEP or IGES.
 Contact Factory mjm@hammondmfg.com

NOTE

Enclosure molded from GP ABS (UL94-HB) plastic.
 Purchased assembly includes top and bottom cover, front and rear plastic panels (2 types - flat and contoured) and 4 cover screws.

PART NUMBERS

1593L Enclosure	
Black Enclosure	1593LBK
Grey Enclosure	1593LGY
ACCESSORIES	
Cover Screws (Pkg 100)	1593QS100 (Silver)
#4 x 3/4" self-tapping oval head (19.1mm)	1593QS100BK (Black)
P.C. Board Screws	1593ATS50 (Pkg 50)
#4 x 1/4" self-tapping (6.4mm)	1593ATS100 (Pkg 100)
Belt or Pocket Clip	1599CLIP (Black)
	1599CLIPGY (Grey)
Infrared Panels (Pkg 10)	1593DIR10

**HAMMOND
MANUFACTURING™**

1593L

www.hammondmfg.com