



Chipsmall Limited consists of a professional team with an average of over 10 year of expertise in the distribution of electronic components. Based in Hongkong, we have already established firm and mutual-benefit business relationships with customers from,Europe,America and south Asia,supplying obsolete and hard-to-find components to meet their specific needs.

With the principle of “Quality Parts,Customers Priority,Honest Operation,and Considerate Service”,our business mainly focus on the distribution of electronic components. Line cards we deal with include Microchip,ALPS,ROHM,Xilinx,Pulse,ON,Everlight and Freescale. Main products comprise IC,Modules,Potentiometer,IC Socket,Relay,Connector.Our parts cover such applications as commercial,industrial, and automotives areas.

We are looking forward to setting up business relationship with you and hope to provide you with the best service and solution. Let us make a better world for our industry!



Contact us

Tel: +86-755-8981 8866 Fax: +86-755-8427 6832

Email & Skype: info@chipsmall.com Web: www.chipsmall.com

Address: A1208, Overseas Decoration Building, #122 Zhenhua RD., Futian, Shenzhen, China



DO NOT SCALE

DIMENSIONS IN mm

METRIC

THIRD ANGLE
PROJECTION

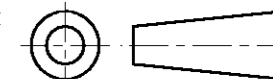

LTR.	REVISION RECORD	DR.	CHK.	DATE
C2	REVISED PER ECO-11-005140	RK	HMR	01APR11

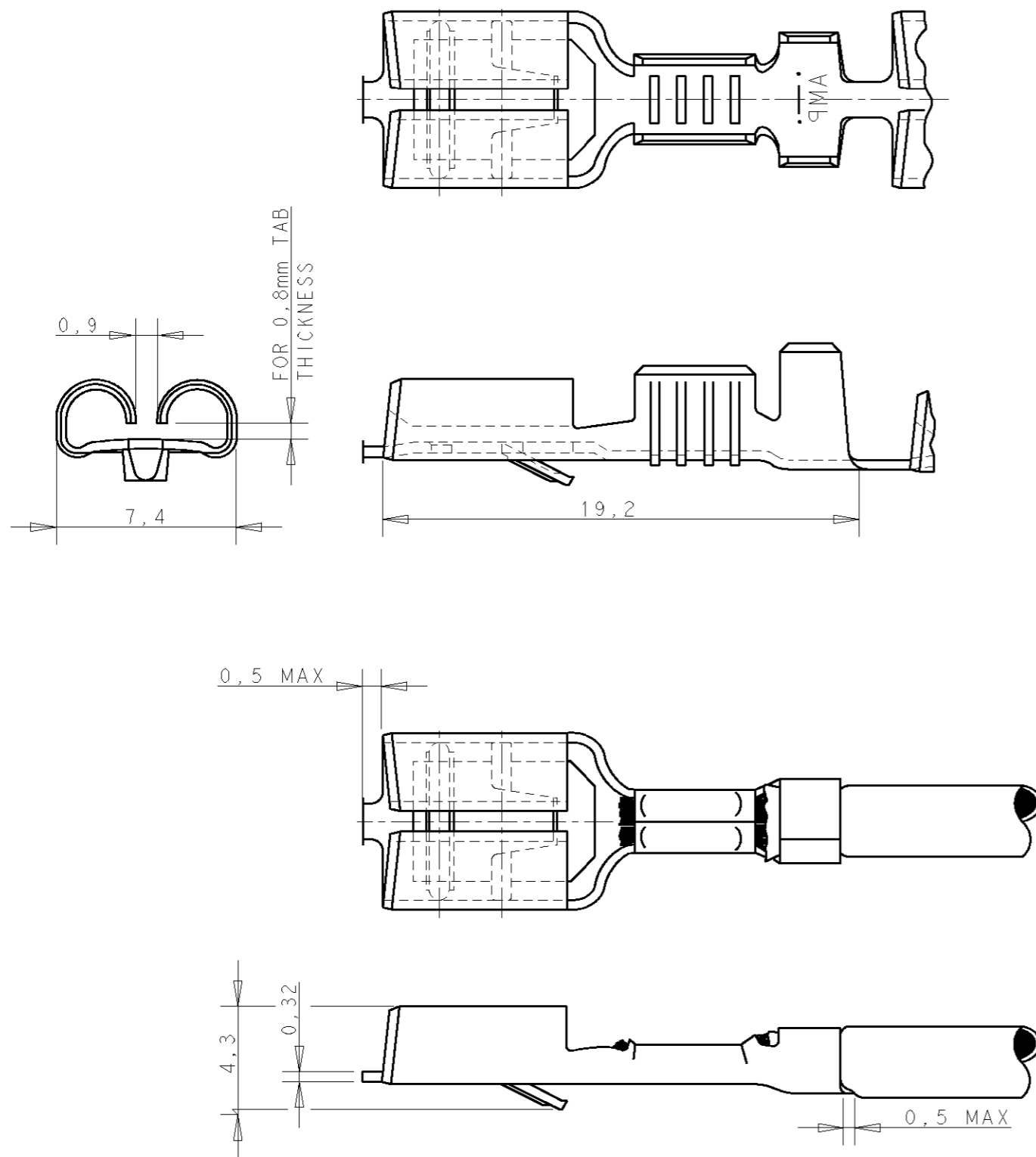

NOTES

- 1 FOR USE ON MINIATURE APPLICATORS (LEFT-RIGHT FEED) AND STANDARD APPLICATORS (RIGHT-LEFT FEED).
- 2. REELED WITH PAPER AND PAPER COVER.
- 3 OBSOLETE PARTS: OBSOLETE CIS STREAMLINING PER D.RENAUD/D.SINISI

GENERAL TOLERANCES ±0.3

NOTES	FINISH	MATERIAL	PARTNUMBER
3 OBSOLETE	1 PRE-TINPLATED	PH.BRONZE	6-160927-8
	1 PRE-TINPLATED	BRASS	6-160927-7
	1 TINPLATED	PH.BRONZE	160927-4
	1 UNPLATED	PH.BRONZE	160927-3
	1 TINPLATED	BRASS	160927-2
	1 UNPLATED	BRASS	160927-1

CUSTOMER DRAWING

FOR REFERENCE ONLY
WILL NOT BE UPDATED

STE TE Connectivity

~~THIS DRAWING IS UNPUBLISHED~~ RELEASED FOR PUBLICATION jan ,1988

DR. R.v.Lokven	DATE 26.01.88	WIRE RANGE >1,0-2,5 mm ²	NAME .250 SRS FASTIN-ON RECEPTACLE.	REV. DATE D M Y 01 04 11
CHK. A.B.	DATE 02.02.88	INSUL. RANGE 2,1-3,1 DIA		
APP. L.v.Soest	DATE 03.02.88	SIZE A3	SHEET 1 OF 1	REV. LTR. C2

8 | 7 | 6 | 5 | 4 | 3 | 2 | 1