



Chipsmall Limited consists of a professional team with an average of over 10 year of expertise in the distribution of electronic components. Based in Hongkong, we have already established firm and mutual-benefit business relationships with customers from,Europe,America and south Asia,supplying obsolete and hard-to-find components to meet their specific needs.

With the principle of “Quality Parts,Customers Priority,Honest Operation,and Considerate Service”,our business mainly focus on the distribution of electronic components. Line cards we deal with include Microchip,ALPS,ROHM,Xilinx,Pulse,ON,Everlight and Freescale. Main products comprise IC,Modules,Potentiometer,IC Socket,Relay,Connector.Our parts cover such applications as commercial,industrial, and automotives areas.

We are looking forward to setting up business relationship with you and hope to provide you with the best service and solution. Let us make a better world for our industry!



## Contact us

Tel: +86-755-8981 8866 Fax: +86-755-8427 6832

Email & Skype: info@chipsmall.com Web: www.chipsmall.com

Address: A1208, Overseas Decoration Building, #122 Zhenhua RD., Futian, Shenzhen, China



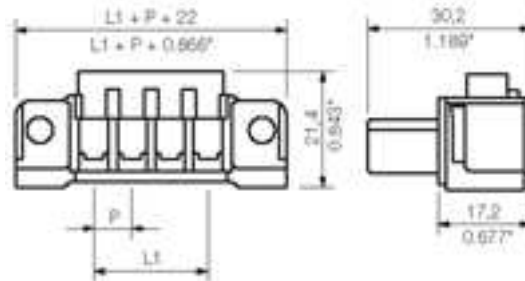

#### General ordering data

Order No.	1612020000
Part designation	STV S 4 SB
Version	PCB plug-in connector, Female connectors, Leaf spring connection, Clamping range, max.: 4 mm <sup>2</sup> , Pitch: 7.00 mm, No. of poles: 4, 90°, Box
EAN	4008190198732
Qty.	10 pc(s).

#### System parameters

Conductor connection system	Leaf spring connection
Outgoing direction of conductor	90°
Pitch	7 mm
Pitch in inch	0.276 inch
No. of poles	4
No. of rows	1
Screwdriver blade	0.6 x 3.5
Screwdriver blade standard	DIN 5264
Tightening torque, min.	0.5 Nm
Tightening torque, max.	0.6 Nm
Clamping screw	M 3
Stripping length	9 mm
L1 in mm	21 mm
L1 in inch	0.827 inch
Electric shock protection to DIN VDE 0470	IP 20
Electric shock protection to DIN VDE 0470	Safe from finger touch

#### Material data

Insulating material	Wemid (PA)
Colour	pebble grey
colour chart	Similar to RAL 7032
Insulating material group	I
Flammability class UL 94	V-0
CTI	>= 600
Contact base material	CuZn

#### Material data

Contact surface	silver-plated
-----------------	---------------

#### Connectable conductors

Clamping range, min.	0.32 mm <sup>2</sup>
Clamping range, max.	4 mm <sup>2</sup>
AWG, min.	22
AWG, max.	12
Solid, min. H05(07) V-U	0.5 mm <sup>2</sup>
Solid, max. H05(07) V-U	4 mm <sup>2</sup>
Flexible, min. H05(07) V-K	0.5 mm <sup>2</sup>
Flexible, max. H05(07) V-K	4 mm <sup>2</sup>
With wire end ferrule, acc. to DIN 46 228/1, min.	0.5 mm <sup>2</sup>
With wire end ferrule, acc. to DIN 46 228/1, max.	4 mm <sup>2</sup>
w. plastic collar ferrule, DIN 46228 pt 4, min.	0.5 mm <sup>2</sup>
w. plastic collar ferrule, DIN 46228 pt 4, max.	4 mm <sup>2</sup>
Gauge to EN 60999 a x b; ø	2.8 mm x 2.2 mm;

#### DIN IEC rating data

Rated current, min. No. pins (Tu=20°C)	32 A
Rated current, max. No. pins (Tu=20°C)	28 A
Rated current, min. No. pins (Tu=40°C)	32 A
Rated current, max. No. pins (Tu=40°C)	24 A
Rated voltage for overvoltage class/pollution severity II/2	1,000 V
Rated voltage for overvoltage class/pollution severity III/2	500 V
Rated voltage for overvoltage class/pollution severity III/3	500 V
Rated impulse withstand voltage for overvoltage class/pollution severity II/2	6 kV
Rated impulse withstand voltage for overvoltage class/pollution severity III/2	6 kV
Rated impulse withstand voltage for overvoltage class/pollution severity III/3	6 kV
Short-time withstand current resistance	3 x 1s with 340 A

#### CSA rating data

AWG conductor (field wiring), min.	20
AWG conductor (field wiring), max.	12

#### UL 1977 rating data

Rated voltage (UL 1977)	600 V
Rated current (UL 1977)	25 A
AWG-conductor, min. (UL 1977)	22
AWG-conductor, max. (UL 1977)	12

## Approvals

Approvals institutes



## Classifications

ETIM 2.0	NK
ETIM 3.0	EC001284
eClass 4.1	27-26-07-01
eClass 5.0	27-26-07-01
eClass 5.1	27-26-07-01

## Similar products

Order No.	Part designation	Version
1611960000	STV S 2 SB	PCB plug-in connector, Female connectors, Leaf spring connection, Clamping range, max.: 4 mm <sup>2</sup> , Pitch: 7.00 mm, No. of poles: 2, 90°, Box
1611990000	STV S 3 SB	PCB plug-in connector, Female connectors, Leaf spring connection, Clamping range, max.: 4 mm <sup>2</sup> , Pitch: 7.00 mm, No. of poles: 3, 90°, Box
1612050000	STV S 5 SB	PCB plug-in connector, Female connectors, Leaf spring connection, Clamping range, max.: 4 mm <sup>2</sup> , Pitch: 7.00 mm, No. of poles: 5, 90°, Box
1612080000	STV S 6 SB	PCB plug-in connector, Female connectors, Leaf spring connection, Clamping range, max.: 4 mm <sup>2</sup> , Pitch: 7.00 mm, No. of poles: 6, 90°, Box
1612110000	STV S 7 SB	PCB plug-in connector, Female connectors, Leaf spring connection, Clamping range, max.: 4 mm <sup>2</sup> , Pitch: 7.00 mm, No. of poles: 7, 90°, Box
1612140000	STV S 8 SB	PCB plug-in connector, Female connectors, Leaf spring connection, Clamping range, max.: 4 mm <sup>2</sup> , Pitch: 7.00 mm, No. of poles: 8, 90°, Box
1612170000	STV S 9 SB	PCB plug-in connector, Female connectors, Leaf spring connection, Clamping range, max.: 4 mm <sup>2</sup> , Pitch: 7.00 mm, No. of poles: 9, 90°, Box
1612200000	STV S 10 SB	PCB plug-in connector, Female connectors, Leaf spring connection, Clamping range, max.: 4 mm <sup>2</sup> , Pitch: 7.00 mm, No. of poles: 10, 90°, Box